

TECHNICAL SPECIFICATIONS – PIVOT & HINGE DOORS

300CV - Continuous Hinge - 1/4" Glass

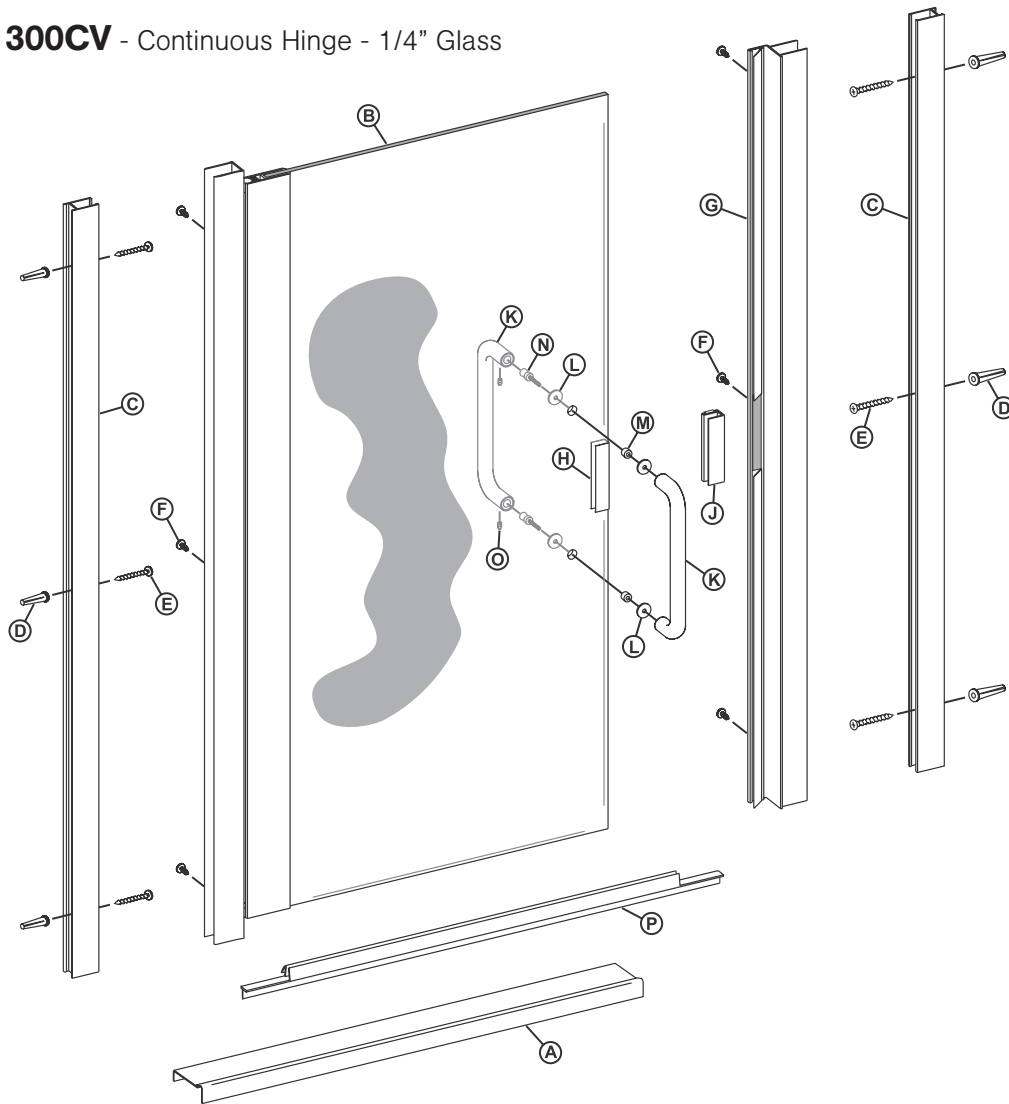

- A.** 1 SC-915 Shower Curb
- B.** 1 Glazed Door Panel Assembly
- C.** 2 SC-508 Wall Jambs
- D.** 6 Plastic Wall Anchors
- E.** 6 #8 x 1 1/2 Truss Head Screws
- F.** 6 #6 x 3/8 Pan Head Tex Screws

- G.** 1 SC-552 Strike Jamb w/Magnet
- H.** 1 Latch Vinyl
- J.** 1 Latch
- K.** 1 Back to Back Handle
- L.** 4 Plastic Washers
- M.** 2 Plastic Bushings

- N.** 2 Cone Head Bolts
- O.** 2 Set Screws
- P.** 1 V-351 Deflector

Calculations

Maximum allowable width of unit = 37 (@ 72 tall)
 Maximum allowable height of unit = 84 (@ 30 wide)

Glass Size

Width = Unit width - 3 5/8
 Height = Unit ht. - 1 9/16

Adjustment for Wall Conditions

+ 3/8" on Both Sides
 - 0"

Metal Cuts

SC-508 wall jamb = Unit ht. - 7/16
 SC-552 strike jamb = Unit ht. - 7/16
 V-351 deflector = Door panel width - 7/16
 SC-649 hinge jamb = Unit ht. - 7/16
 SC-651 hinge rail = Unit ht. - 1 9/16
 SC-915 curb = Unit width