

TECHNICAL SPECIFICATIONS – PIVOT & HINGE DOORS

338 - Pivot - 3/16" Glass

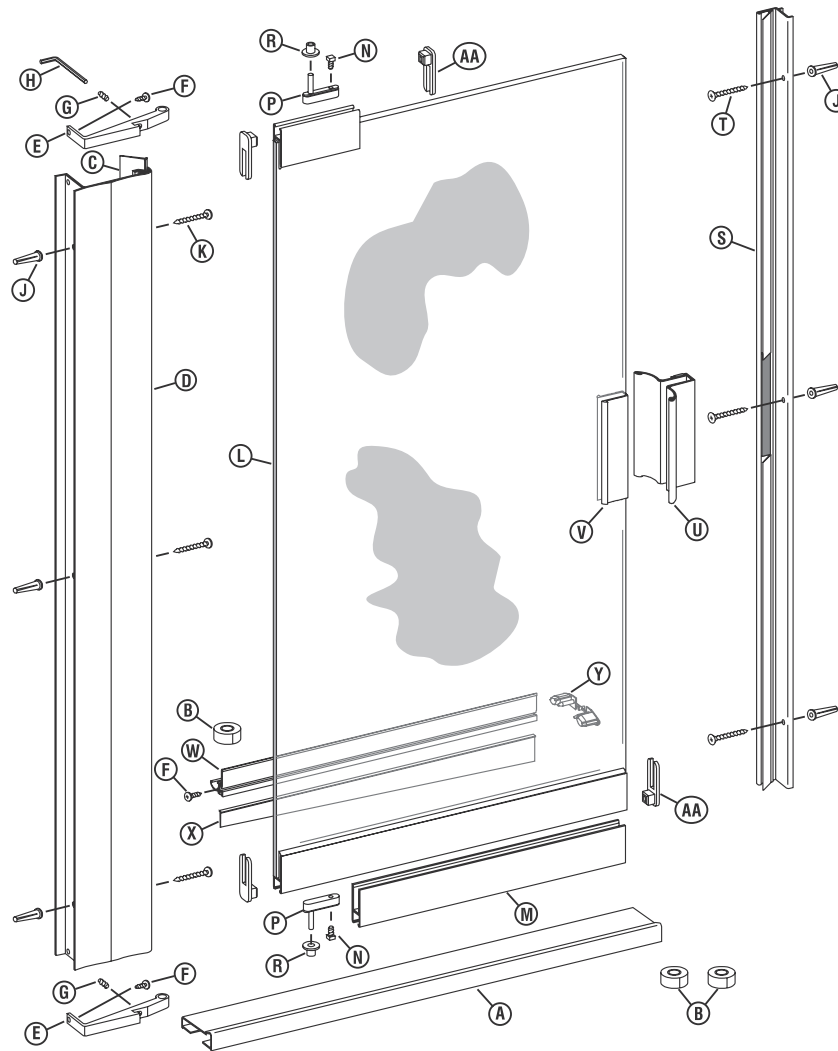

- A.** 1 SC-607 Curb
- B.** 3 Rolls of Tape (double-stick)
- C.** 1 Pivot Jamb Seal Vinyl
- D.** 1 SC-621 Pivot Jamb
- E.** 2 Pivot Bracket
- F.** 3 #6 x 3/8 Truss Head Screws
- G.** 2 #8 x 1/8 Allen Set Screws
- H.** 1 Allen Wrench (5/64)

- J.** 6 Plastic Wall Anchors
- K.** 3 #8 x 2 Truss Head Screws
- L.** 1 Glazed Door Panel
- N.** 2 #10 x 7/16 Set Screws
- P.** 2 Pivot Blocks
- R.** 2 Nylon Bushings
- S.** 1 SC-551 Strike Jamb (w/Magnet)
- T.** 3 #8 x 1 1/2 Flat Head Screws

- U.** 1 Door Handle (w/Magnet)
- V.** 1 Door Handle Vinyl (4")
- W.** 1 Drip Rail
- X.** 1 Tapered Drip Vinyl
- Y.** 2 Drip Plugs
- AA.** 4 Rail End Caps

Calculations

Maximum allowable width of unit = 37 (@ 72 tall)
 Maximum allowable height of unit = 84 (@ 30 wide)

Glass Size

Width = Unit width - 1 5/8
 Height = Unit ht. - 2 1/2

Adjustment for Wall Conditions

± 1/4" on Strike Jamb
 ± 3/8" on Pivot Jamb

Metal Cuts

SC-558 top and bottom rail = 4 3/8
 SC-558 bottom rail = Glass width - 4 1/4
 SC-607 curb (optional) = Unit width
 SC-621 pivot jamb = Unit ht. - 7/16
 SC-551 strike jamb = Unit ht. - 1 1/2