

TECHNICAL SPECIFICATIONS – SLIDING ENCLOSURES

640 / 650 - Framed Slider - 5/32" Glass

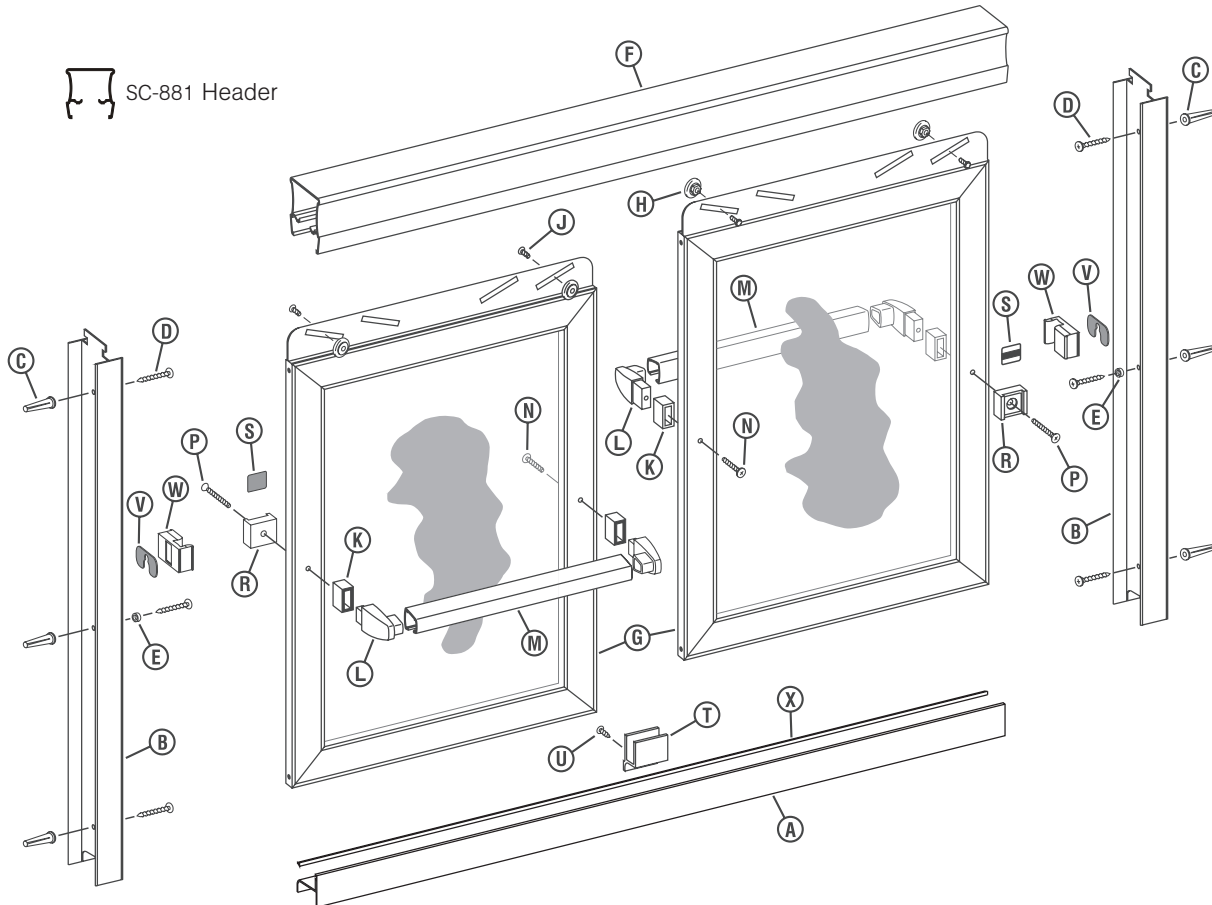

- | | | |
|---|---|--|
| A. 1 SC-556 Tub Track | H. 4 Nylon Roller Bearings | R. 2 Acrylic Finger Pull |
| B. 2 SC-896 Wall Jamba | J. 4 #8 - 32 x 3/8" Hex Head Screws | S. 2 Alumax Decals |
| C. 6 Plastic Wall Anchors | K. 4 Towel Bar Trim Rings | T. 1 Nylon Bottom Guide |
| D. 6 #8 x 1 1/2" Truss Head Screws | L. 4 Towel Bar Brackets | U. 1 #6 x 3/8 Truss Head Screw |
| E. 2 Nylon Spacers | M. 2 SC-805 Towel Bar | V. 2 Stainless Steel Bumper Inserts |
| F. 1 SC-881 Header | N. 2 #10 - 24 x 7/8" Truss Head Screw | W. 2 Soft Jamb Bumpers |
| G. 2 Glazed Panels | P. 2 #10 - 24 x 1 1/8" Flat Head Screw | X. 1 Vinyl Silencer |

Calculations

Maximum allowable width of unit = 72
 Maximum allowable height of unit = 72

Glass Size

Width = (Unit Width ÷ 2) - 2
 Height = Unit Ht. - 4 1/2

Adjustment for Wall Conditions

± 3/16" on Both Sides

Metal Cuts

SC-556 tub track = Unit width - 1/16
 SC-805 towel bar = Bottom rail - 1 11/16
 SC-881 header = Unit width - 1/16
 SC-882 top rail = (Unit width ÷ 2) - 1/8
 SC-883 bottom rail = (Unit width ÷ 2) - 1/8
 SC-896 wall jamb = Unit ht. - 1 1/2
 SC-884 side rail = Unit ht. - 2 5/8