

TECHNICAL SPECIFICATIONS – SLIDING ENCLOSURES

1040 / 1050 - 3/8" Frameless Slider

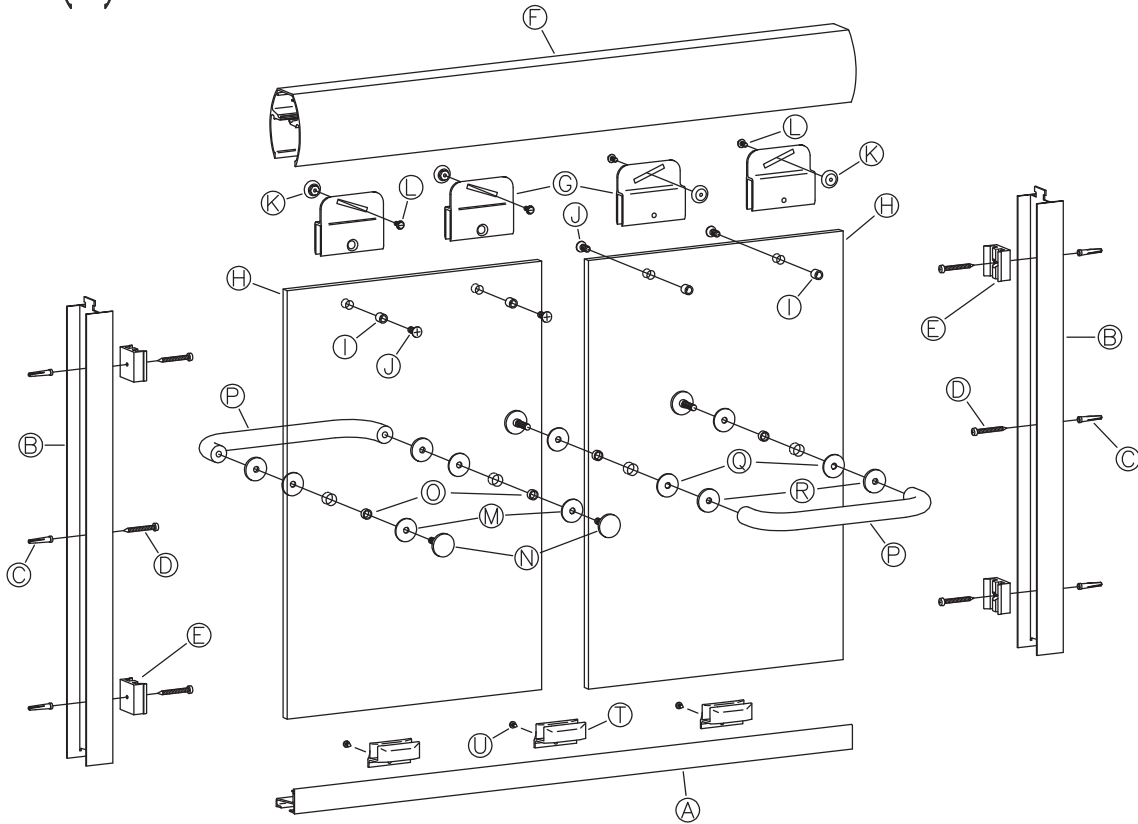
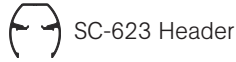

- | | | |
|---|--|--|
| A. 1 SC-624 Tub Track | I. 4 Nylon Bushing | P. 2 Towel Bars |
| B. 2 SC-800 Wall Jamb | J. 4 1/4" x 5/8" Flat Head Screws | Q. 4 Small Hole Plastic Washers |
| C. 6 Wall Anchors | K. 4 Roller Bearings | R. 4 Metal Washers |
| D. 6 #8 x 1 1/2" Truss Head Screws | L. 4 #8 x 3/8" Hex Head Screws | S. 1 Wrench (Not Shown) |
| E. 4 Jamb Bumpers | M. 4 Large Hole Plastic Washers | T. 3 Clear Panel Guides |
| F. 1 SC-623 Header | N. 4 End Caps | U. 3 #6 x 3/8" Pan Head Screws |
| G. 4 Hanger Brackets | O. 4 Glass Inserts | V. 1 Vinyl Silencer |
| H. 2 Glass Door Panels | | |

Calculations

Maximum allowable width of unit = 72 (@ 71 1/4 tall)

Maximum allowable height of unit = 84 (@ 60 wide)

Glass Size

Width = (Unit Width ÷ 2) + 1/4

Height = Unit Ht. - 2 3/8

Adjustment for Wall Conditions

± 1/4" on Both Sides

Metal Cuts

SC-623 header = Unit width - 1/16

SC-624 tub track = Unit width - 1/16

SC-800 wall jamb = Unit ht. - 1 3/8