

K-KC4Z - Kona

INSTRUCTION MANUAL

 **ALUMAX**
Kula Collection

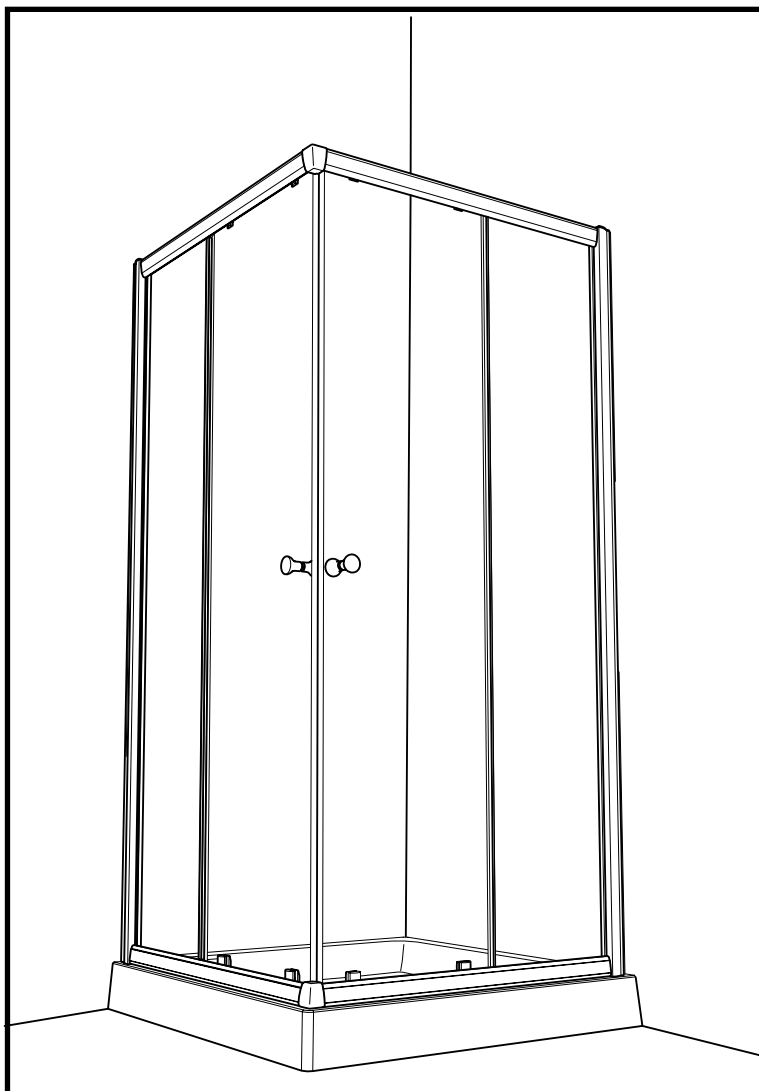

07.10

KK008

- Model Number

Please keep this manual and product code number for future reference and to order replacement parts if necessary.

- General Instructions

- Read this manual carefully and completely before proceeding.
- It is recommended that you wear safety glasses at all times during the installation.

- Installation over Ceramic Tiles

- Silicone should be used to seal the gap where the ceramic tiles meet the fixed panel.
- If your shower door is to be installed over ceramic tiles, the tiles should lay completely under the wall jamb.

- Notice

- Caulking: no sealant is required inside the shower.
- All models are equipped with transparent sealing gaskets.

- Care for your Frameless Shower Door

- Never use scouring powder pads or sharp instruments on metal pieces or glass panels.
An occasional wiping down with a mild soap diluted in water is all that is needed to keep the panels and aluminum parts looking new.
- We recommend wiping the glass panels with a squeegee after each use.

Product specifications are subject to change without notice.

PARTS LISTING

NOTE

XX REFERS TO THE MATERIAL FINISH

11- Bright Chrome
12- Bright Brass
25- Brushed Nickel
29- Oil Rubbed Bronze

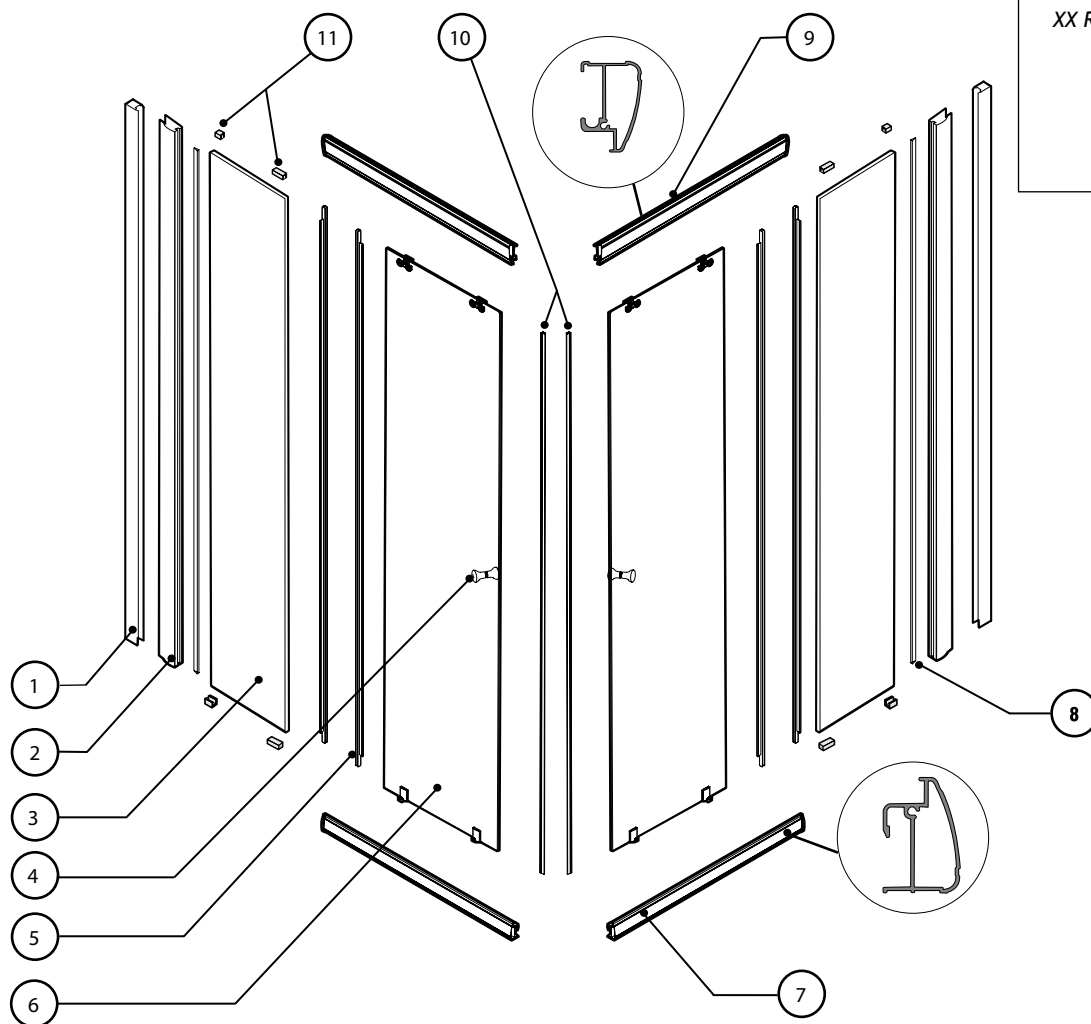

ITEM	PARTS	QTY
1	WALL JAMB	2
2	EXPANDER	2
3	FIXED PANEL	2
4	SET OF HANDLES	2
5	DOOR SIDE GASKET	4
6	DOOR PANEL ASSEMBLY	2
7	BOTTOM TRACK	2
8	SIDE GASKET WALL JAMB SIDE	2
9	TOP TRACK	2
10	MAGNETIC DOOR GASKET	2
11	GLASS SUPPORT	8

PROVIDED HARDWARE

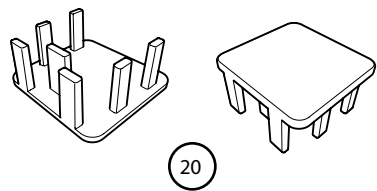
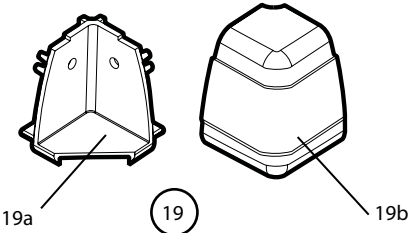
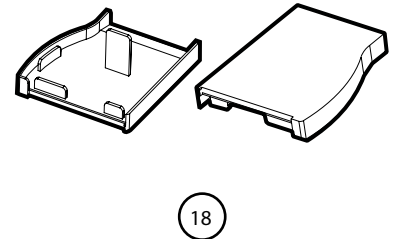
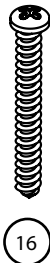
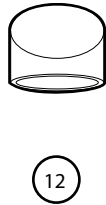
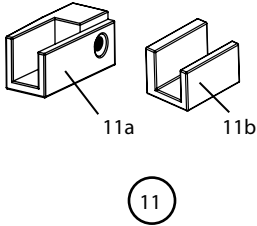
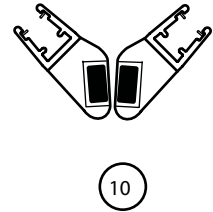
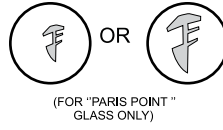
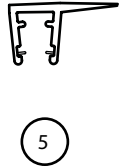
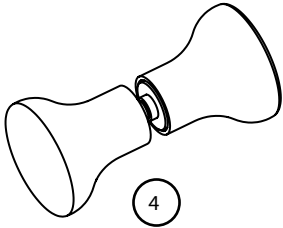

ITEM	HARDWARE	QTY
4	SET OF HANDLES	2
5	SIDE GASKET	4
8	SIDE GASKET WALL JAMB SIDE	4
10	MAGNETIC DOOR GASKET	1
11	GLASS SUPPORT	8
12	BOTTOM SLIDER SHIM	4
13	WALL PLUG	8
14	SCREW (M4 x 8)	8
15	SCREW CAP	8
16	SCREW (M4 x 35)	12
17	SCREW (M4 x 8)	8
18	EXPANDER CAP	2
19	CONNECTOR	2
20	WALL JAMB CAP	

TOOLS AND MATERIALS REQUIRED



SCREWDRIVERS

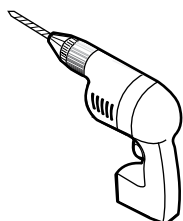

DRILL

*

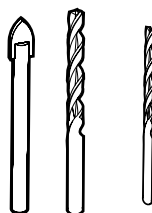

1/4" & 1/8" DRILL BITS

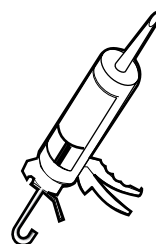

SILICONE

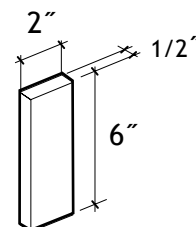

WOODEN BLOCK

**If the shower panels are to be assembled on ceramic tiles, use a 1/4" drill bit for ceramic tiles.*

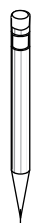

PENCIL

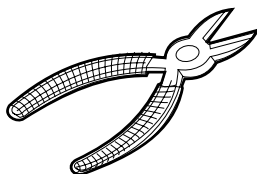

CUTTING PLIER

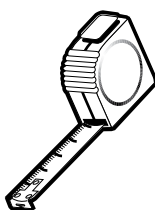

TAPE MEASURE

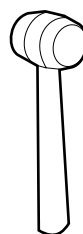

MALLET

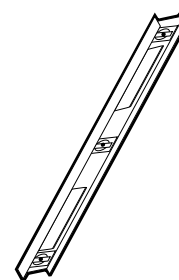

LEVEL

1

CENTER AND INSTALL THE WALLJAMB

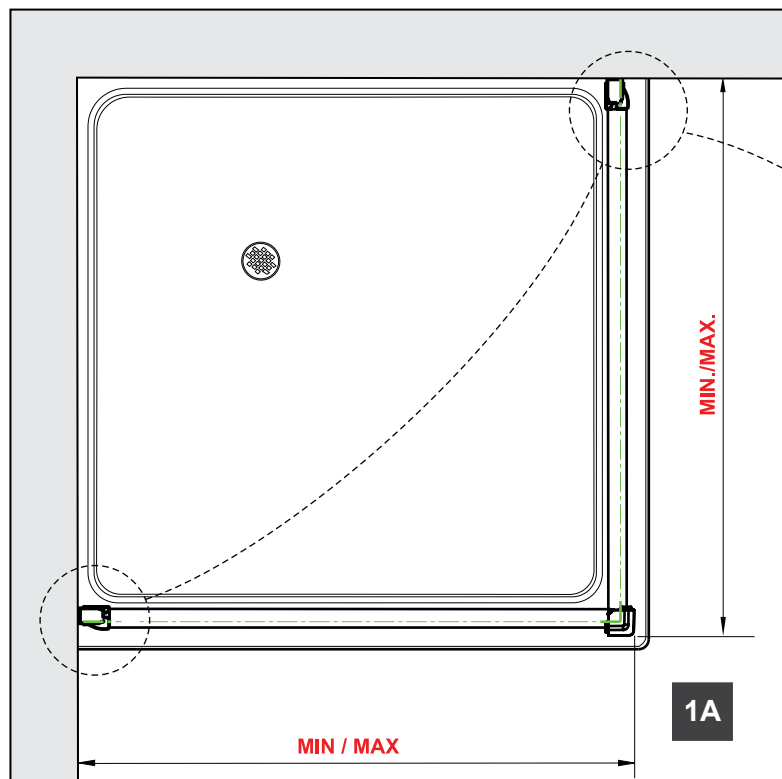

MODEL	MIN (in / cm)	MAX (in / cm)
32	31 1/4" (79cm)	32" (81cm)
36	34 1/4" (87cm)	35" (89cm)
42	40 3/8" (102.5cm)	41 1/8" (104cm)

1A

1A. Refer to the limits given (Min/Max), position and center the wall jambs (#1) on the shower threshold.

1B. Trace outer edge of wall jambs.

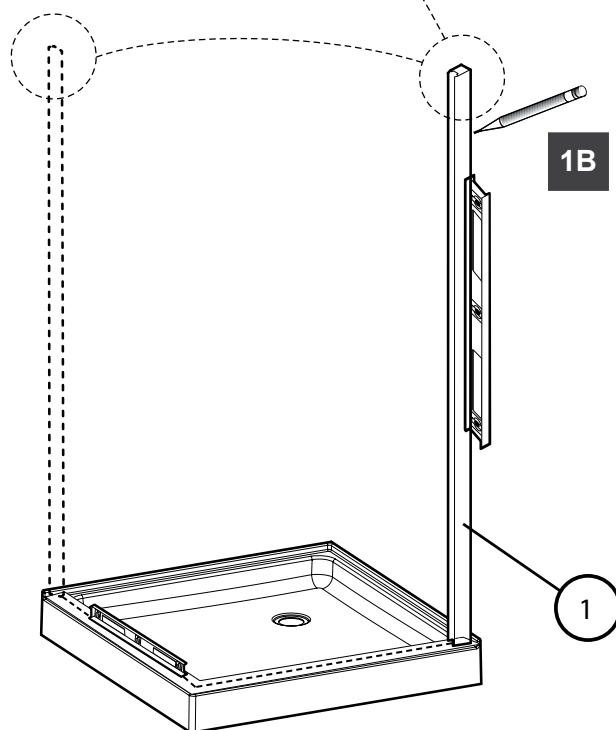

2A. Reposition one of the wall jambs (#1) on the shower threshold.

2B. Mark drilling location.

2C. With a 1/4" drill bit, drill 4 holes.

2D. Insert 4 wall plugs (#13) and put in each a drop of silicone.

2E. Secure the wall jamb (#1) using the 1 3/8" screws (#16).

2F. Repeat the same step for the other wall jamb.

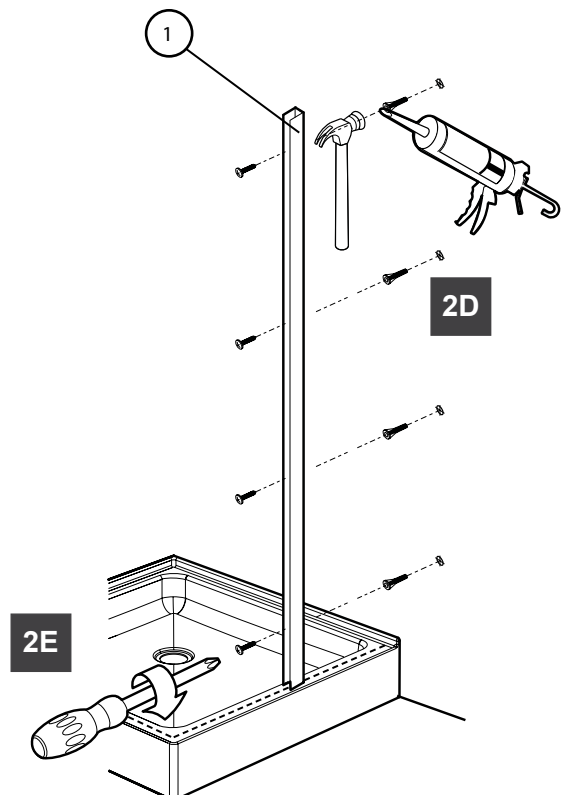
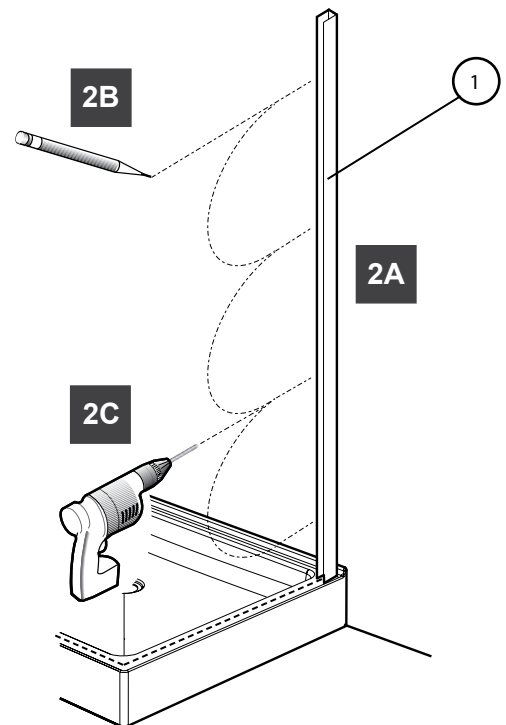

3 BUILD TWO HALVES-FRAMES.

3A. Mount on the each expander (#2) the two track (#7 & #9) to form two halves-frames.

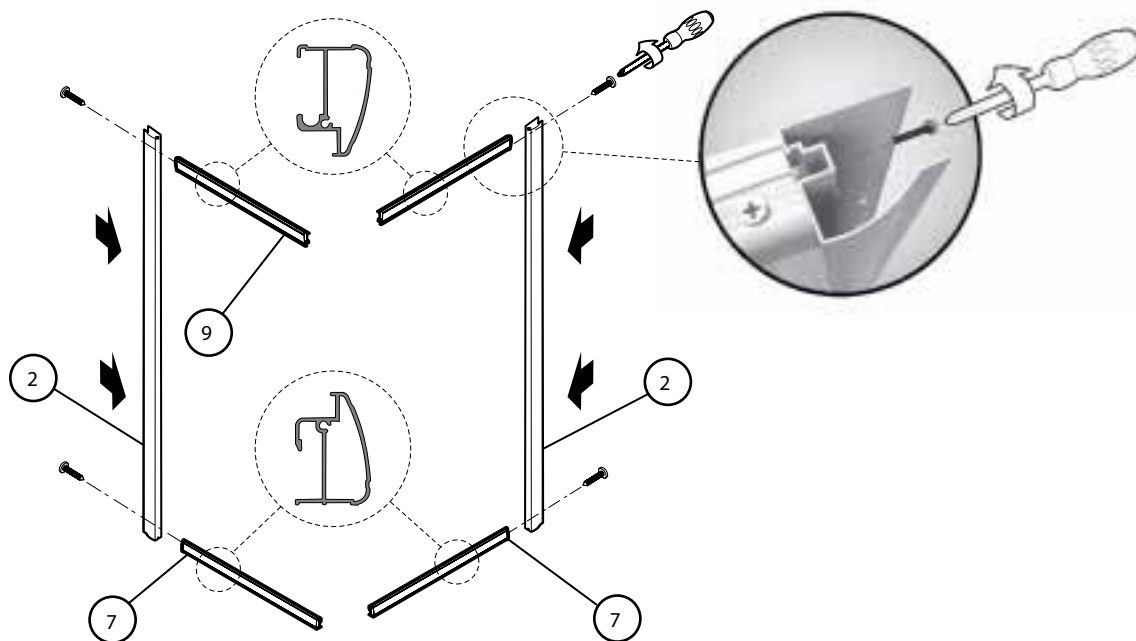

4 BUILD THE FRAME.

4A. Use the connectors(#19a) to close the frame and add the cover (#19b).

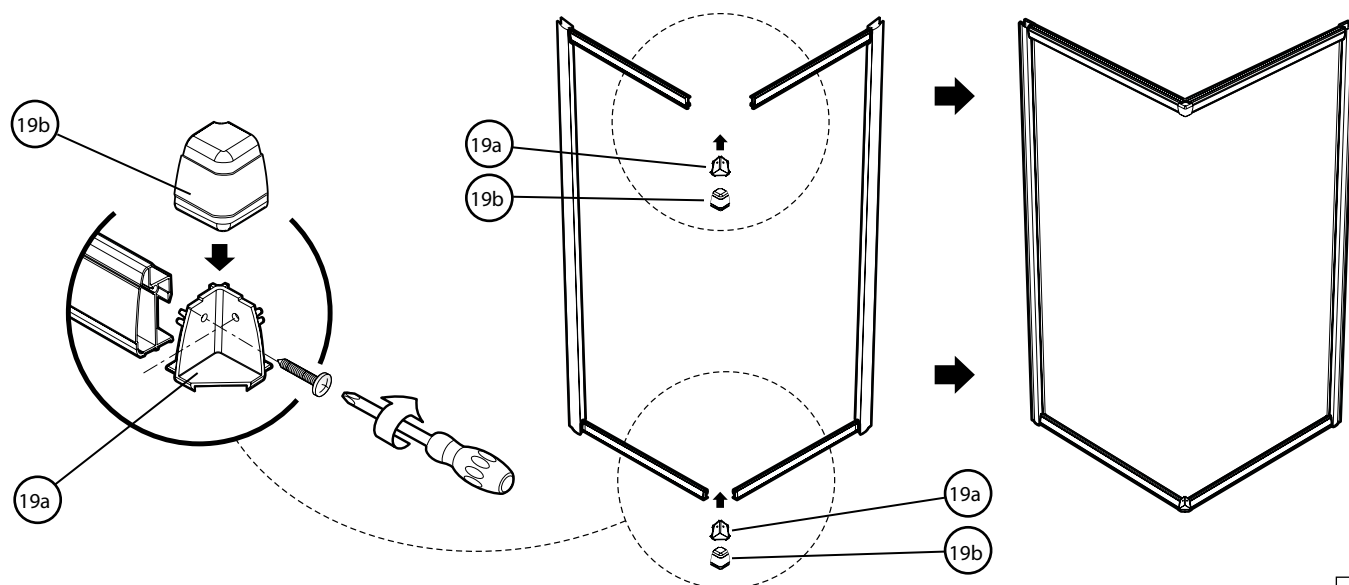

5A. *Insert the frame into the installed wall jambs.*

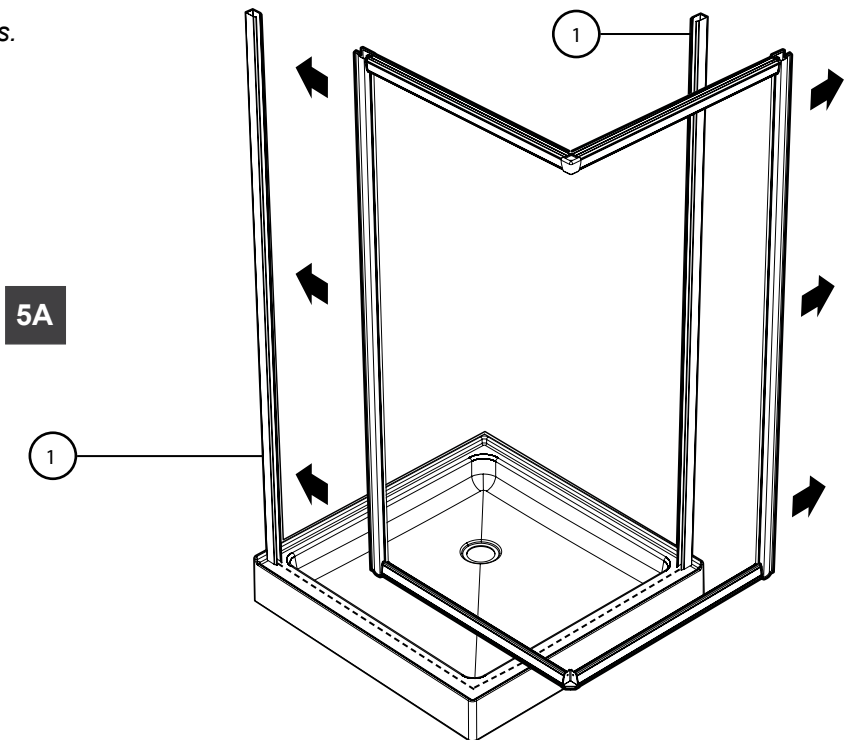

5B. *Position and center the frame onto threshold of shower base.*

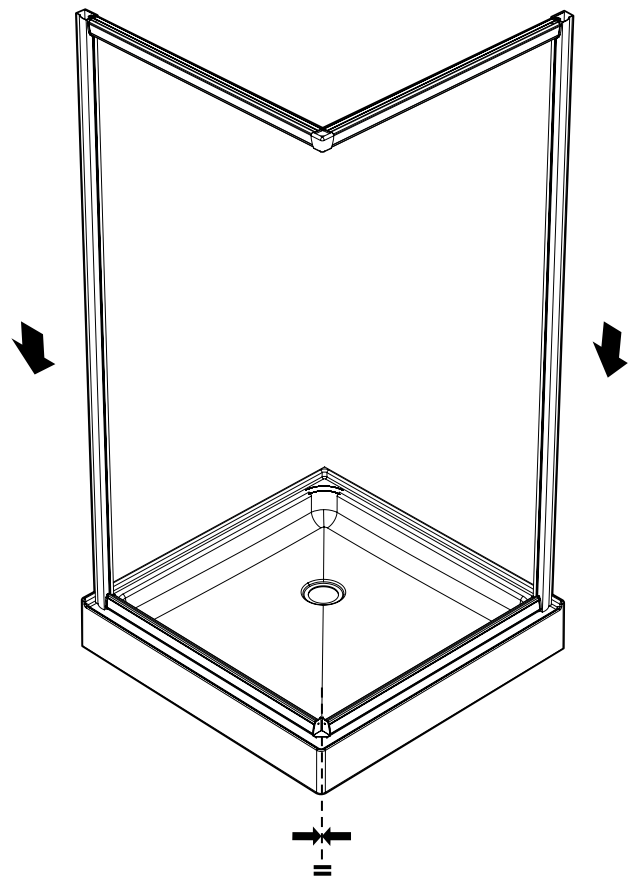

6A. Insert fixed panel support blocks (#11a & 11b) at each corner of the fixed panels. (# 3).

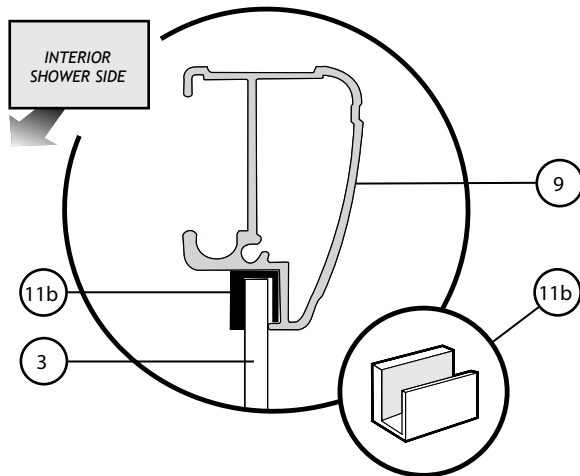

6A

6B. Secure the fixed panels with a 15/32" screw (#17).

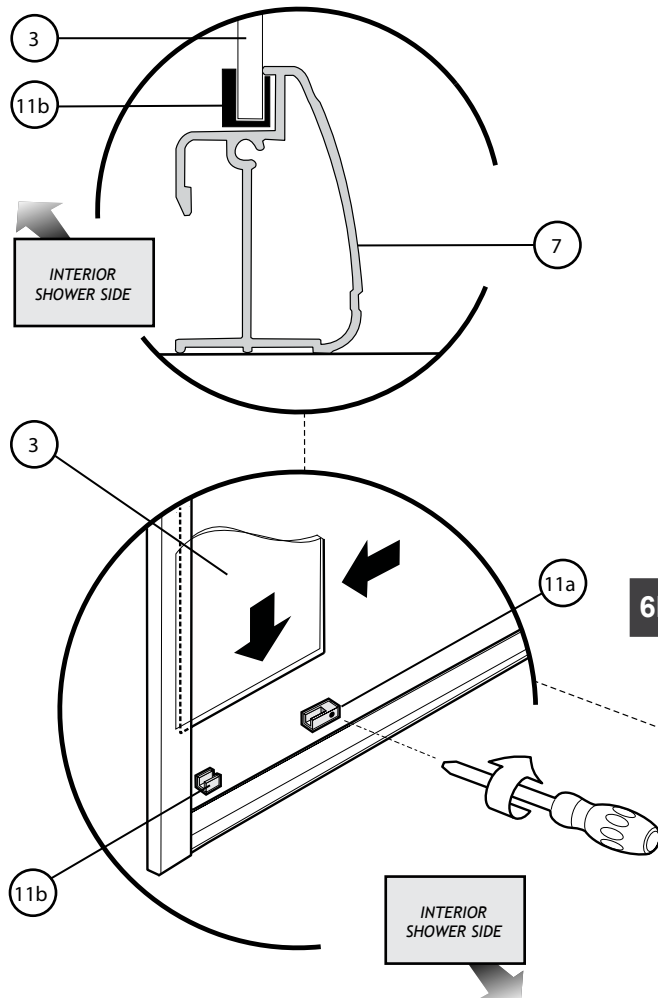

6B

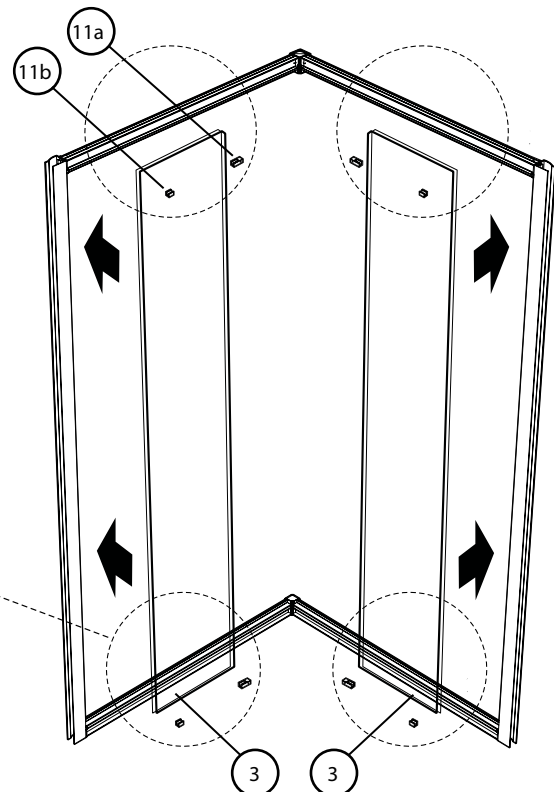

7 DOOR INSTALLATION

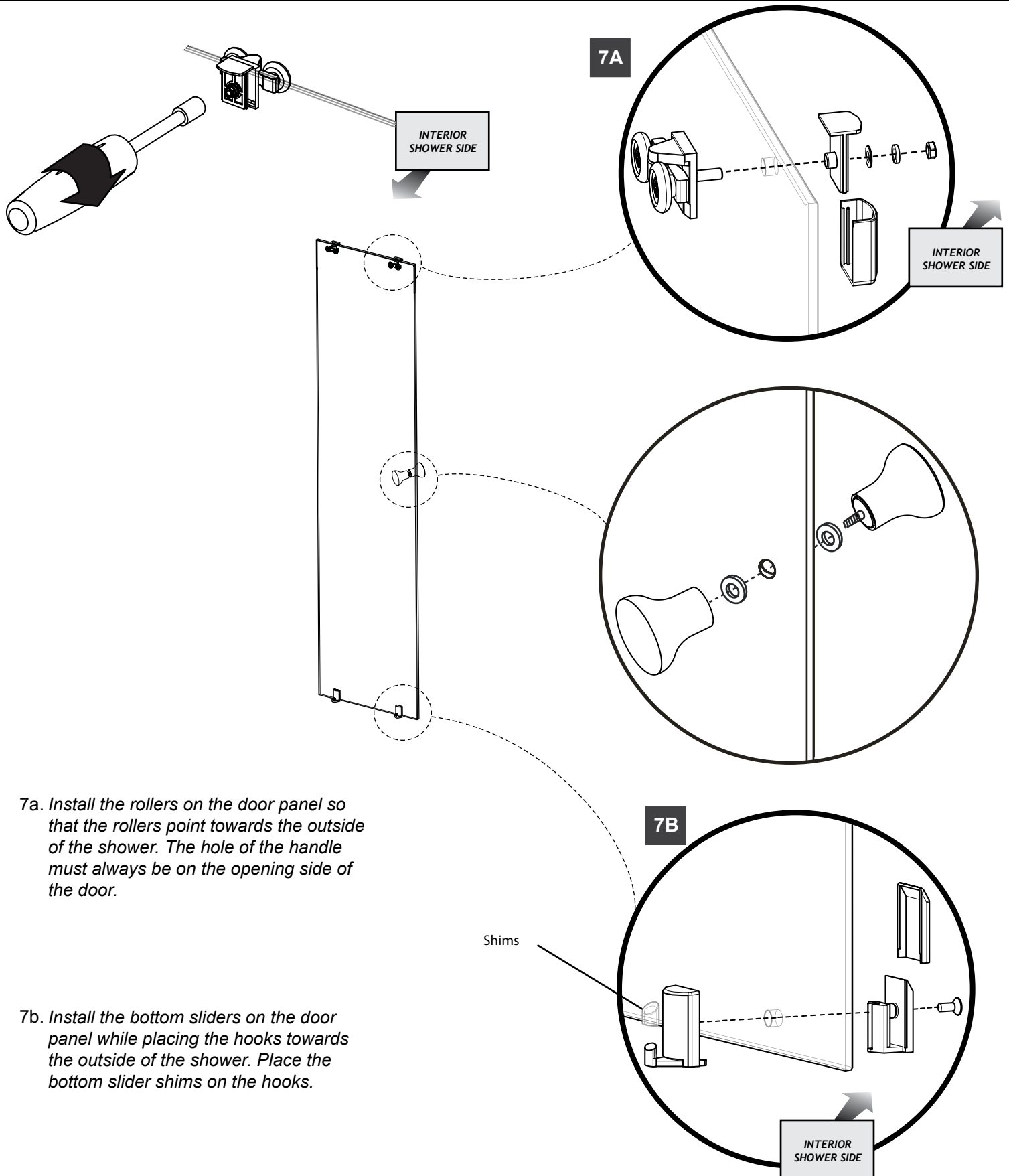

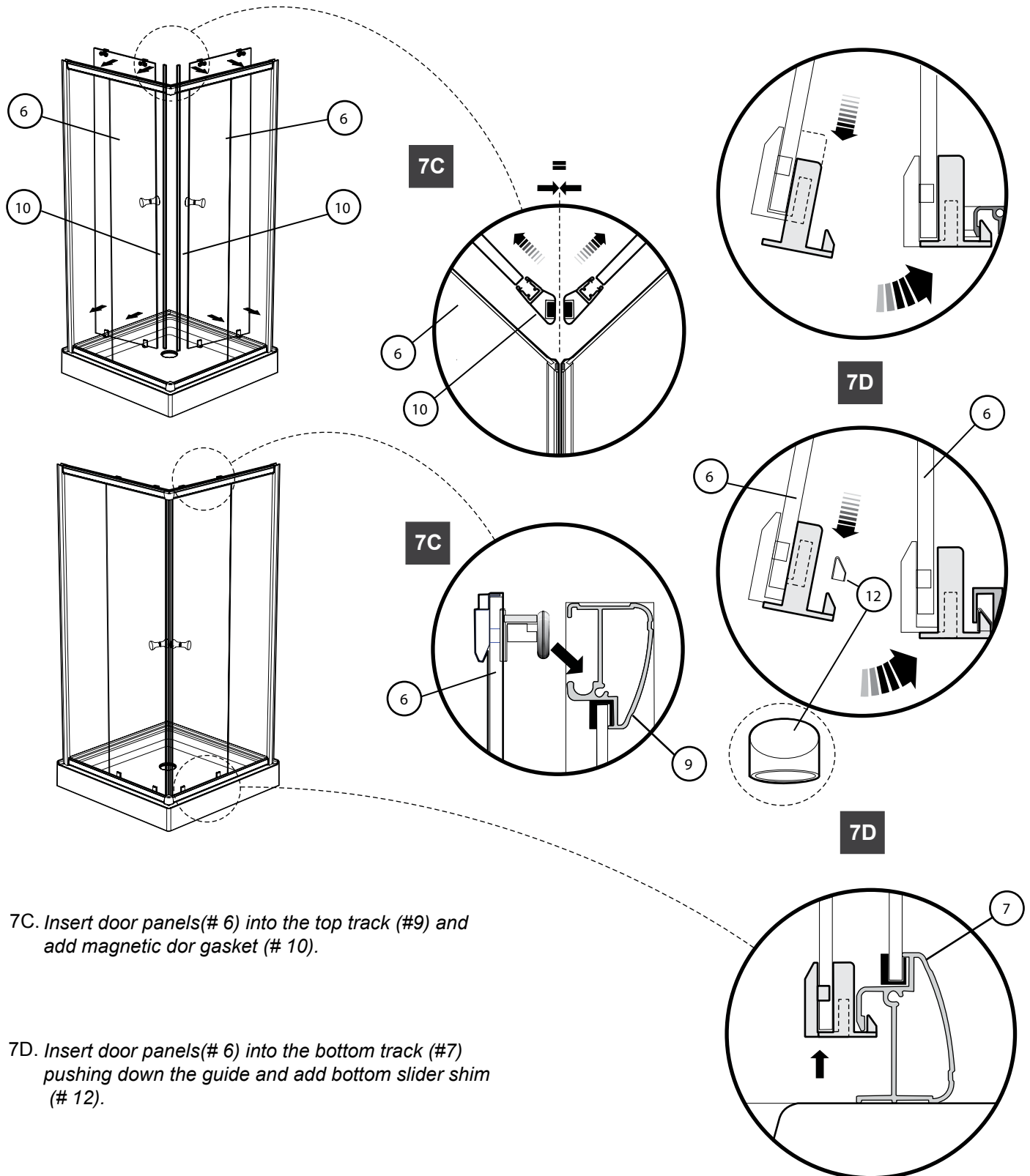

7C. Insert door panels(# 6) into the top track (#9) and add magnetic door gasket (# 10).

7D. Insert door panels(# 6) into the bottom track (#7) pushing down the guide and add bottom slider shim (# 12).

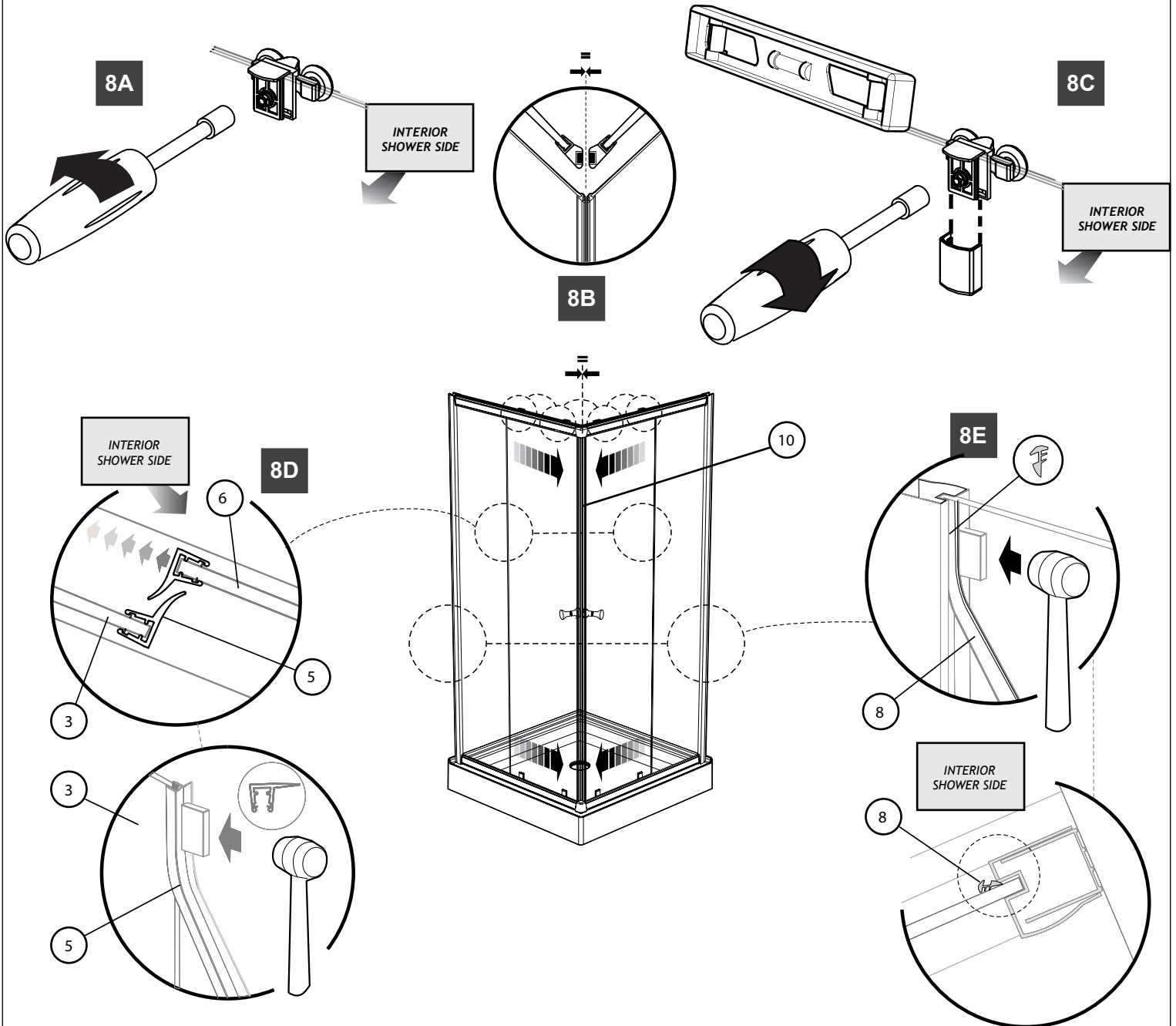

8A. Loosen the nut with a hex nut driver 5/16"

8B. Vertical adjustment(verify if the magnetic gasket meet-properly).

8C. Tighten the nut. Close the cover.

8D. Insert side panels gasket (# 5) onto fixed panel & door panels.

8E. Insert side gasket wall jamb side (#8) using a mallet and a small wood block.

9A. Level and adjust unit.

9B. Fasten frame with screw 3/8" (#14) and add screw cap (#15).

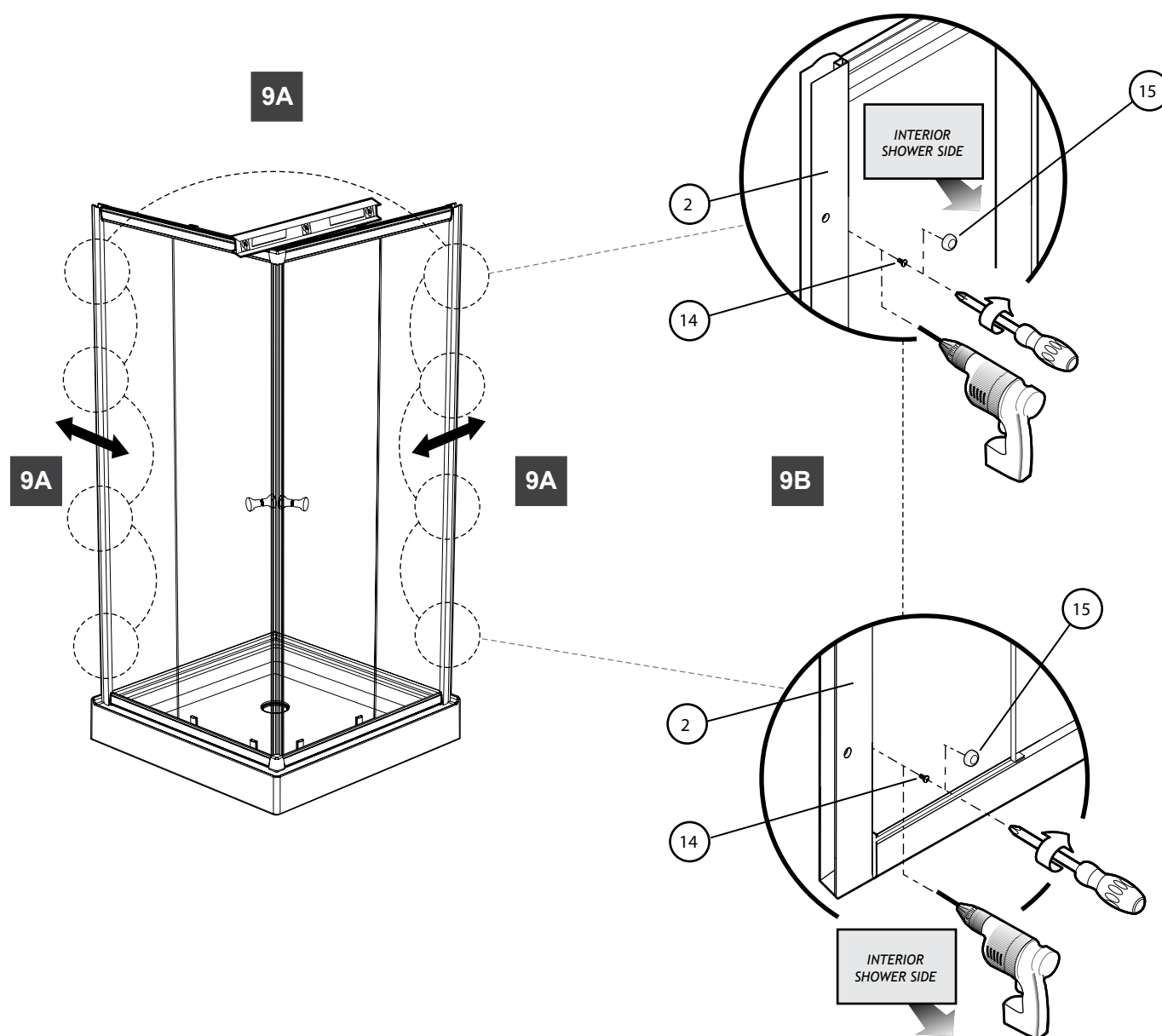

10 FINISHING TOUCHES.

10A. Insert expander caps (#18).

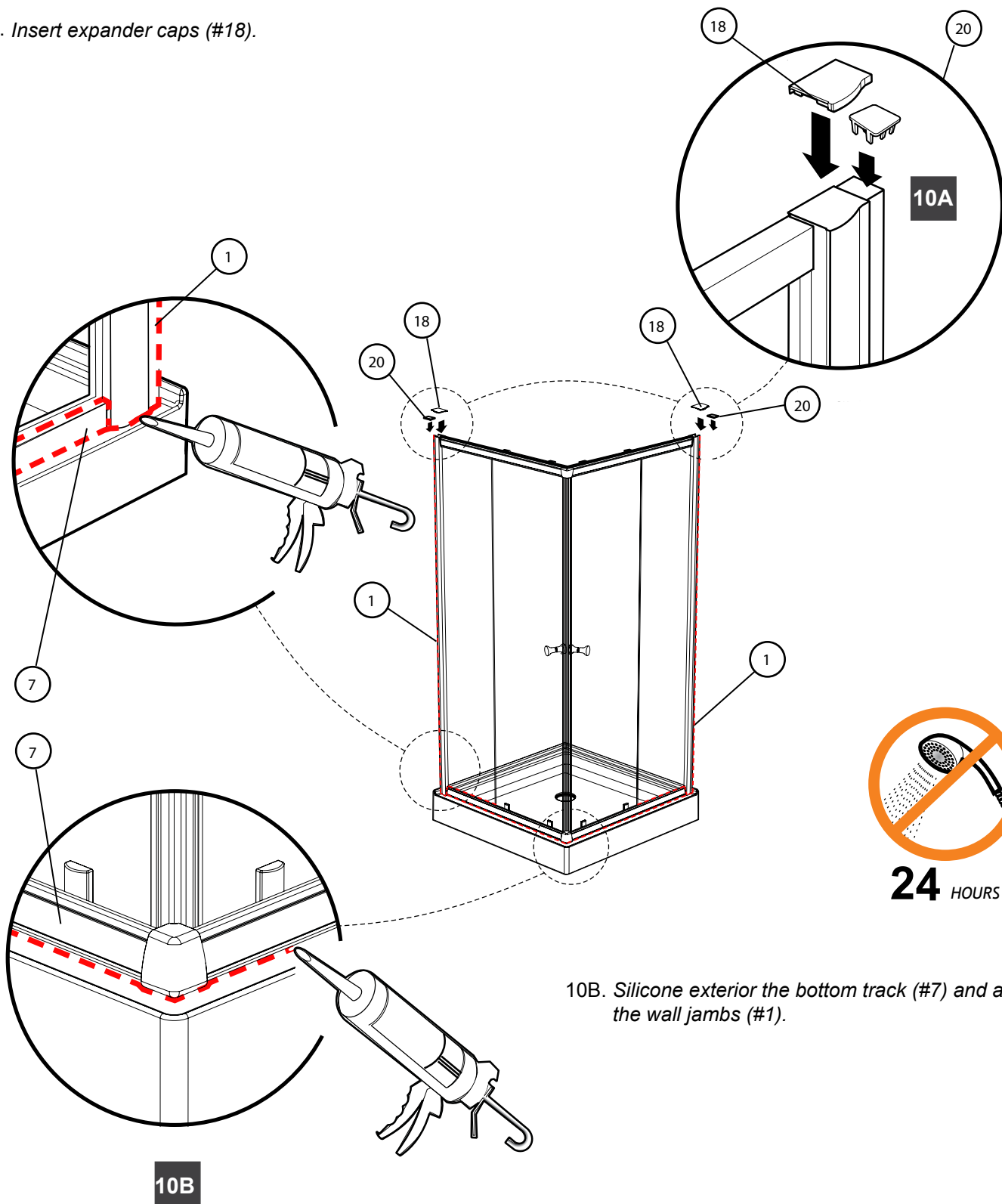

10B. Silicone exterior the bottom track (#7) and along the wall jambs (#1).