

K-STZ | K-STX
K-SSZ | K-SSX - Sunset

INSTRUCTION MANUAL

 **ALUMAX**
Kula Collection

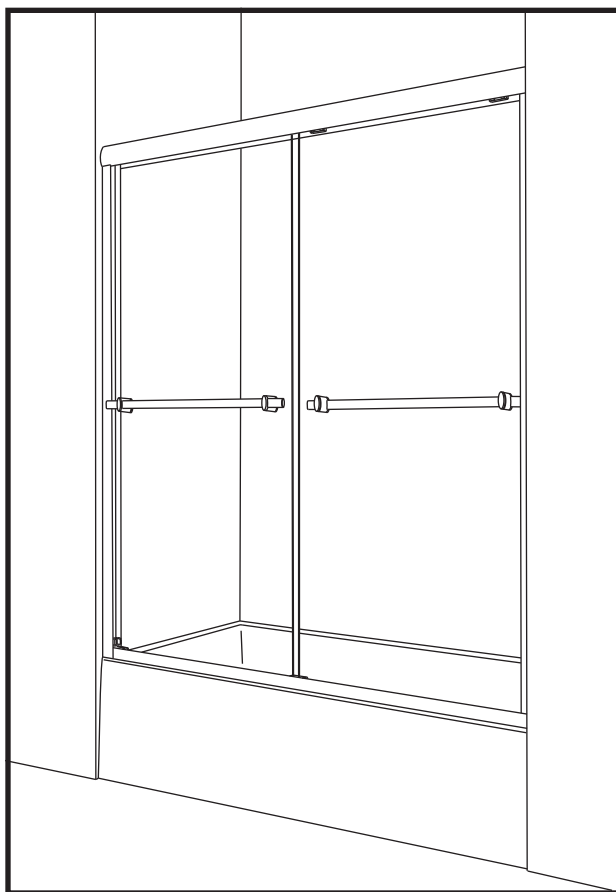
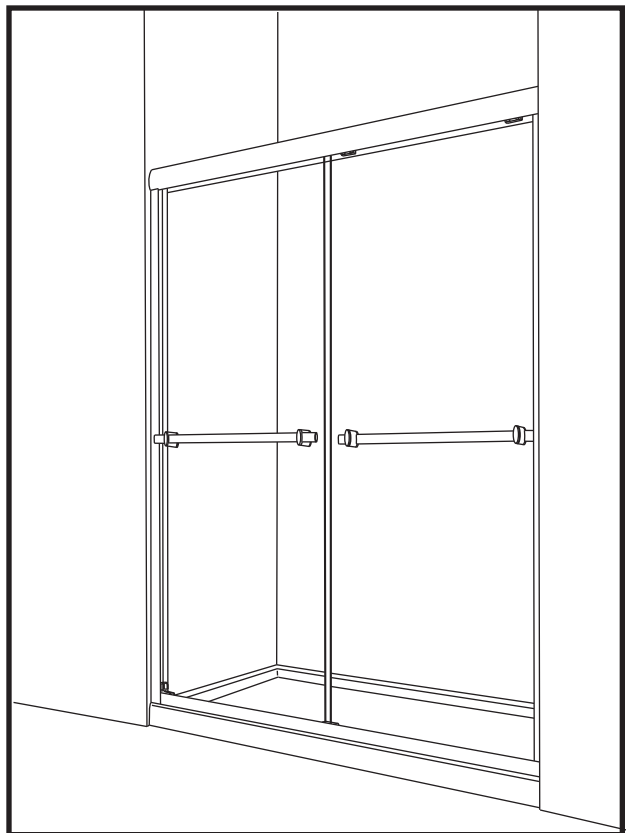

07.10

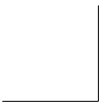
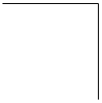

Please keep this manual and product code number for future reference
and replacement parts ordering if necessary.

INSTALLATION INSTRUCTIONS FOR FRAMELESS BATHTUB AND SHOWER DOORS

Congratulations! You have made the right choice in buying this shower system.
We are convinced that you will be entirely satisfied with our product.

READ CAREFULLY AND COMPLETELY BEFORE PROCEEDING

IT IS RECOMMENDED THAT YOU WEAR SAFETY GLASSES AT ALL TIMES DURING INSTALLATION

INSTALLATION OVER CERAMIC TILE

If your shower door is to be installed over ceramic tile, tile should extend completely under both wall jambs. Silicone should be used to seal the line where ceramic tile meets the base.

HOW TO CARE FOR YOUR DOOR

Never use scouring powder pads or sharp instruments on metal work or glass panels. An occasional wiping down with a mild detergent diluted in water is all that is needed to keep the panels and aluminum parts looking new.

Product specifications are subject to change without notice.

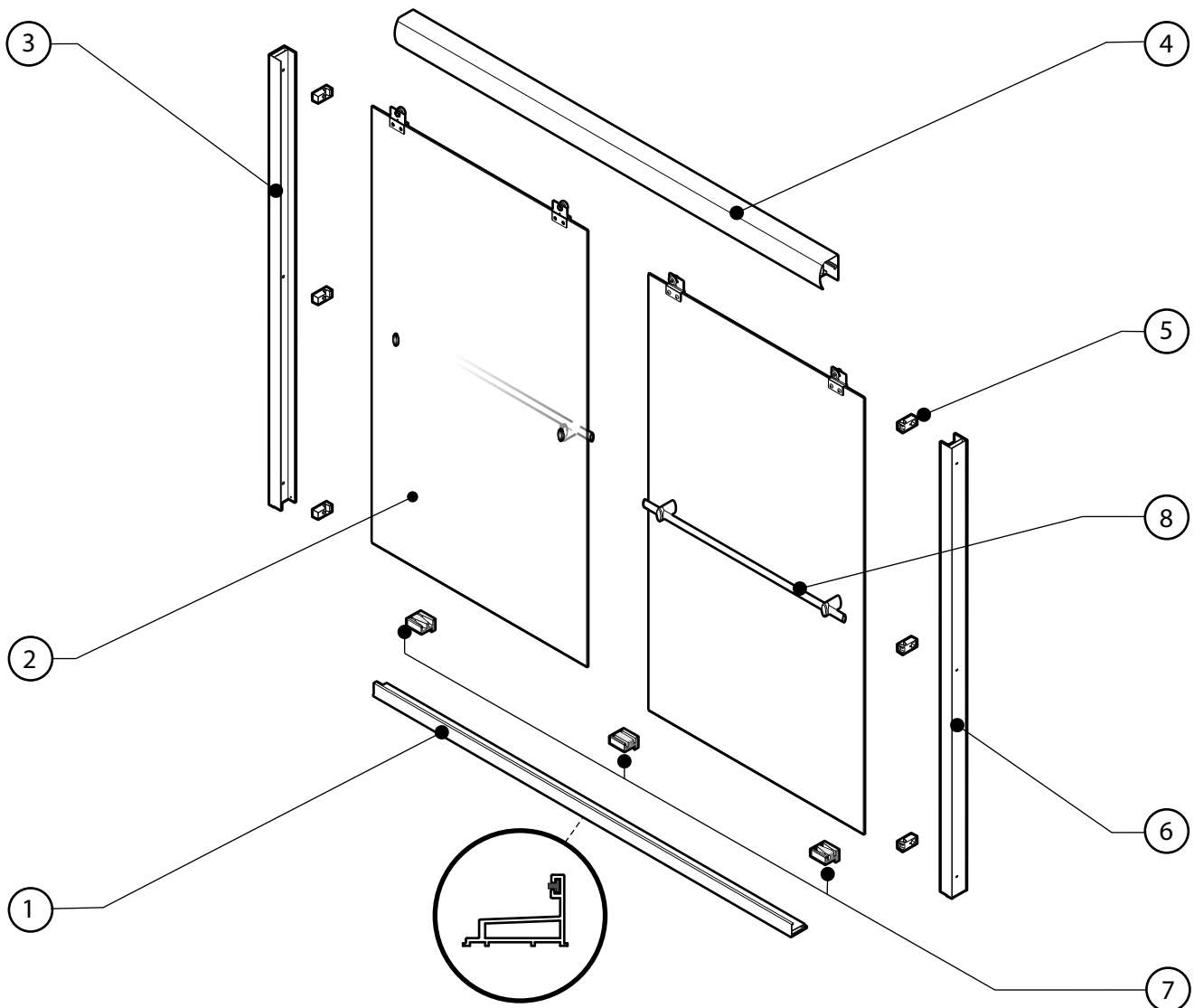

1 BOTTOM TRACK (1)

2 DOOR PANEL (2)

3 LEFT WALL JAMB (1)

4 TOP TRACK (1)

5 BUMPER (6)

6 RIGHT WALL JAMB (1)

7 GUIDE (3)

8 TOWEL BAR (2)

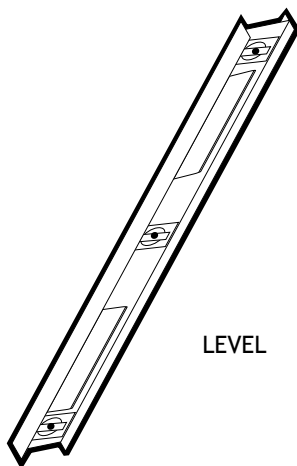

LEVEL

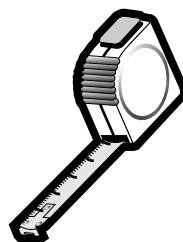

MEASURE TAPE

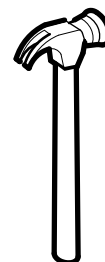

HAMMER

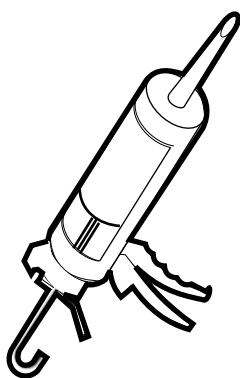

SILICON



SCREWDRIVERS



DRILL



PENCIL

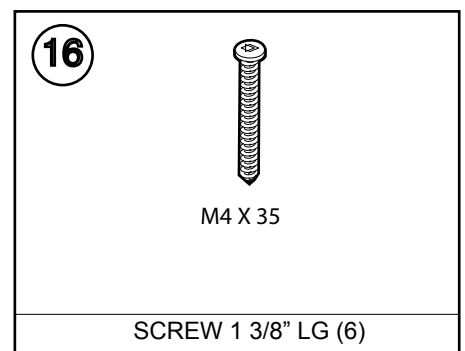
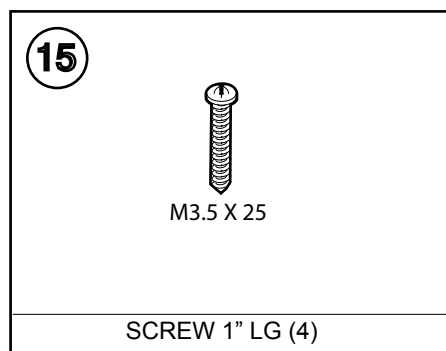
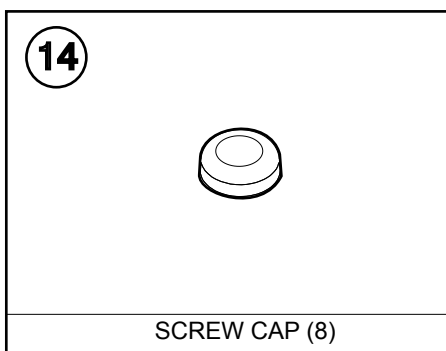
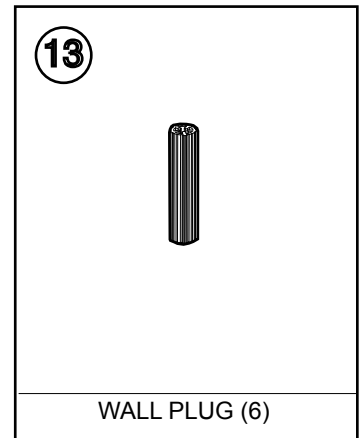
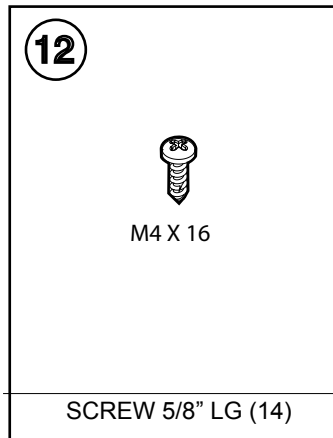
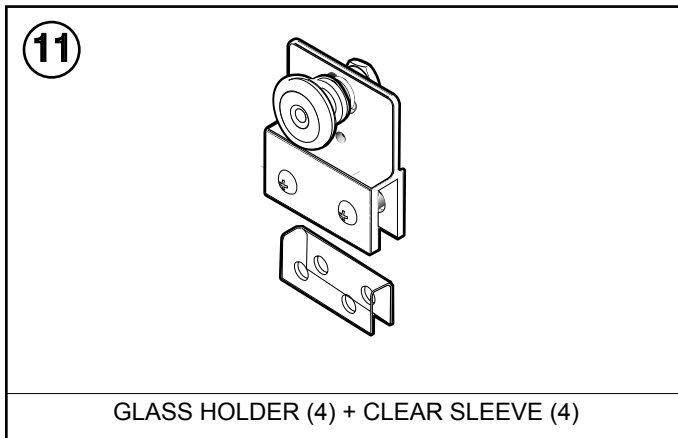
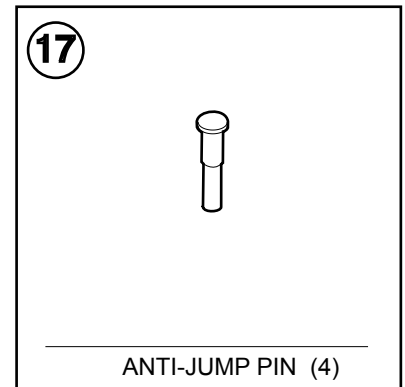
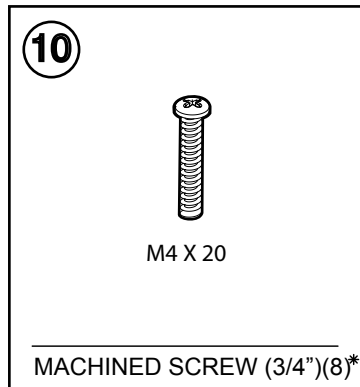
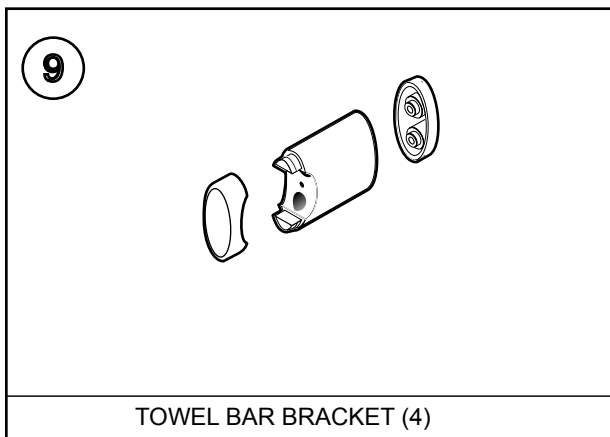
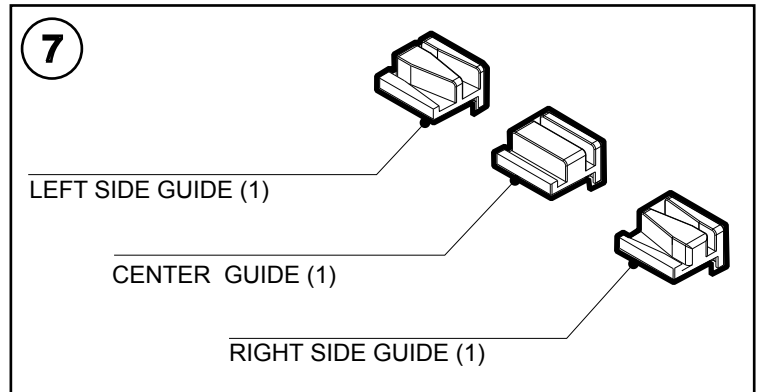
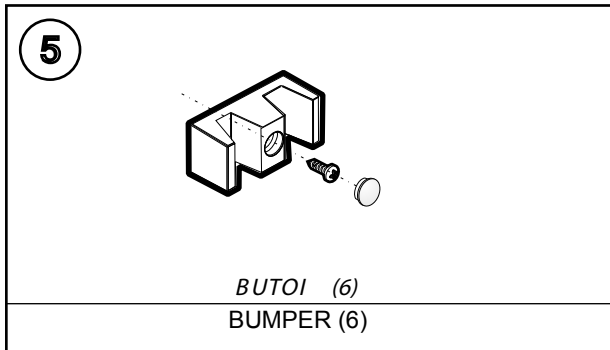

Step
1 INSTALL GLASS HOLDER (4)

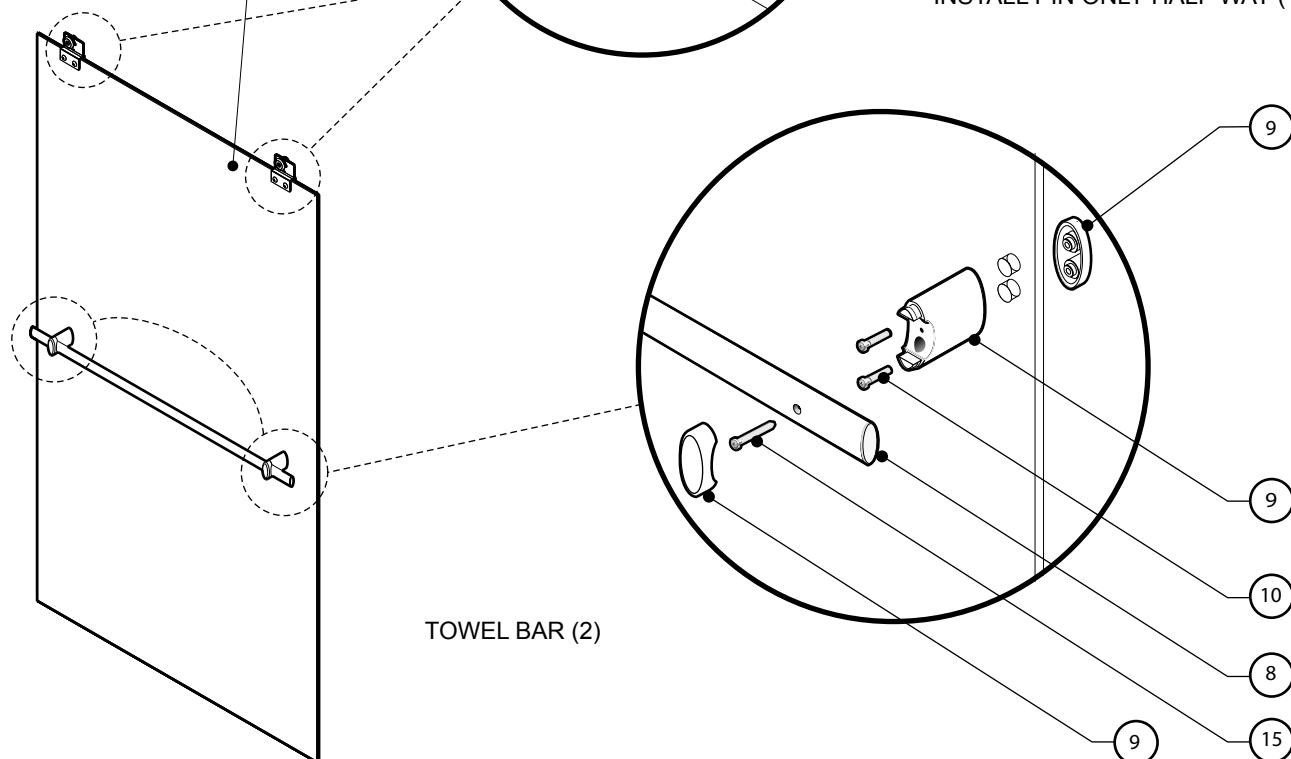
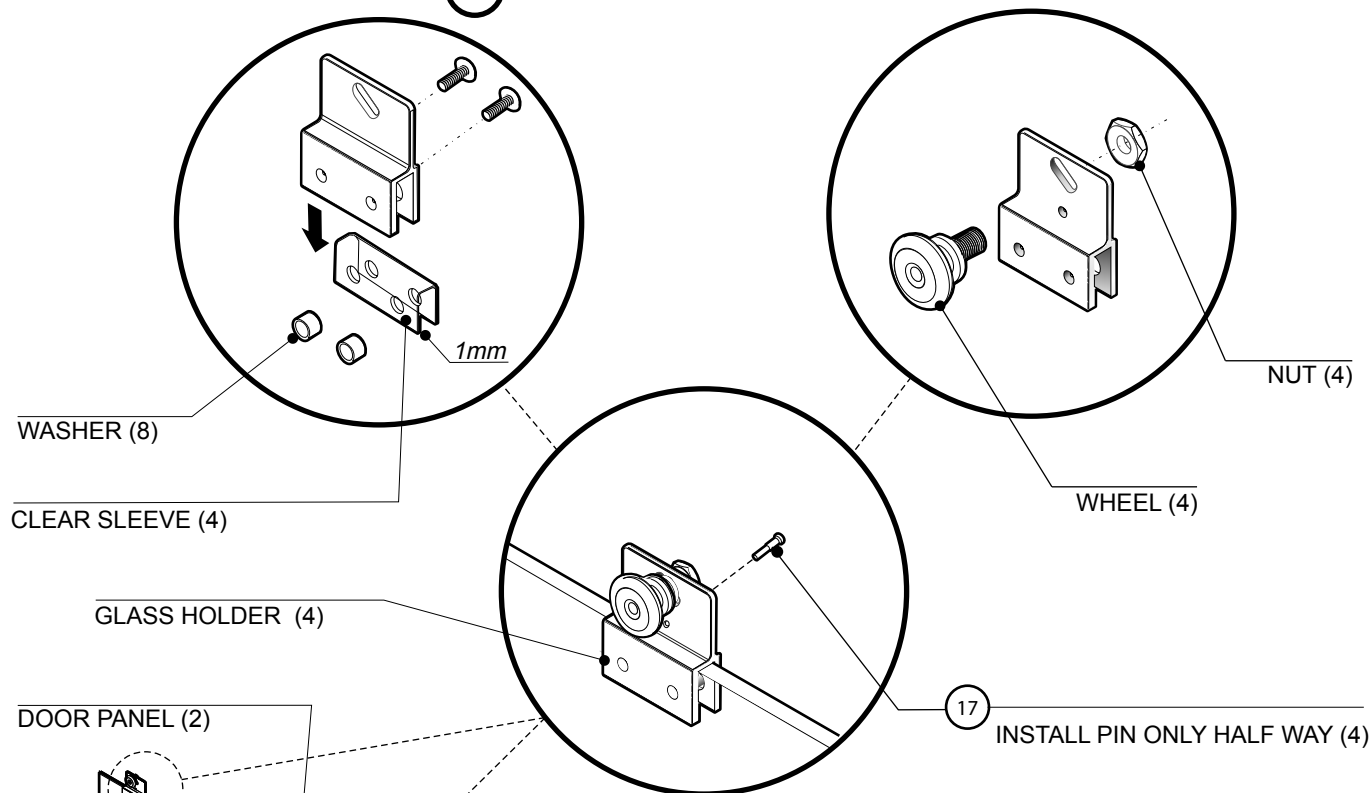

Step
2 INSTALL TOWEL BAR (2)

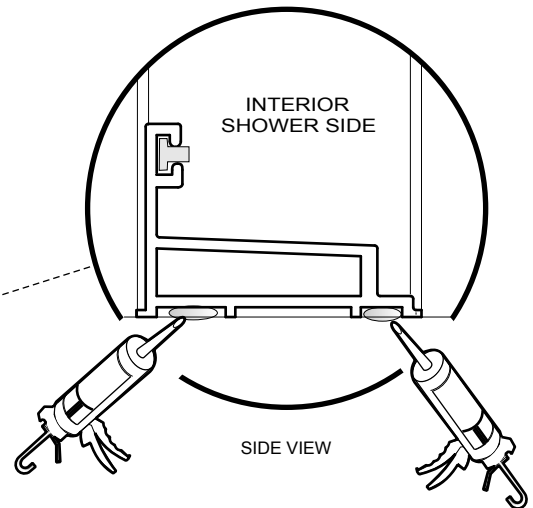
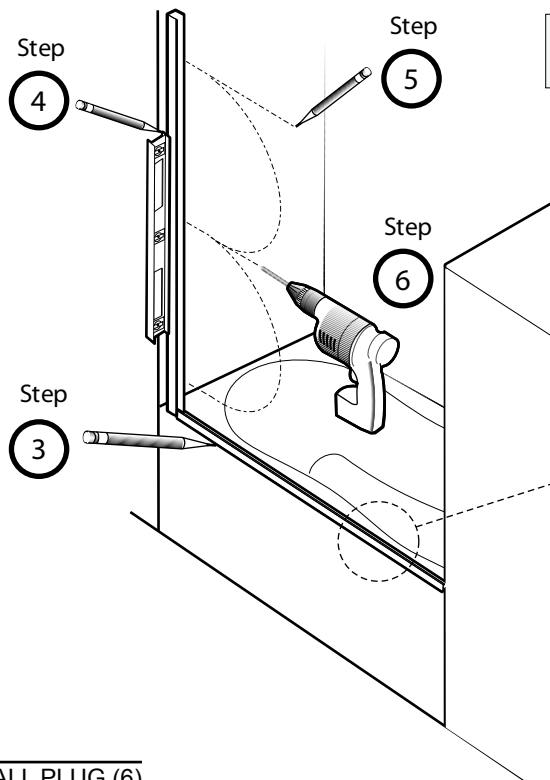

Step 7 BOTTOM TRACK (1) SILICONE UNDERNEATH

Step 8 WALL PLUG (6)

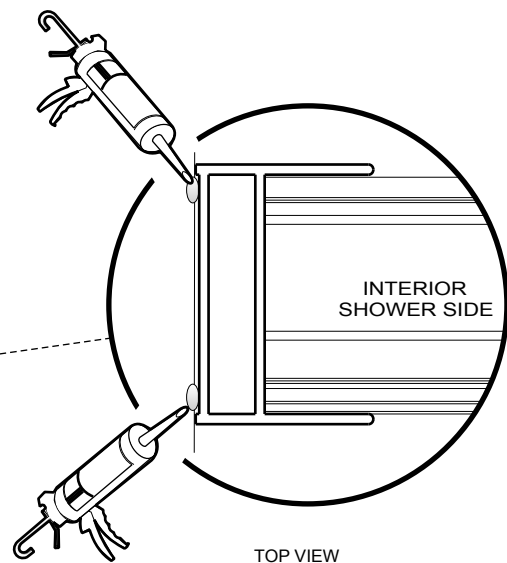
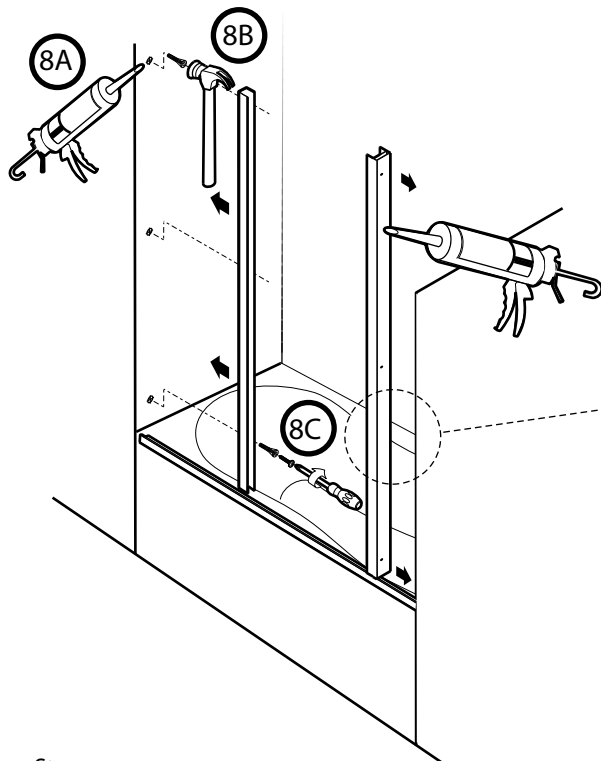

Step 9 WALL JAMB (2) SILICONE ON BACKSIDE

Step 10 SCREW 1 3/8" LG (6) ATTACH BOTH WALL JAMBS

REPEAT ON BOTH SIDES

Step

11

FASTEN BUMPER (6) ONTO BOTH WALL JAMBS WITH 5/8" SCREW

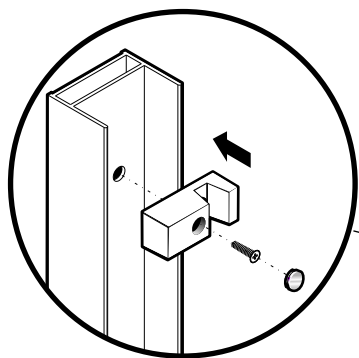

Step

13

PLACE TOP RAIL ON THE WALLJAMBS.

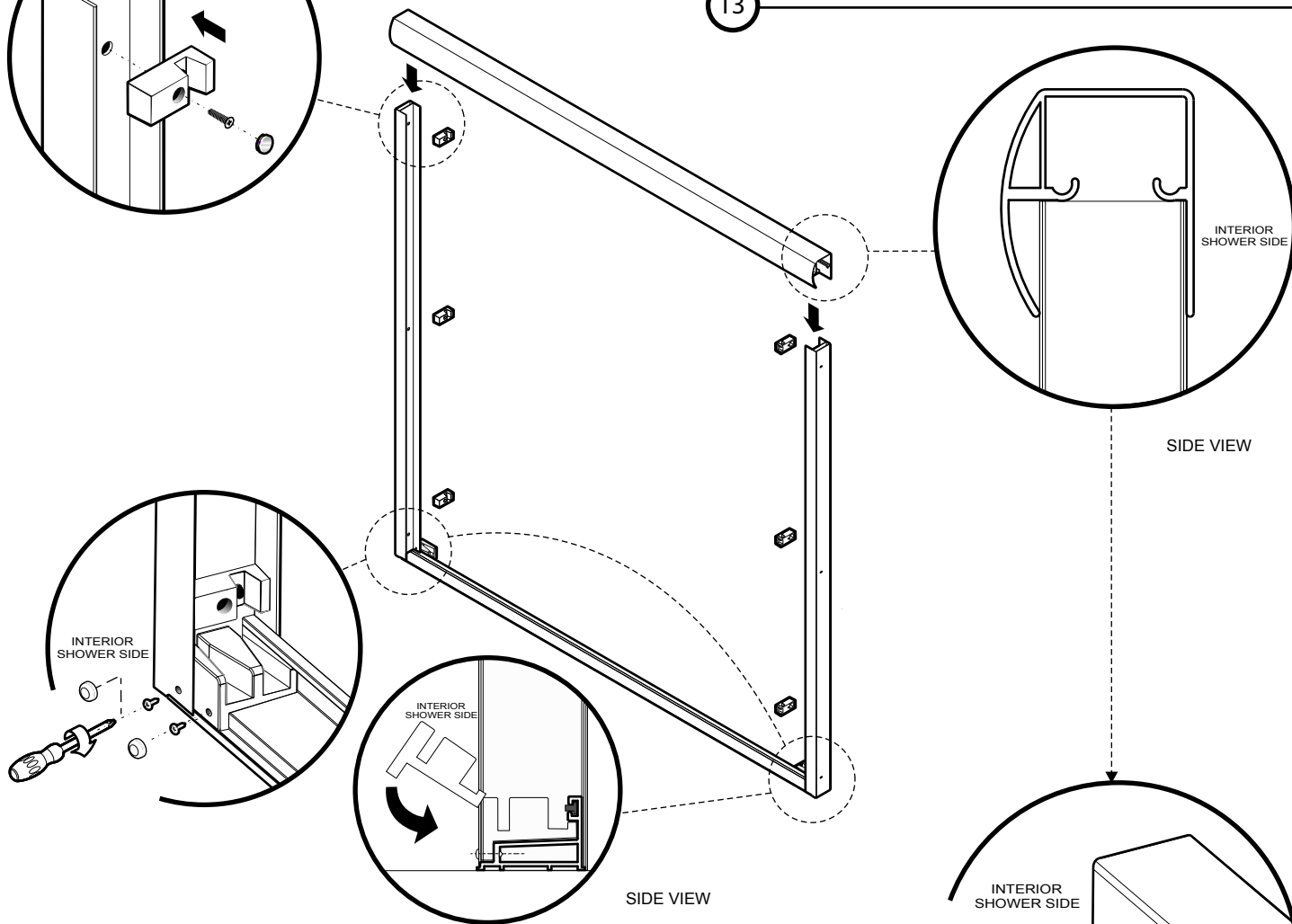

Step

12

- FASTEN SIDE GUIDES (2) ONTO WALL JAMBS
AND BOTTOM TRACK WITH 5/8" SCREW
- PUT SCREW CAP.

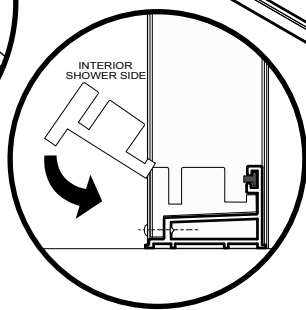
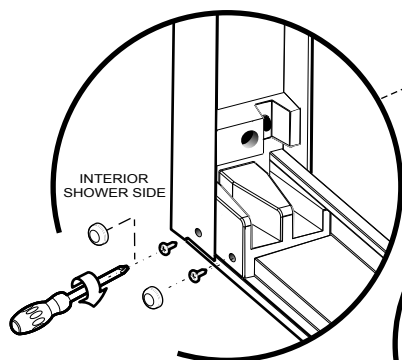

Step

14

- FASTEN TOP TRACK ONTO WALL JAMBS WITH 5/8" SCREW.
- PUT SCREW CAP.

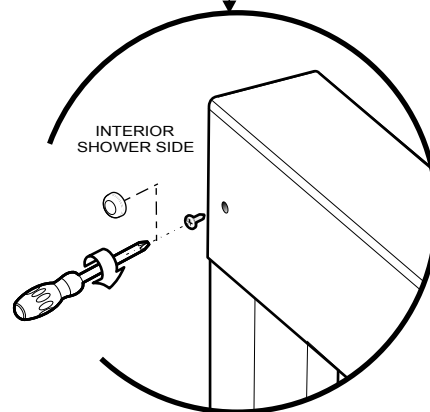

Step

15

INSERT OUTER DOOR PANEL BY LIFTING UP & INTO TOP TRACK

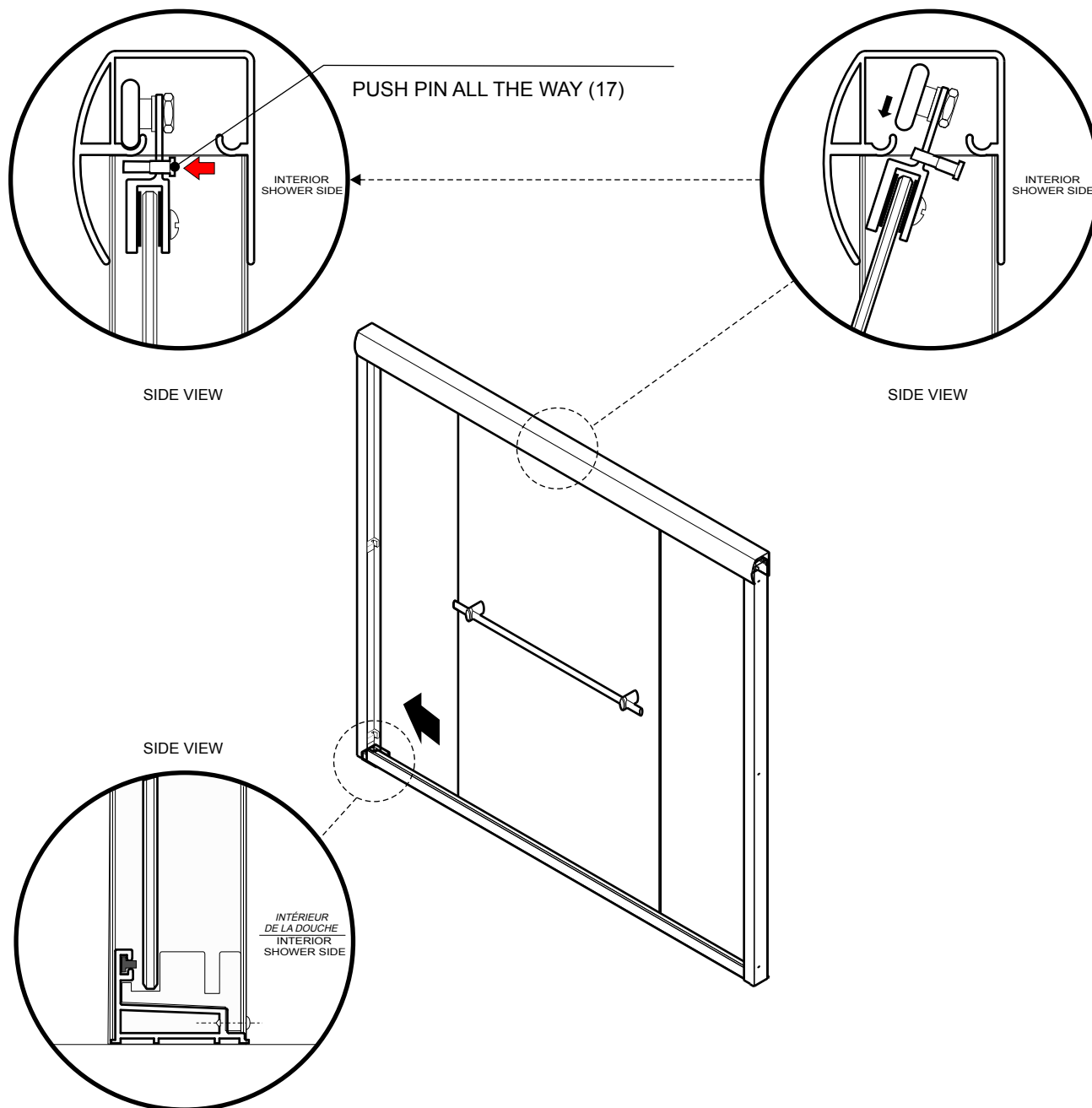

Step

16

SLIDE OUTER PANEL INTO SIDE GUIDE.

Step

17

INSERT INNER DOOR PANEL BY LIFTING UP & INTO TOP TRACK

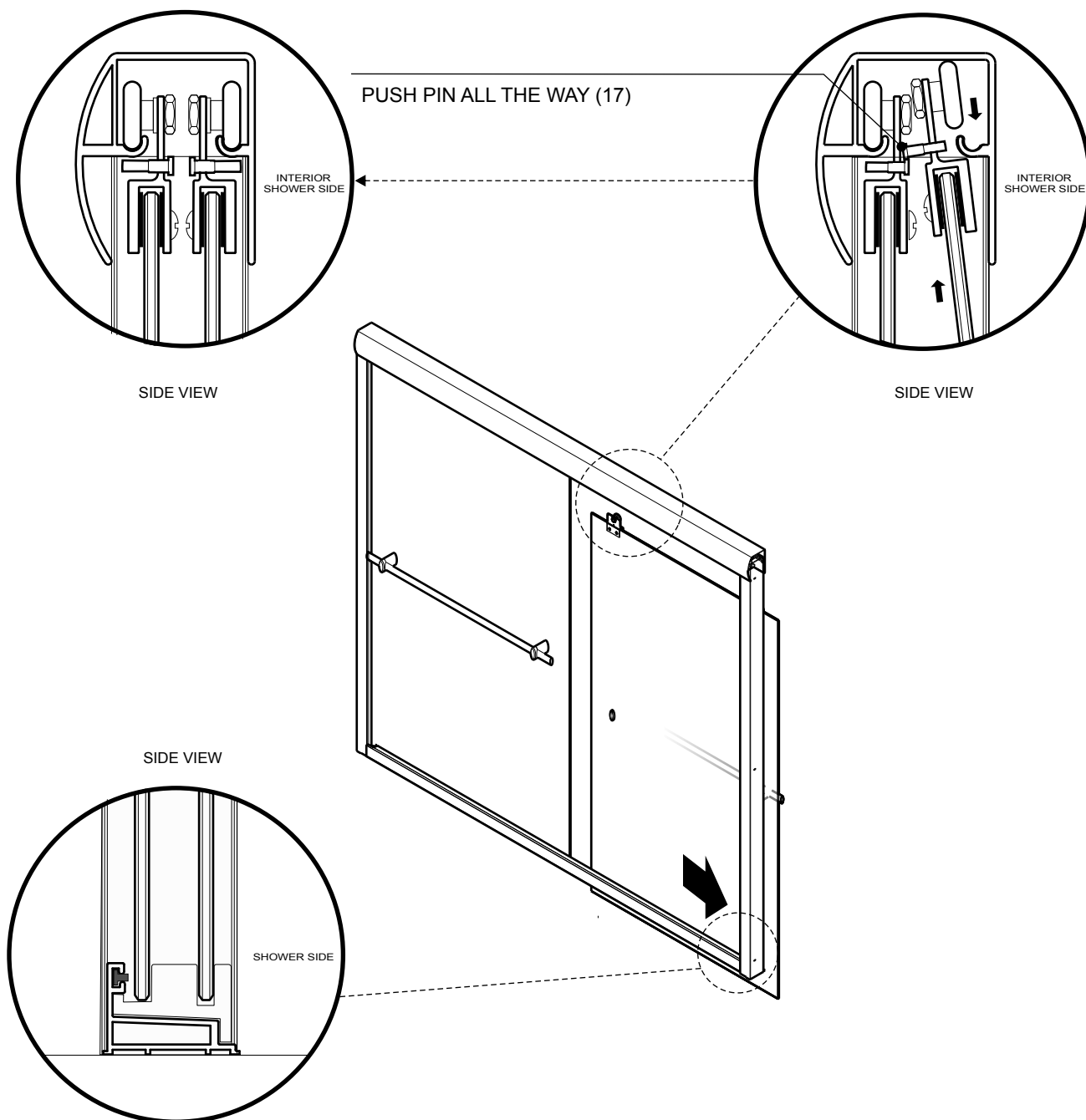

Step

18

SLIDE INNER PANEL INTO SIDE GUIDE.

Step

19

- PUT THE CENTER GUIDE IN THE MIDDLE OF THE BOTTOM TRACK
- FASTEN GUIDE WITH SCREW 3/8" LG (2) + SCREW CAP (2)

