

K-V91Z - Ventura

INSTRUCTION MANUAL

 **ALUMAX**
Kula Collection

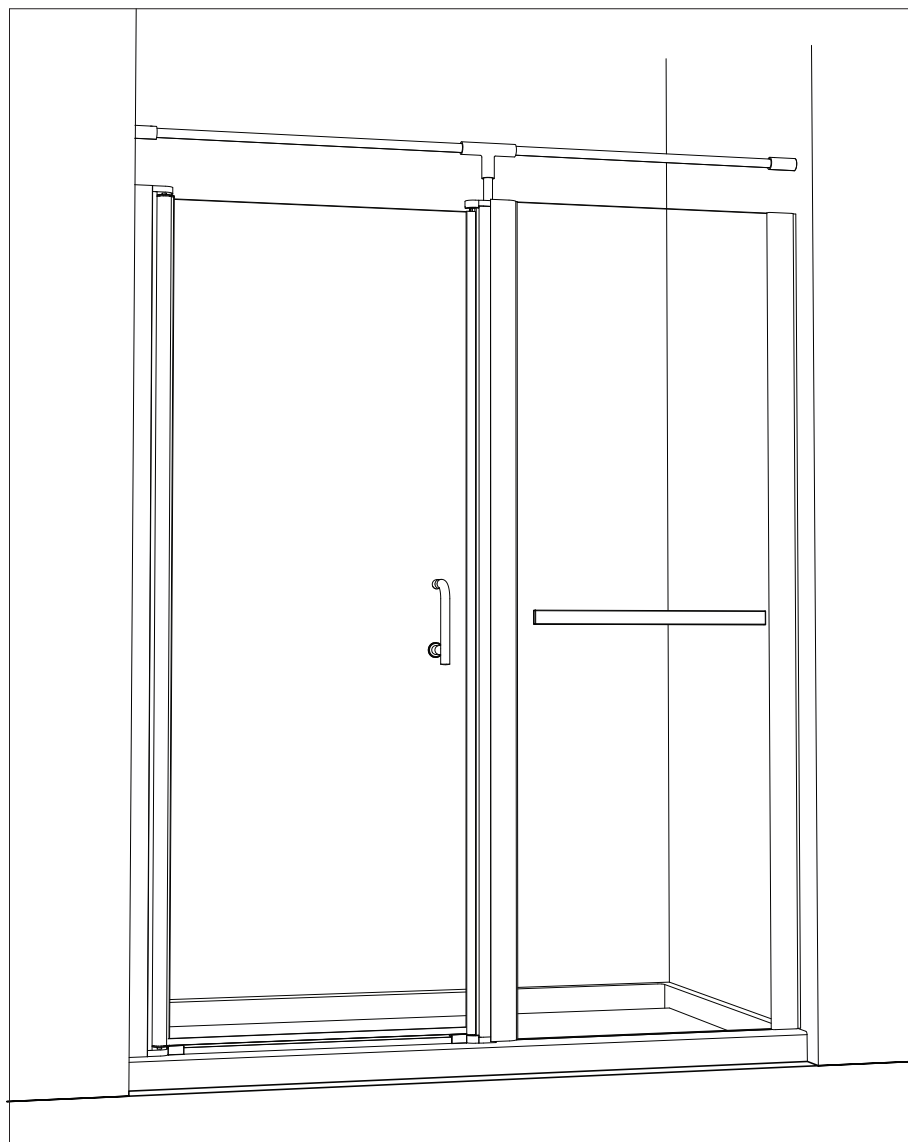

07.10

KV011

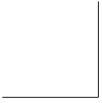

Please keep this manual and product code number for future reference
and replacement parts ordering if necessary.

READ CAREFULLY AND COMPLETELY BEFORE PROCEEDING

IT IS RECOMMENDED THAT YOU WEAR SAFETY GLASSES AT ALL TIMES DURING INSTALLATION

INSTALLATION OVER CERAMIC TILE

If your shower door is to be installed over ceramic tile, tile should extend completely under both wall jambs. Silicone should be used to seal the line where ceramic tile meets the base.

HOW TO CARE FOR YOUR DOOR

Never use scouring powder pads or sharp instruments on metal work or glass panels. An occasional wiping down with a mild detergent diluted in water is all that is needed to keep the panels and aluminum parts looking new.

Product specifications are subject to change without notice.

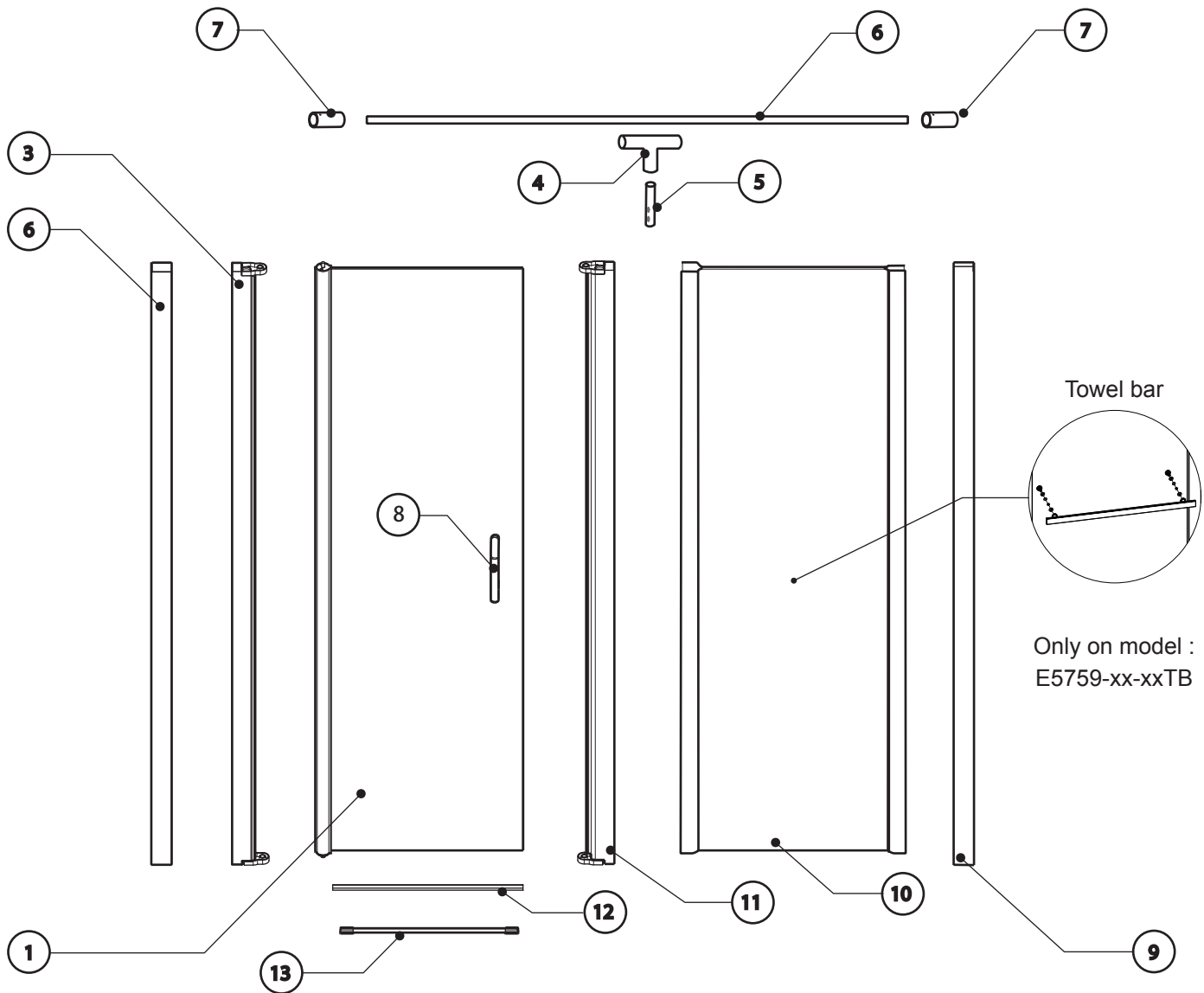

1 DOOR PANEL (1)

2 WALL JAMB "A" (1)

3 PIVOT SIDE COLUMN (1)

4 CONNECTOR "T" (1)

5 SHORT SUPPORT BAR (1)

6 SUPPORT BAR (1)

7 WALL BRACKET (2)

8 SET OF HANDLES (1)

9 WALL JAMB "B" (1)

10 FIXED PANEL (1)

11 MAGNET COLUMN (1)

12 BOTTOM DOOR GASKET (1)

13 THRESHOLD (1)

REQUIRED TOOLS LIST

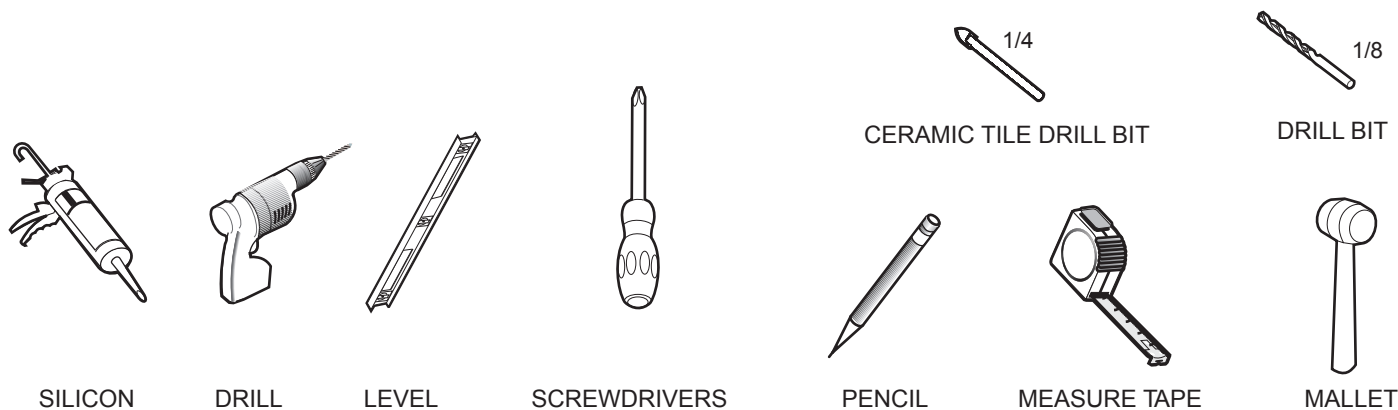

PACKAGING CHECK LIST & HARDWARE

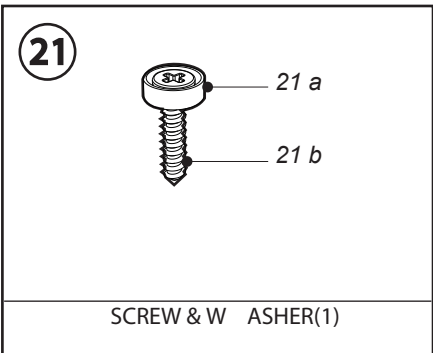
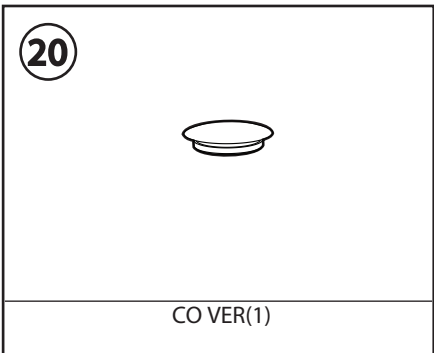
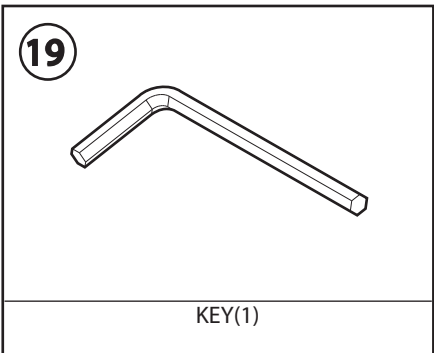
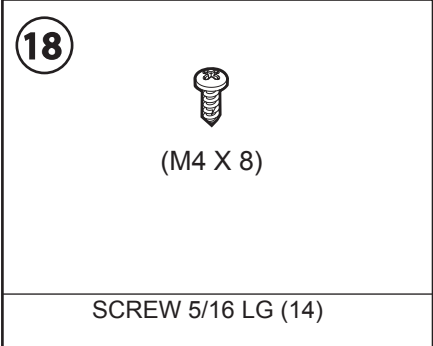
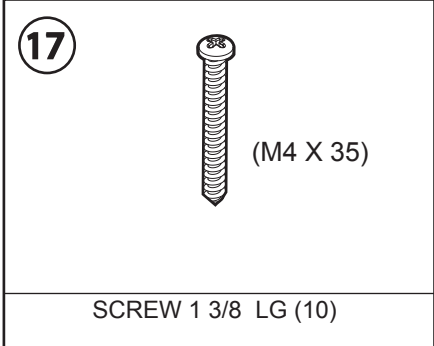
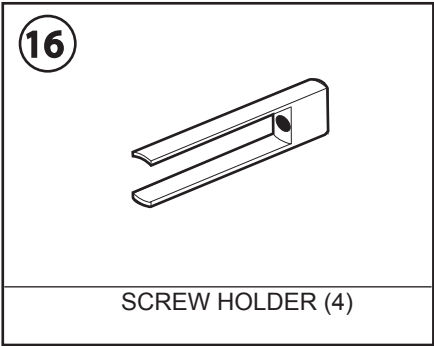
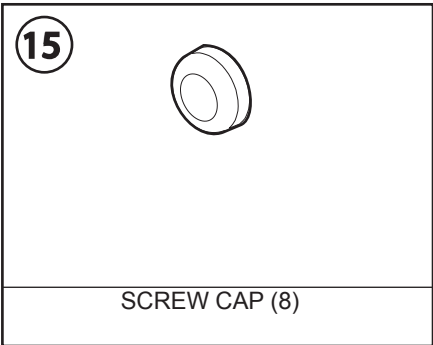
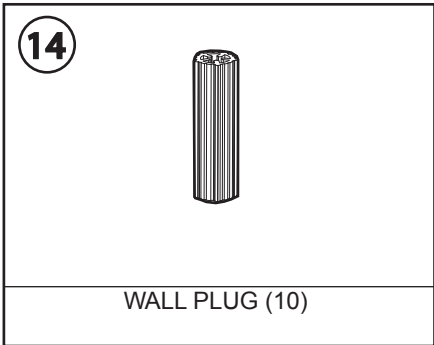
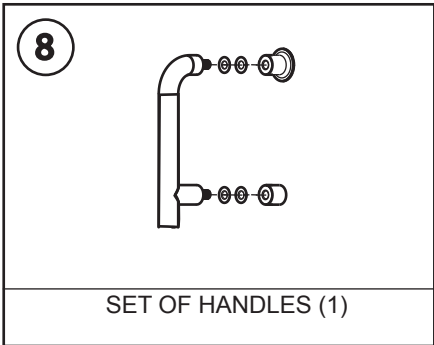

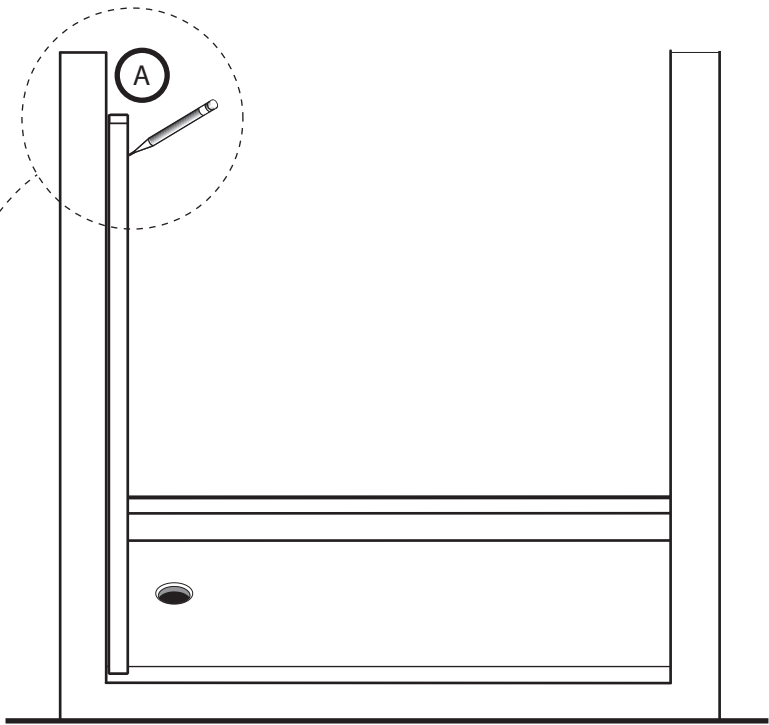

Step
1 WALL JAMB "A" (1)

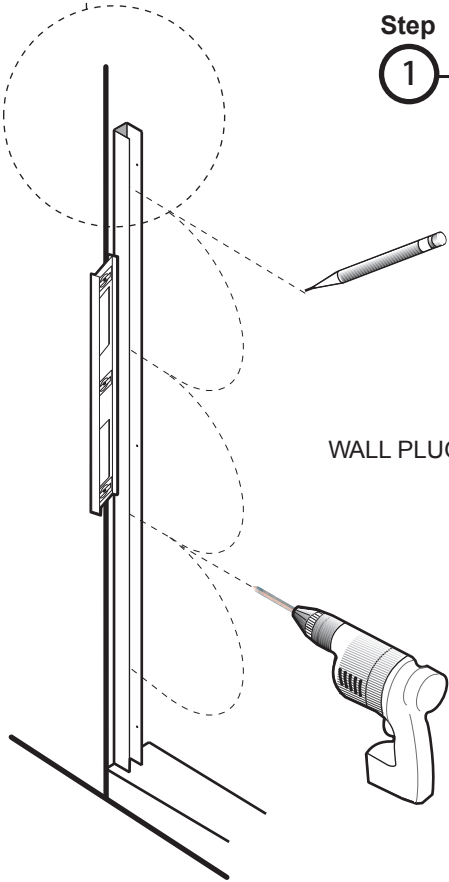

WALL PLUG (4) + SCREW 1 3/8LG (4)

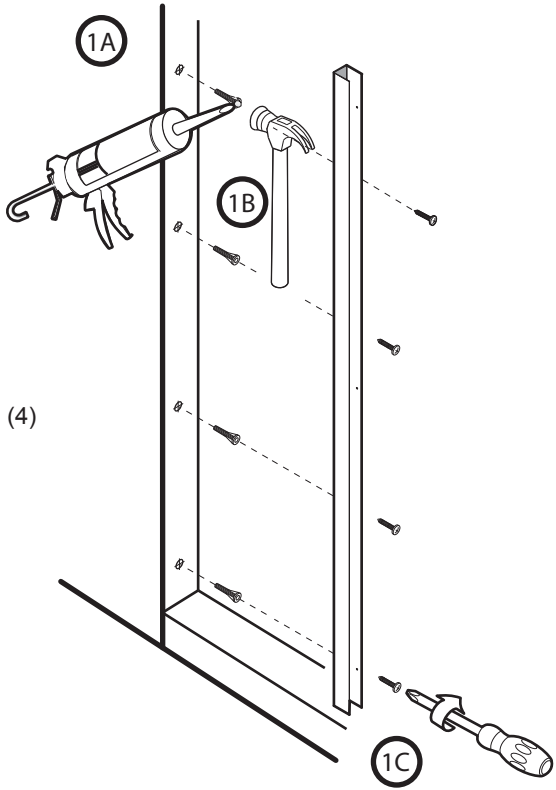

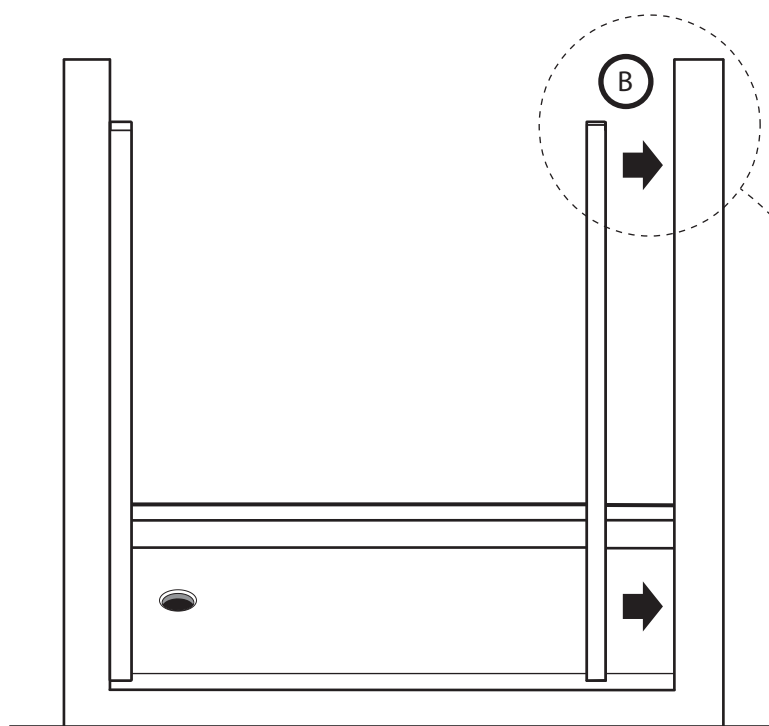

Step
2 WALL JAMB "B"

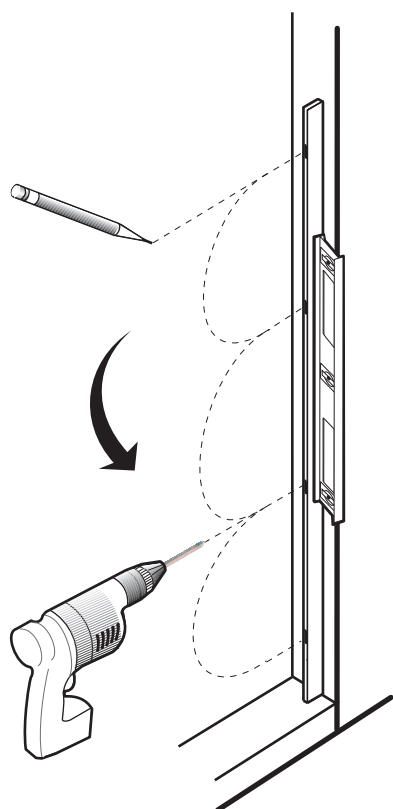

WALL PLUG (4) + SCREW 1 3/8LG (4)
+ SCREW HOLDER(4)

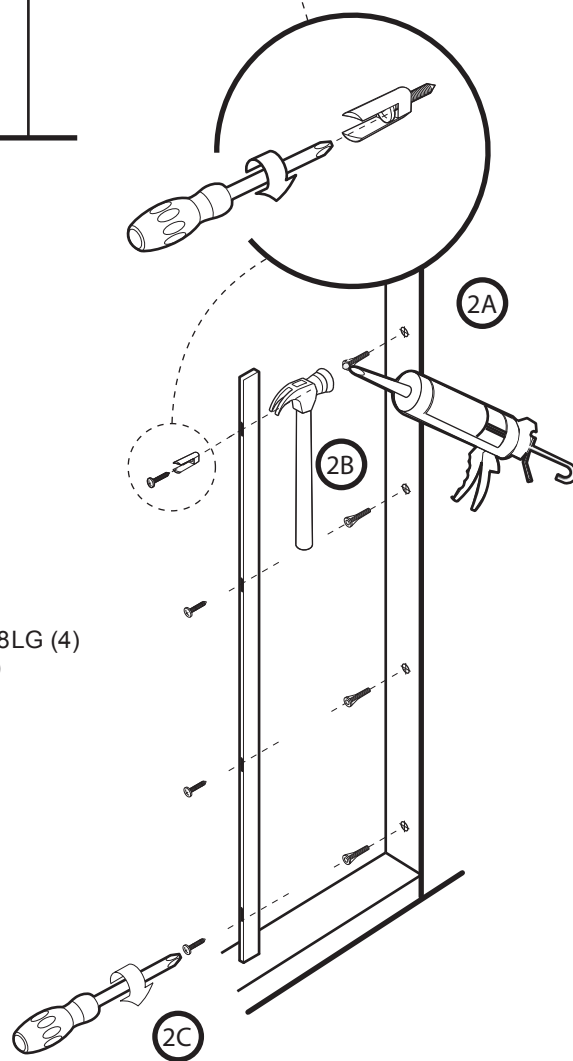

Step
3

FIXED PANEL (1)

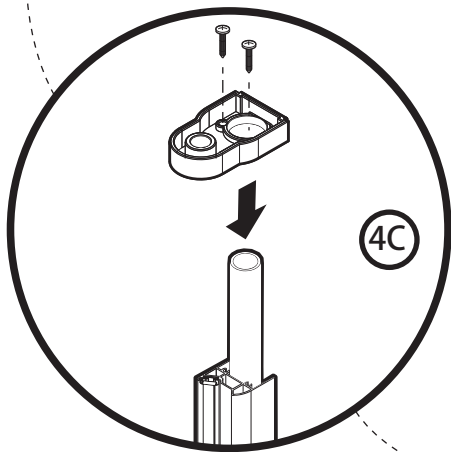
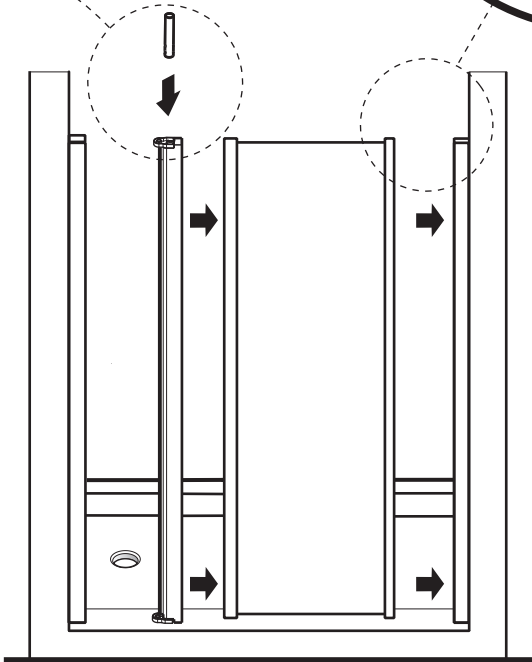
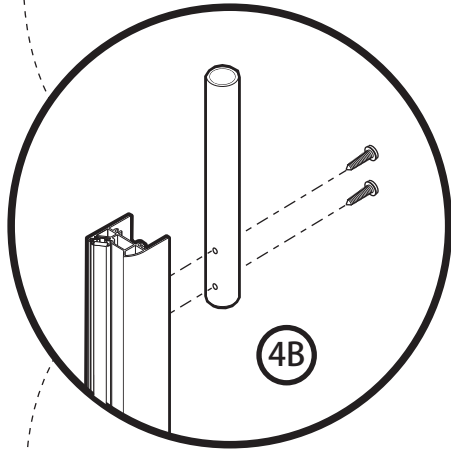
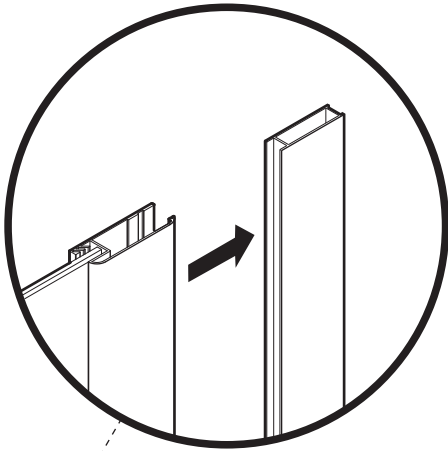
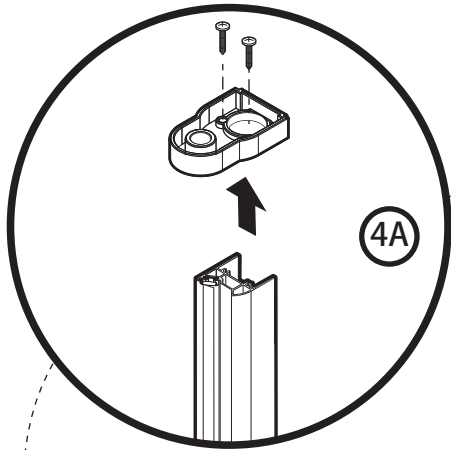

MAGNET COLUMN (1)

Step
4

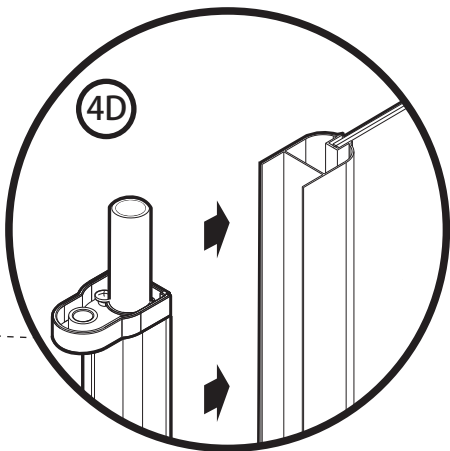

5 DOOR PANEL (1)

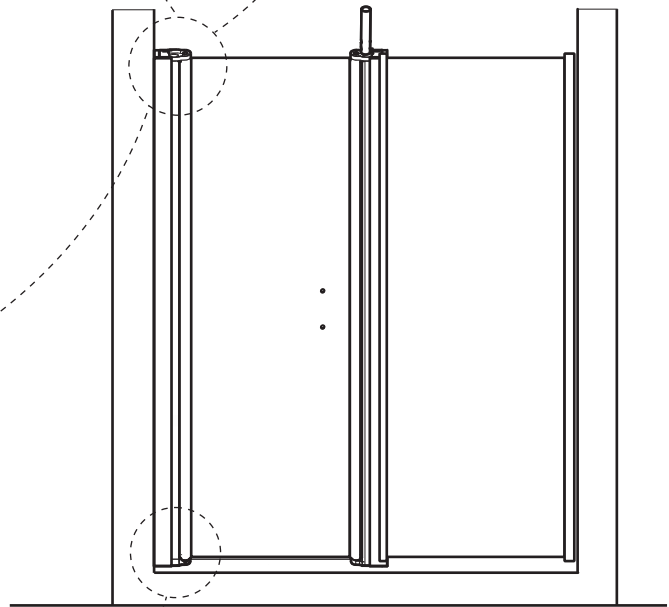
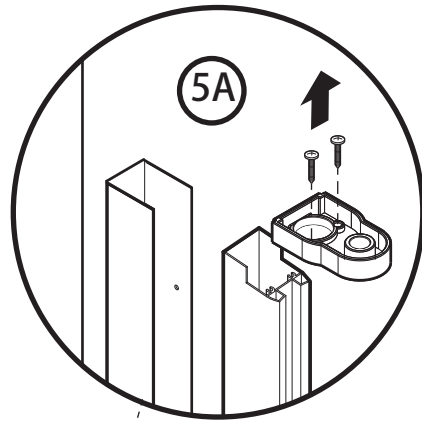
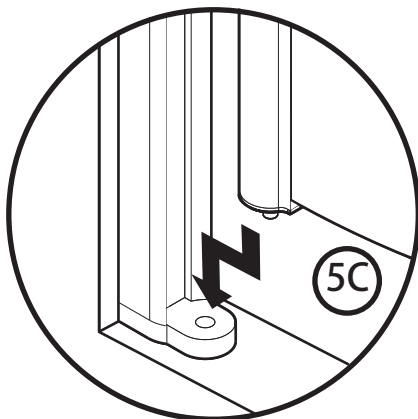
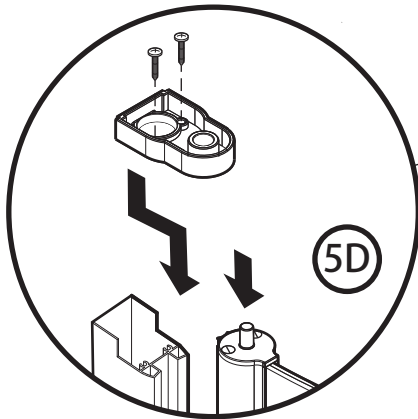
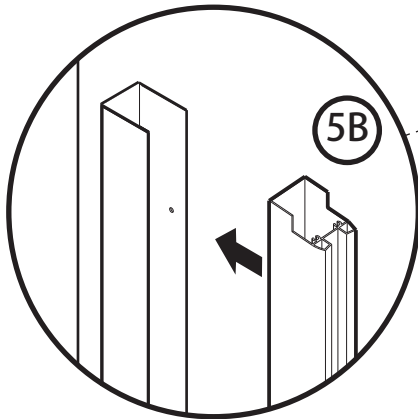

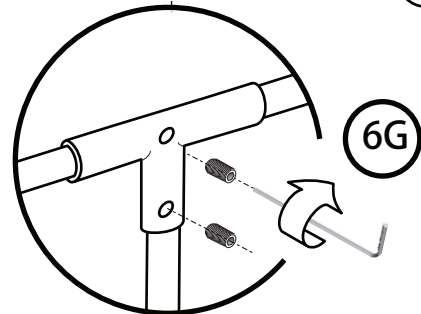
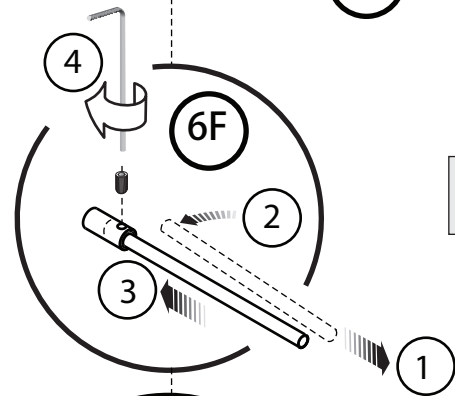
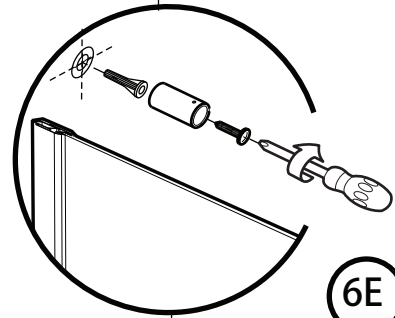
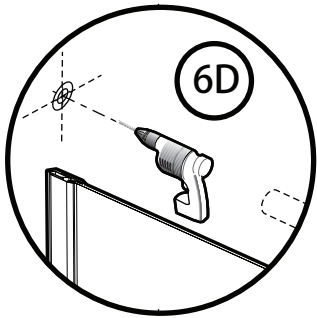
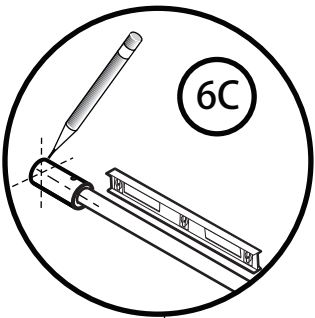

Step

6

"T" CONNECTOR (1) + CENTER SUPPORT BAR (1) + WALL BRACKET (2)

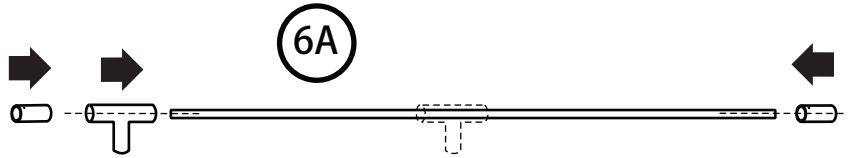

ON BOTH SIDES

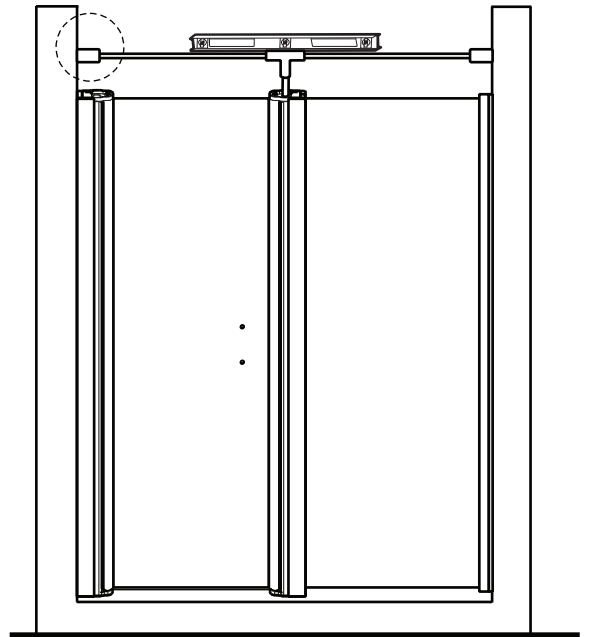
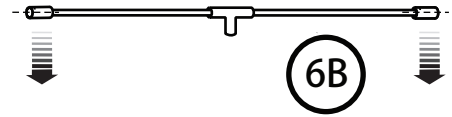

INTERIOR
SHOWER SIDE

Step
7

- USING A DRILL BIT Ø 1/16" DRILL INTO THE BASE THROUGH THE PIVOT SUPPORT.
- PUT A BEAD OF SILICON INSIDE THE HOLE.
- SCREW IN THE PROVIDED RETAINER PIECE.
- ADD THE COVER.

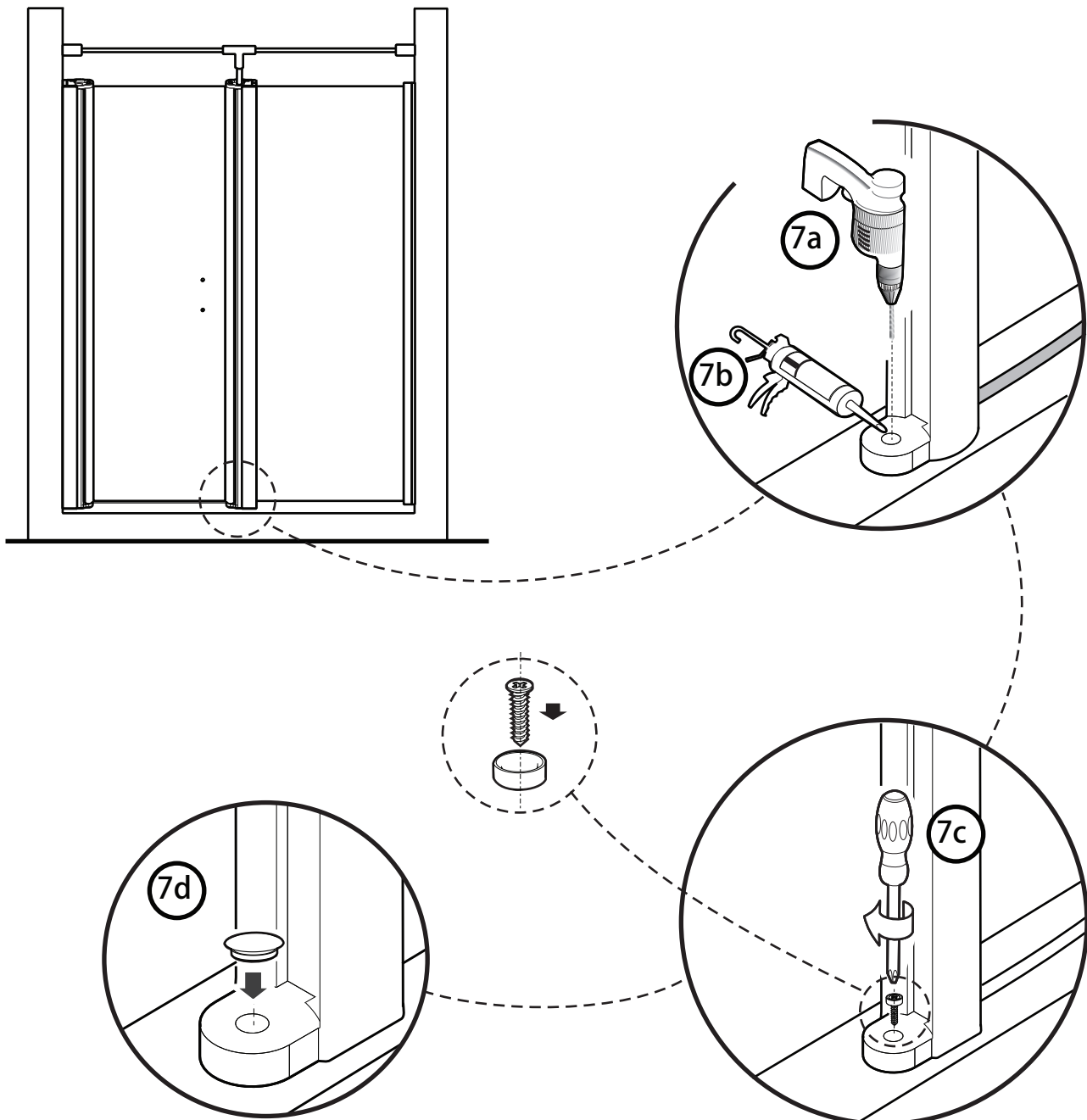

Step

8 SET OF HANDLES (1)

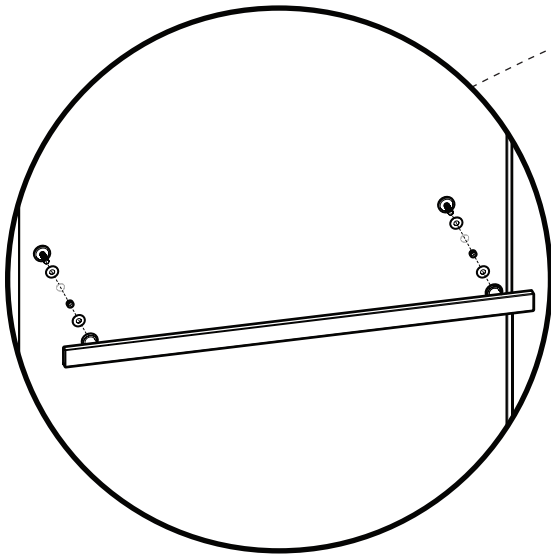
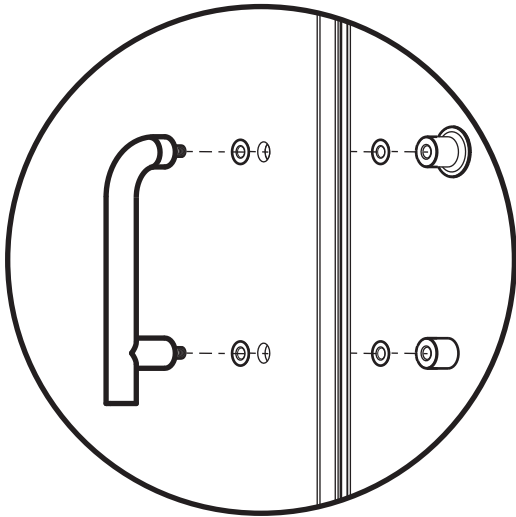

Towel bar applicable only on some models.

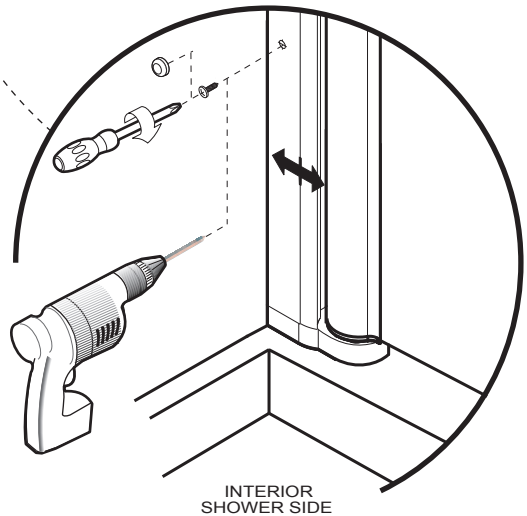
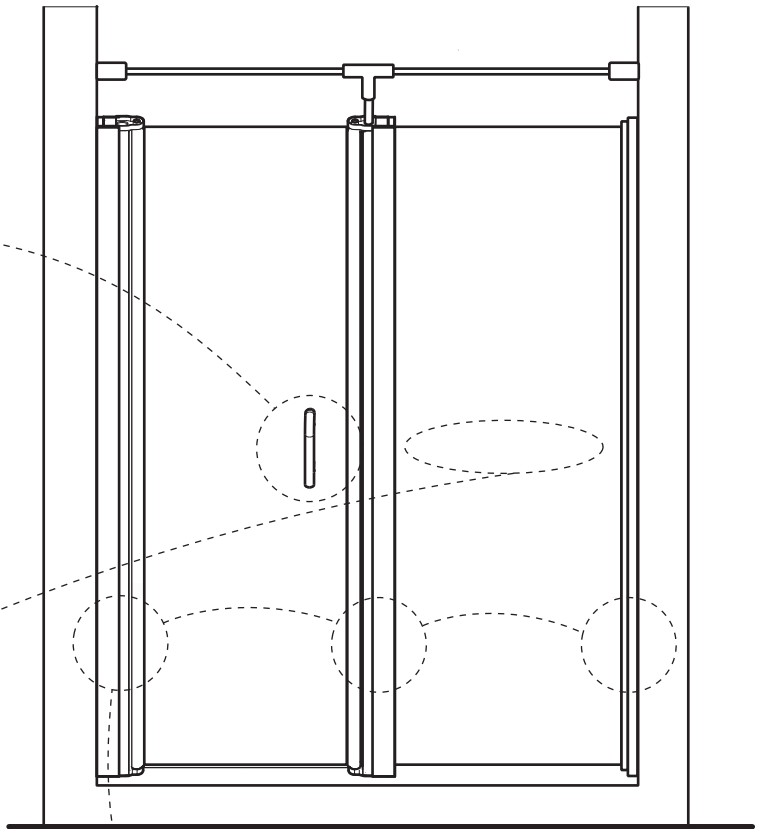

Step

9 SCREW 5/16" LG (12) / SCREW COVER (12)

