

**L-301X-24, L-302X-24**



**L-301X-32, L-302X-32**



**L-421X-32, 422X-32**



**L-421TBX-32, L-422TBX-32**

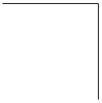

Please keep this manual and product code number for future reference  
and replacement parts ordering if necessary.



2 PEOPLES REQUIRED

#### GENERAL INSTRUCTIONS

- Read this manual carefully and completely before proceeding.
- It is recommended that you wear safety glasses at all times during the installation.

#### INSTALLATION OVER CERAMIC TILES

- Silicone should be used to seal the gap where the ceramic tiles meet the fixed panel.
- If your shower door is to be installed over ceramic tiles, the tiles should lay completely under the wall jamb.

#### NOTICE

- Caulking: no sealant is required inside the shower Unless otherwise stated.
- Some models are equipped with clear sealing gaskets.

#### CARE FOR YOUR SHOWER DOOR

- Never use scouring powder pads or sharp instruments on metal pieces or glass panels.  
An occasional wiping down with a mild soap diluted in water is all that is needed to keep the panels and aluminum parts looking new.
- We recommend wiping the glass panels with a squeegee after each use.

Product specifications are subject to change  
without notice.

301X-24, 302X-24

PARTS LISTING

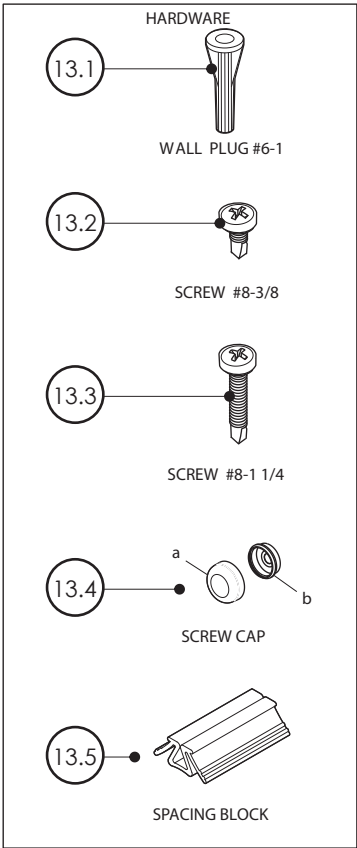
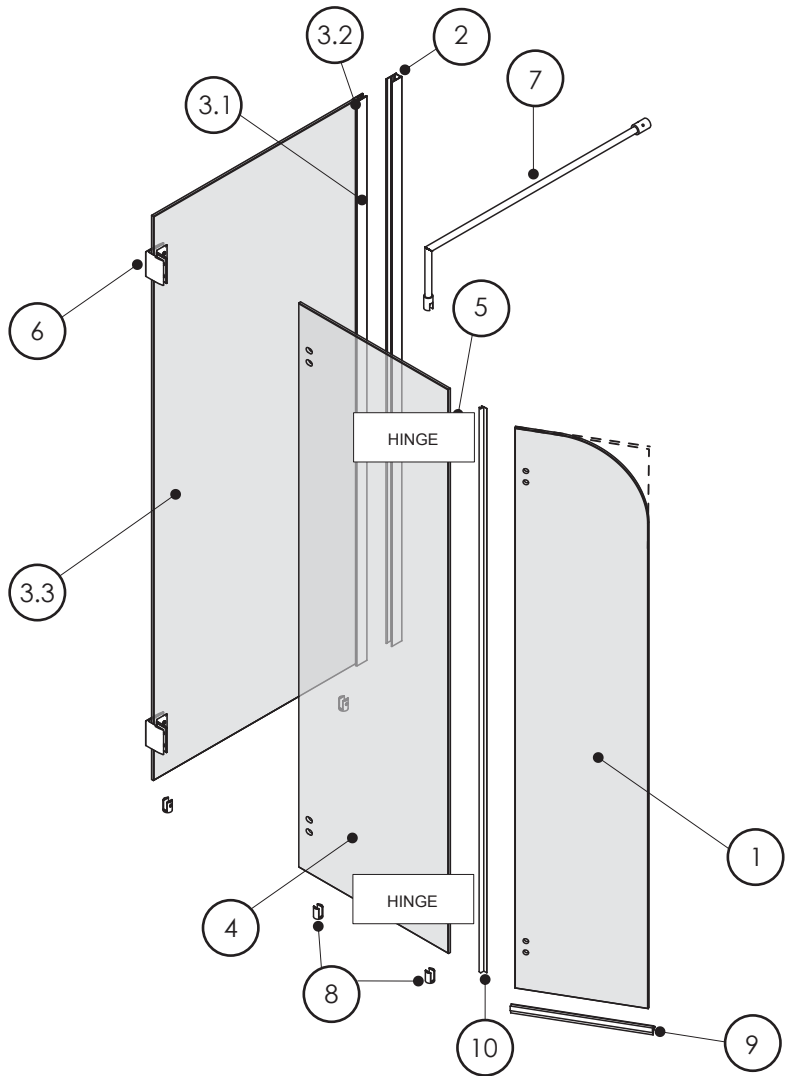

ITEM #	PARTS	QTY
1	DOOR PANEL	1
2	WALL JAMB	1
3.1	EXPANDER	1
3.2	GASKET	1
3.3	RETURN PANEL	1
4	FIXED PANEL	1
5	HINGE	2
6	CORNER CLIP	2
7	SUPPORT BAR	1
8	BOTTOM GLASS CLIP	4
9	BOTTOM DOOR GASKET	1
10	SIDE GASKET	1
13	HARDWARE	
13.1	WALL PLUG #6-1	3
13.2	SELF DRILLING SCREW #8-3/8	3
13.3	SELF DRILLING SCREW #8-1 1/4	4
13.4	SCREW CAP #8/8	4
13.5	SPACING BLOCK	2

301X-24, 302X-24

## TOOLS AND MATERIALS REQUIRED



LONG NOSE LOCKING PLIER



SCREWDRIVERS

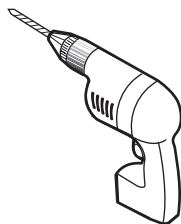

DRILL

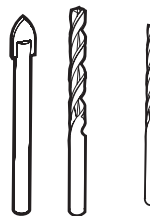

Ø1/4" & Ø1/8" DRILLBITS

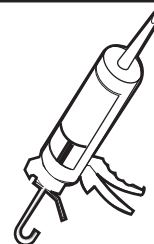

SILICONE

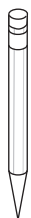

PENCIL

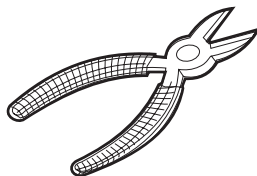

CUTTING PLIER

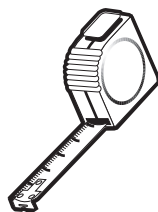

TAPE MESURE

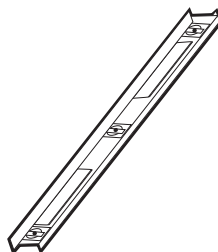

LEVEL



MALLET

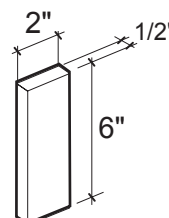

BLOCK

## INSTALLATIONS OF COMPONENTS

Return panel  
Bottom clips



see page 9-10

Support bar

see page 13-14

Hinges  
Door panel

see page 16

Side gasket  
Door bottom

see page 15

Front panel  
Corner clips  
Bottom clips

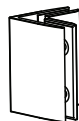

see page 1 1-12

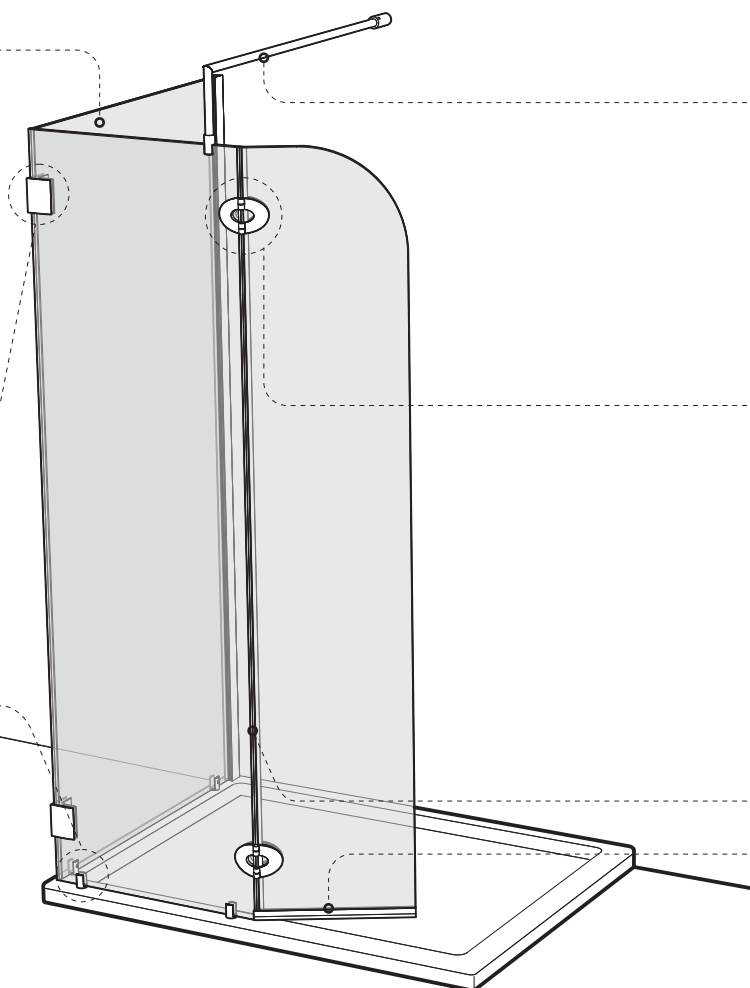

301X-32, 302X-32

# PARTS LISTING

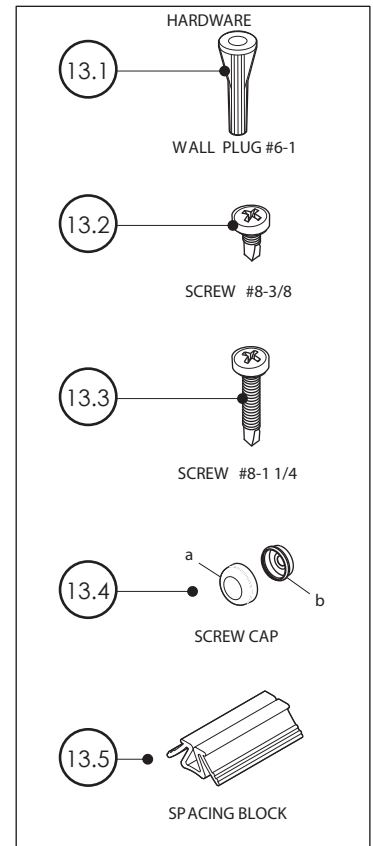
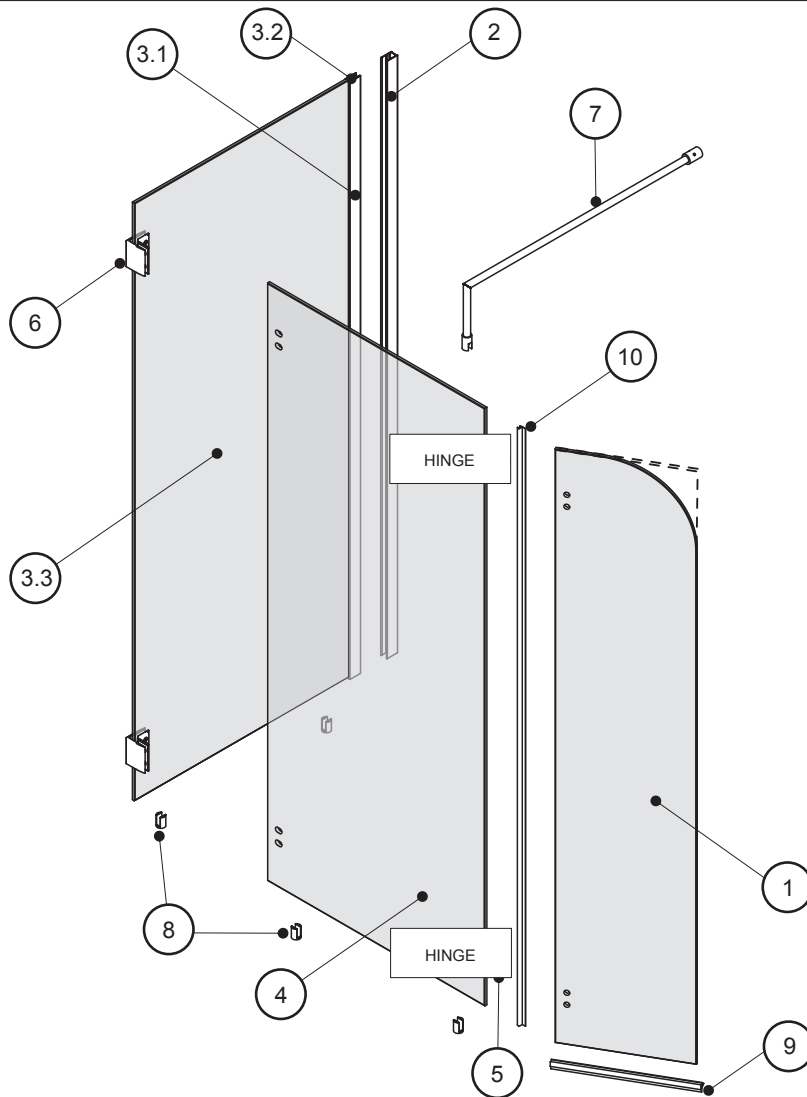

ITEM #	PARTS	QTY
1	DOOR PANEL	1
2	WALL JAMB	1
3.1	EXPANDER	1
3.2	GASKET	1
3.3	RETURN PANEL	1
4	FIXED PANEL	1
5	HINGE	2
6	CORNER CLIP	2
7	SUPPORT BAR	1
8	BOTTOM GLASS CLIP	4
9	BOTTOM DOOR GASKET	1
10	SIDE GASKET	1
13	HARDWARE	
13.1	WALL PLUG #6-1	3
13.2	SELF DRILLING SCREW #8-3/8	3
13.3	SELF DRILLING SCREW #8-1 1/4	4
13.4	SCREW CAP #8/8	4
13.5	SPACING BLOCK	2

301X-32, 302X-32

## TOOLS AND MATERIALS REQUIRED

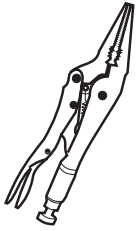

LONG NOSE LOCKING PLIER



SCREWDRIVERS

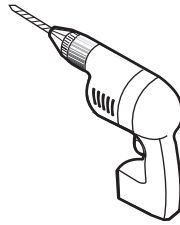

DRILL

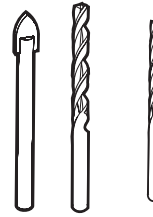

Ø1/4" & Ø1/8" DRILLBITS

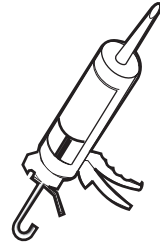

SILICONE



PENCIL

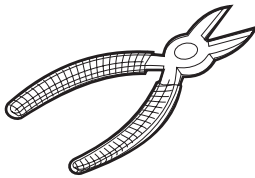

CUTTING PLIER

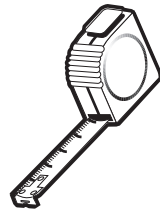

TAPE MESURE

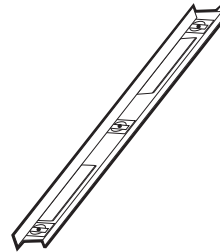

LEVEL



MALLET

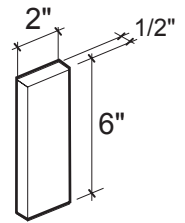

BLOCK

## INSTALLATIONS OF COMPONENTS

Return panel  
Bottom clips



see page 9-10

Support bar

see page 13-14

Hinges  
Door panel

see page 16

Front panel  
Corner clips  
Bottom clips

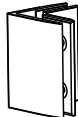

see page 1 1-12

Side gasket  
Door bottom

see page 15

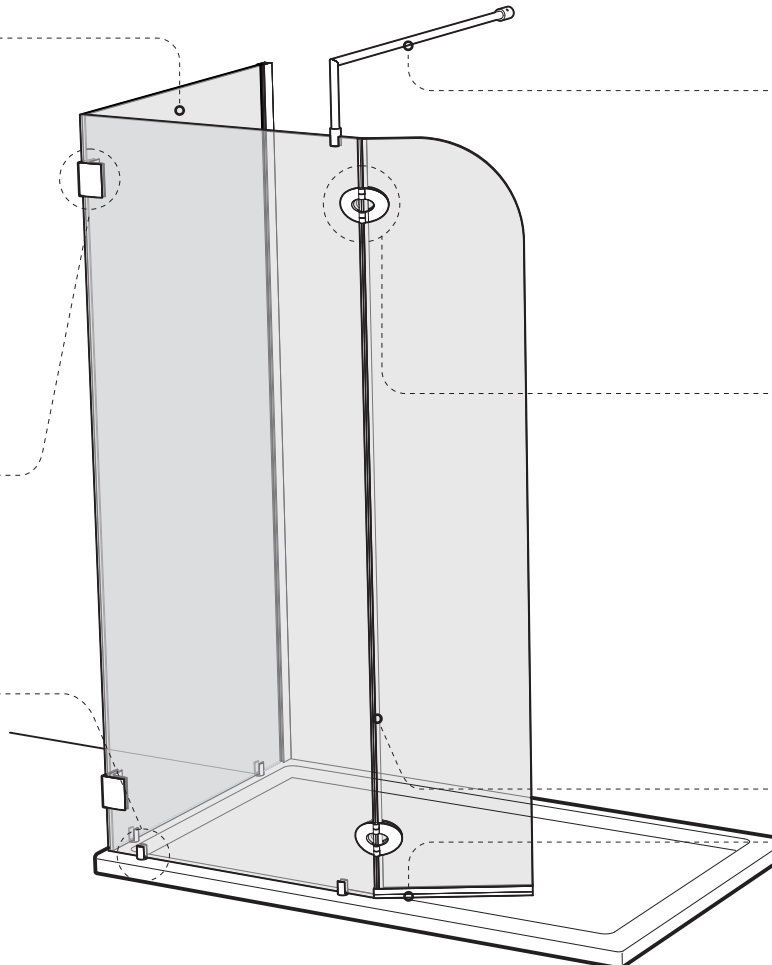

421X-32, 422X-32

# PARTS LISTING

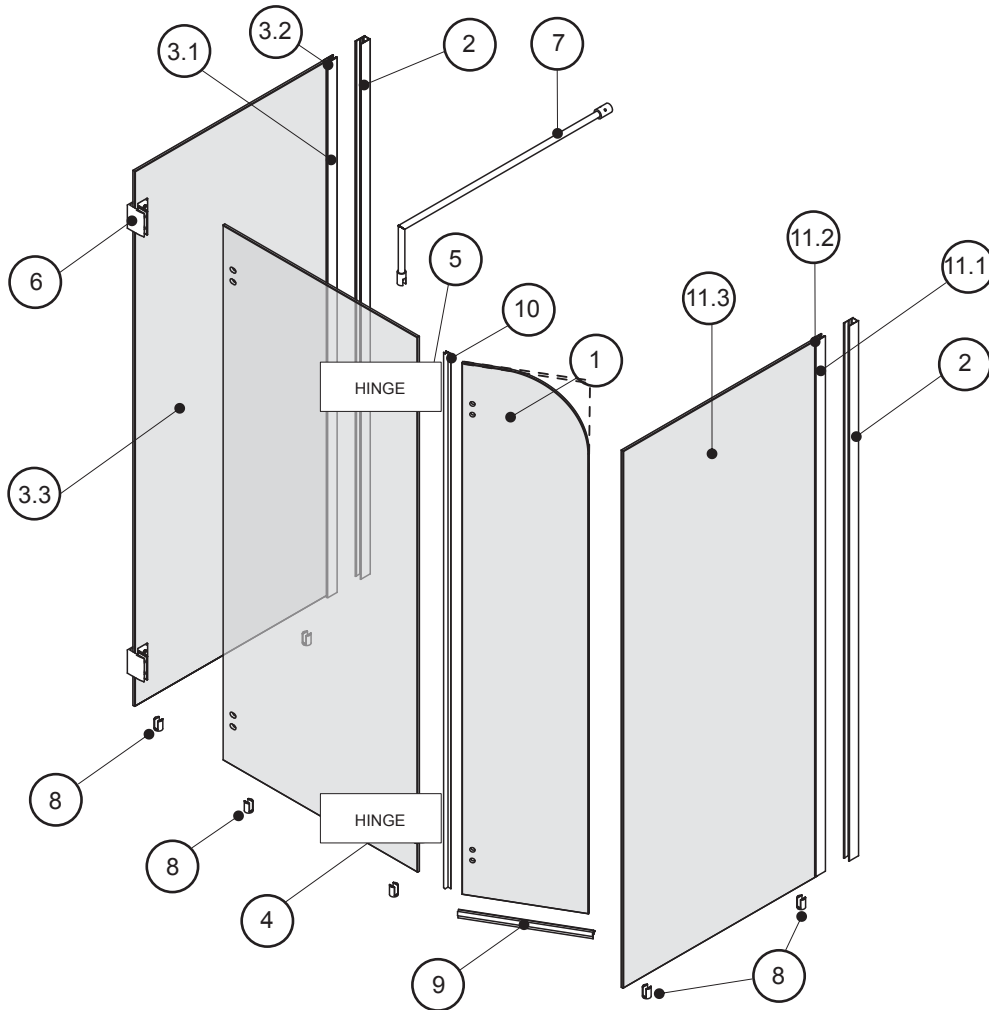

ITEM #	PARTS	QTY
1	DOOR PANEL	1
2	WALL JAMB	1
3.1	EXPANDER	1
3.2	GASKET	1
3.3	RETURN PANEL	1
4	FIXED PANEL	1
5	HINGE	1
6	CORNER CLIP	1
7	SUPPORT BAR	1
8	BOTTOM GLASS CLIP	1
9	BOTTOM DOOR GASKET	1
10	SIDE GASKET	1
11.1	EXPANDER	1
11.2	GASKET	1
11.3	RETURN PANEL	1
13	HARDWARE	1
13.1	WALL PLUG # 6 - 1	8
13.2	SELF DRILLING SCREW # 8 - 3 / 8	6
13.3	SELF DRILLING SCREW # 8 - 1 1 / 4	6
13.4	SCREW CAP # 8 / 8	8
13.5	SPACING BLOCK	2

421X-32, 422X-32

## TOOLS AND MATERIALS REQUIRED

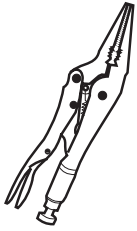

LONG NOSE LOCKING PLIER



SCREWDRIVERS

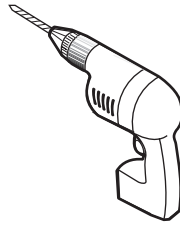

DRILL

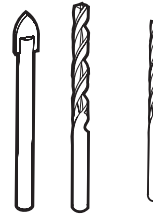

Ø1/4" & Ø1/8" DRILLBITS

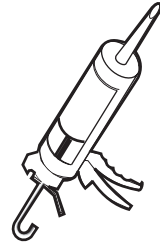

SILICONE



PENCIL

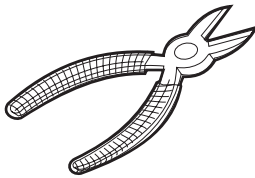

CUTTING PLIER

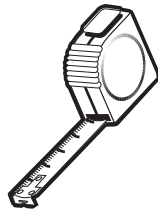

TAPE MESURE

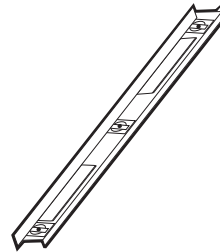

LEVEL



MALLET

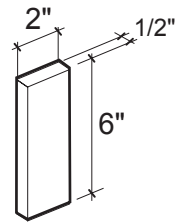

BLOCK

## INSTALLATIONS OF COMPONENTS

Return panel  
Bottom clips



see page 9-10

Support bar

see page 13-14

Front panel  
Corner clips  
Bottom clips

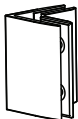

see page 1 1-12

Hinges  
Door panel

see page 16

Side gasket  
Door bottom

see page 15

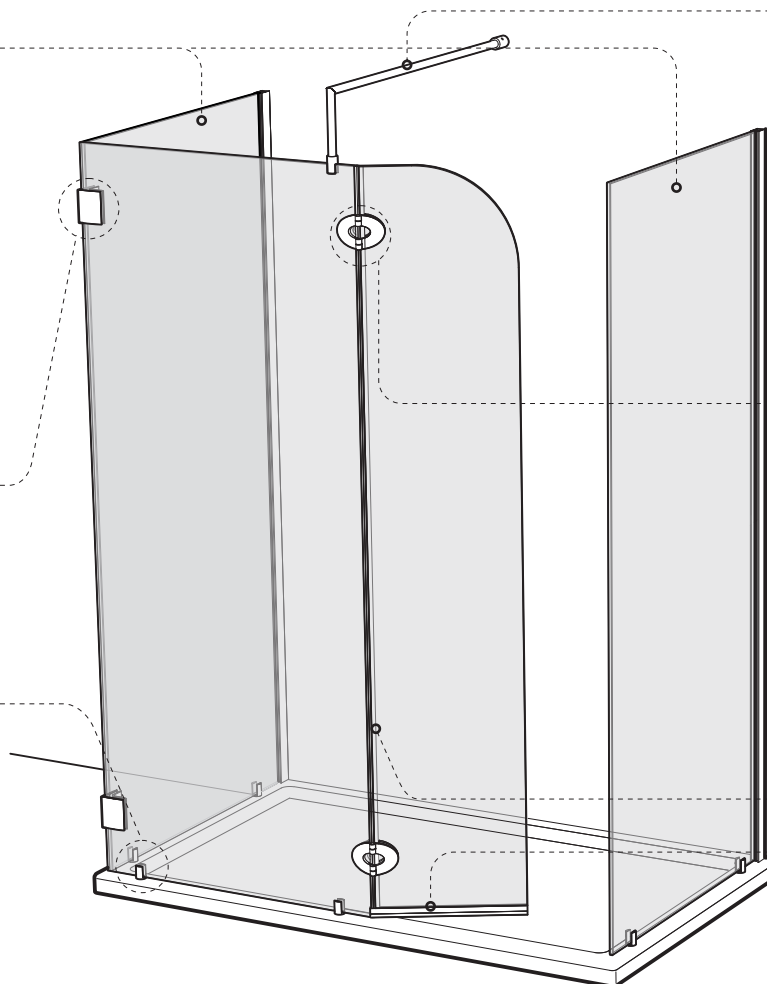

421TBX-32, 422TBX-32

PARTS LISTING

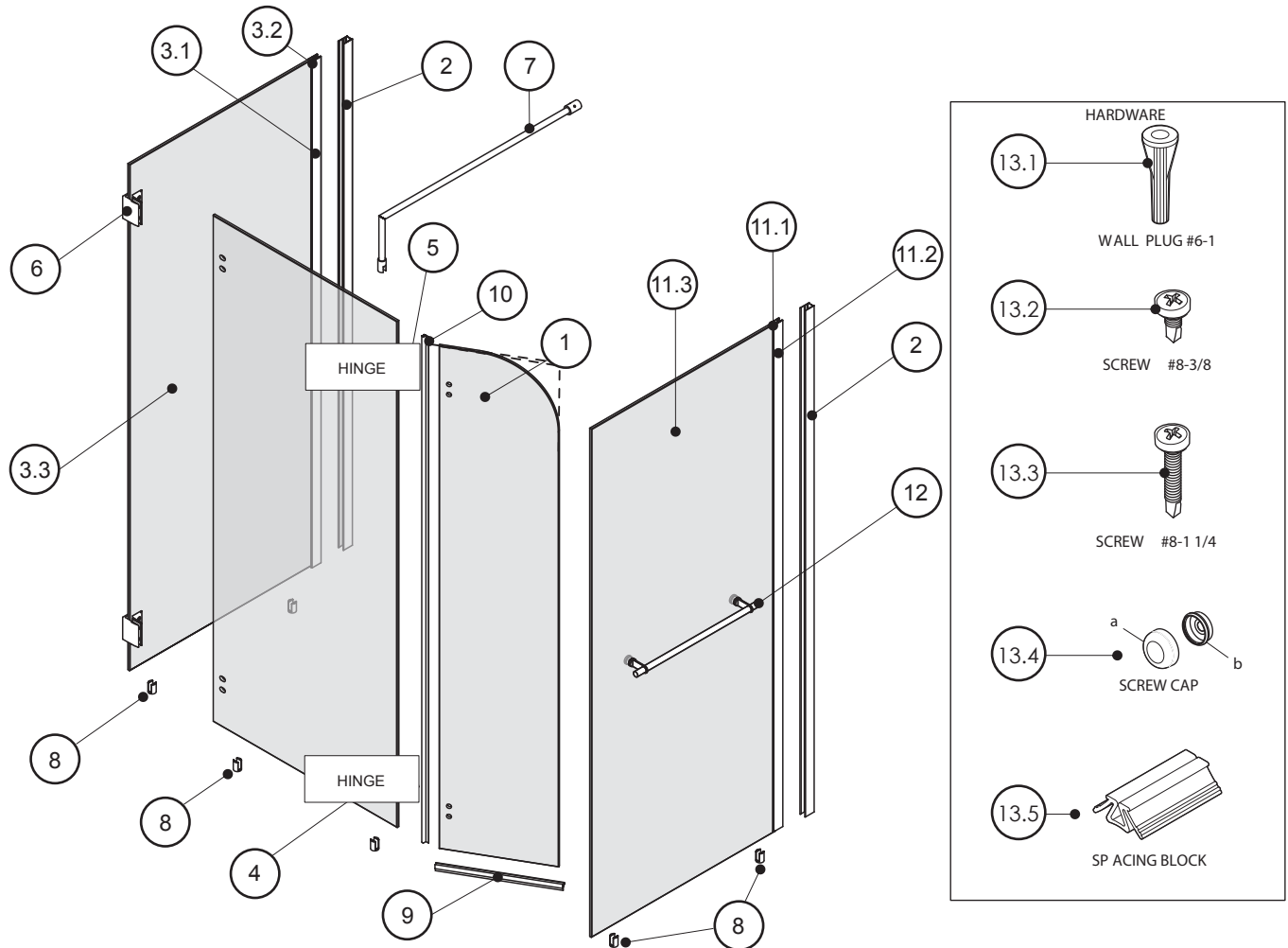

ITEM #	PARTS	QTY
1	DOOR PANEL	1
2	WALL JAMB	1
3.1	EXPANDER	1
3.2	GASKET	1
3.3	RETURN PANEL	1
4	FIXED PANEL	1
5	HINGE	2
6	CORNER CLIP	2
7	SUPPORT BAR	1
8	BOTTOM GLASS CLIP	6
9	BOTTOM DOOR GASKET	1
10	SIDE GASKET	1
11.1	GASKET	1
11.2	EXPANDER	1
11.3	RETURN PANEL	1
12	TOWEL BAR	1
13	HARDWARE	
13.1	WALL PLUG #6-1	8
13.2	SELF DRILLING SCREW #8-3/8	6
13.3	SELF DRILLING SCREW #8-1 1/4	6
13.4	SCREW CAP #8/8	8
13.5	SPACING BLOCK	2

421TBX-32, 422TBX-32

## TOOLS AND MATERIALS REQUIRED



LONG NOSE LOCKING PLIER



SCREWDRIVERS

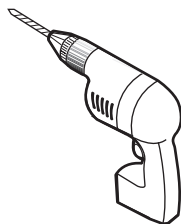

DRILL

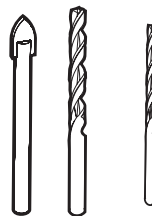

Ø1/4" & Ø1/8" DRILLBITS

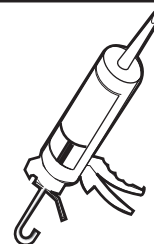

SILICONE

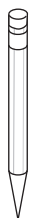

PENCIL

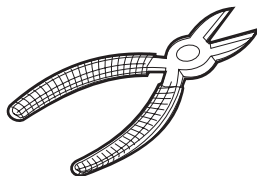

CUTTING PLIER

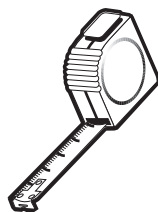

TAPE MESURE

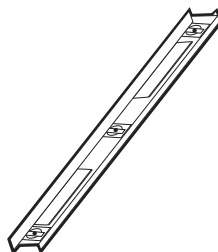

LEVEL



MALLET

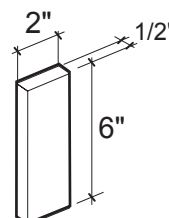

BLOCK

## INSTALLATIONS OF COMPONENTS

Return panel  
Bottom clips



voir page 9-10  
see page 9-10

Support bar

see page 13-14

Hinges  
Door panel

see page 16

Towel bar

see page 17

Side gasket  
Door bottom

see page 15

Front panel  
Corner clips  
Bottom clips

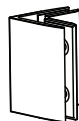

see page 1 1-12

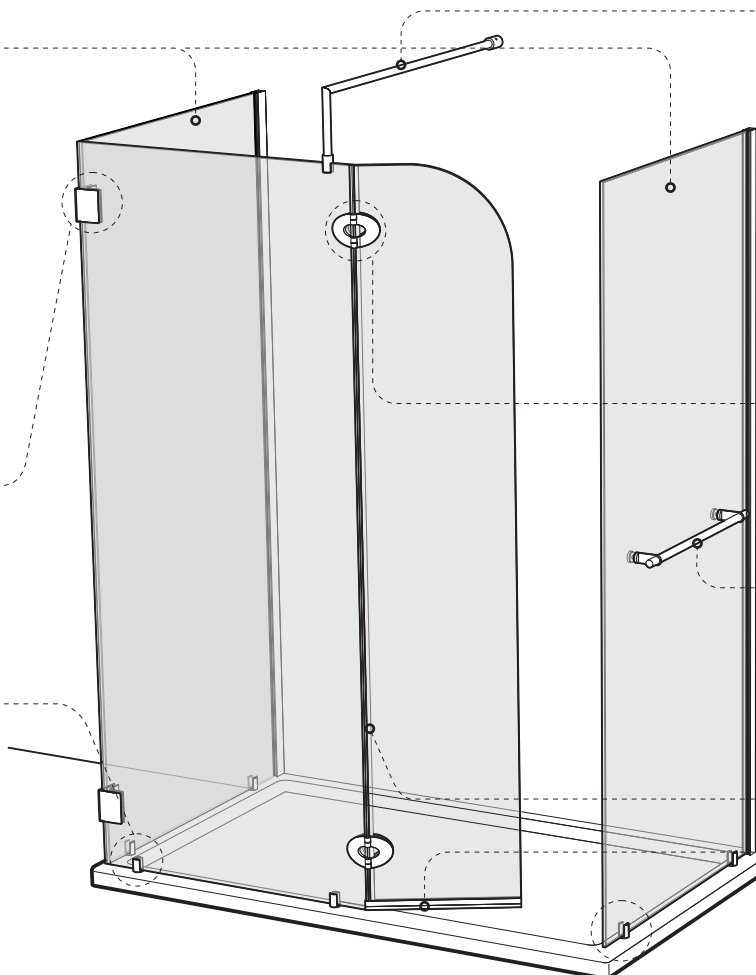

1

RETURN PANEL INSTALLATION

THIS INSTALLATION PROCEDURE APPLIES FOR ALL RETURN PANELS INSTALLATION REGARDLESS OF QUANTITY OR ADDITIONAL FIXTURE SUCH AS TOWEL BAR.

- 1a. Using a measuring tape, mark the center of the threshold of the base.

- 1b. Using the marking established in the previous step, run a second line up the wall. Use a level to ensure verticality of this line.

- 1c. Place the wall jamb (2) onto the wall while ensuring that the wall jamb slotted holes are centered to the center line. The side with holes of the wall jamb should face the interior of the shower .  
Drill holes using a  $\varnothing 1/8$  1/4 drill bit, through the wall using the wall jamb slotted holes as reference.

- 1d. Insert a drop of silicone into each hole made in the previous step. Insert a wall plug (13.1) into each hole and from there the wall jamb can be repositioned and permanently fastened using self drilling screws #8-1 1/4 (13.3).

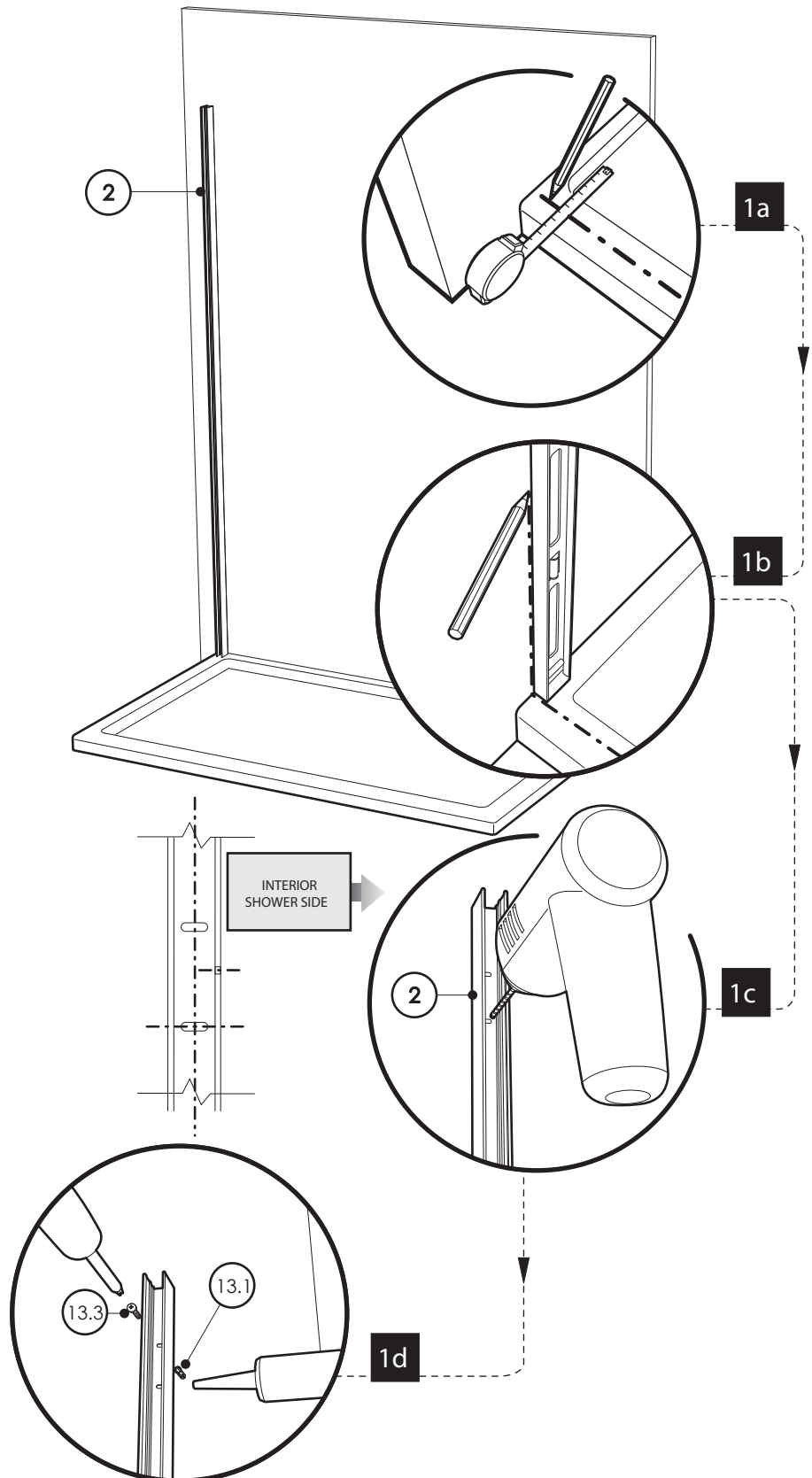

# 1 CONTINUED

- 1e. Place the bottom clips (8) for return panel on the line traced previously following dimension shown on the plan view. Mark the screw location. Remove temporary the bottom clips to drill the base using #1/8" drill bit. Put silicone onto the bottom clip bottom face groove and around the hole. Finally, fasten the bottom clips to the base using the provided screws. Place the gaskets into bottom clips slots.

- 1f. Slide the return panel assembly into the wall jamb (2) and through the bottom clips slots. Once the return panel has been adjusted, secure the expander (3.1) (11.1) to the wall jamb (2) by way of a clamp so as to keep the return panel level.

- 1g. Tighten the bottom clips set screws (8).

- 1h. Secure the wall jamb (2) to the expander (3.1) (11.1) by using #8- 3/8 screws (13.2), as well as screw caps (13.4).

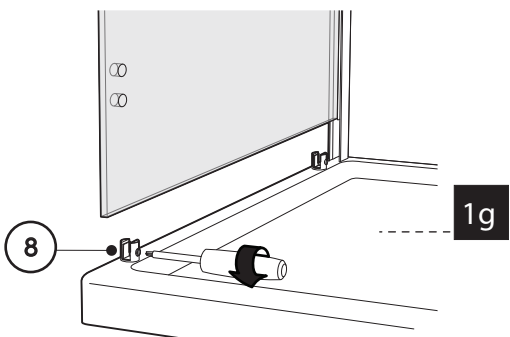
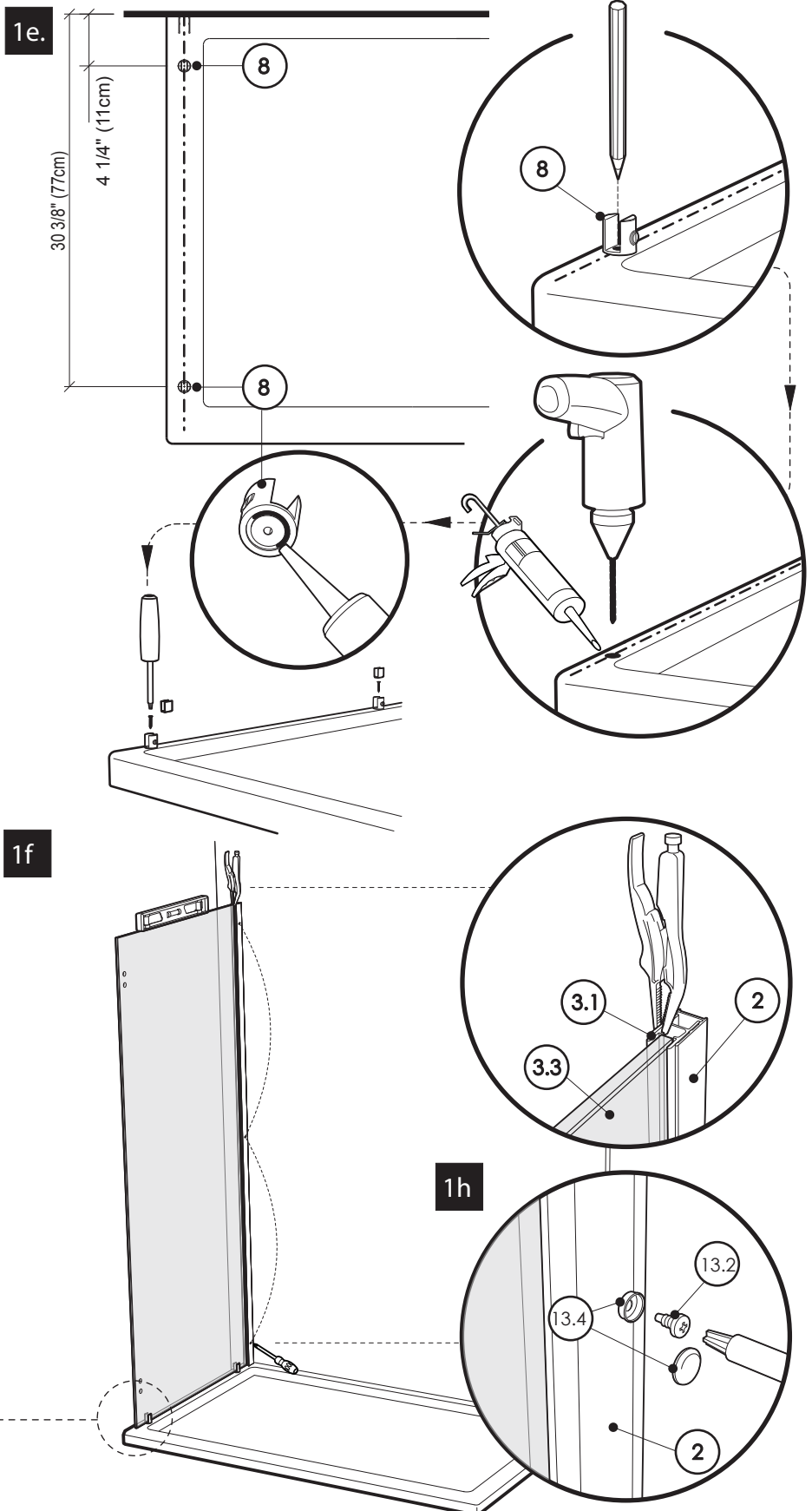

## 2 BOTTOM CLIPS INSTALLATION

### CORNER CLIPS INSTALLATION

2a. Fasten bottom clips (8) at both sides of the front panel (4) at approximately 3 1/2" from the edges.

2b. Temporarily install the corner clip (6) on the panels (3 & 4).  
Align the front panel (4) to the edge of the return panel (3) as shown. Install the front plate of the corner clip in the slotted holes and slide it into the holes of the return panel (4).  
A second person proceeds to tighten the black plates of corner clip from the inside of the shower.  
Make the necessary adjustments and level the front panel (4) by adjusting the corner clip.

2c. Mark on the base the location of bottom clips (8).

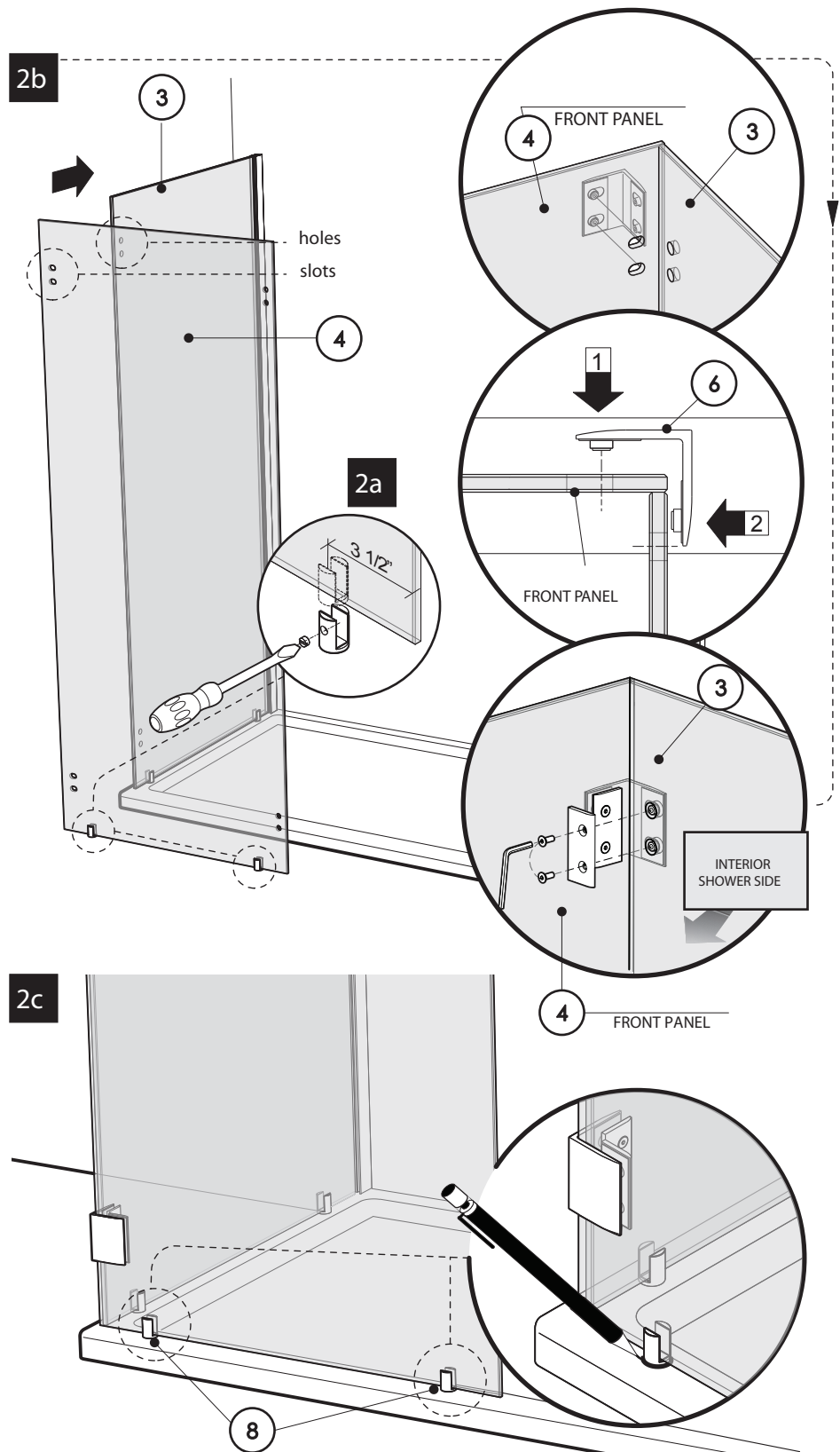

## 2 CONTINUED

- 2d. Remove the front panel (4) by disassembling the corner clip back plate. Drill pilot hole on the base with  $\varnothing 1/8"$  drill bit according to marking.

- 2e. Remove the bottom clips from the front fixed panel (4). Apply silicone sealant into the groove on the underside of the piece and around pilot holes. Fasten the bottom clips (8) to the base with # 6 - 1" provided screws and replace the gasket.

- 2f. Reinstall the front panel (4) by sliding into the bottom clips (8). Level all panels prior to tightening the corner clips back plates and bottom clips set screws.

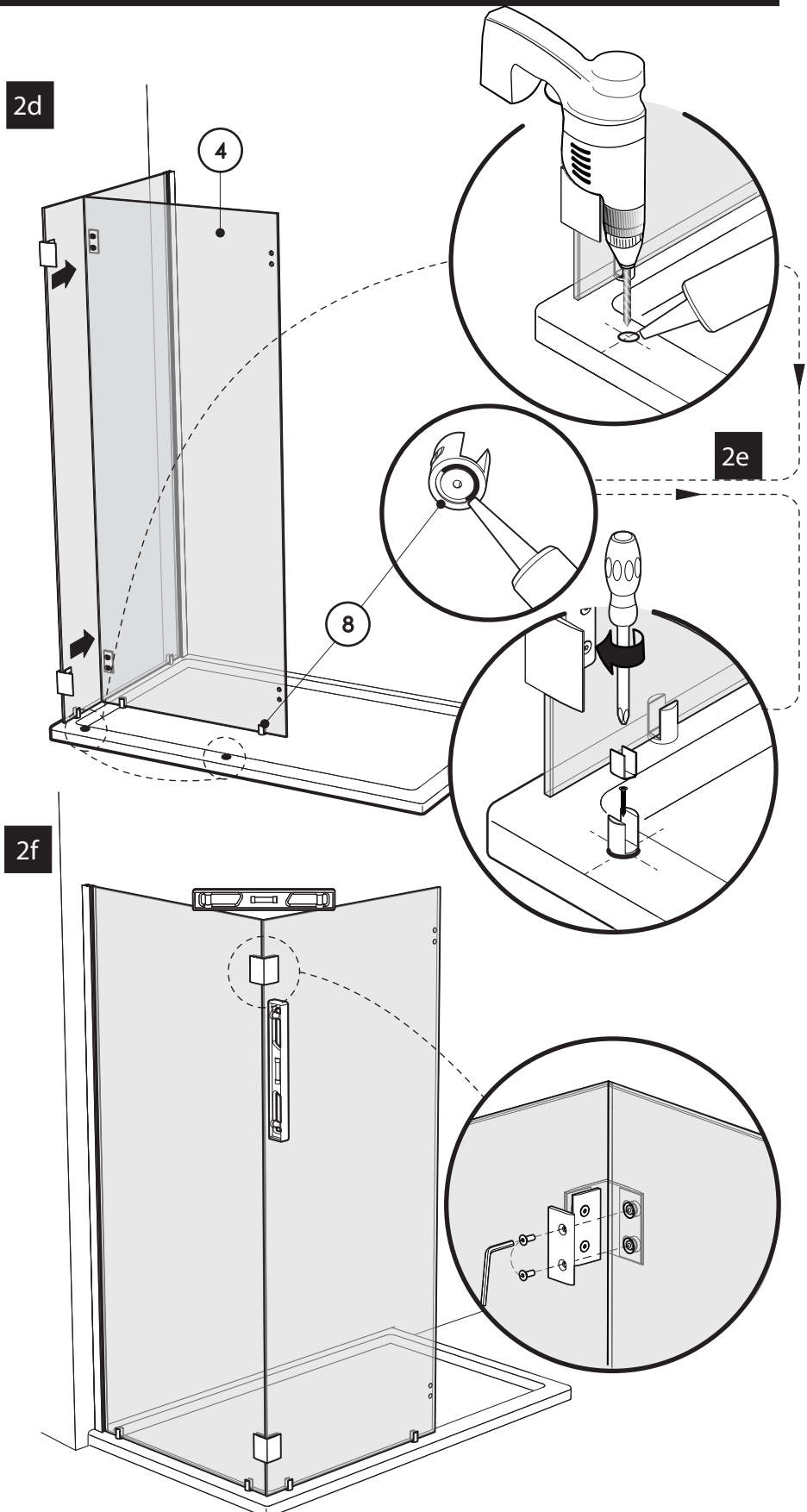

### 3 SUPPORT BAR INSTALLATION

3a. Take apart the end component (A) of the support bar with the provided Allen Key

3b. Transfer the position of the bottom clip (8) to the back wall. At 82" from the threshold mark the position (center of the cylinder) for the support bar end component (A) mounting

3c. Drill the back wall using a  $\varnothing 1/4"$  drill bit.

3d. Apply a bead of silicone in each hole and insert the wall plug. Proceed to fasten the wall end components (A) onto the wall.

3e. To ease subsequent installation on the front panel. Insert bar (7) in the component wall (A) on a horizontal plane as shown. Tighten the set screws.

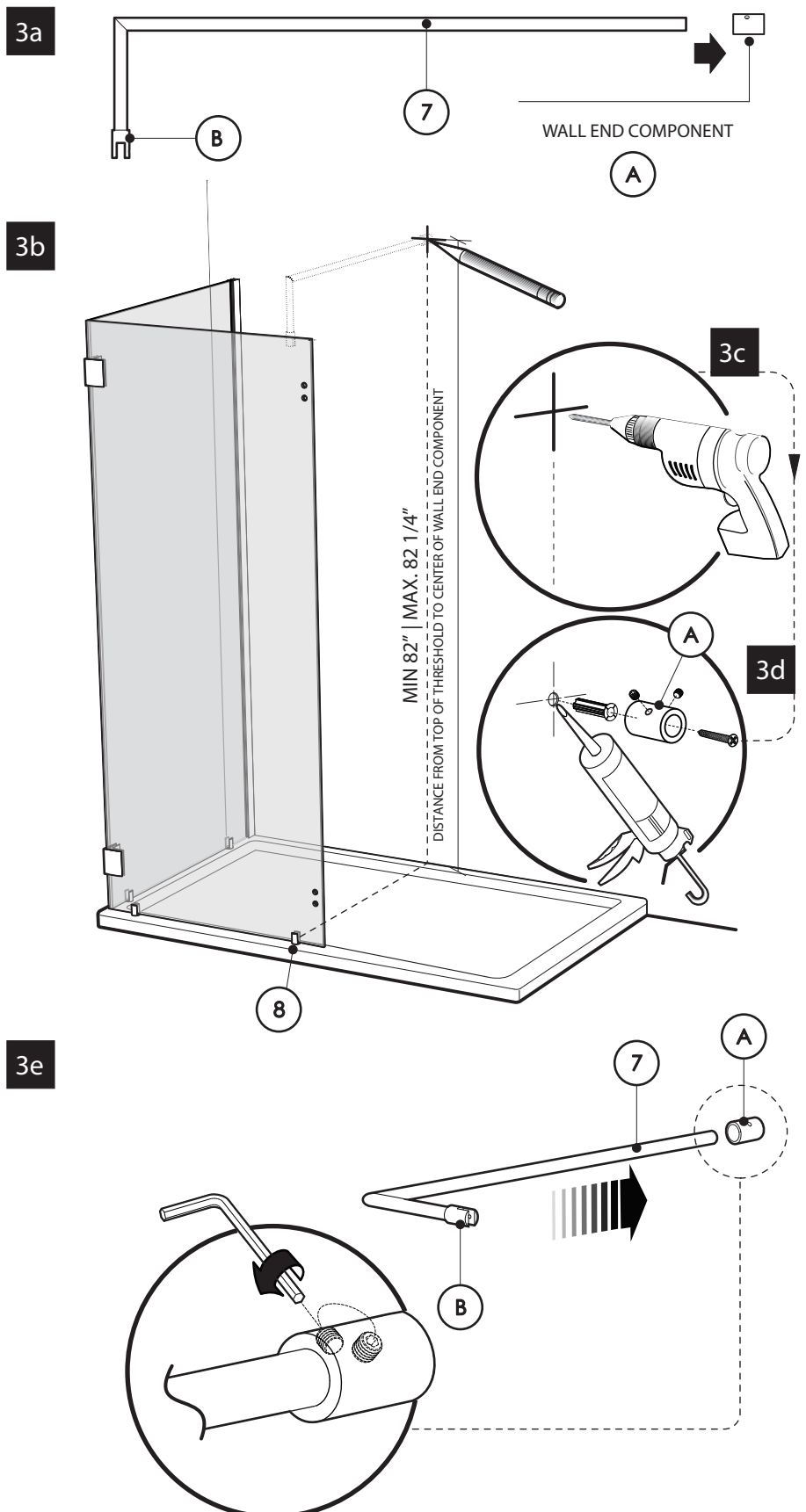

# 3 CONTINUED

- 3h. Insert the clear gasket as shown. Then Loosen and rotate support bar to grab the front panel.

3h

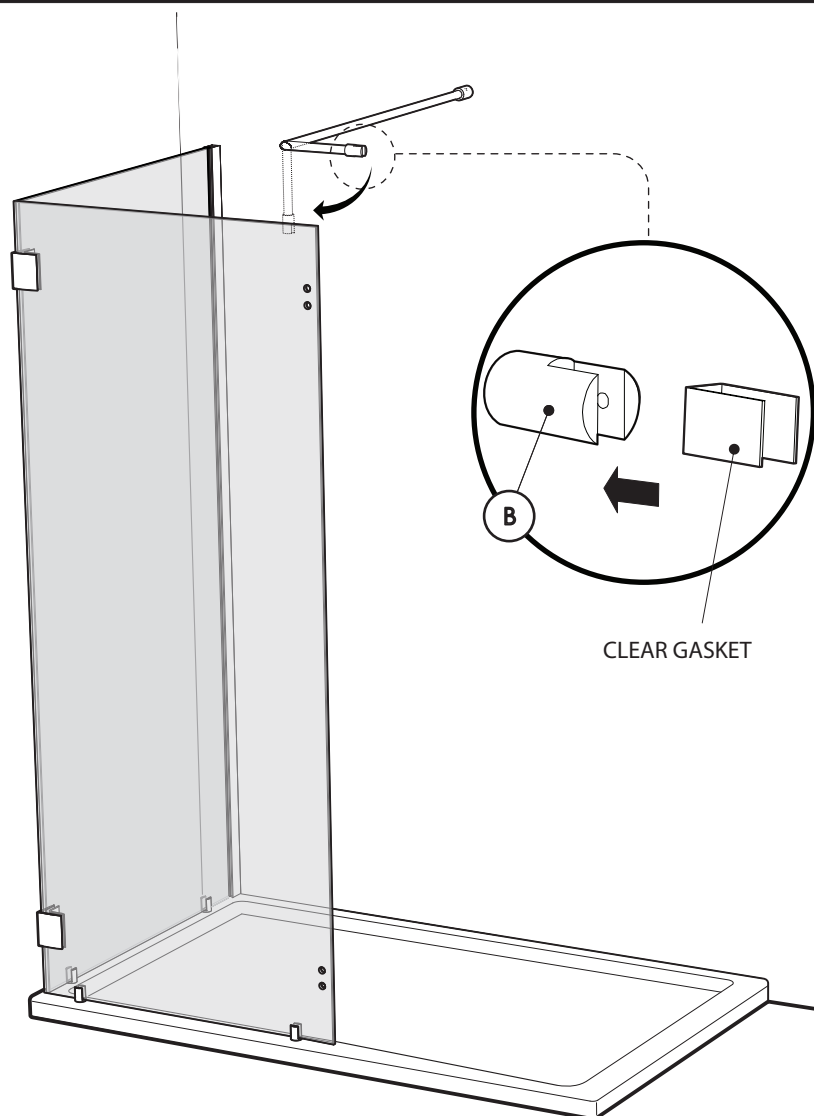

- 3g. Level support bar. Tighten the set screws.

3g

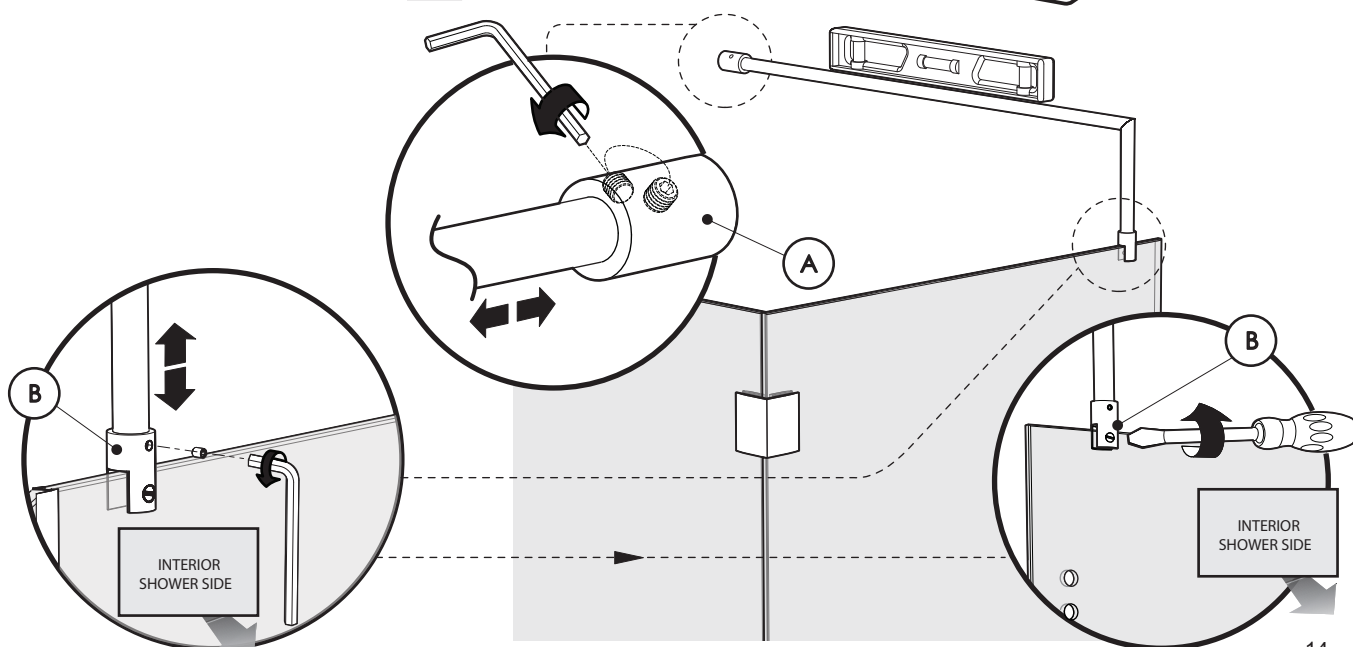

## 4 GASKETS INSTALLATION

4a. Align the fixed panel side gasket to the glass panel edge. Insert it with a 2" x 6" x 1/2" block and a mallet. Trim the excess using the cutting plier.

4b. Cut the bottom door gasket (9) as illustrated. The lip should be about 3/4" longer than the rest .

4c. Rest the door panel (1) on a flat surface. With the mallet, insert the bottom door gasket (9) at the bottom of the door. Make sure the lip faces the shower side. Install the 2 spacing blocks (13.5) onto the bottom lip of the gasket (9).

4a

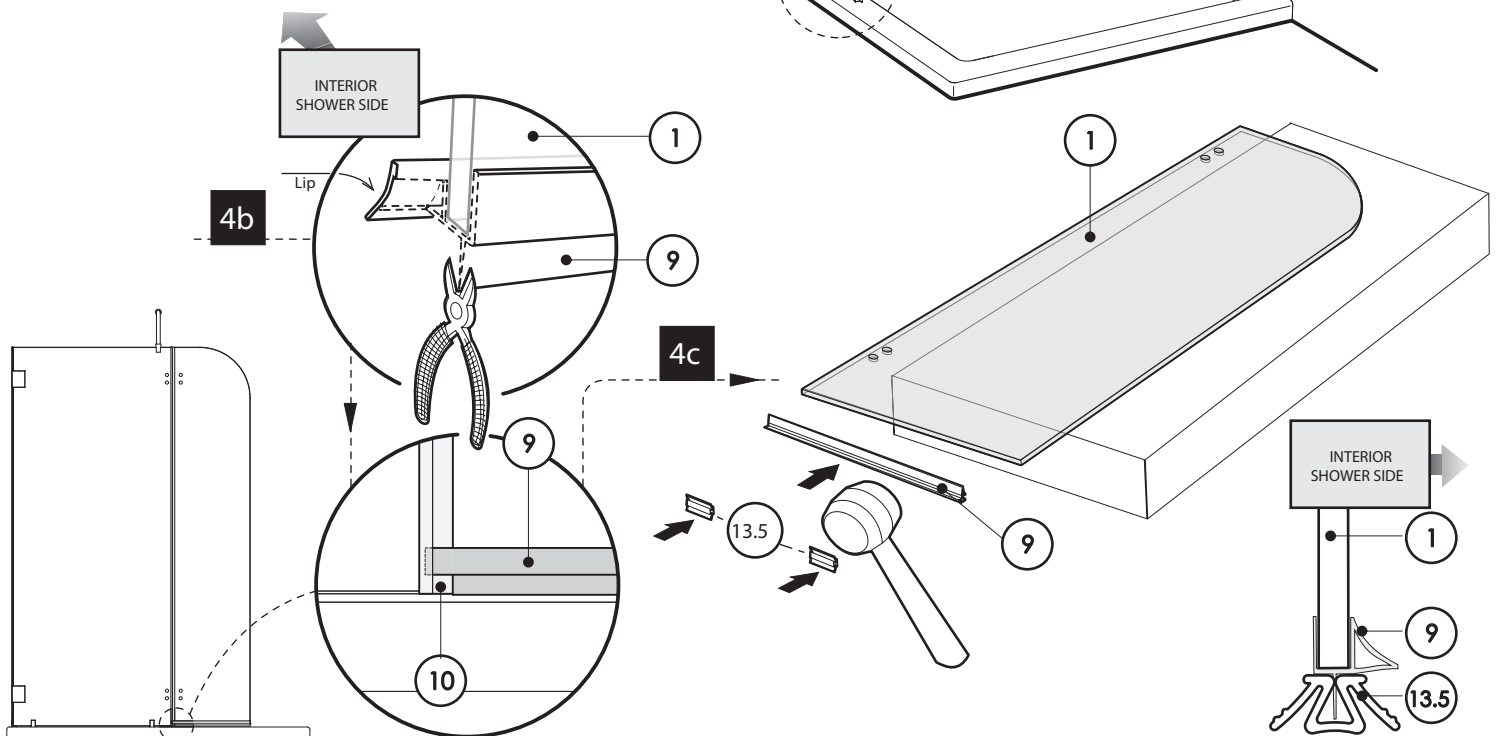
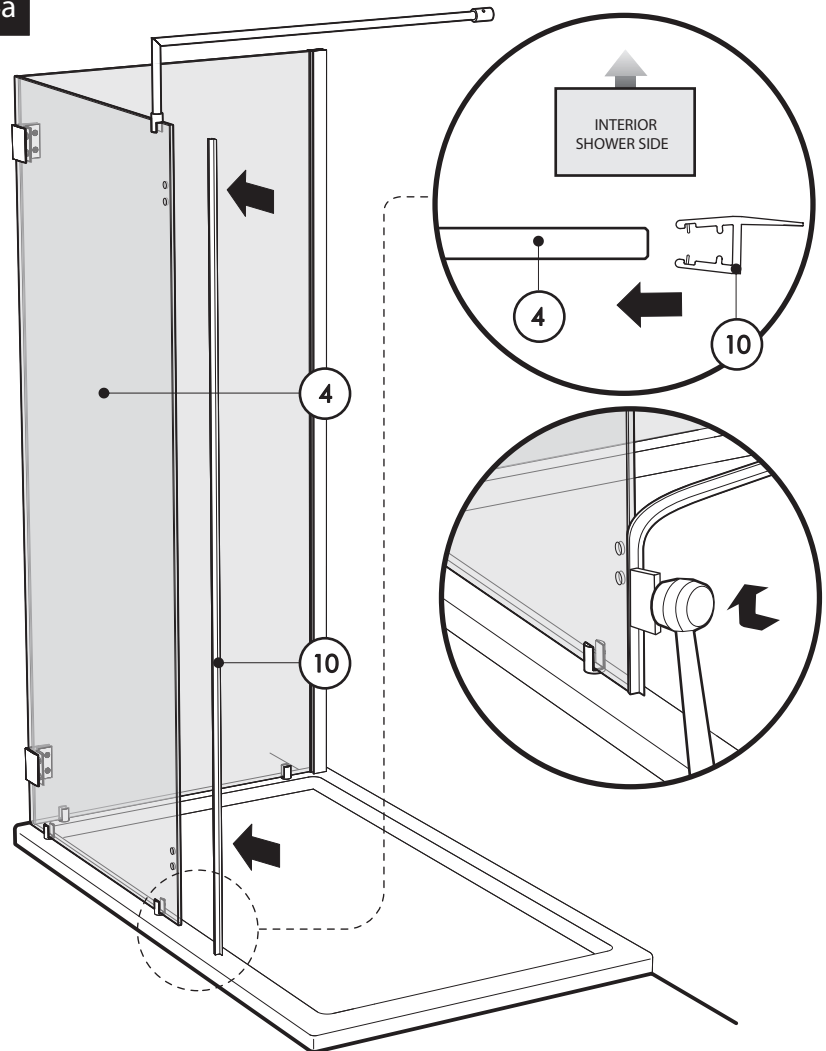

## 5 HINGES INSTALLATION

- 5a. Fasten one side of the hinges (5) onto the fixed panel (4). Do not tighten all the way for this step to allow other door (1) adjustments.
- 5b. Place the door panel vertically next to the fixed panel (4). The holes for the hinges should be aligned.
- 5c. Fasten the hinge on the door (1). The door panel must be leveled before tightening the hinges completely.
- 5d. Remove the spacing blocks (13.5).

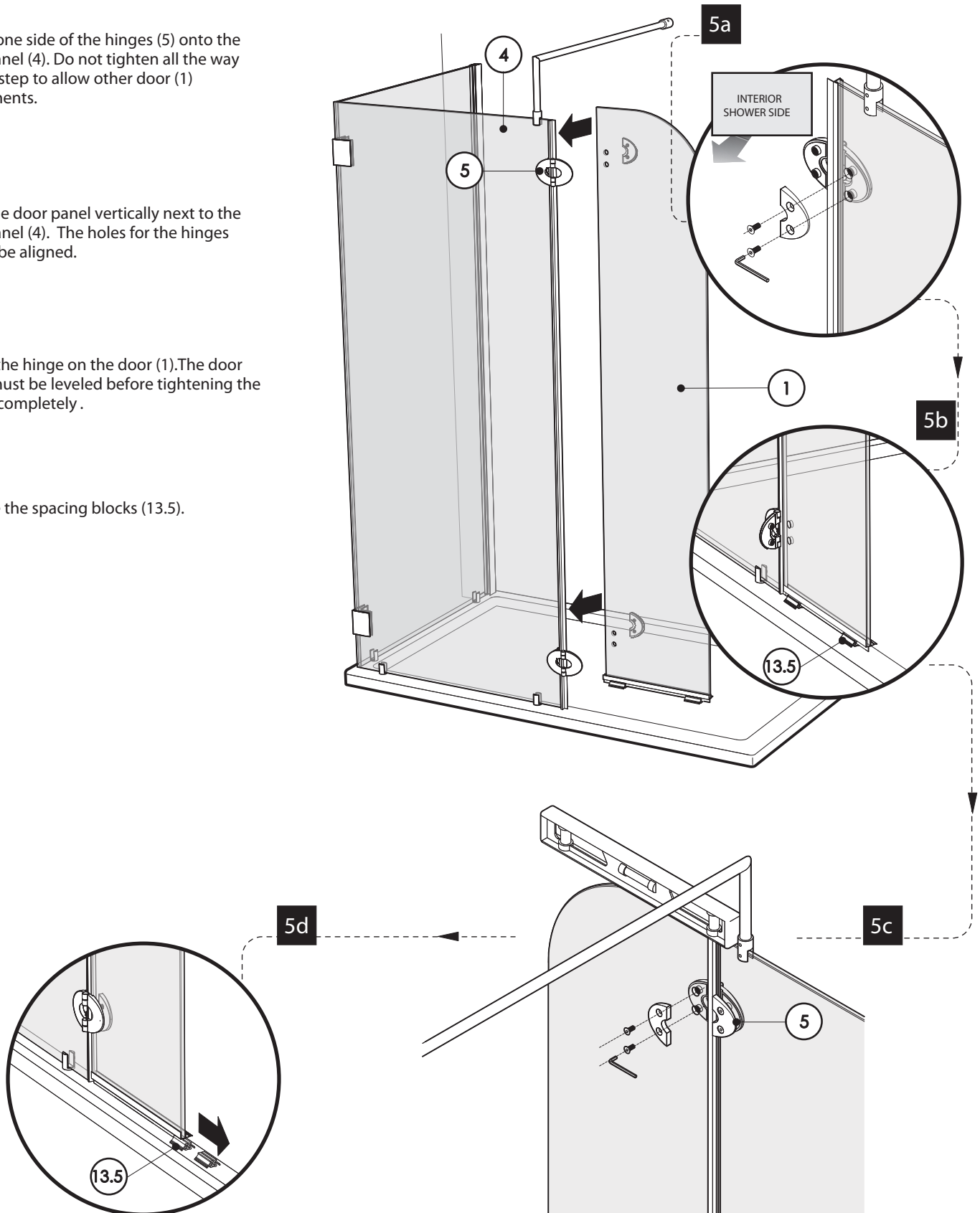

## 6 TOWEL BAR INSTALLATION

6a. For 56305 - 56306 configurations.  
If installation of return panel (11) has not  
been performed yet please, refer to step #1  
to complete the installation.

6b. Install the towel bar (12) as illustrated.

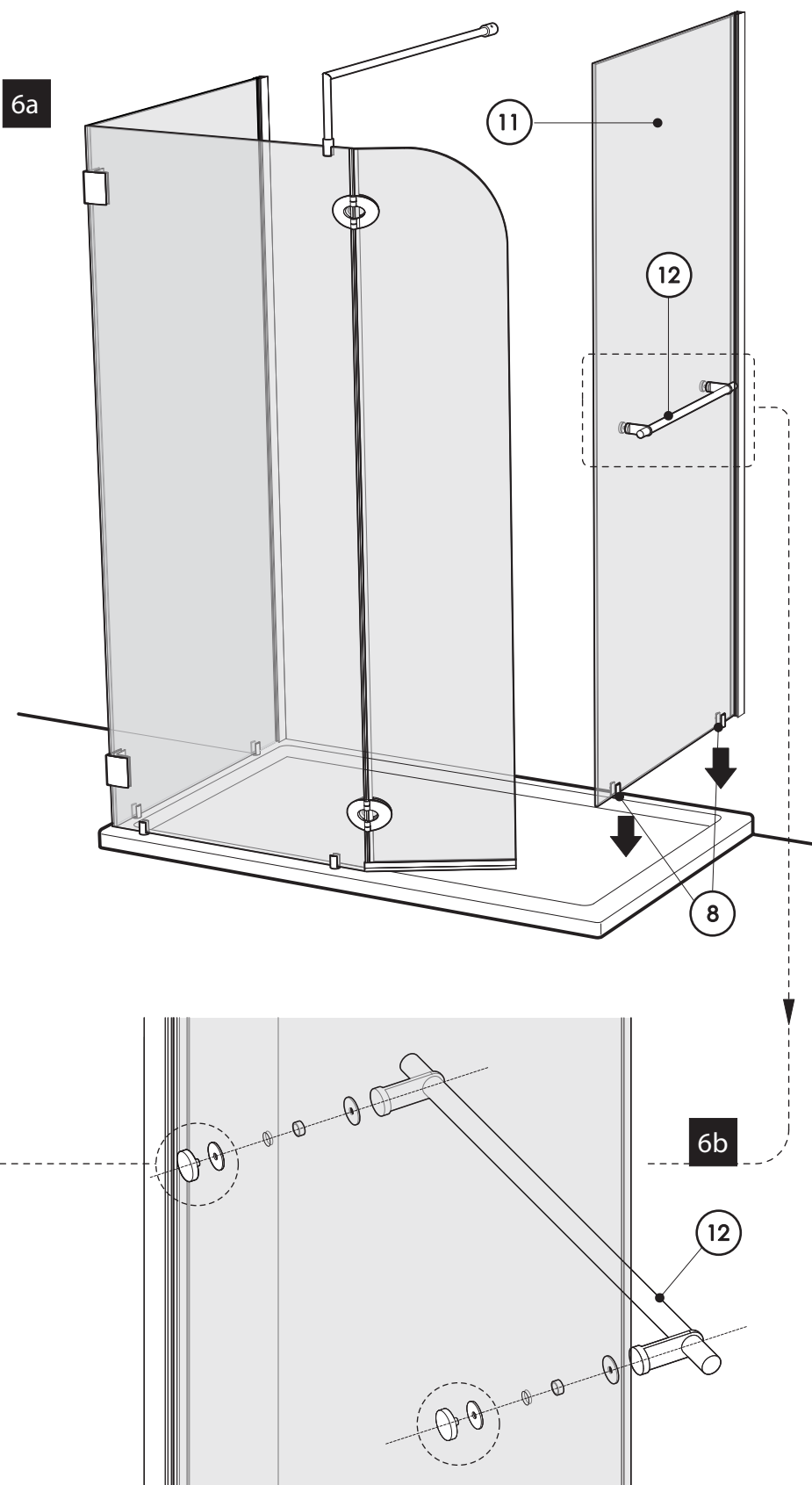

## 7 SILICONE SEAL THE SHOWER DOOR

7a. Seal the exterior of the shower along the wall with silicone. Fill gap between the glass panels and base surrounding the bottom clips (8).

7b. Inside the shower seal along the corner between the glass panels by passing trough the center of the corner clips with silicone.

