

**L-503X-32**



**L-513X-32**



**L-523X-32**



**L-523TBX-32**

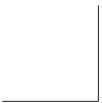

Please keep this manual and product code number for future reference  
and replacement parts ordering if necessary.



2 PEOPLE REQUIRED

#### GENERAL INSTRUCTIONS

- Read this manual carefully and completely before proceeding.
- It is recommended that you wear safety glasses at all times during the installation.

#### INSTALLATION OVER CERAMIC TILES

- Silicone should be used to seal the gap where the ceramic tiles meet the fixed panel.
- If your shower door is to be installed over ceramic tiles, the tiles should lay completely under the wall jamb.

#### NOTICE

- Caulking: no sealant is required inside the shower. Unless otherwise stated.
- Some models are equipped with clear sealing gaskets.

#### CARE FOR YOUR SHOWER DOOR

- Never use scouring powder pads or sharp instruments on metal pieces or glass panels.  
An occasional wiping down with a mild soap diluted in water is all that is needed to keep the panels and aluminum parts looking new.
- We recommend wiping the glass panels with a squeegee after each use.

Product specifications are subject to change  
without notice.

503X-32

PARTS LISTING

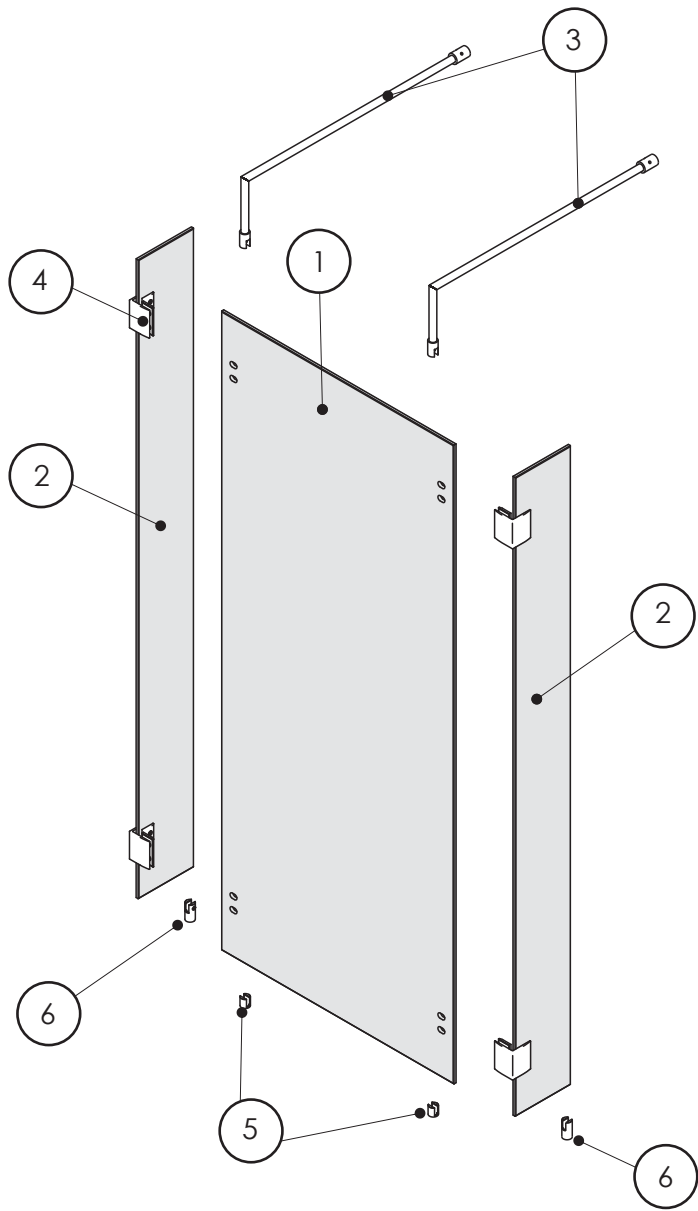

ITEM #	PARTS	QTY
1	FIXED PANEL	1
2	SMALL RETURN PANEL	2
3	SUPPORT BAR	2
4	CORNER CLIP	4
5	BOTTOM CLIP	2
6	LONG BOTTOM CLIP	2

503X-32

## TOOLS AND MATERIALS REQUIRED

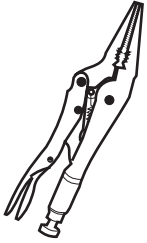

LONG NOSE LOCKING PLIER



SCREWDRIVERS

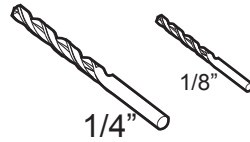

ACRYLIC DRILL BIT

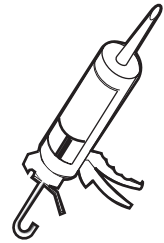

SILICONE



PENCIL

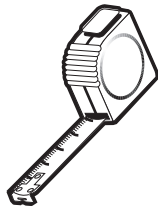

TAPE MESURE

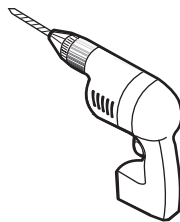

DRILL

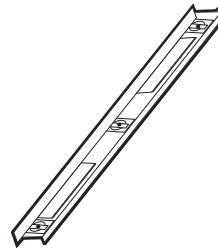

LEVEL

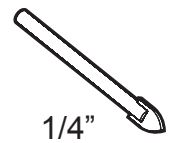

CERAMIC TILE DRILL BIT

## INSTALLATION OF COMPONENTS

Small fixed panel  
Corner clips  
Long bottom clips

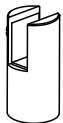
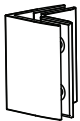

see page 12

Bottom clips



see page 9

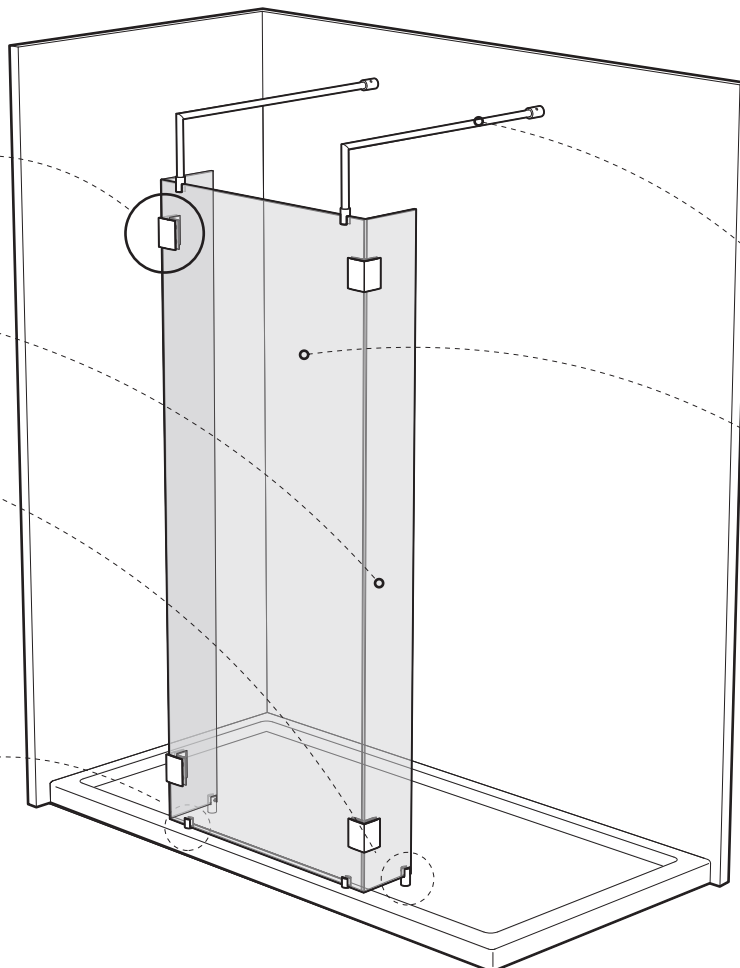

Front panel  
Support bar

see page 10

513X-32

## PARTS LISTING

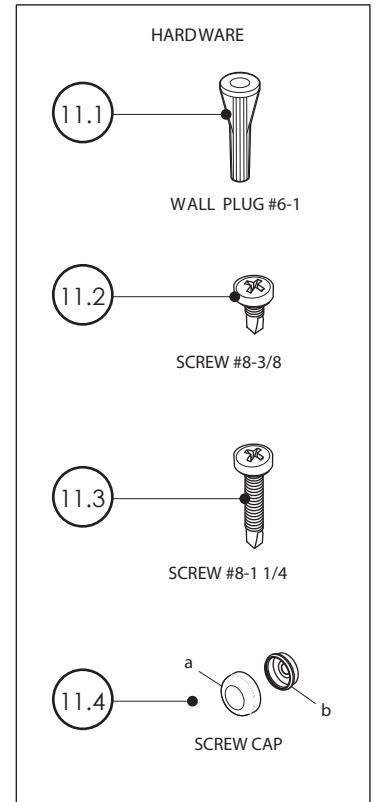
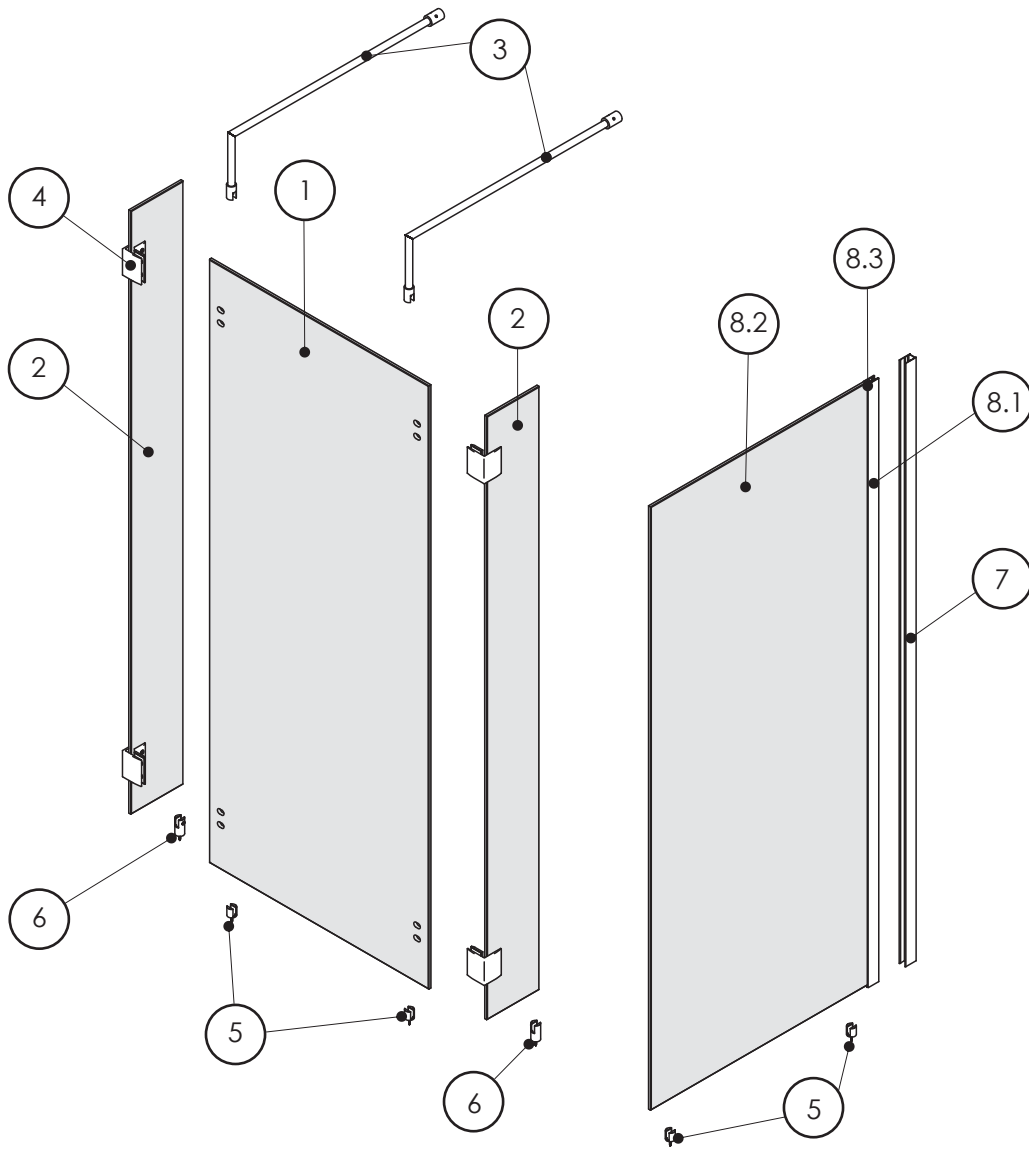

ITEM #	PARTS	QTY
1	FIXED PANEL	1
2	SMALL RETURN PANEL	2
3	SUPPORT BAR	2
4	CORNER CLIP	4
5	BOTTOM CLIP	4
6	LONG BOTTOM CLIP	2
7	WALL JAMB	1
8.1	EXPANDER	1
8.2	RETURN PANEL	1
8.3	GASKET	1
11	HARDWARE	
11.1	WALL PLUG #6-1	4
11.2	SELF DRILLING SCREW #8-3/8	3
11.3	SELF DRILLING SCREW #8-1 1/4	3
11.4	SCREW CAP #8/8	4

513X-32

## TOOLS AND MATERIALS REQUIRED

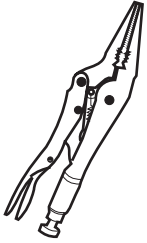

LONG NOSE LOCKING PLIER



SCREWDRIVERS

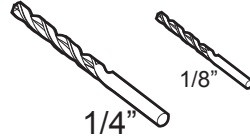

ACRYLIC DRILL BIT

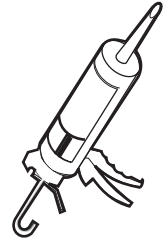

SILICONE

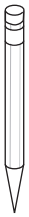

PENCIL

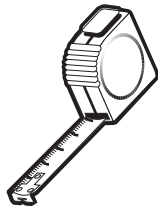

TAPE MEASURE

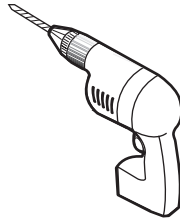

DRILL

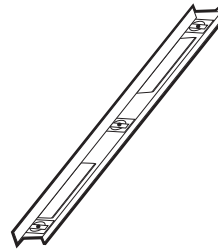

LEVEL

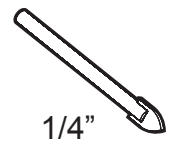

CERAMIC TILE DRILL BIT

## INSTALLATION OF COMPONENTS

Small fixed panel  
Corner clips  
Long bottom clips

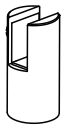
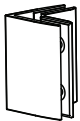

see page 12

Front panel  
Support bar

see page 10

Bottom clips



see page 9

Return panel panel  
Bottom clips

see page 14

523X-32

## PARTS LISTING

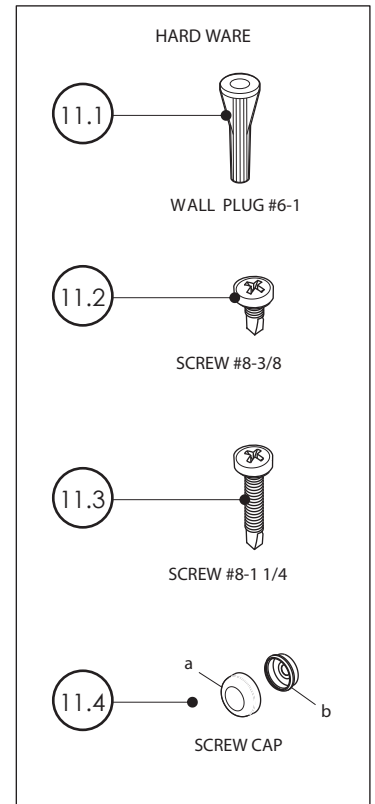
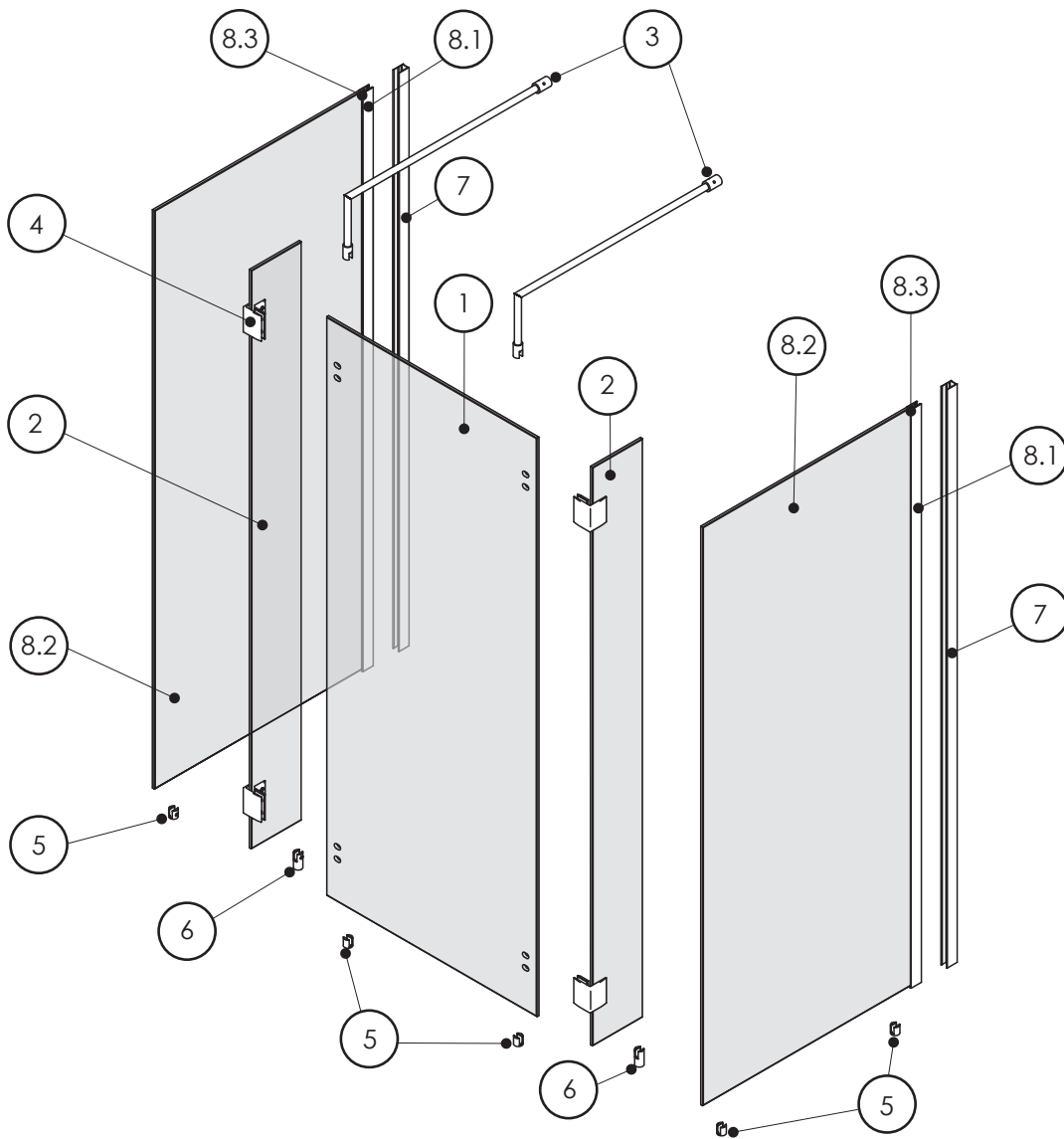

ITEM #	PARTS	QTY
1	FIXED PANEL	1
2	SMALL RETURN PANEL	2
3	SUPPORT BAR	2
4	CORNER CLIP	4
5	BOTTOM CLIP	6
6	LONG BOTTOM CLIP	2
7	WALL JAMB	2
8.1	EXPANDER	2
8.2	RETURN PANEL	2
8.3	GASKET	2
11	HARDWARE	
11.1	WALL PLUG #6-1	8
11.2	SELF DRILLING SCREW #8-3/8	6
11.3	SELF DRILLING SCREW #8-1 1/4	6
11.4	SCREW CAP #8/8	8



523X-32

## TOOLS AND MATERIALS REQUIRED

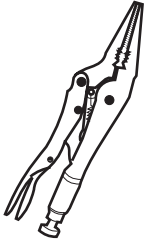

LONG NOSE LOCKING PLIER



SCREWDRIVERS

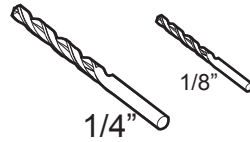

ACRYLIC DRILL BIT

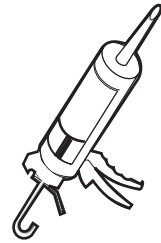

SILICONE



PENCIL

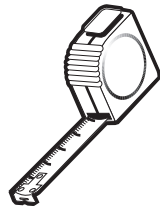

TAPE MESURE

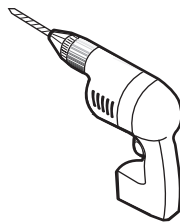

DRILL

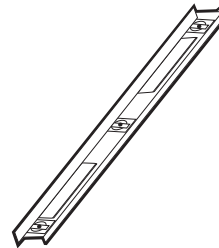

LEVEL

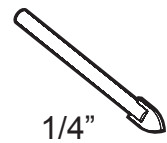

CERAMIC TILE DRILL BIT

## INSTALLATION OF COMPONENTS

Small fixed panel  
Corner clips  
Long bottom clips

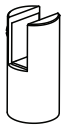
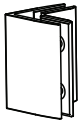

see page 12

Front panel  
Support bar

see page 10

Bottom clips



see page 9

Return panel  
Bottom clips

see page 14

523TBX-32

## PARTS LISTING

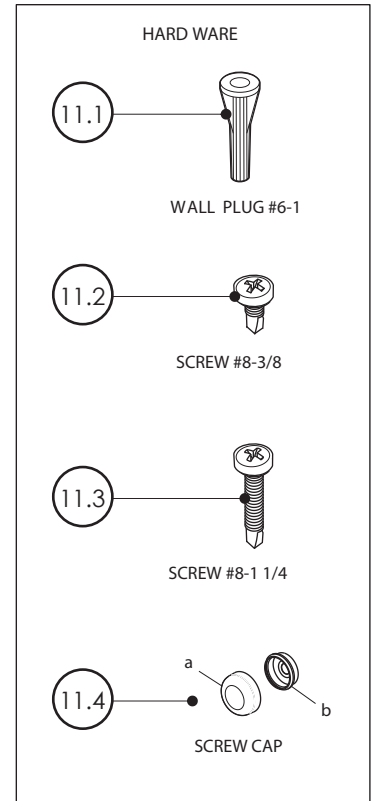
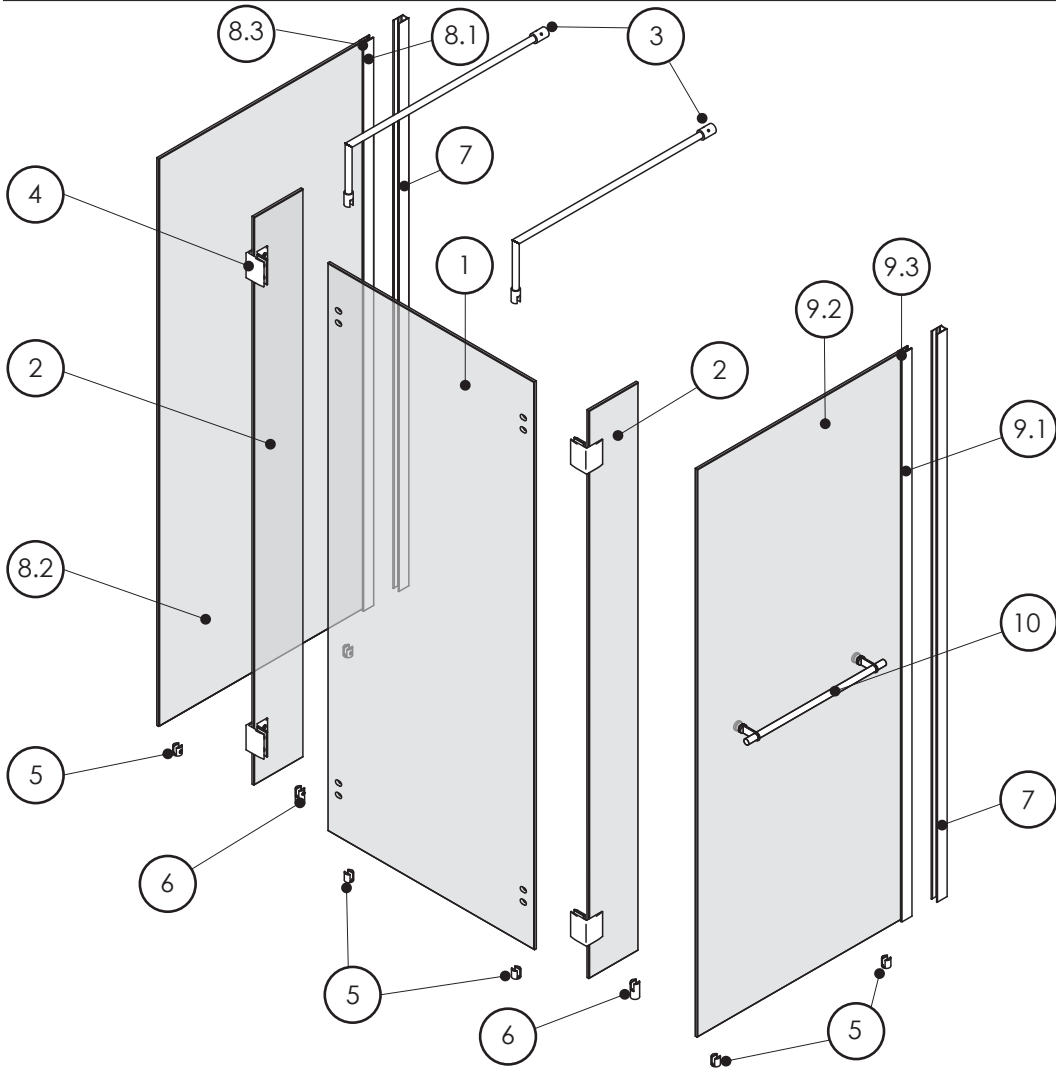

ITEM #	PARTS	QTY
1	FIXED PANEL	1
2	SMALL RETURN PANEL	2
3	SUPPORT BAR	2
4	CORNER CLIP	4
5	BOTTOM CLIP	6
6	LONG BOTTOM CLIP	2
7	WALL JAMB	1
8.1	EXPANDER	1
8.2	RETURN PANEL	1
8.3	GASKET	1
9.1	EXPANDER	1
9.2	RETURN PANEL	1
9.3	GASKET	1
10	TOWEL BAR	1
11	HARDWARE	
11.1	WALL PLUG #6-1	8
11.2	SELF DRILLING SCREW #8-3/8	3
11.3	SELF DRILLING SCREW #8-1 1/4	3
11.4	SCREW CAP #8/8	8

523TBX-32

## TOOLS AND MATERIALS REQUIRED

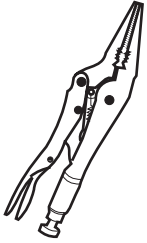

LONG NOSE LOCKING PLIER



SCREWDRIVERS

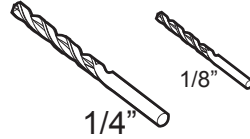

ACRYLIC DRILL BIT

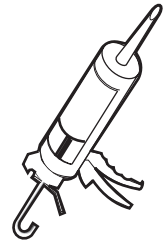

SILICONE



PENCIL

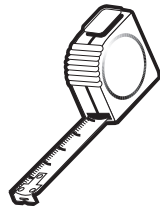

TAPE MEASURE

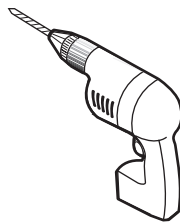

DRILL

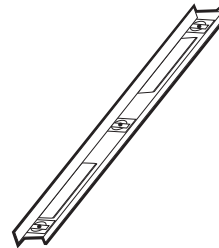

LEVEL

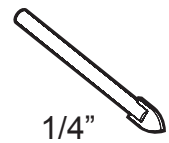

CERAMIC TILE DRILL BIT

## INSTALLATION OF COMPONENTS

Small fixed panel  
Corner clips  
Long bottom clips

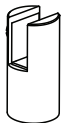
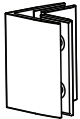

see page 12

Front panel  
Support bar

see page 10

Bar à serviette  
Towel bar

see page 16

Bottom clips



see page 9

Return panel  
Bottom clips

see page 14

# 1 BOTTOM CLIPS INSTALLATION

- 1a. Using the measuring tape, mark the center of the threshold of the base. Find the center of the exposed base and draw a line to the center of the threshold. The line must be perpendicular. Place both bottom clips (5) along the line of the center of threshold. Mark the screw location following the dimensions shown in the drawing. Dimensions on the drawing are for ABN3672 base installation.

- 1b. Remove the bottom clips to drill the base using #1/8" drill bit.

- 1c. Apply silicone into the groove at the bottom of the clip and around the hole drilled. Fasten the bottom clips to the base using the provided screws. Place the gaskets into bottom clips slots.

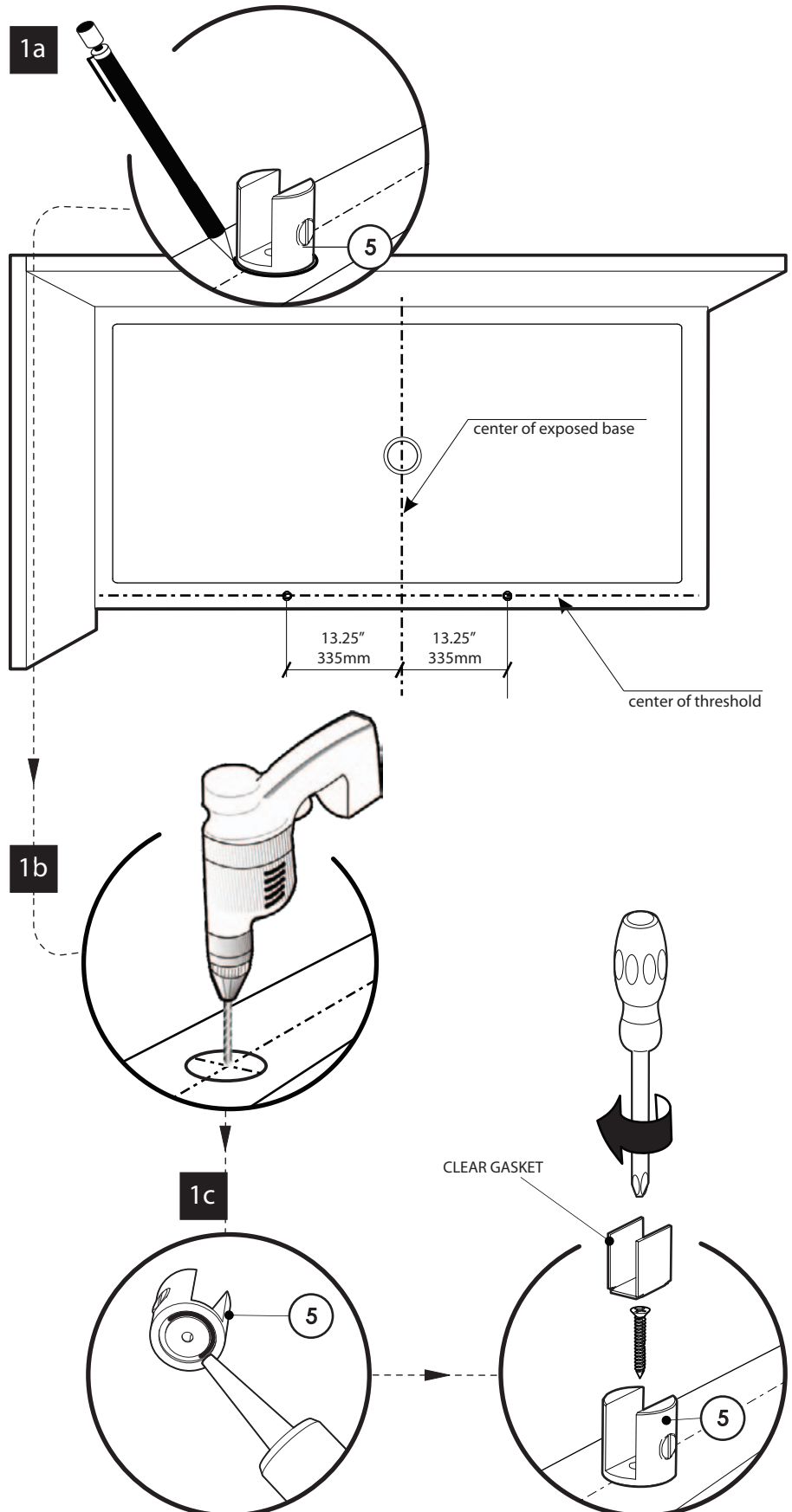

## 2 SUPPORT BARS INSTALLATION

- 2a. Take apart the end component of the support bar with the provided Allen Key.

- 2b. Transfer the position of the bottom clip (5) to the back wall. At 82" from the threshold mark the position (center of the cylinder A) for the support bar end component mounting.

- 2c. Drill the back wall using a  $\varnothing 1/4"$  drill bit.

- 2d. Apply a bead of silicone in each hole and insert the wall plugs. Proceed to fasten the wall end components onto the wall.

- 2e. To ease subsequent installation on the front panel. Insert bar (3) in the component wall (A) on a horizontal plane as shown. Tighten the set screws.

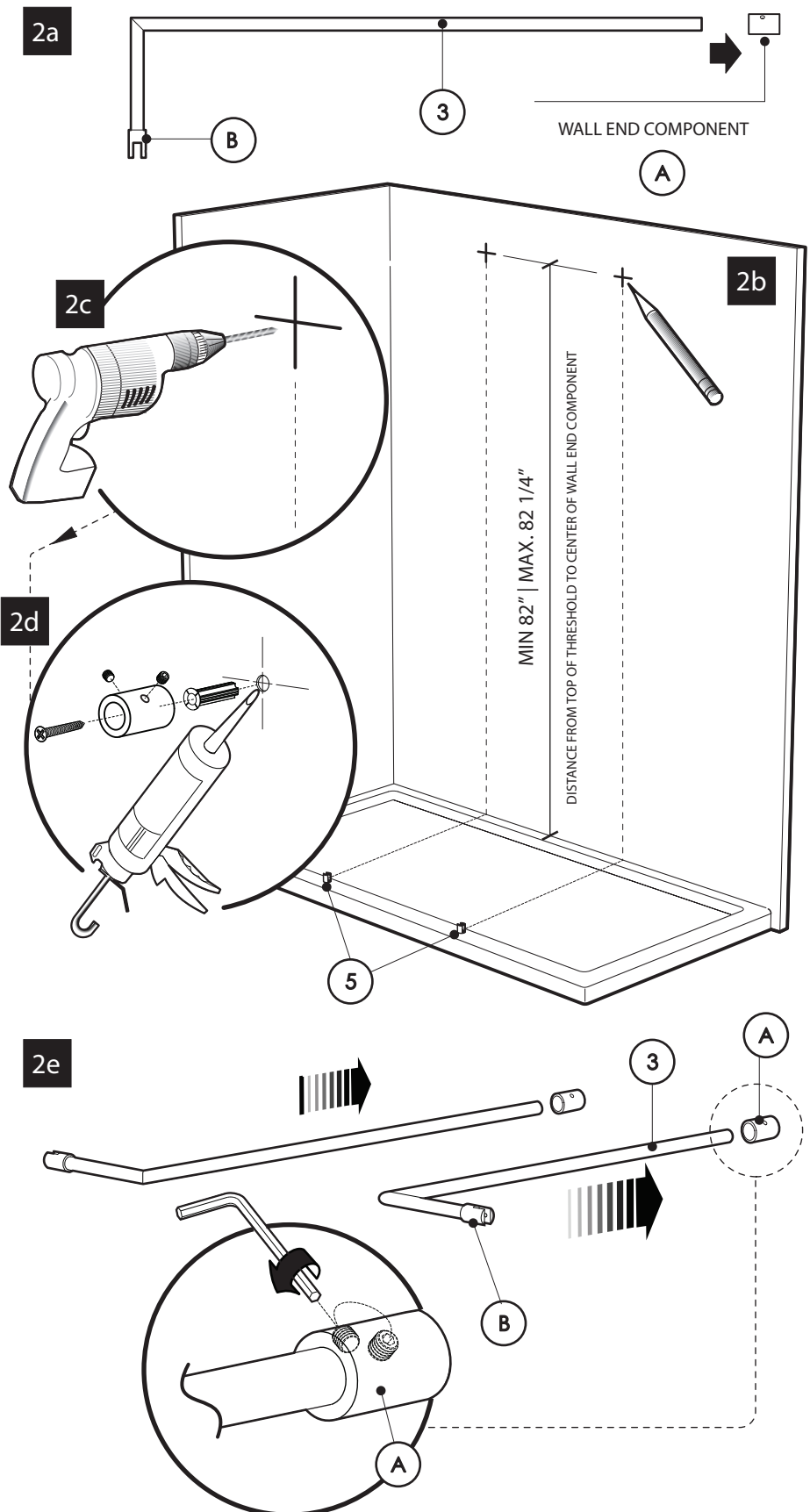

2

CONTINUED

- 2f. Place the front fixed panel into the bottom clips (5) attached to the base. Insert the clear gasket as shown. Then Loosen and rotate support bar to grab the front panel.

2f

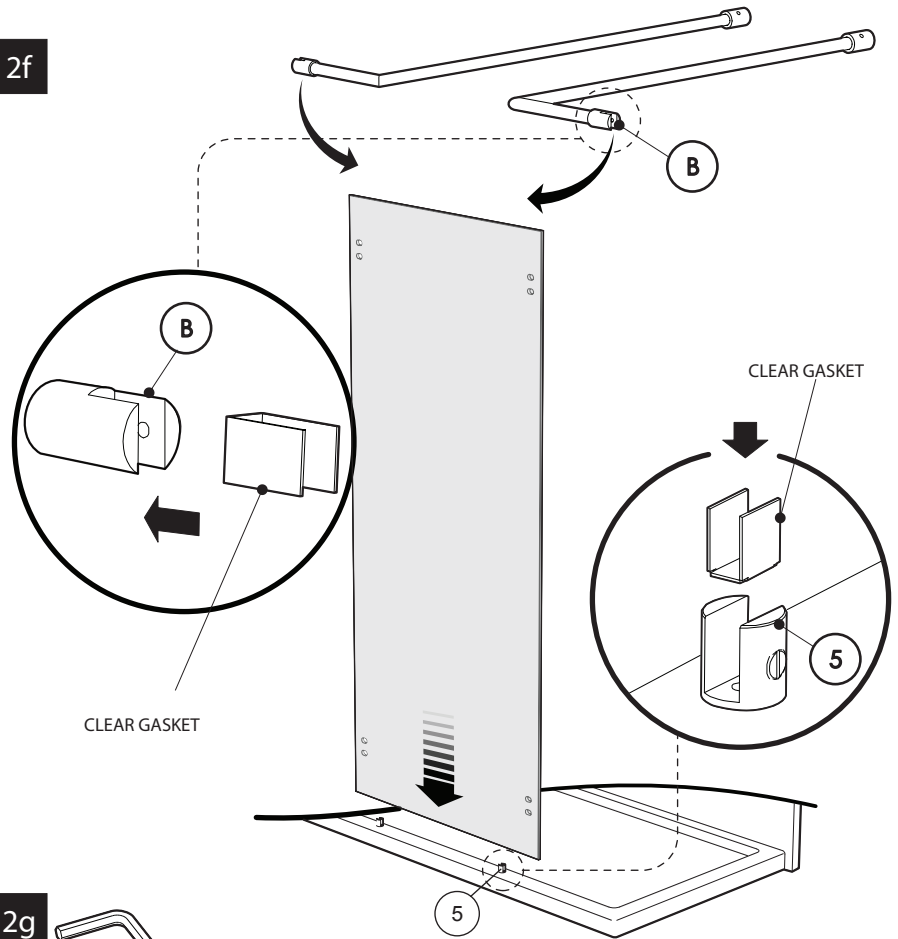

- 2g. Level support bar. Tighten the set screws.

2g

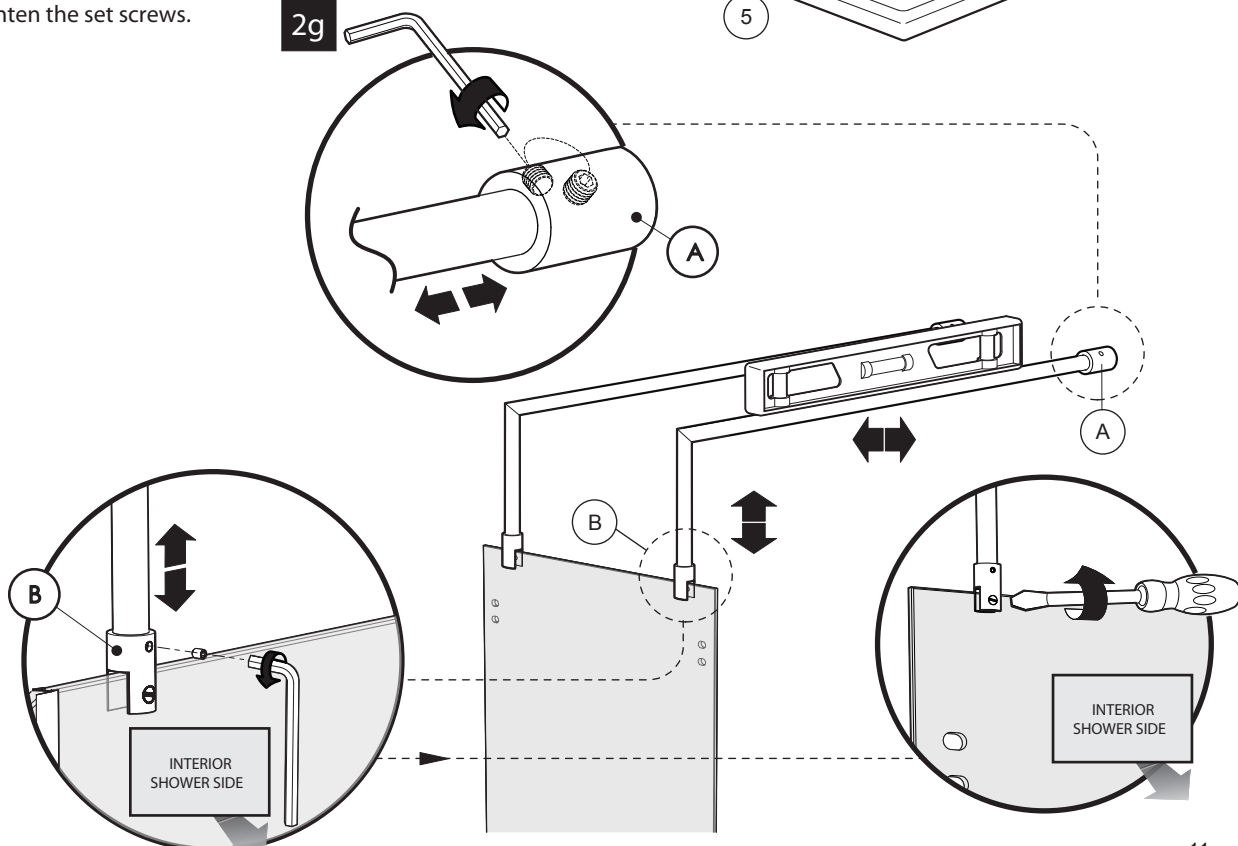

### 3 LONG BOTTOM CLIPS INSTALLATION

#### CORNER CLIPS INSTALLATION

- 3a. Temporarily install the corner clips(4) onto the glass panels (1 & 2). Align the edge of the small return panels onto the back face of the front panel as shown in the detail. Holding the glasses from the front install corner clip front plate onto front panel slots. Slide the corner clip until it meets the side fixed panel holes. A second person proceeds to tighten the black plates of corner clip from the inside of the shower. Level the small glass panels by adjusting the corner clips.

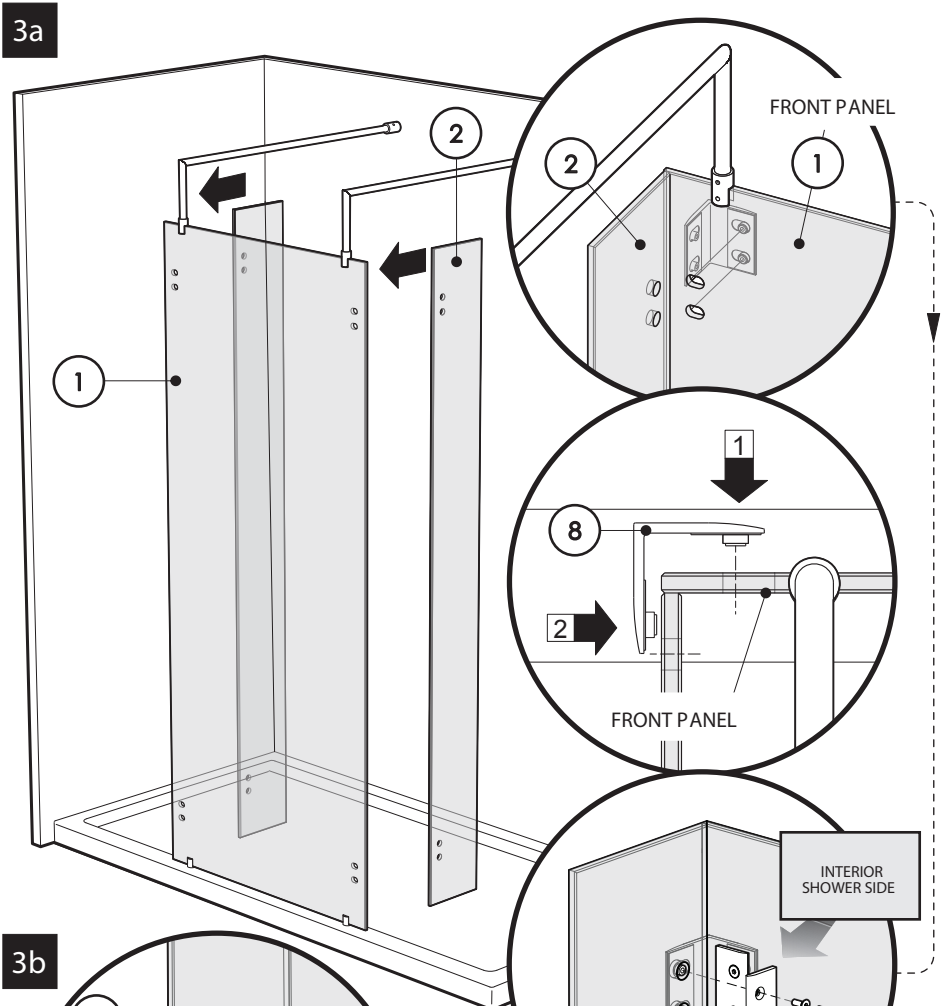

- 3b. Place the long bottom clip (6) right at the edge of the glass (2). Mark on the base its location.

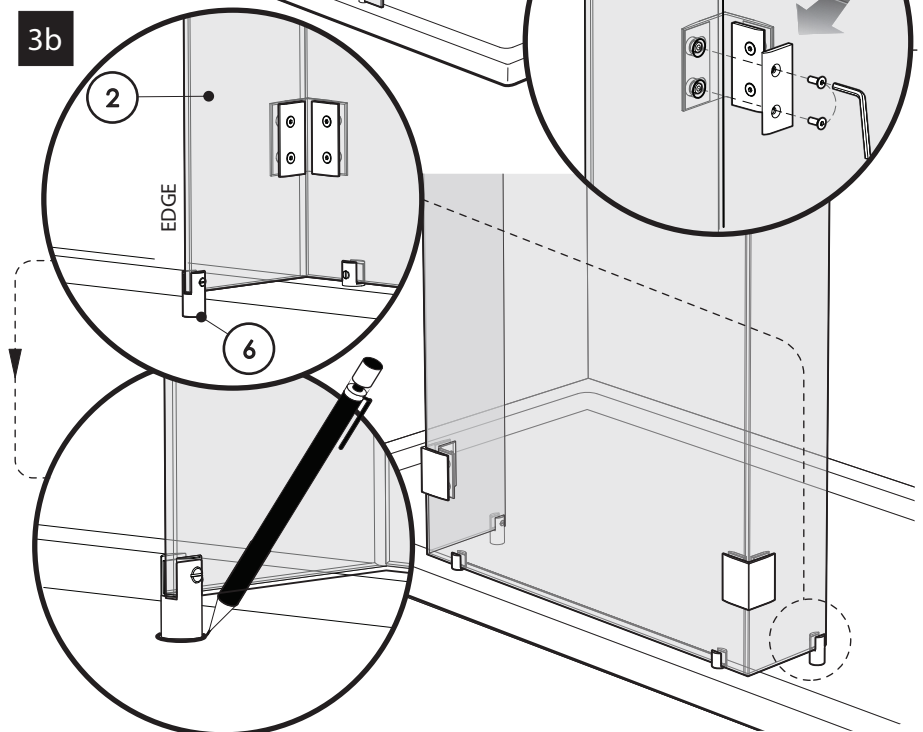

## 3

## CONTINUED

- 3c. Remove the small fixed panel by unscrewing the corner clip back plate. On the marked position drill the base with a drill bit 1/8". Put silicone onto the bottom clip bottom face groove and around the hole. Fasten it to the base with screw #6-1". Install the provided gasket.

- 3d. Placed inside the shower silicone seal along the corner between the glass panels all the way long trough out the corner clips.

3c

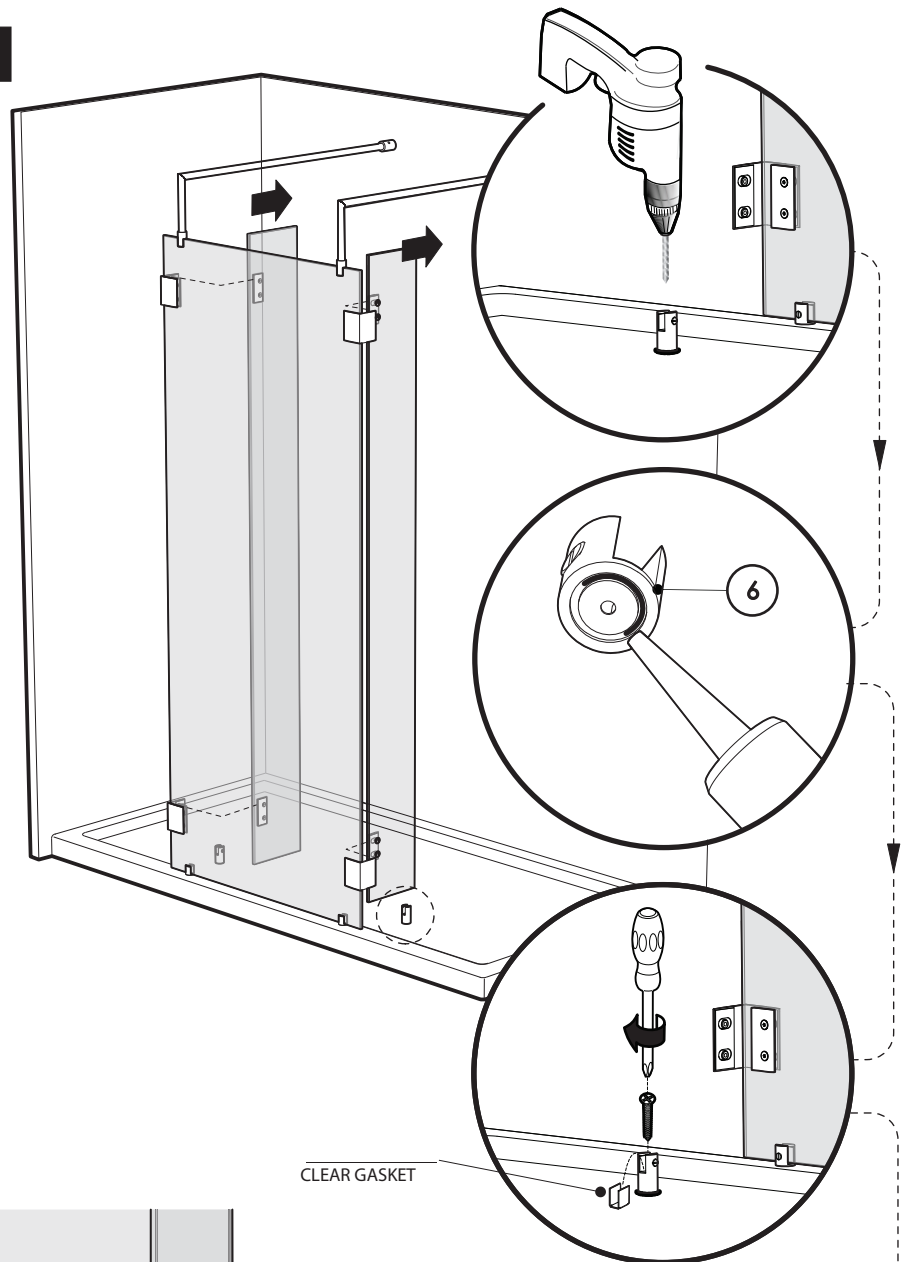

3d

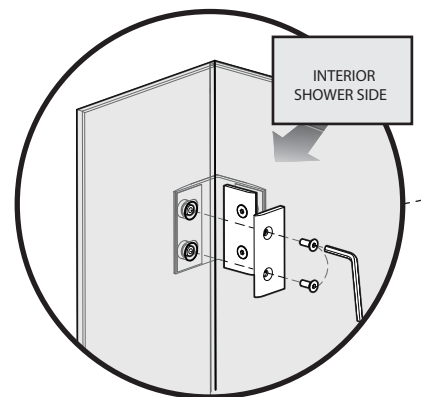
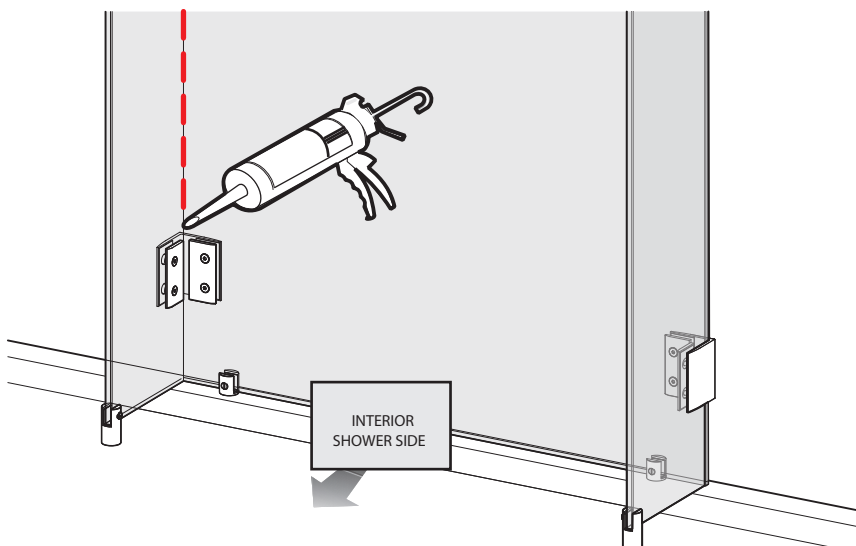



## 4

## RETURN PANEL INSTALLATION

THIS INSTALLATION PROCEDURE APPLIES FOR ALL RETURN PANEL INSTALLATIONS REGARDLESS QUANTITY OR ADDITIONAL FIXTURE AS TOWEL BAR.

- 4a. Using a measuring tape, mark the center of the threshold of the base

- 4b. Using the marking established in the previous step, run a second line up the wall. Use a level to ensure verticality of this line.

- 4c. Place the wall jamb (7) onto the wall while ensuring that the wall jamb slotted holes are centered to the center line. The side holes of the wall jamb should face the interior of the shower. Drill holes using a  $\varnothing 1/8"$  drill bit, through the wall using the wall jamb slotted holes as reference.

- 4d. Insert a drop of silicone into each hole made in the previous step. Insert a wall plug (11.1) into each hole and from there the wall jamb can be repositioned and permanently fastened using self drilling screws #8-1 1/4 (11.3).

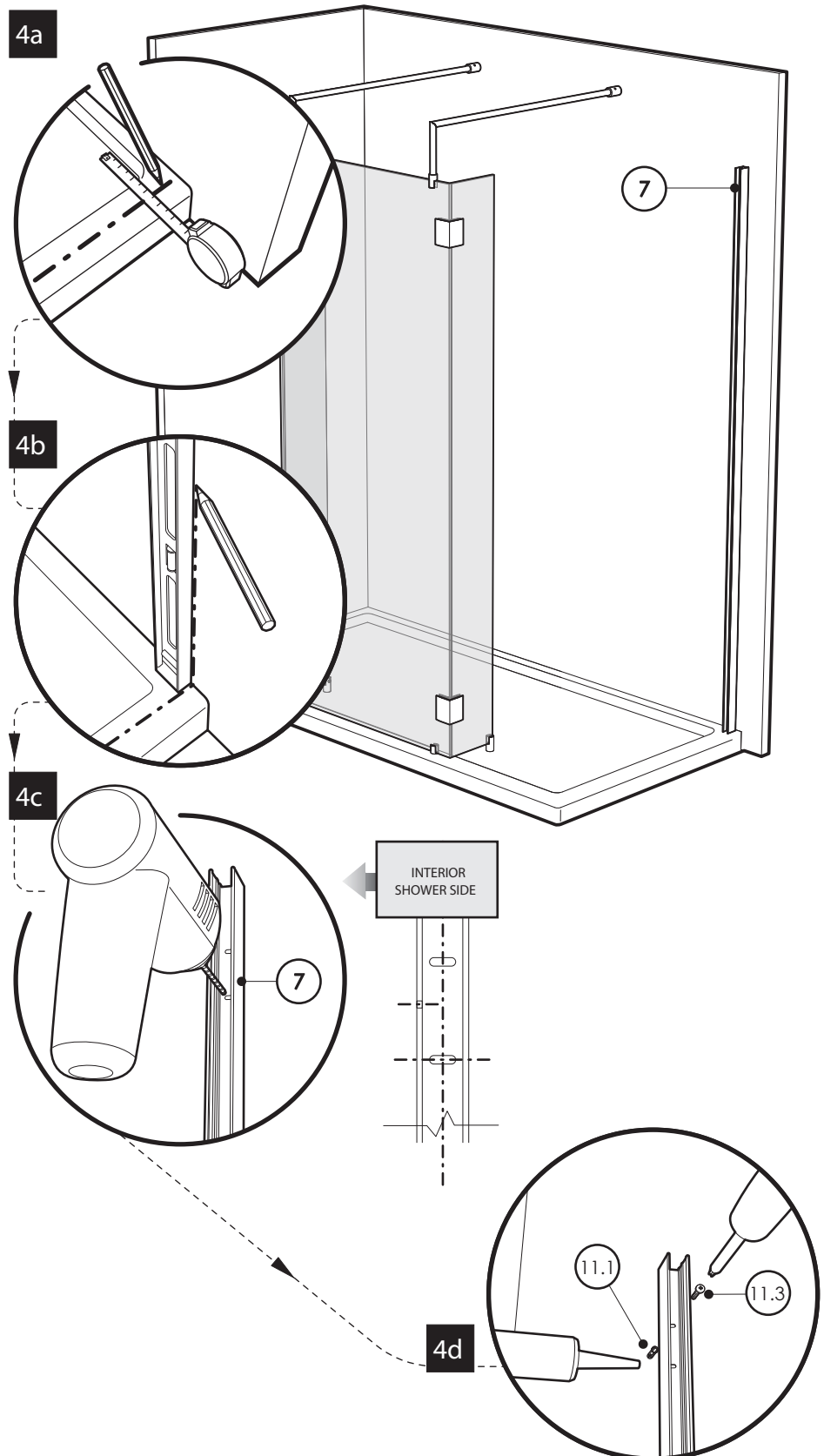

## 4

## CONTINUED

- 4e. Place the bottom clips (5) for return panel on the line traced previously following dimension shown on the plan view. Mark the screw location. Remove temporary the bottom clips to drill the base using #1/8" drill bit. Put silicone onto the bottom clip bottom face groove and around the hole. Finally, fasten the bottom clips to the base using the provided clips screws. Place the gaskets into bottom clips slots.

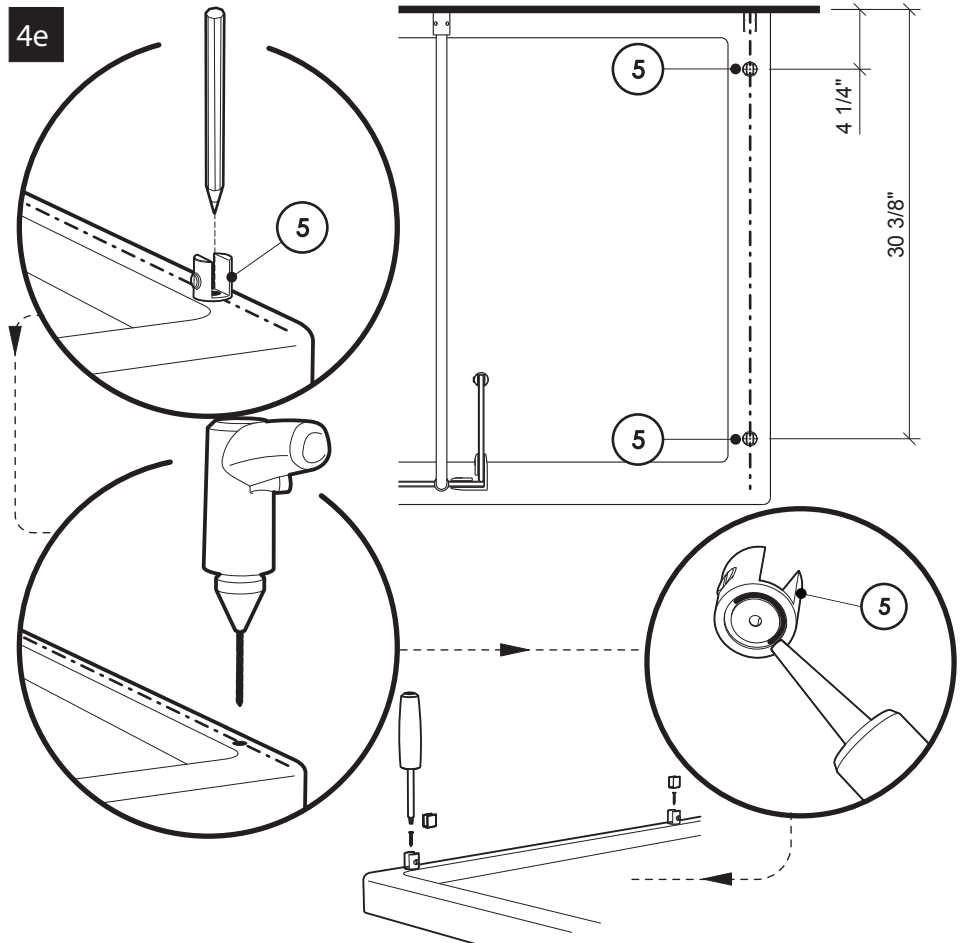

- 4f. Slide the return panel assembly into the wall jamb (7) and through the bottom clips slots. Once the return panel has been adjusted, secure the expander (8.1 & 9.1) to the wall jamb (7) by way of a clamp so as to keep the return panel level.

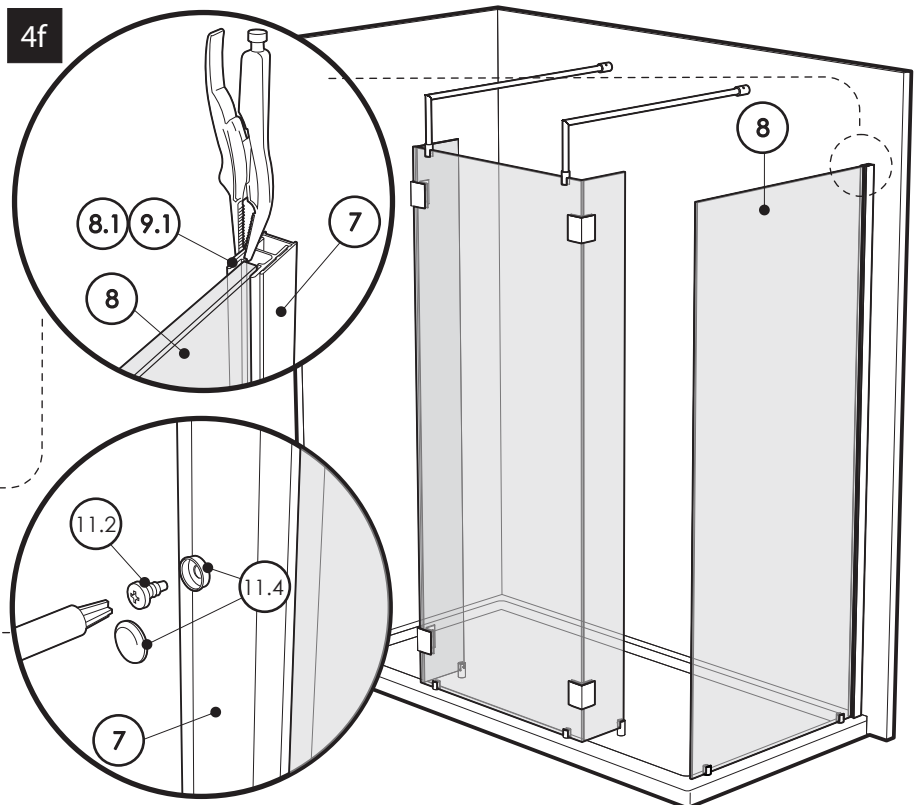

- 4g. Fasten tightly the bottom clips set screws (5).

- 4h. Secure the wall jamb (7) to the expander (8.1 & 9.1) by using #8- 3/8 screws (11.2), as well as screw caps (11.4).

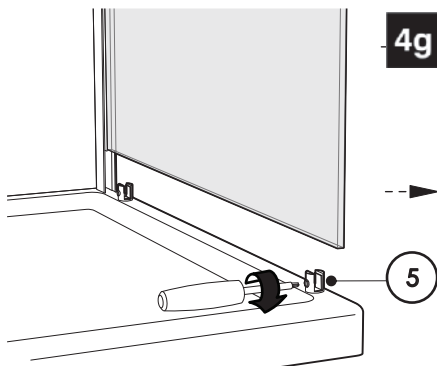

## 5 TOWEL BAR INSTALLATION

5a. Install the towel bar (10) as illustrated.

5a

5b. Silicone seal the exterior of the shower along the wall. Fill gap between glass panels and base surrounding the bottom clips (8).

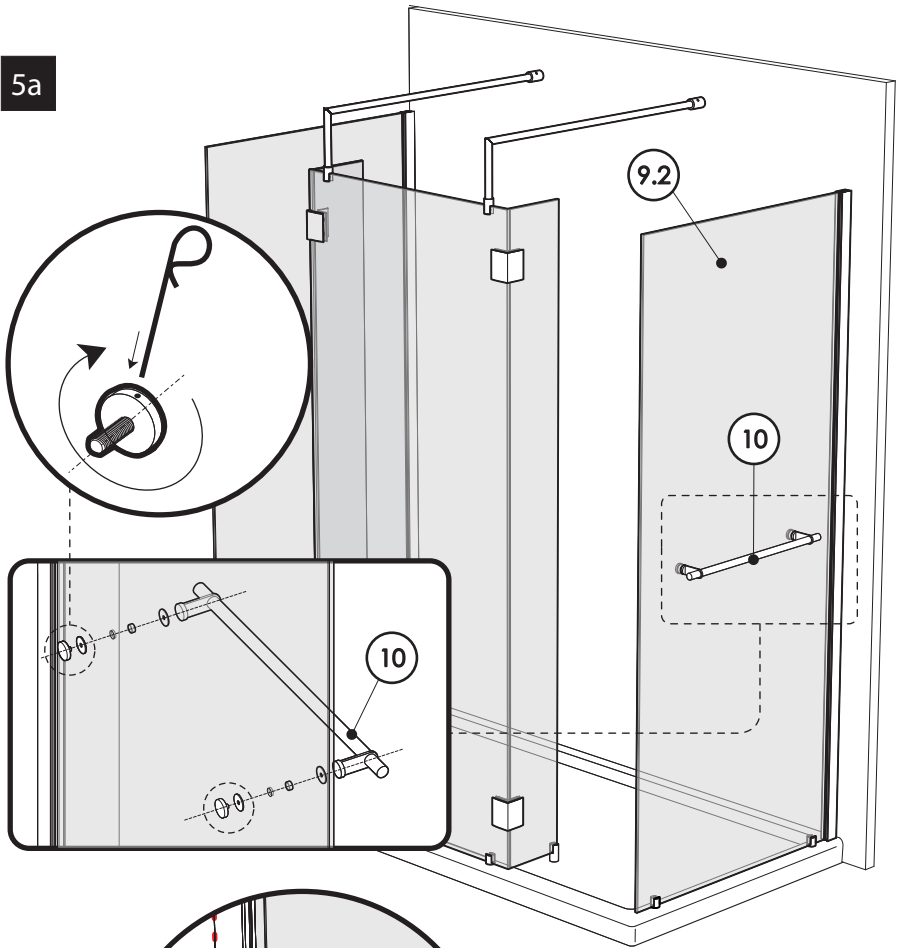

5b

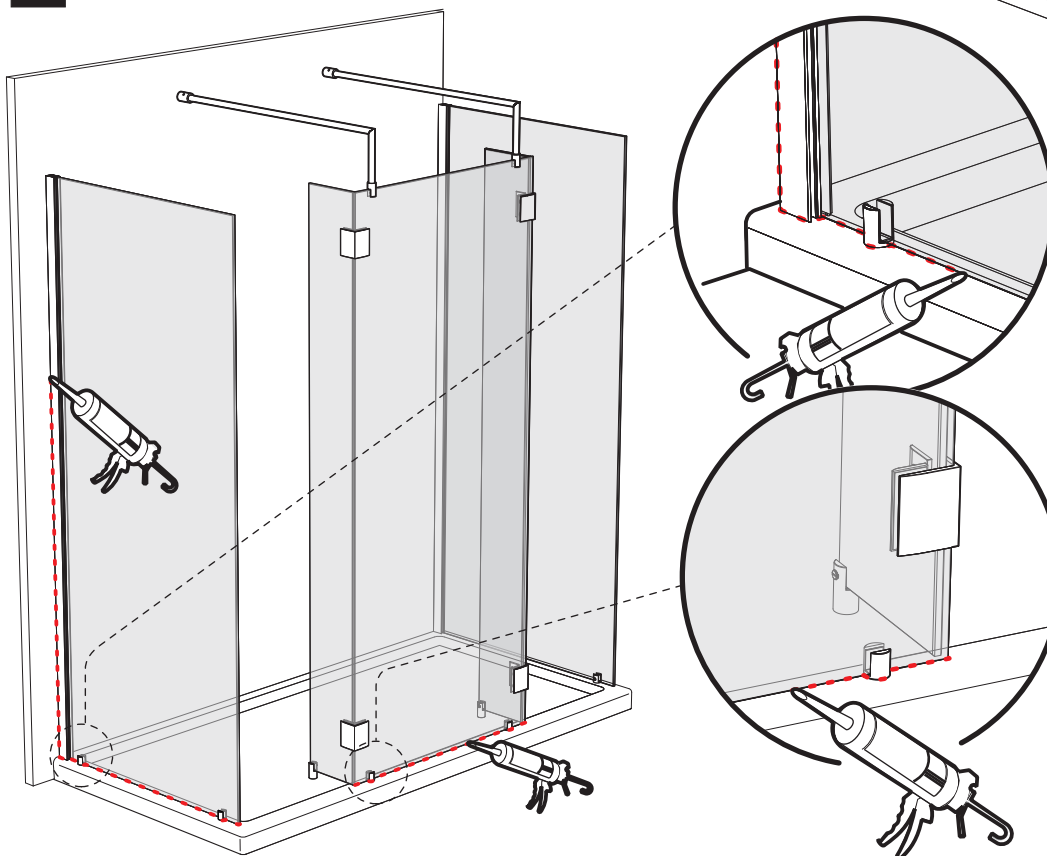

**24** HOURS