

M-92X
INSTRUCTION MANUAL

ALUMAX
Moana Collection

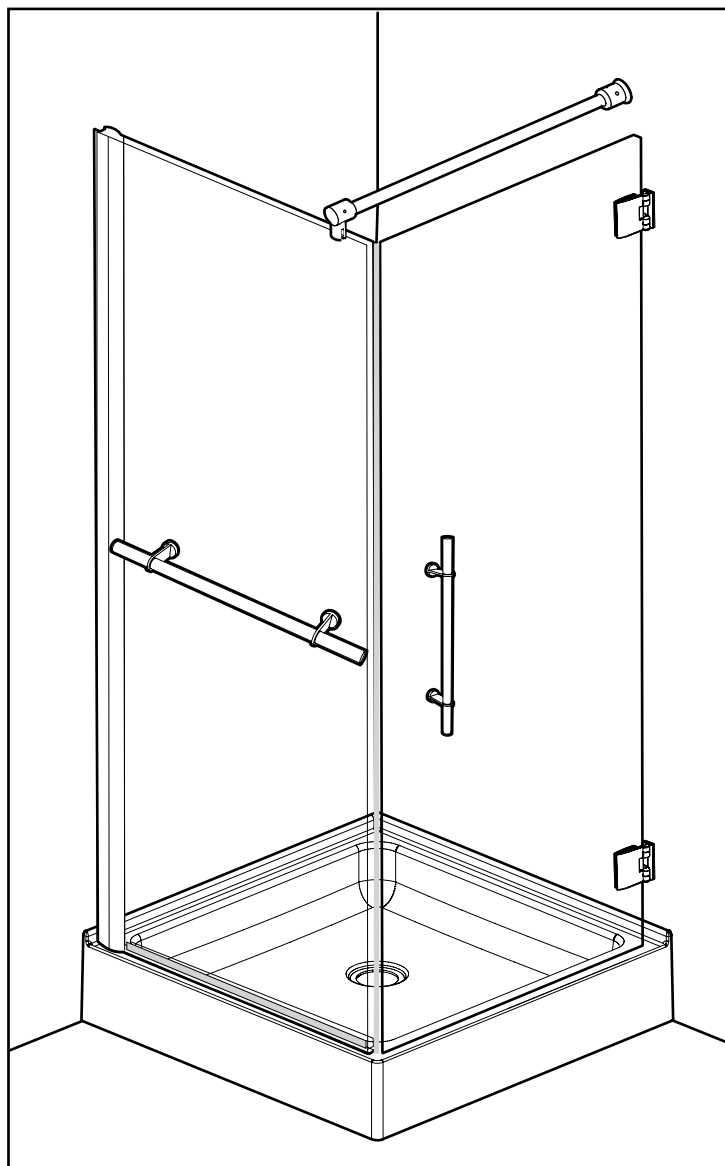

☐ *Custom Order*

FINISH

- ☐ 11- *Bright Chrome*
- ☐ 12- *Bright Brass*
- ☐ 25- *Brushed Nickel*
- ☐ 29- *Oil Rubbed Bronze*

GLASS

- ☐ 40- *Clear*

*Please keep this manual and product code number for future reference
and to order replacement parts if necessary.*

- **Table of Contents**

GENERAL INSTRUCTIONS	3
INSTALLATION OVER CERAMIC TILES.....	3
NOTICE.....	3
CARE FOR YOUR FRAMELESS SHOWER DOOR	3
PARTS LISTING.....	4
PROVIDED HARDWARE.....	5
TOOLS AND MATERIALS REQUIRED	5
1. DETERMINE HINGES LOCATION.	6
2. FASTEN THE HINGES TO THE WALL.	7
3. PREASSEMBLE THE DOOR.....	7
4. INSTALL THE DOOR PANEL.....	8
5. INSTALL THE DOOR HANDLE.	8
6. MOUNT THE WALL JAMB.	9
7. POSITION THE FIXED PANEL.	10
8. FASTEN THE “U” CHANNEL.	11
9. INSTALL THE FIXED PANEL.....	11
10. FASTEN THE SUPPORT BAR.	12
11. INSTALL THE TOWEL BAR.	13
12. INSTALL THE DOOR GASKETS.....	13
12. INSTALL THE DOOR GASKETS (CONTINUED).....	14
13. SILICONE SEAL THE SHOWER.	15

- **General Instructions**

- Read this manual carefully and completely before proceeding.
- It is recommended that you wear safety glasses at all times during the installation.

- **Installation over Ceramic Tiles**

- Silicone should be used to seal the gap where the ceramic tiles meet the fixed panel.
- If your shower door is to be installed over ceramic tiles, the tiles should lay completely under the wall jamb.

- **Notice**

- Caulking: no sealant is required inside the shower.
- All models are equipped with transparent sealing gaskets.

- **Care for your Frameless Shower Door**

- Never use scouring powder pads or sharp instruments on metal pieces or glass panels.
An occasional wiping down with a mild soap diluted in water is all that is needed to keep the panels and aluminum parts looking new.
- We recommend wiping the glass panels with a squeegee after each use.

<p>Product specifications are subject to change without notice.</p>
--

PARTS LISTING

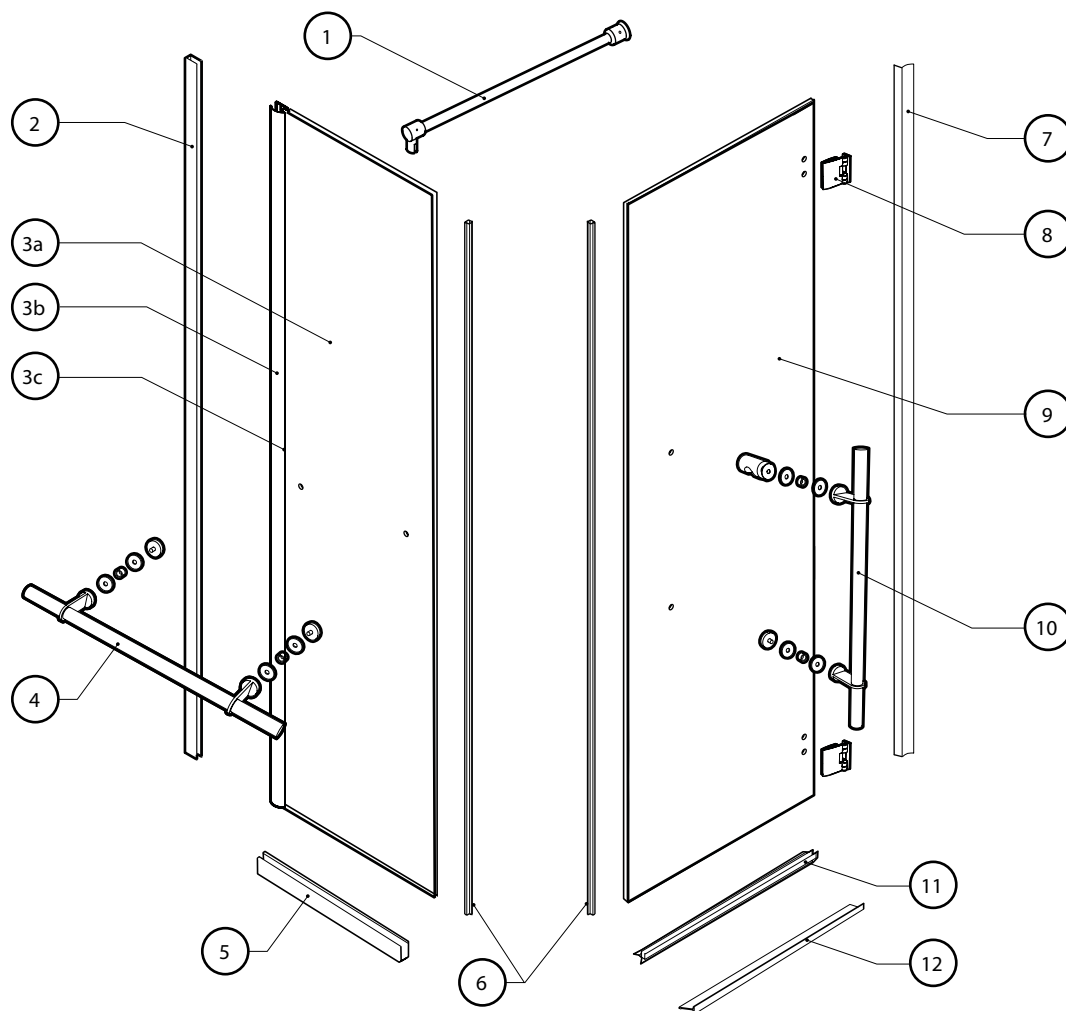

ITEM	PARTS	QTY
1	SUPPORT BAR	1
2	WALL JAMB (TEMPLATE)	1
3a	SIDE PANEL	1
3b	EXPANDER	1
3c	GASKET	1
4	TOWEL BAR	1
5	ALUMINUM "U" CHANNEL	1
6	MAGNETIC DOOR GASKET	2
7	SIDE GASKET	1
8	SQUARE WALL MOUNT HINGE	2
9	DOOR PANEL	1
10	HANDLE BAR	1
11	BOTTOM DOOR GASKET	1
12	THRESHOLD	1

PROVIDED HARDWARE

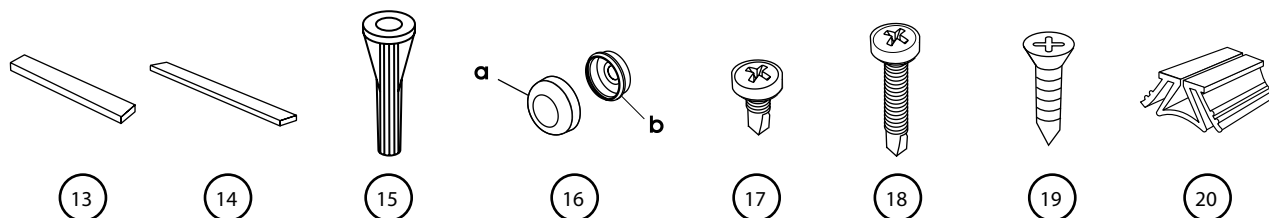

ITEM	HARDWARE	QTY
13	CLEAR SETTING BLOCK	2
14	CLEAR SETTING BLOCK	2
15	WALL PLUG	4
16	SCREW CAP	4
17	SELF DRILLING SCREW #8-3/8	3
18	SELF-DRILLING SCREW #8-1 1/4	3
19	FLAT HEAD SCREW #6-3/4	1
20	SPACING BLOCKS	2

TOOLS AND MATERIALS REQUIRED

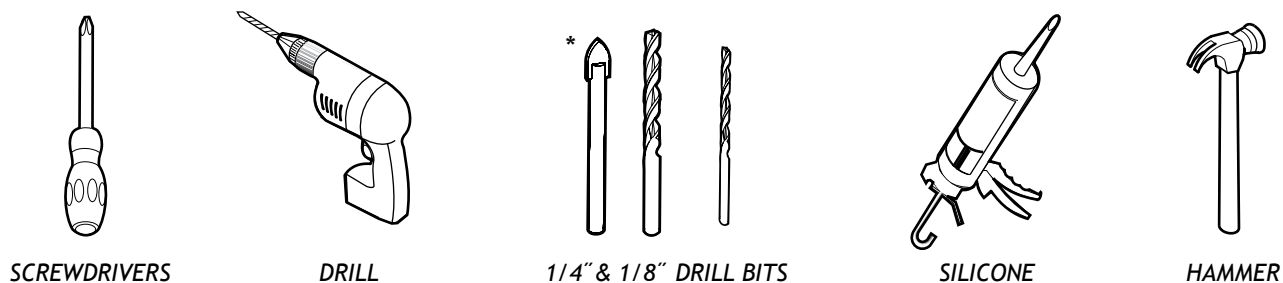

**If the shower panels are to be assembled on ceramic tiles, use a 1/4" drill bit for ceramic tiles.*

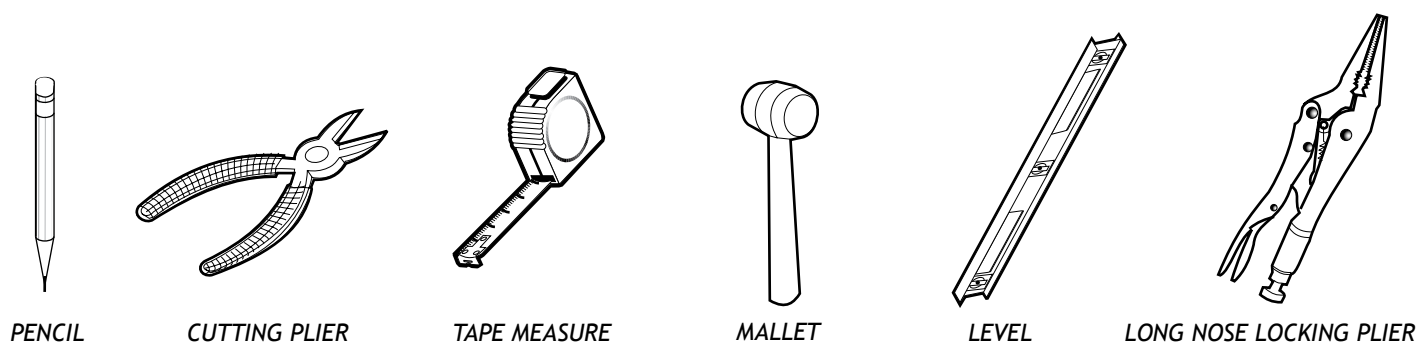

1 DETERMINE HINGES LOCATION.

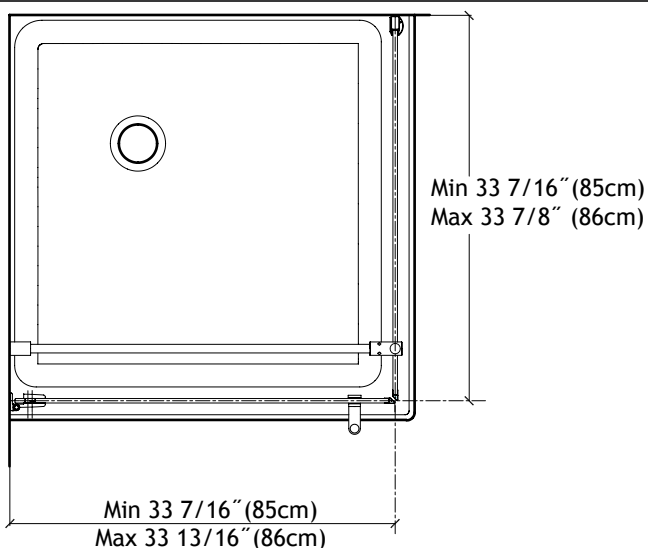

USE THE WALL JAMB (#2) AS TEMPLATE TO MARK DRILLING LOCATIONS FOR WALL-MOUNTED HINGES.



WALL-MOUNTED HINGES MUST BE SUPPORTED AND FASTENED INTO A STUD FRAMING.

- 1A. Determine on which side the hinges will be mounted. It is recommended to install the hinges on the same side as the showerhead.
- 1B. Trace a centerline on the threshold and run it up along the wall.
- 1C. Place the wall jamb (#2) on the threshold by centering the slotted holes with the centerline.
- 1D. Mark the drilling locations at the top and bottom of the wall jamb. Drill a hole at each location with a 1/4" drill bit.

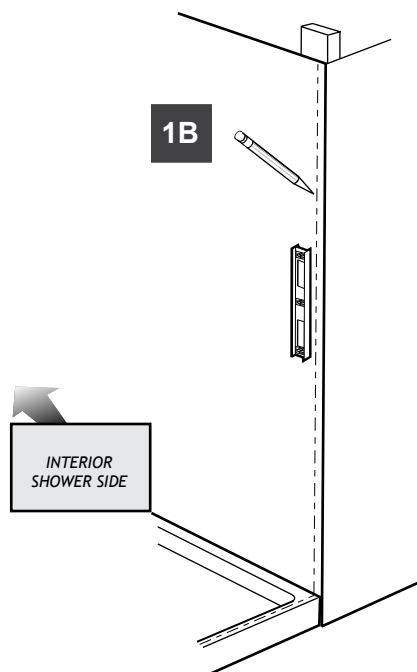

RIGHT CONFIGURATION SHOWN

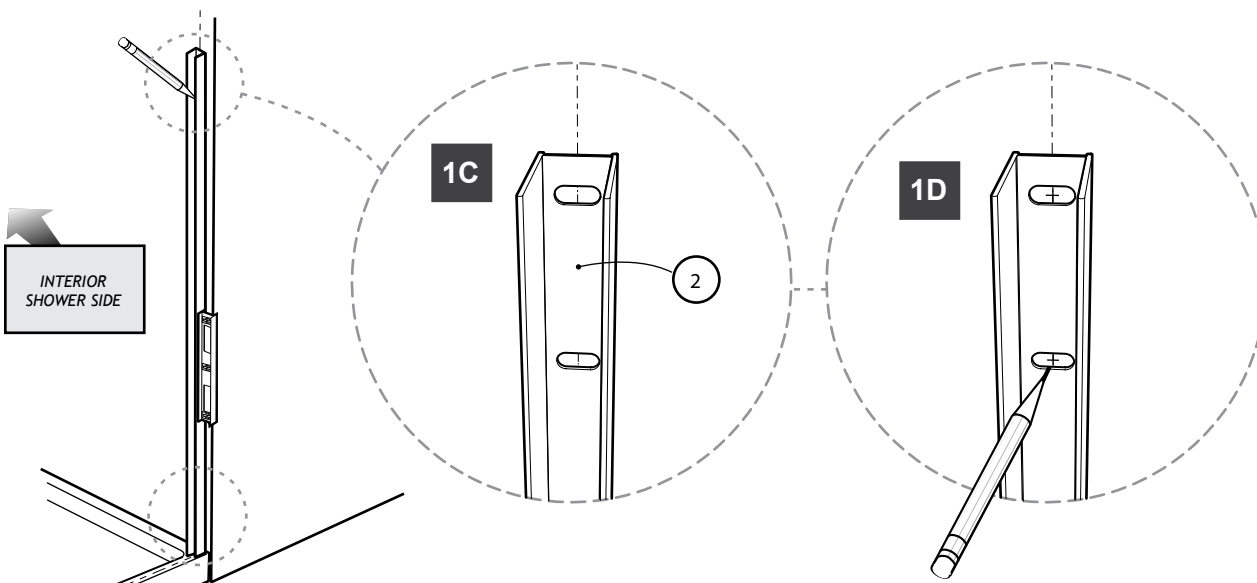

2 FASTEN THE HINGES TO THE WALL.

2A. Fasten the hinges (#8) to the wall as illustrated.

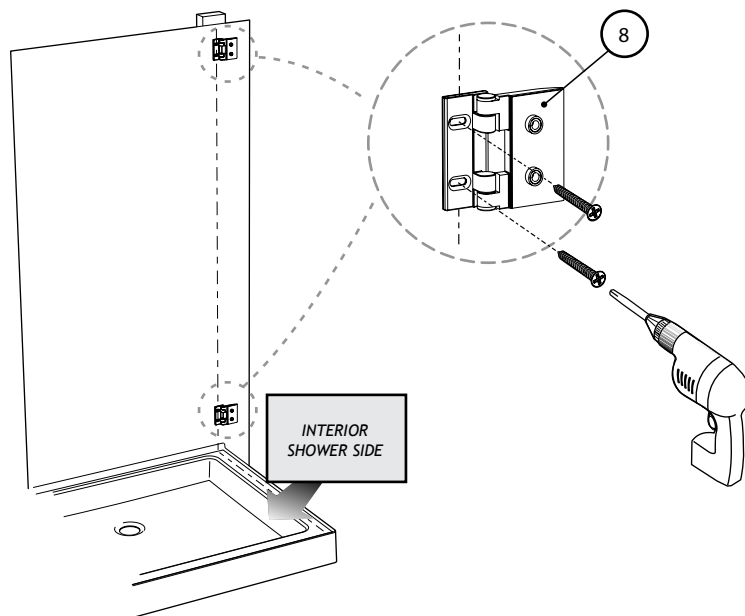

3 PREASSEMBLE THE DOOR.

3A. Rest the door panel (#9) on a flat surface. Temporarily insert the bottom door gasket (#11) under the door panel.

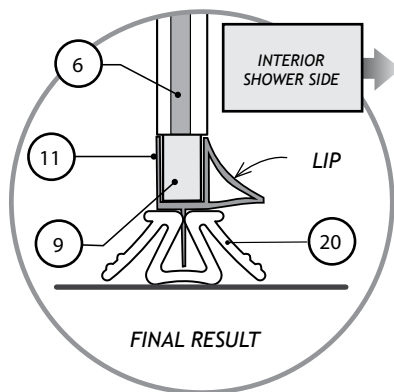

3B. Install the 2 spacing blocks (#7) onto the bottom lip of the gasket.

3C. Place the magnetic gasket (#6) on top of the bottom door gasket (#11) and insert it on the door panel using a mallet.

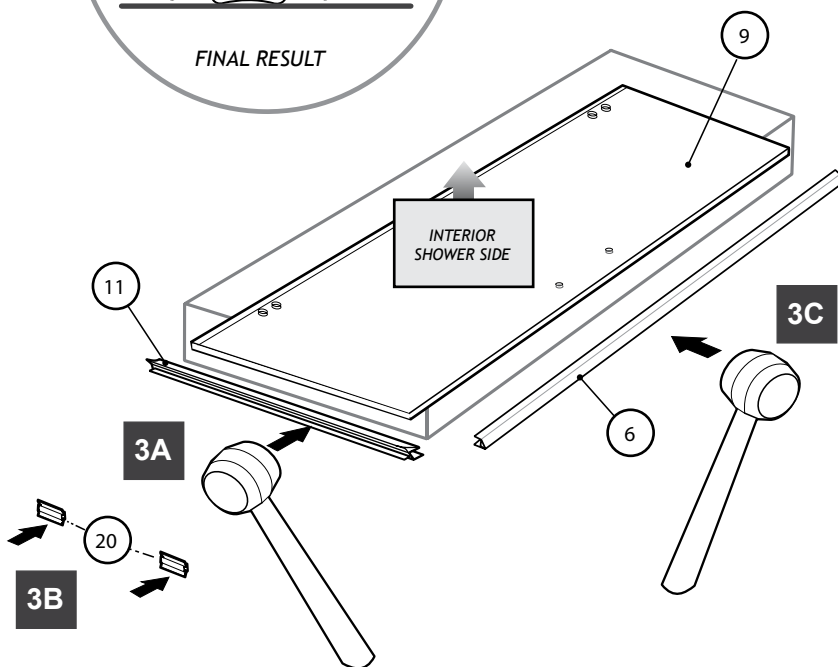

4 INSTALL THE DOOR PANEL.



IT IS BEST TO HAVE 2 PEOPLE
WORKING ON THIS STEP.

4A. Place the door assembly on the shower threshold and level it.

4B. Fasten the hinges as illustrated using the Allen key.

4C. Remove the spacing blocks (#20) and the bottom door gasket (#11).

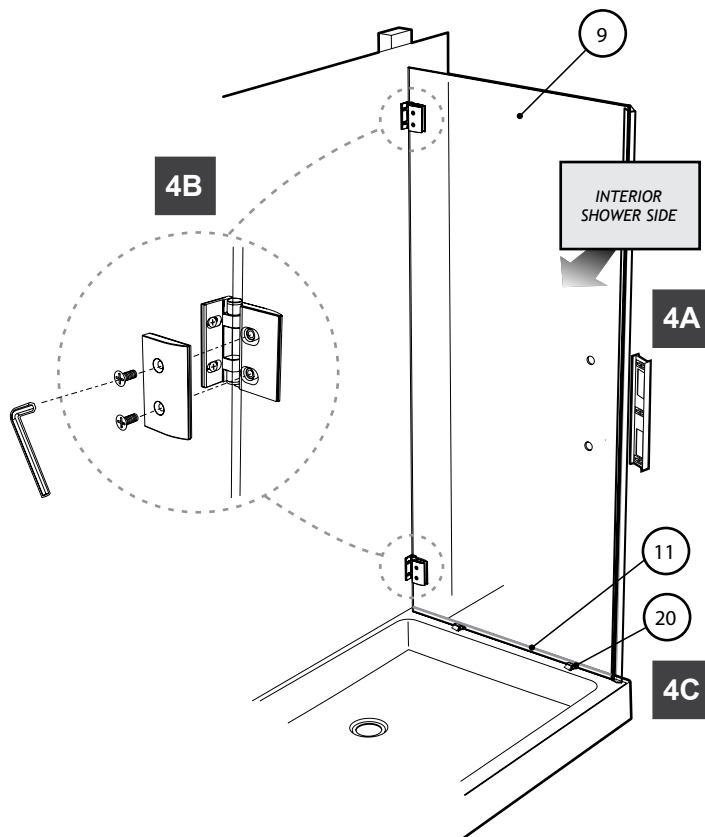

5 INSTALL THE DOOR HANDLE.

5A. Install the straight door handle (#10) as illustrated.

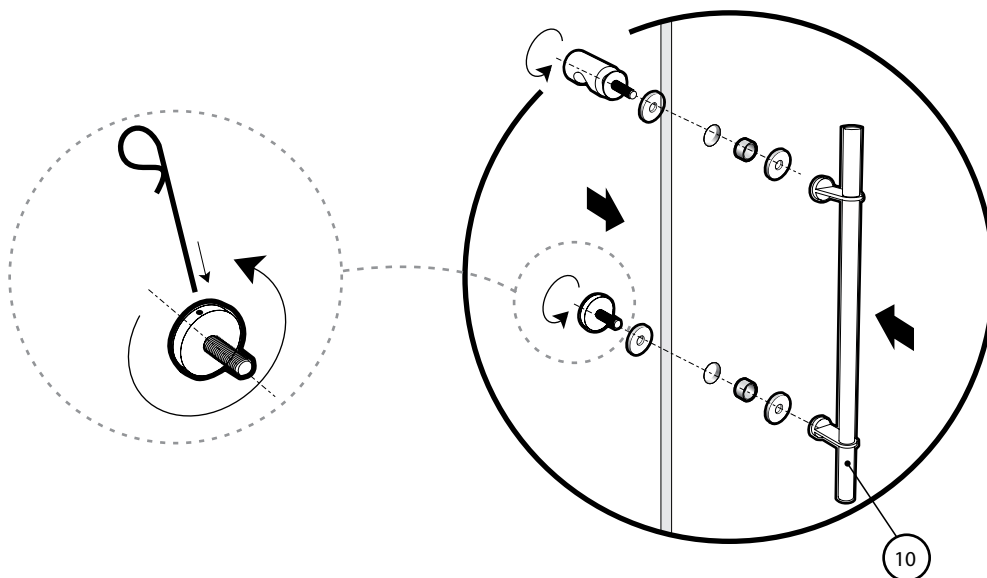

6 MOUNT THE WALL JAMB.

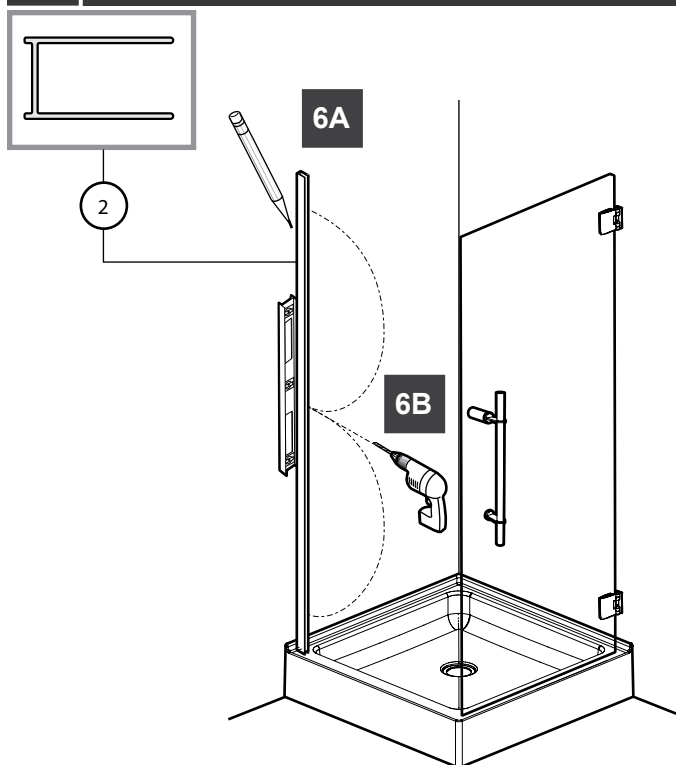

6A. Place the wall jamb (#2) on the center of the threshold and align it using a level. Trace the outer edge of the wall jamb and the holes onto the wall. Remove the wall jamb.

6B. With a 1/4" drill bit, drill 3 holes into the wall using the marks as a guide.

6C. (a) Should you find the wood studs directly behind the drilled hole location, skip this step.
(b) Insert the wall plugs (#15) and put in each a drop of silicone.

6D. Secure the wall jamb using the 1 1/4" screws (#18).

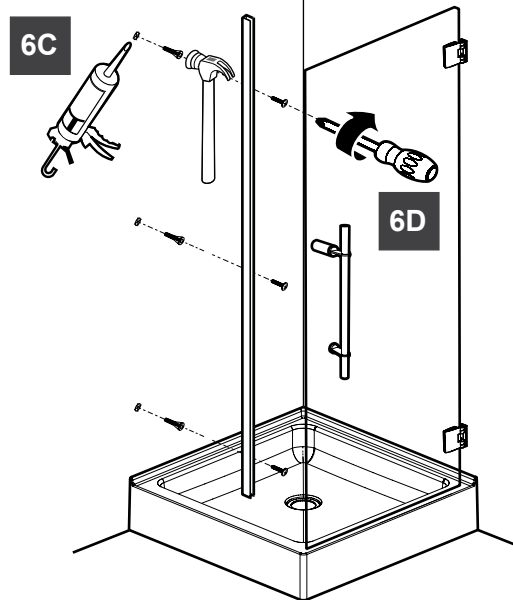
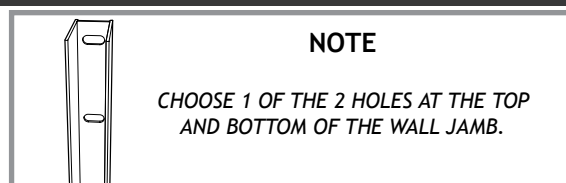

6C(a)
TOP VIEW

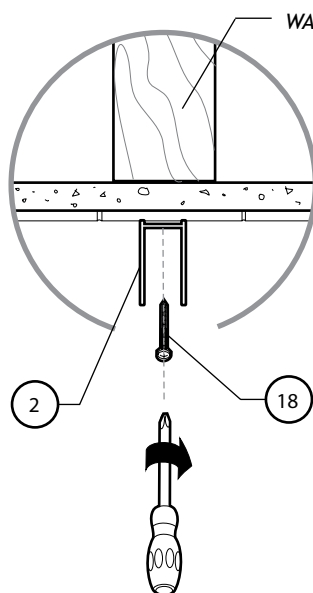

6C(b)
TOP VIEW

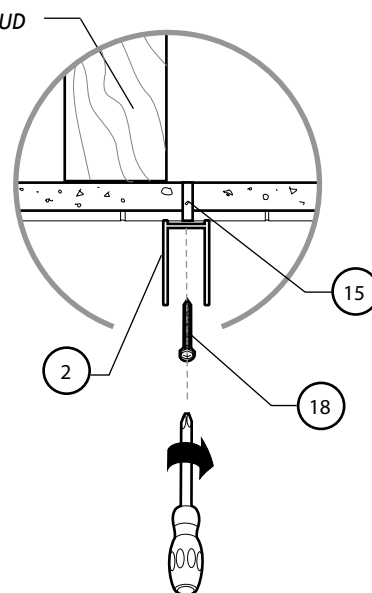

7 POSITION THE FIXED PANEL.

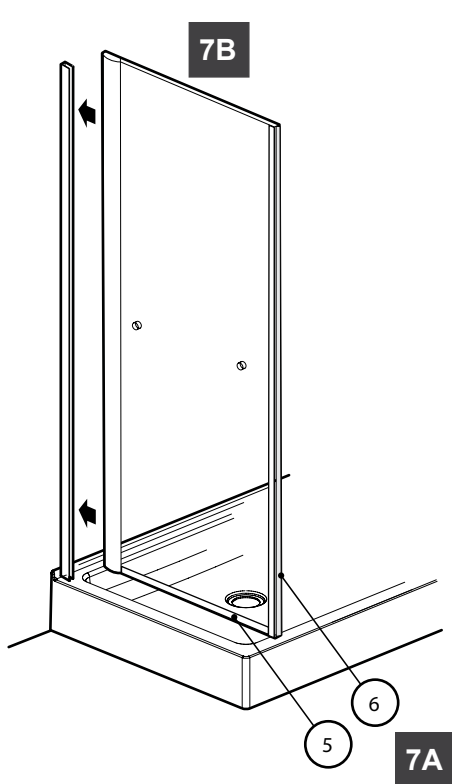

7A. First, insert the other magnetic gasket (#6) onto the fixed panel using the mallet and position the aluminium "U" (#5) underneath.

7B. Slide the fixed panel over the wall jamb.

7C. Adjust and level the glass panels. The magnetic gaskets must be aligned and in contact.

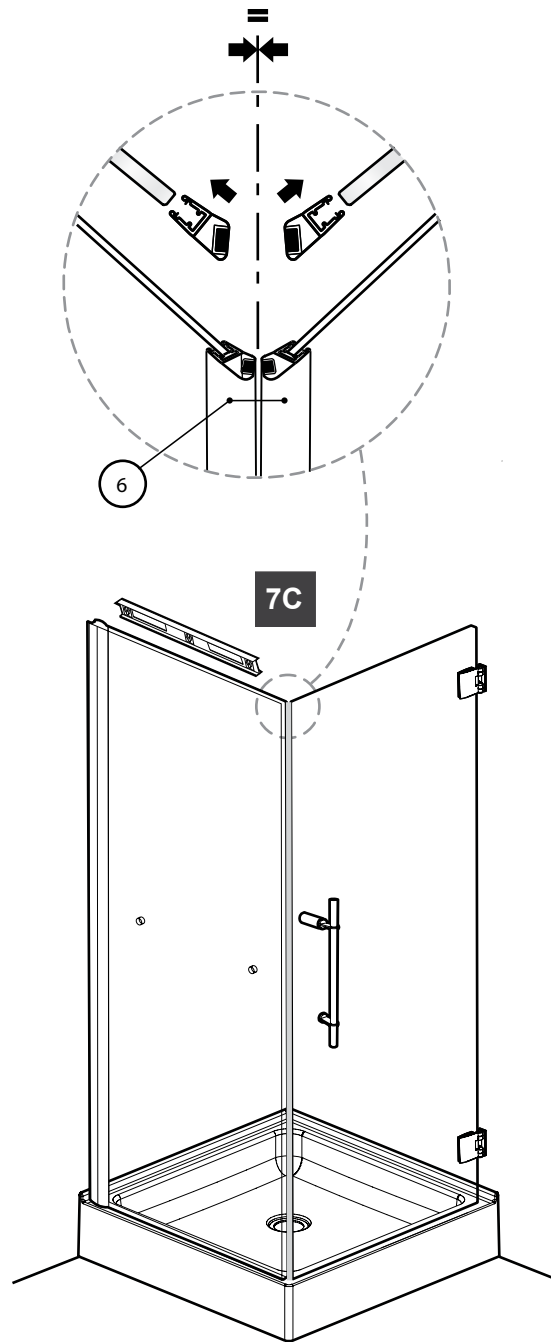

IF MORE ADJUSTMENTS ARE NEEDED, INSERT OTHER SETTING BLOCKS (#13&14) IN THE "U" CHANNEL.

Step

3

SLIDE THE FIXED PANEL
OVER THE WALL JAMB

ON BOTH SIDE

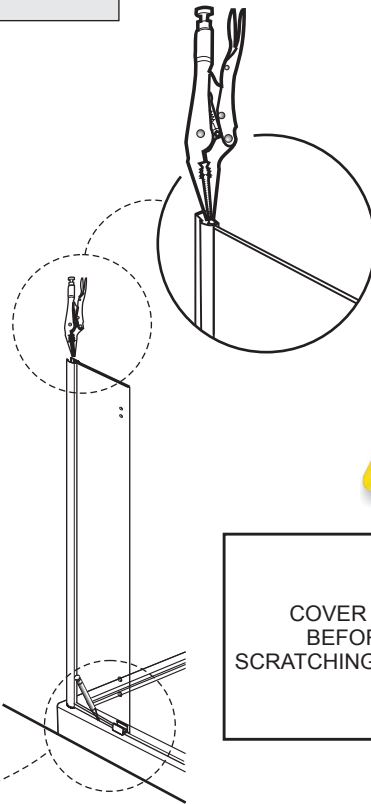
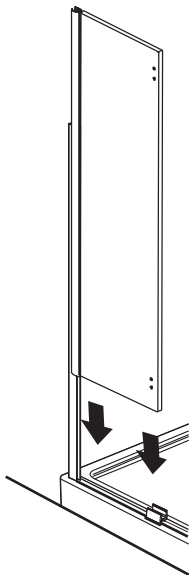
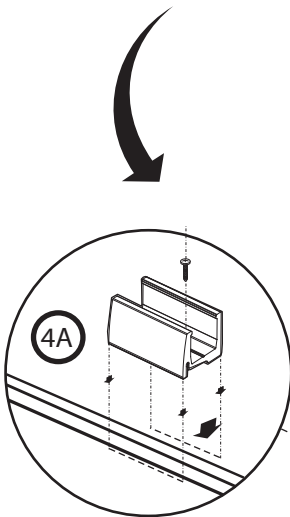
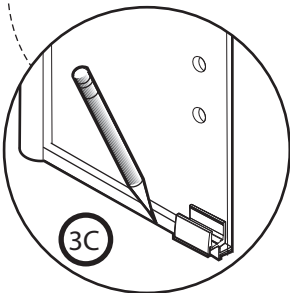
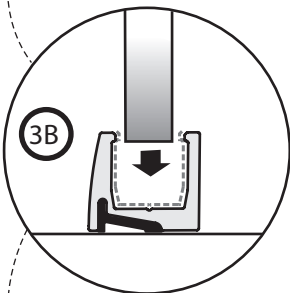
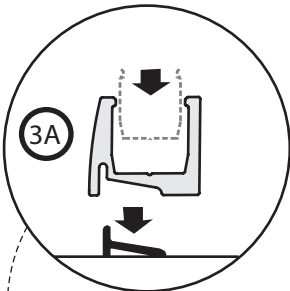

COVER THE PLIER'S TEETH
BEFOREHAND TO AVOID
SCRATCHING THE ALUMINIUM PARTS.

Step

5

FASTEN (TEMPORARILY) FIXED PANELS (1)

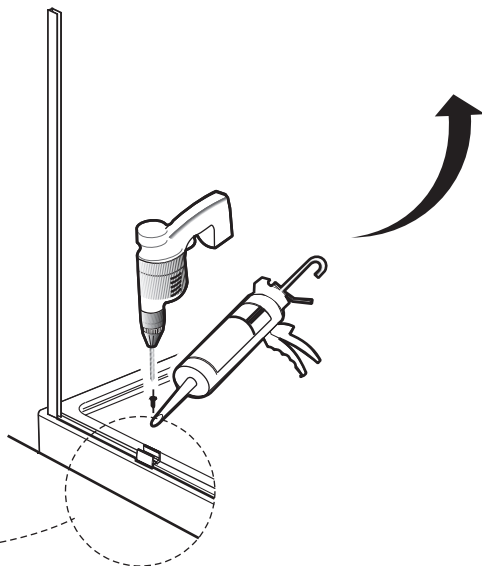

Step

4

FASTEN THE THRESHOLD (1)

8 FASTEN THE "U" CHANNEL.

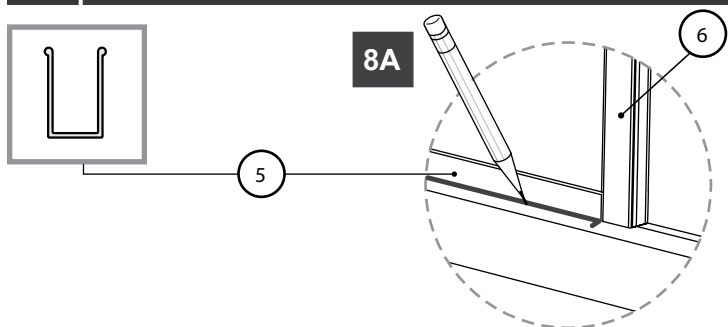

8A. Mark the location of the aluminum "U" channel (#5) on the threshold. Remove the fixed panel.

8B. Realign the aluminum "U" channel on the threshold and drill a hole using a 1/8" drill bit at about 2" from the edge. Put a drop of silicone in the hole and fasten the "U" channel with a 3/4" long screw (#19). Place the clear setting block (#14) back over the screw.

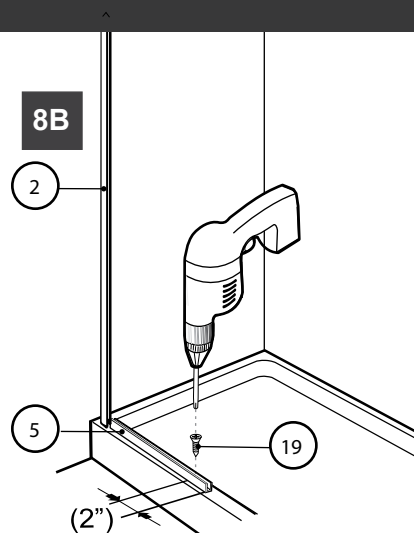

OPTIONAL

RUN A BEAD OF SILICONE IN THE ALUMINUM "U" CHANNEL.

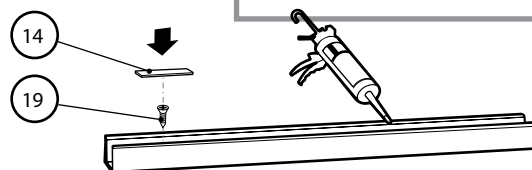

9 INSTALL THE FIXED PANEL.

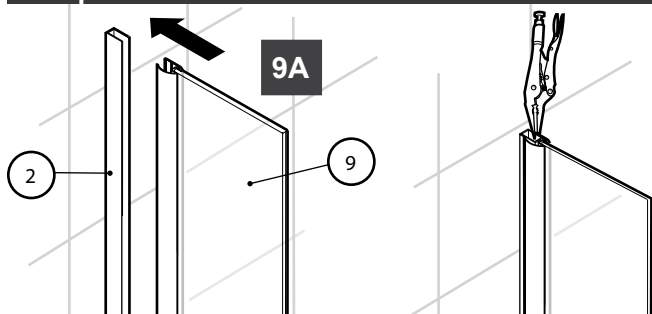

9A. Reposition the fixed panel on the wall jamb and in the aluminum "u" channel. Secure it with the locking plier.

9B. Combine the 3 3/8" screws (#17) with the inner screw caps (#16b). Fasten the fixed panel.

9C. Snap the screw caps (#16a) on the screws.

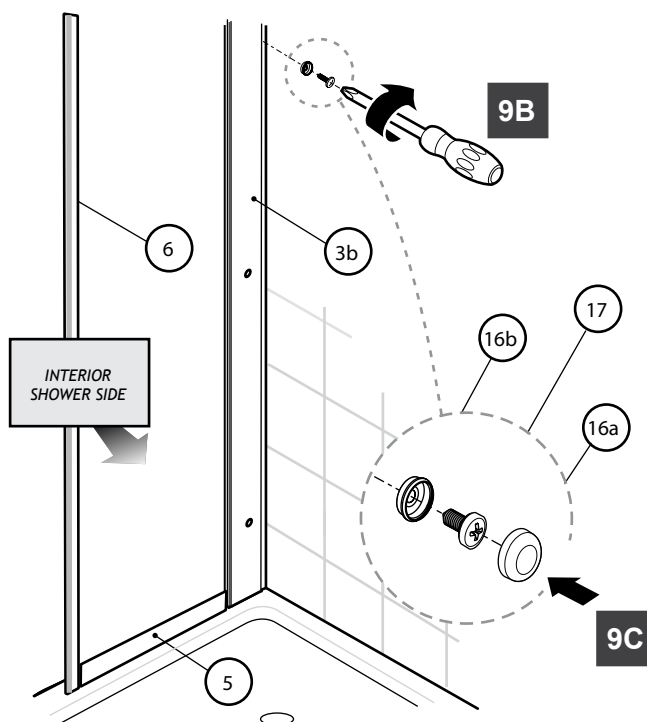

10 FASTEN THE SUPPORT BAR.

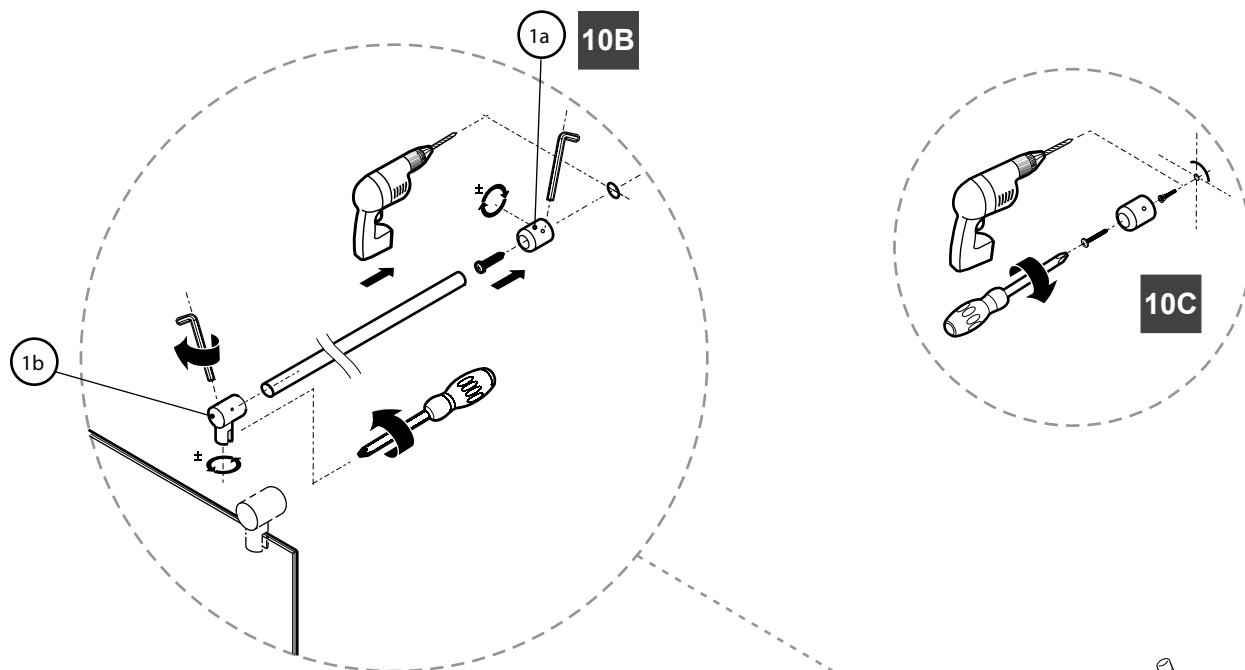

10A. Rest the support bar (#1) on the fixed panel inside the shower. Level it and trace an arc on the wall.

10B. Loosen the set screws in the connector (1a & 1b).

10C. Locate the screw position using the cylindrical part. With a 1/4" drill bit, drill a hole in the wall and insert a wall plug (#15).

10D. Put the bar back in place. Tighten all the screws.

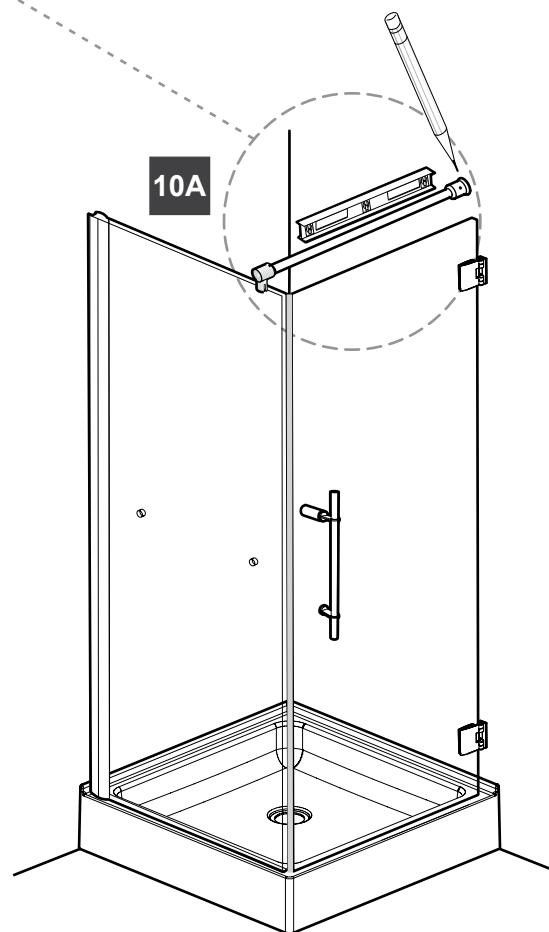

11 INSTALL THE TOWEL BAR.

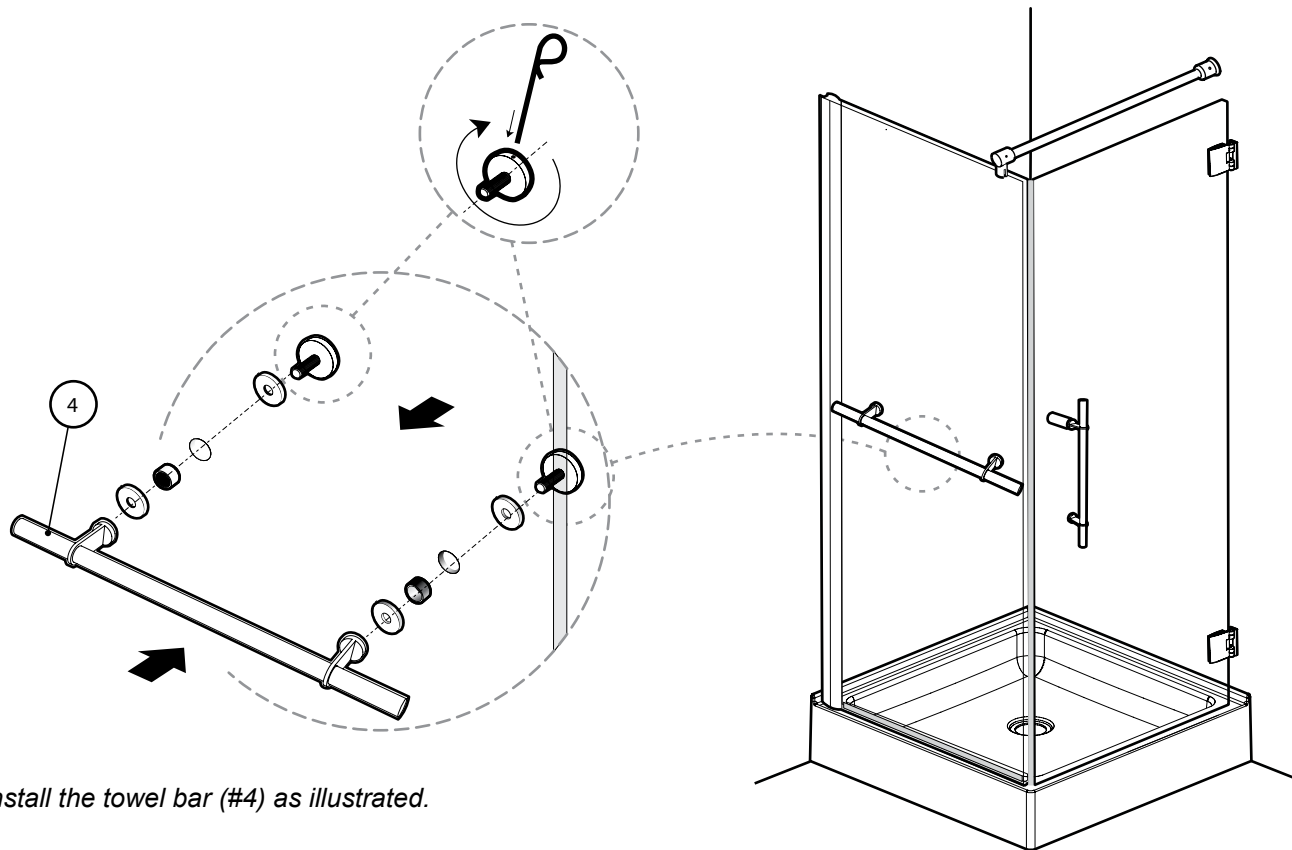

11A. Install the towel bar (#4) as illustrated.

12 INSTALL THE DOOR GASKETS.

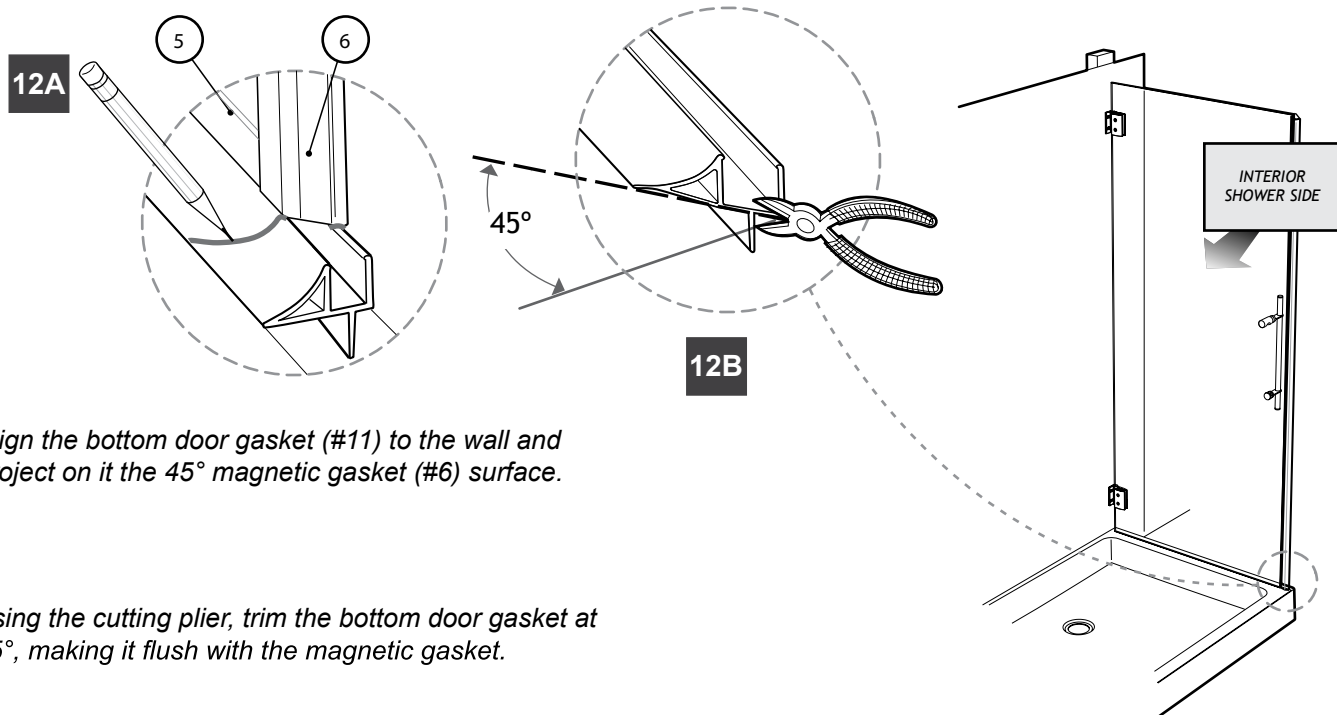

12A. Align the bottom door gasket (#11) to the wall and project on it the 45° magnetic gasket (#6) surface.

12B. Using the cutting plier, trim the bottom door gasket at 45°, making it flush with the magnetic gasket.

12 INSTALL THE DOOR GASKETS (CONTINUED).



PRIOR TO APPLY SIDE GASKET MAKE SURE THAT GLASS PANEL EDGE IS CLEAN

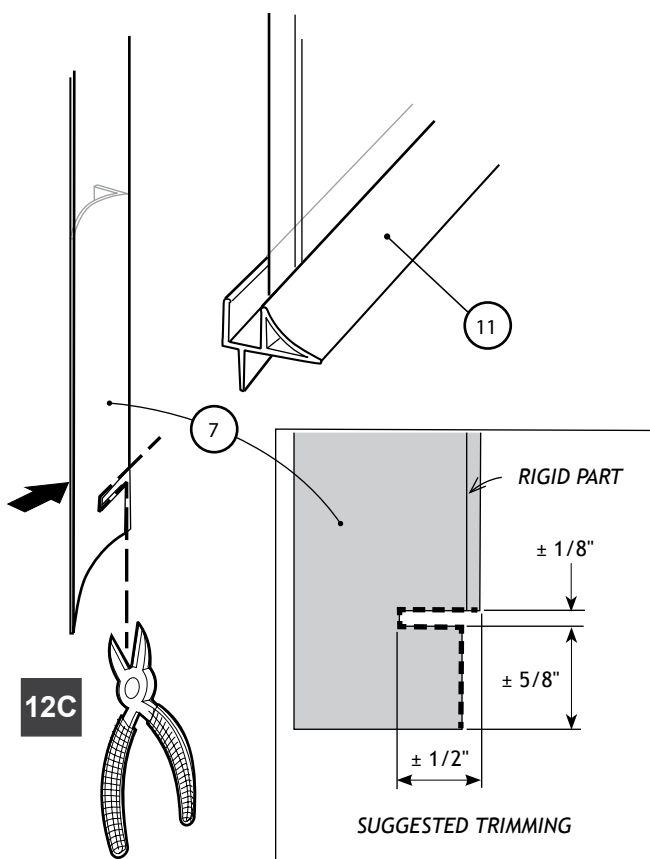

12C. Open the door and clean the door panel surface on which the door side gasket (#7) will be placed. Align it to the threshold and notch it to fit the bottom door gasket. Make sure it is oriented as illustrated.

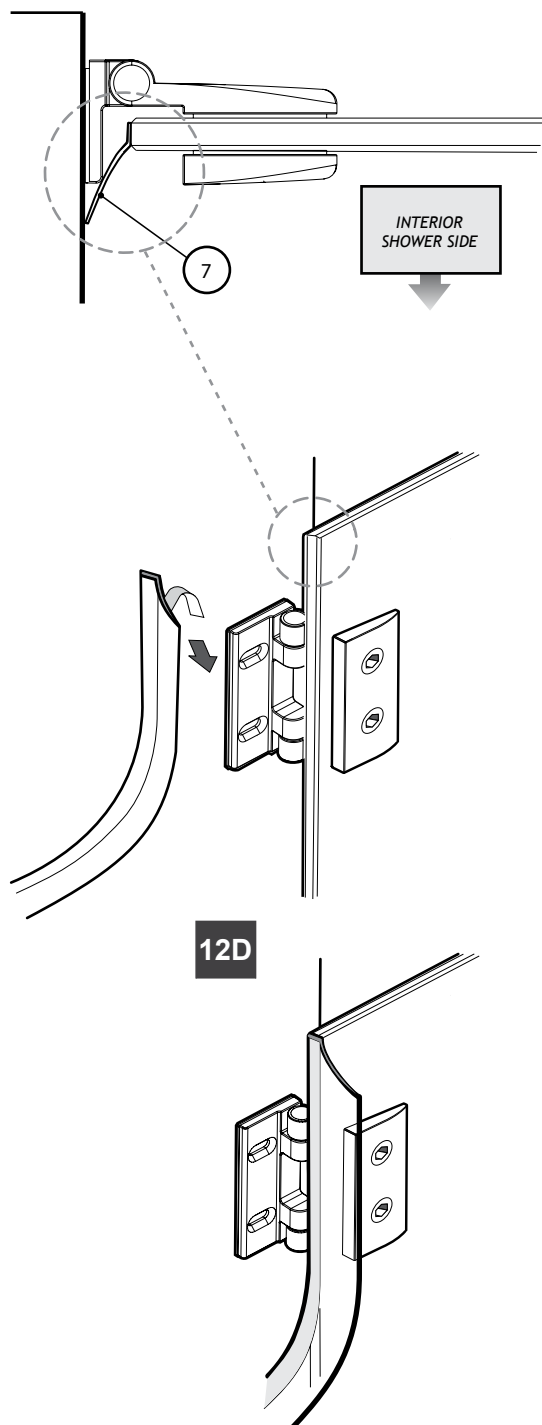

12D. Stick the door side gasket on the door panel.

13 SILICONE SEAL THE SHOWER.

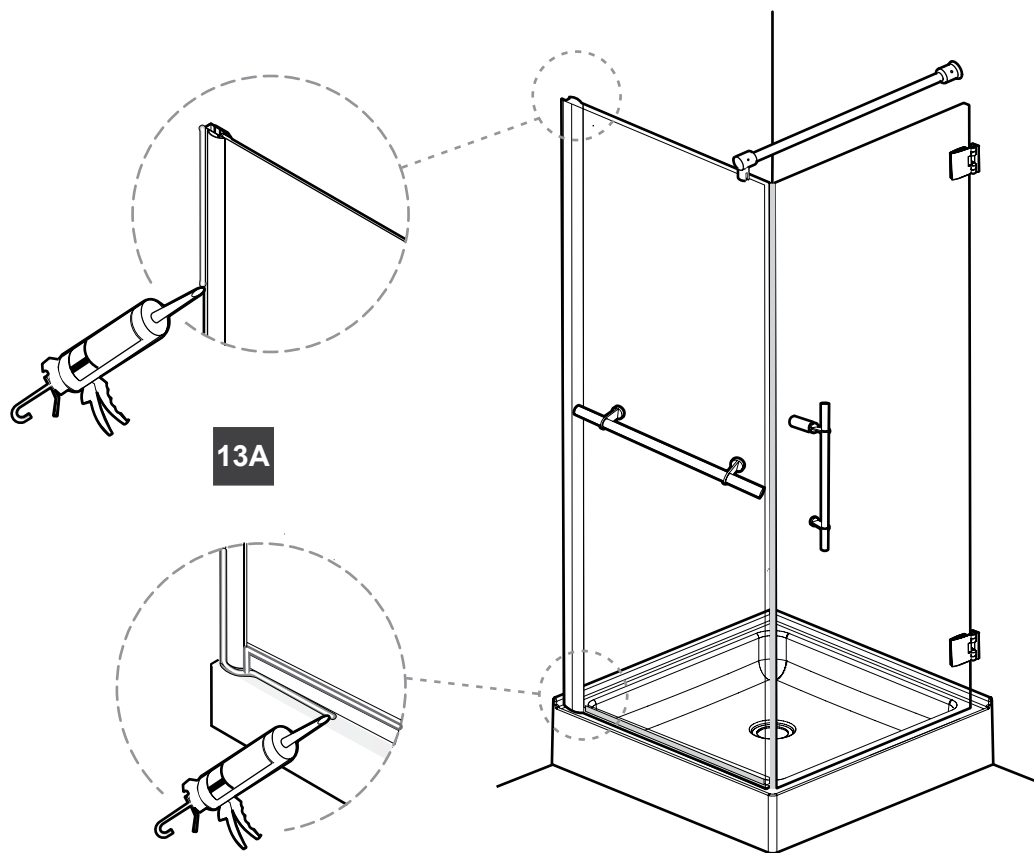

13A. Silicone seal the exterior of the shower along the wall and the aluminum "u" channel (#5).

13B. Position the threshold (#12) under the door panel as illustrated. Lift it to pass a bead of silicone underneath. Apply silicone on the outside edges.

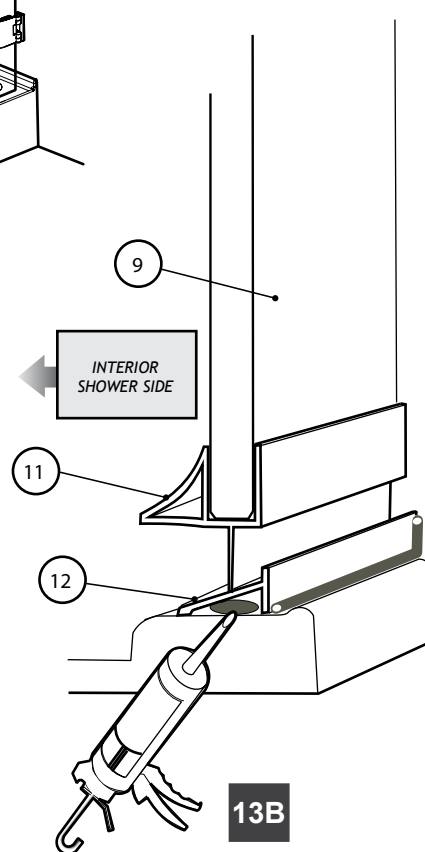

24 HOURS



WE RECOMMEND TO HOLD THE THRESHOLD (#12) IN PLACE WITH TAPE WHILE DRYING.