

M-CDPY-66
INSTRUCTION MANUAL

ALUMAX
Moana Collection

Curved glass Panel and door

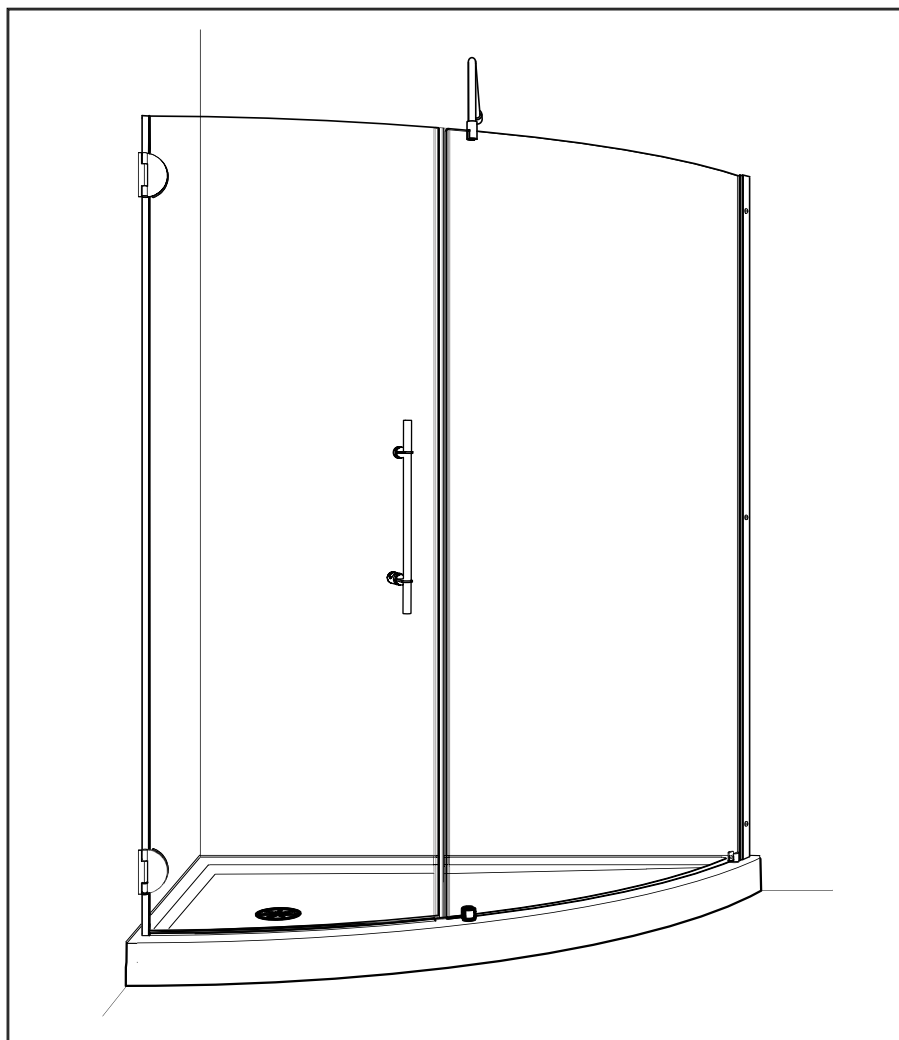

07.10

Please keep this manual and product code number for future reference and replacement parts ordering if necessary.

GENERAL INSTRUCTIONS

- *Read this manual carefully and completely before proceeding.*
- *It is recommended that you wear safety glasses at all times during the installation.*

INSTALLATION OVER CERAMIC TILES

- *Silicone should be used to seal the gap where the ceramic tiles meet the fixed panel.*
- *If your shower door is to be installed over ceramic tiles, the tiles should lay completely under the wall jamb.*

NOTICE

- *Caulking: no sealant is required inside the shower. Unless otherwise stated.*
- *Some models are equipped with clear sealing gaskets.*

CARE FOR YOUR SHOWER DOOR

- *Never use scouring powder pads or sharp instruments on metal pieces or glass panels. An occasional wiping down with a mild soap diluted in water is all that is needed to keep the panels and aluminum parts looking new.*
- *We recommend wiping the glass panels with a squeegee after each use.*

Product specifications are subject to change without notice.

Configurations possible / Possible configurations

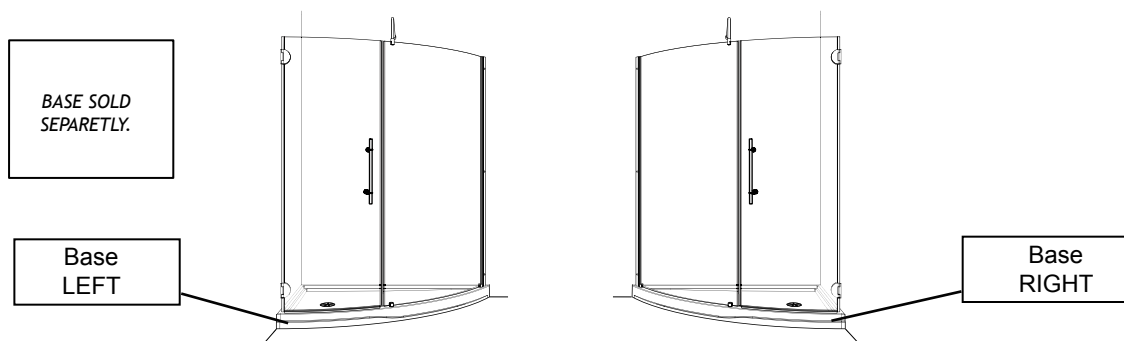

INSTALLATION OF COMPONENTS

STEP 3

Suport Bar Installation

see page 10-12

STEP 1

Wall Jambs Installation

see page 6-7

STEP 5

Door Assembly

see page 13-16

STEP 2

Fix Panel Installation

see page 8-10

STEP 6

Accesories Installation

see page 17-19

STEP 4

Insert The Magnetic Gasket (Fix Panel)

see page 13

STEP 7

Handle Installation

see page 19

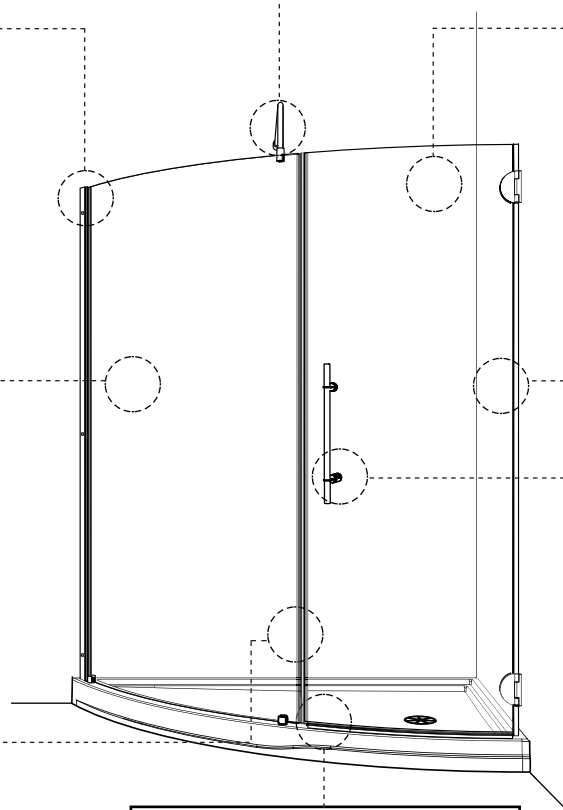

Caulking

see page 20

STEP 8

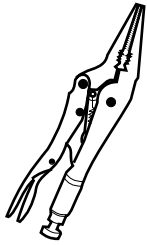

LONG NOSE LOCKING PLIER

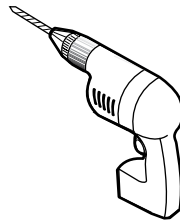

DRILL

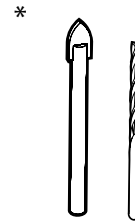

1/4" & 1/16" DRILL BITS



SCREWDRIVERS

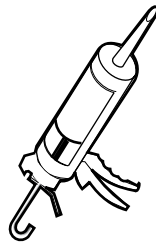

SILICONE



PENCIL

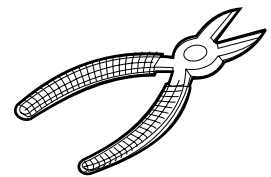

CUTTING PLIER

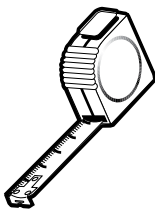

TAPE MEASURE

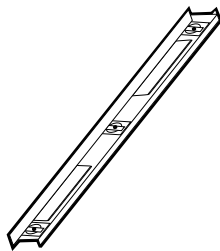

LEVEL

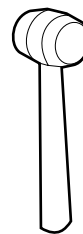

MALLET



5/16" HEX NUT DRIVER

* To install the shower door on ceramic tiles, use a 1/4" drill bit for ceramic tiles.

HARDWARE



17



16



13



14



15



18

Hinges

Q	M	T	R

Handles

A	B	C	D	E

PARTS LISTING

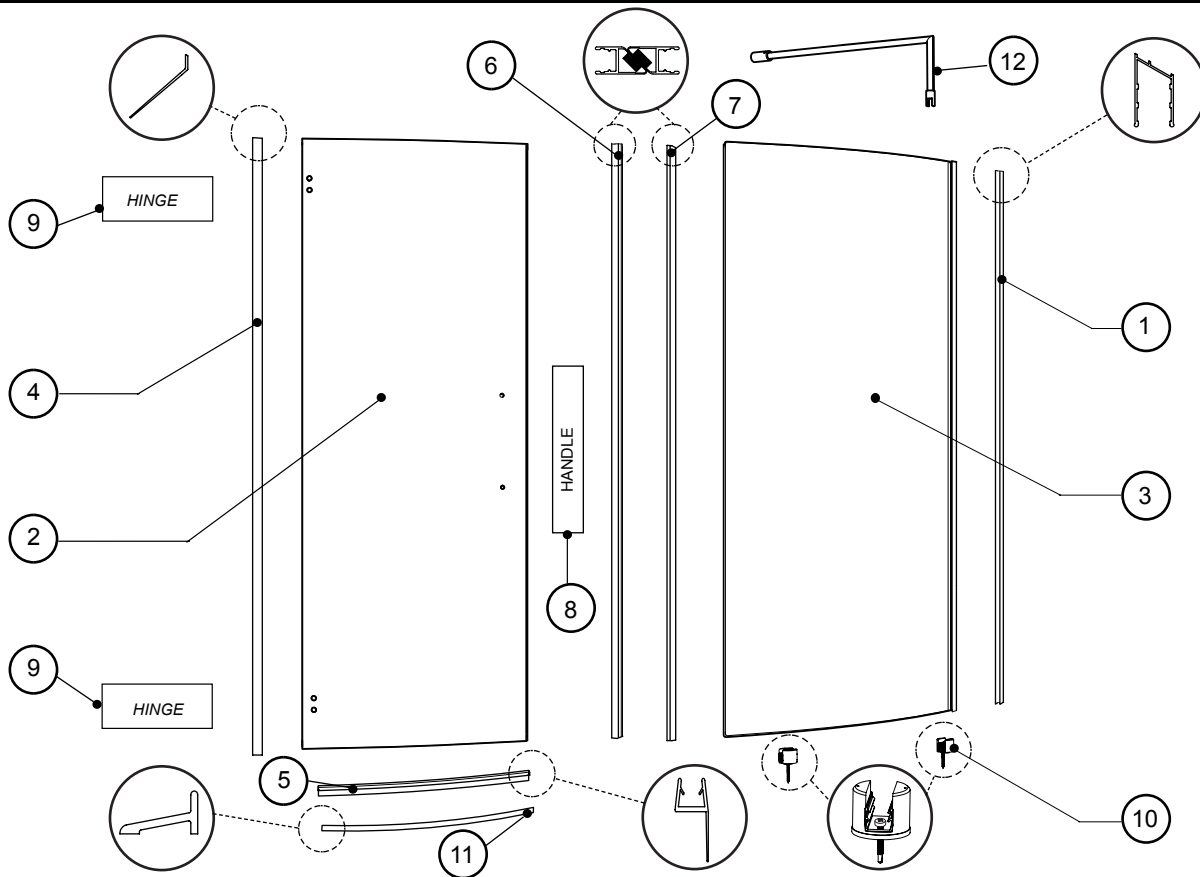

ITEM	PARTS	QTY
1	WALL JAMB	1
2	DOOR PANEL	1
3	SIDE PANEL	1
4	WALL SIDE GASKET	1
5	BOTTOM DOOR GASKET	1
6	MAGNETIC DOOR GASKET	1
7	MAGNETIC SIDE PANEL GASKET	1
8	HANDLES	1
9	HINGE	2
10	GLASS SUPPORT	2
11	THRESHOLD	1
12	SUPORT BAR	1
ITEM	HARDWARE	QTY
13	WALL PLUG # 1/4" x 1"	3
14	SCREW CAP	4
15	BACK SCREW CAP	4
16	PAN SELF DRILLING SCREW #8-3/8"	3
17	PAN HEAD SELF DRILLING SCREW # 8 - 1 1/4"	3
18	SETTING BLOCK	2

1 WALL JAMB INSTALLATION

- 1a. Use a measuring tape and pencil to mark the center of the threshold of the base.

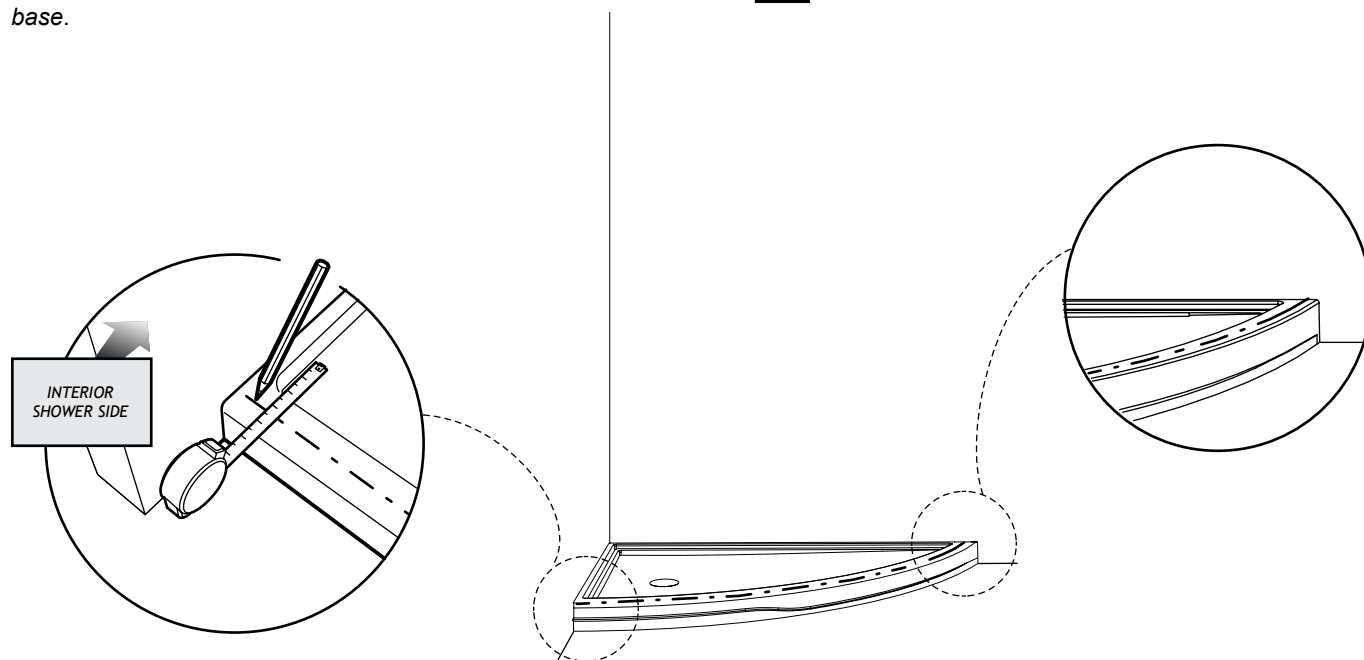

- 1b. Place the wall jamb against the wall so that the holes are located towards the interior of the shower. Center the opening of the wall jamb on the line marked previously. Ensure verticality with a level. Mark the holes position with a pencil using the holes of the wall jamb for reference.

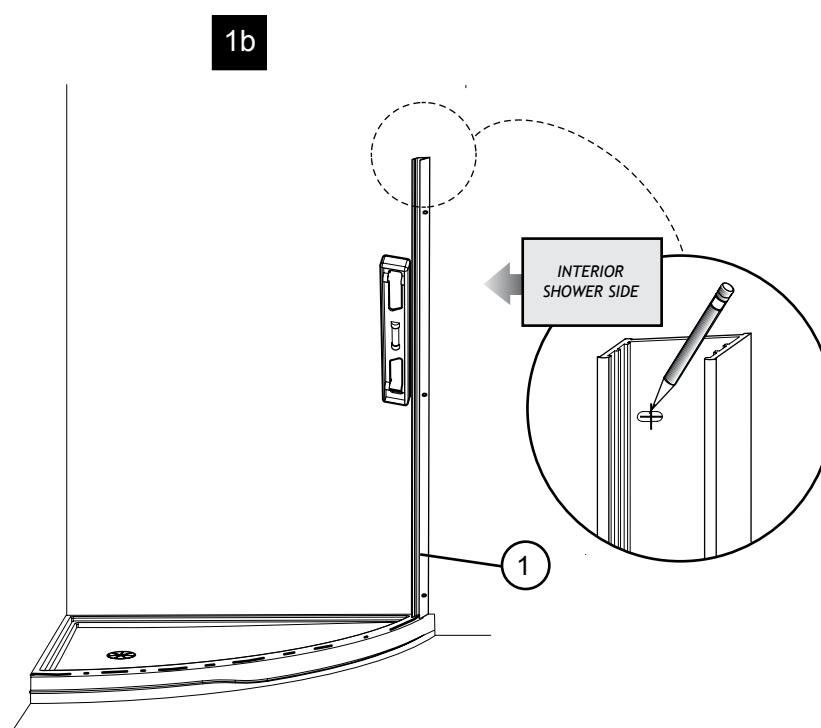

1 WALL JAMB INSTALLATION (CONTINUED)

1c Drill the holes in the wall with Ø1/4" drill bit intended for ceramic tiling .

1c

1d Insert one drop of silicone in each hole in the wall before inserting the wall plug (x3) .

1e Apply silicone at the bottom of the wall jamb on the side that goes on the wall as illustrated.

1f Ensure verticality with the level.
Screw the wall jamb on to the wall using the screws 1 1/4" (x3) .

1g Apply silicone on the inside of the wall jamb as illustrated.

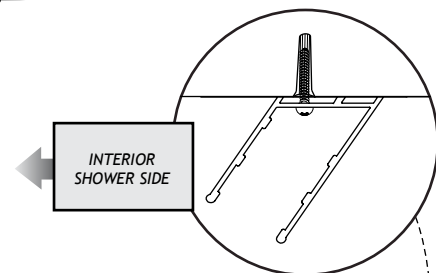
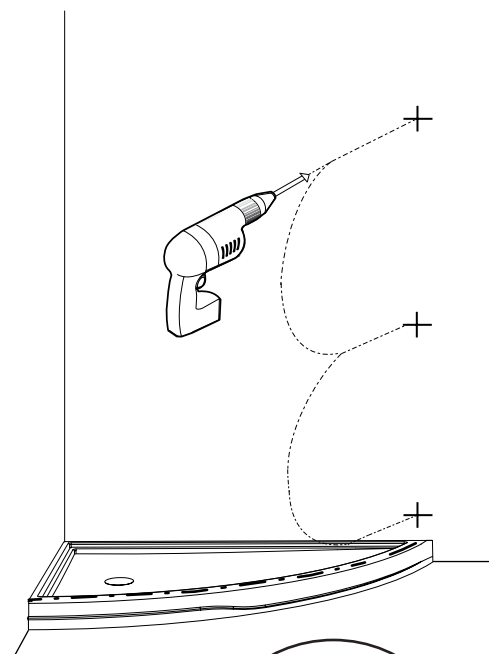

1d

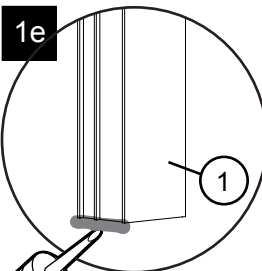
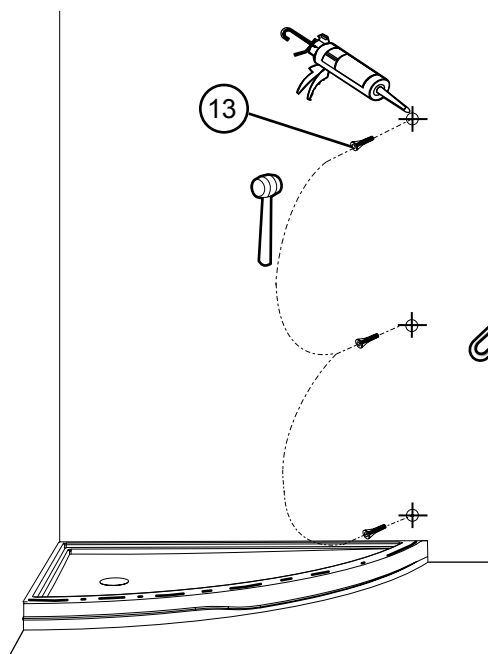

1e

1

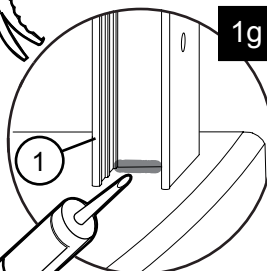

1g

1

1f

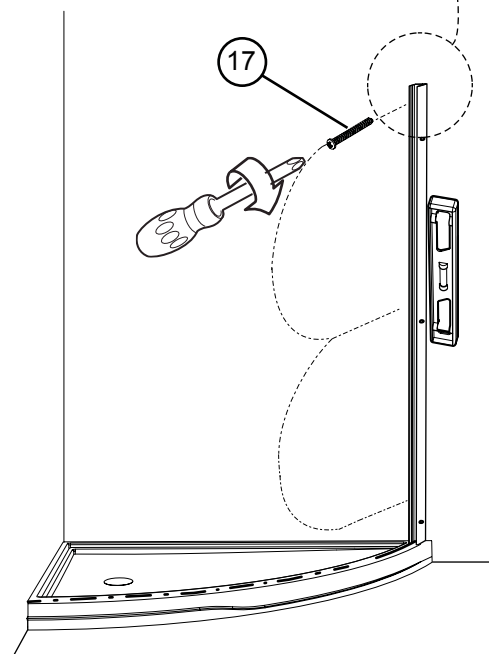

2 FIXED PANEL INSTALLATION

2a Place glass supports (x2) on the bottom of the fixed panel.

2b Slide the fix panel temporarily into the wall jamb.

2c Mark the glass supports locations on the base.



MAKE SURE TO PLACE THE GLASS SUPPORTS AS ILLUSTRATED.

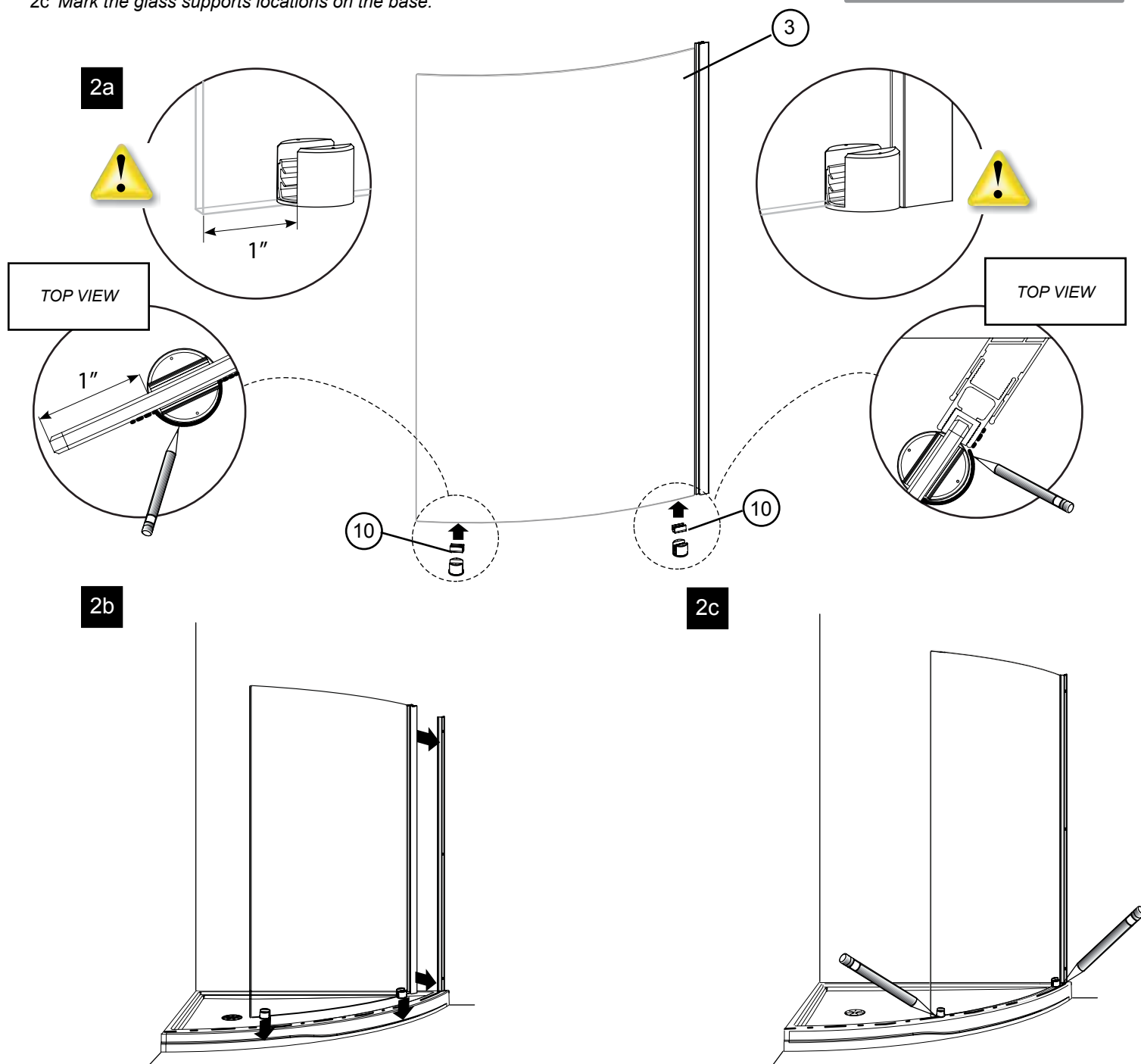

2 FIXED PANEL INSTALLATION (CONTINUED)

2d Remove the fix panel and the glass supports.

2e Reposition the glass supports on the base using the line marked previously. Use a 1/16" drill bit to drill holes into the base through the glass supports.

2f Remove the clips and insert one drop of silicone in each hole in the base.

2g Screw the glass supports by using the screws supplied.

2d

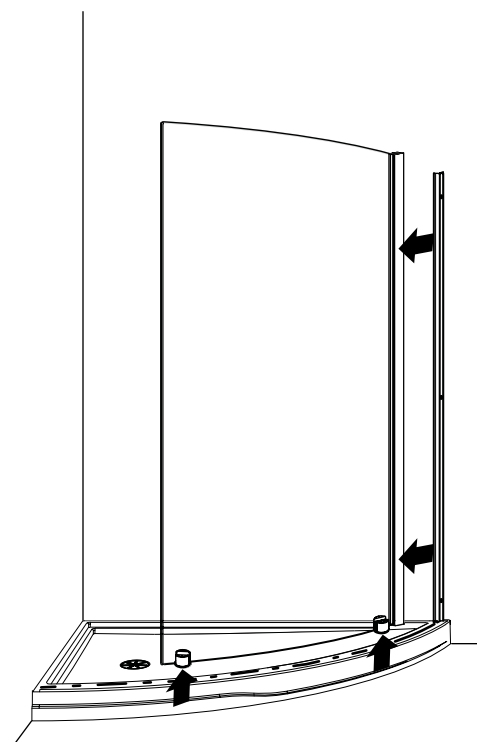

2e

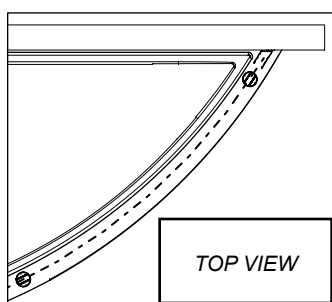

2f

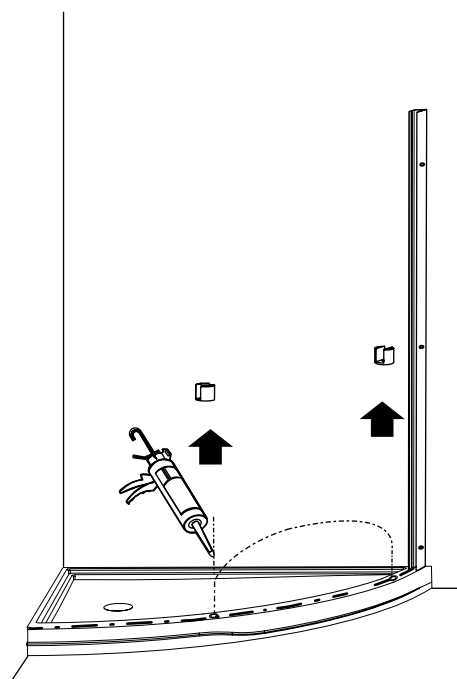

2g

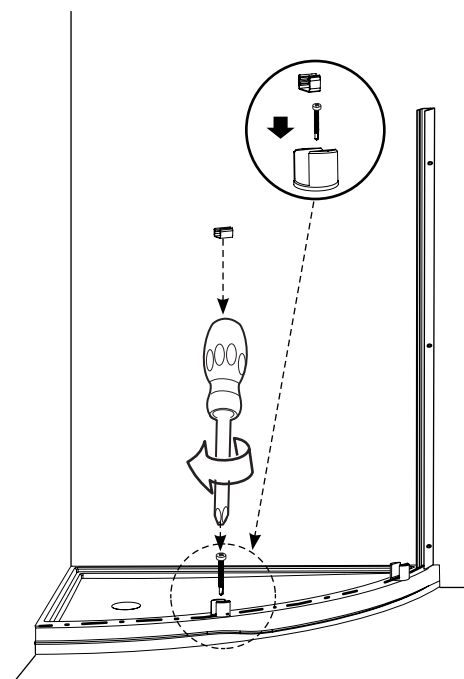
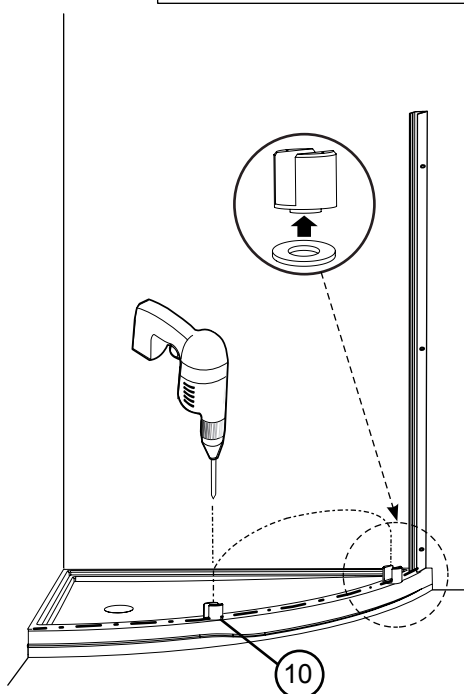

2 FIXED PANEL INSTALLATION (CONTINUED)

- 2h *Reposition the fixed panel in place ensuring that it is placed inside the glass supports. Clamp the fix panel to the wall jamb.**

2h

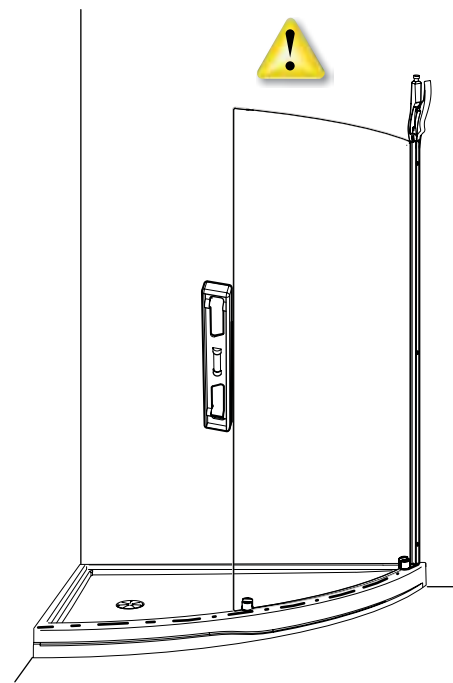
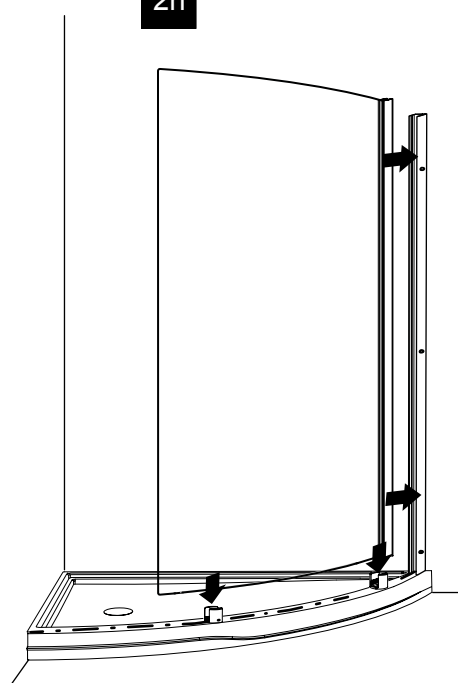

COVER THE PLIER'S TEETH
BEFOREHAND TO
AVOID SCRATCHING THE ALUMINUM
PARTS.

3 SUPPORT BAR INSTALLATION

- 3a *Place temporarily the support bar on the top of the fix panel. Ensure verticality with a level and mark the position on the wall.*

3a

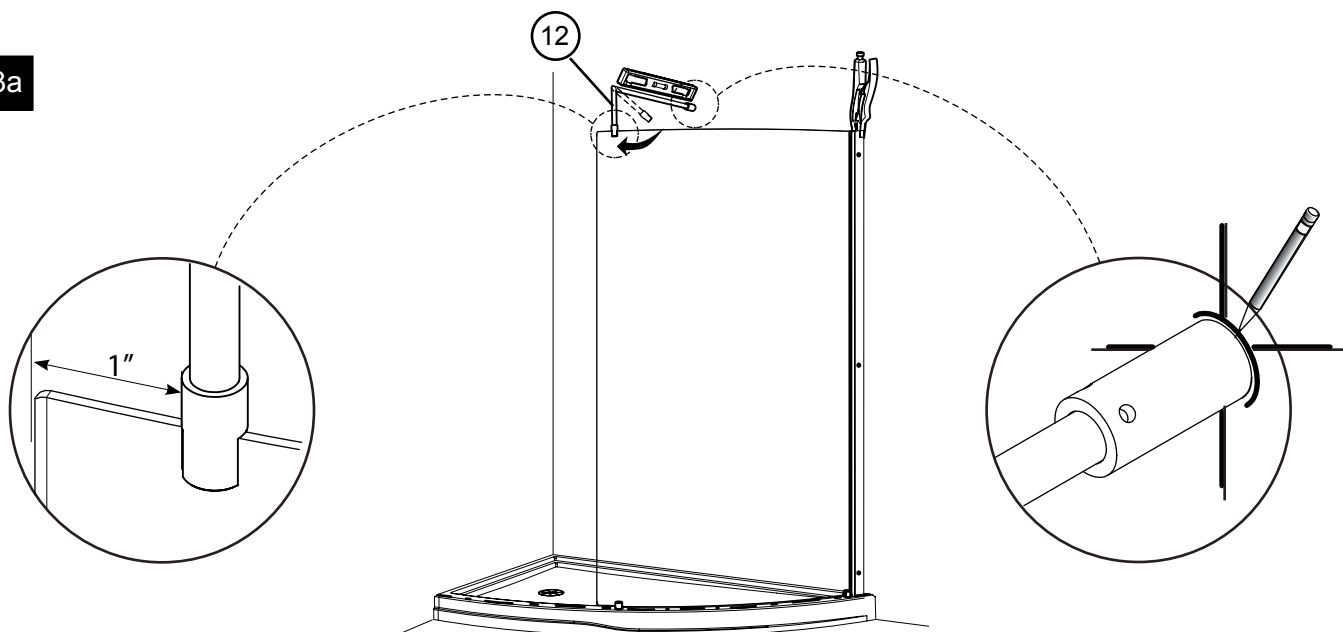

3 SUPPORT BAR INSTALLATION

3b Remove the suport bar and take apart the wall end component (A) with the provided Key. Replace the wall end component on the wall using the marked lines.

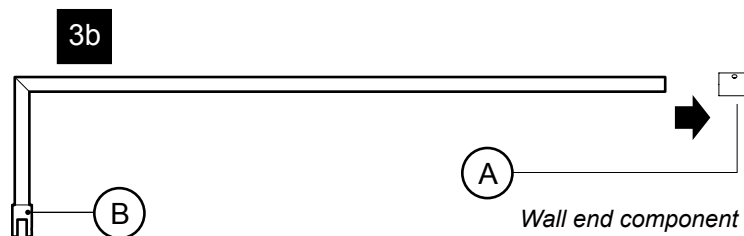

3c Use a 1/4" drill bit to drill a hole into the wall through the wall end component (A).

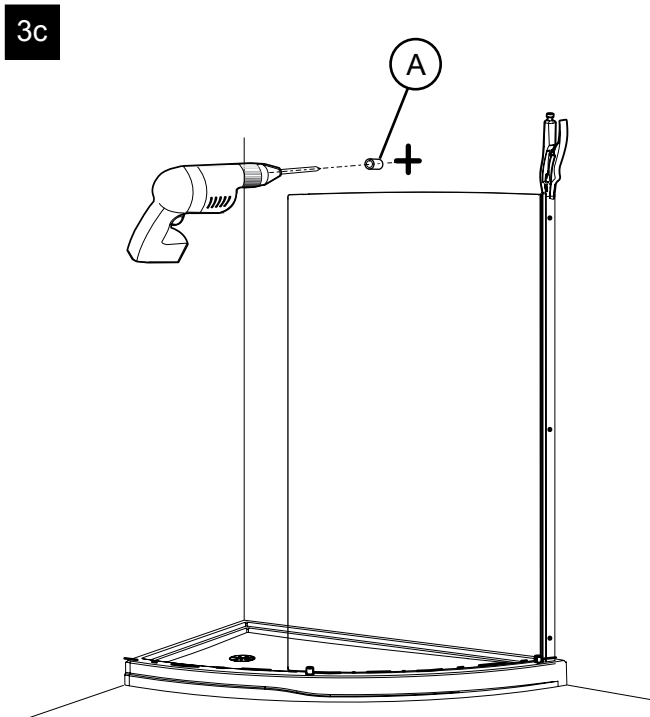

3d Apply a bead of silicone in the hole and insert a wall plug. Use a screw to secure the wall end component (A) to the wall .

3d

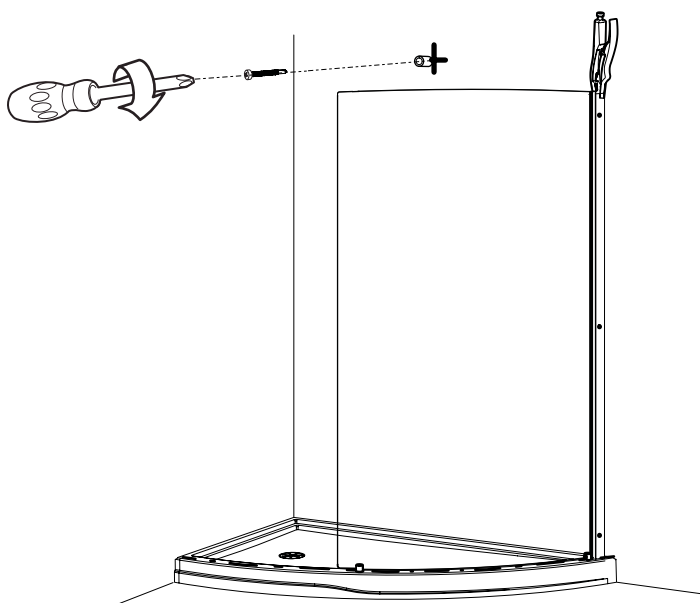
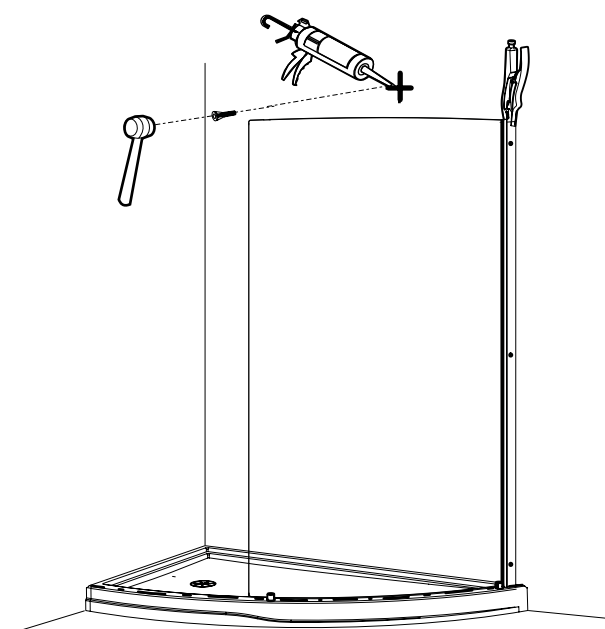

3 SUPPORT BAR INSTALLATION

3e Reposition the support bar as illustrated.

To ease subsequent installation on the fix panel insert bar in the wall end component (A) on a horizontal plane as shown. Make sure you insert the clear gasket as shown before installing it on the fix pannel .

3f. *Level support bar and tighten the set screws. Secure the glass fastener and wall bracket screws to complete the installation process.*

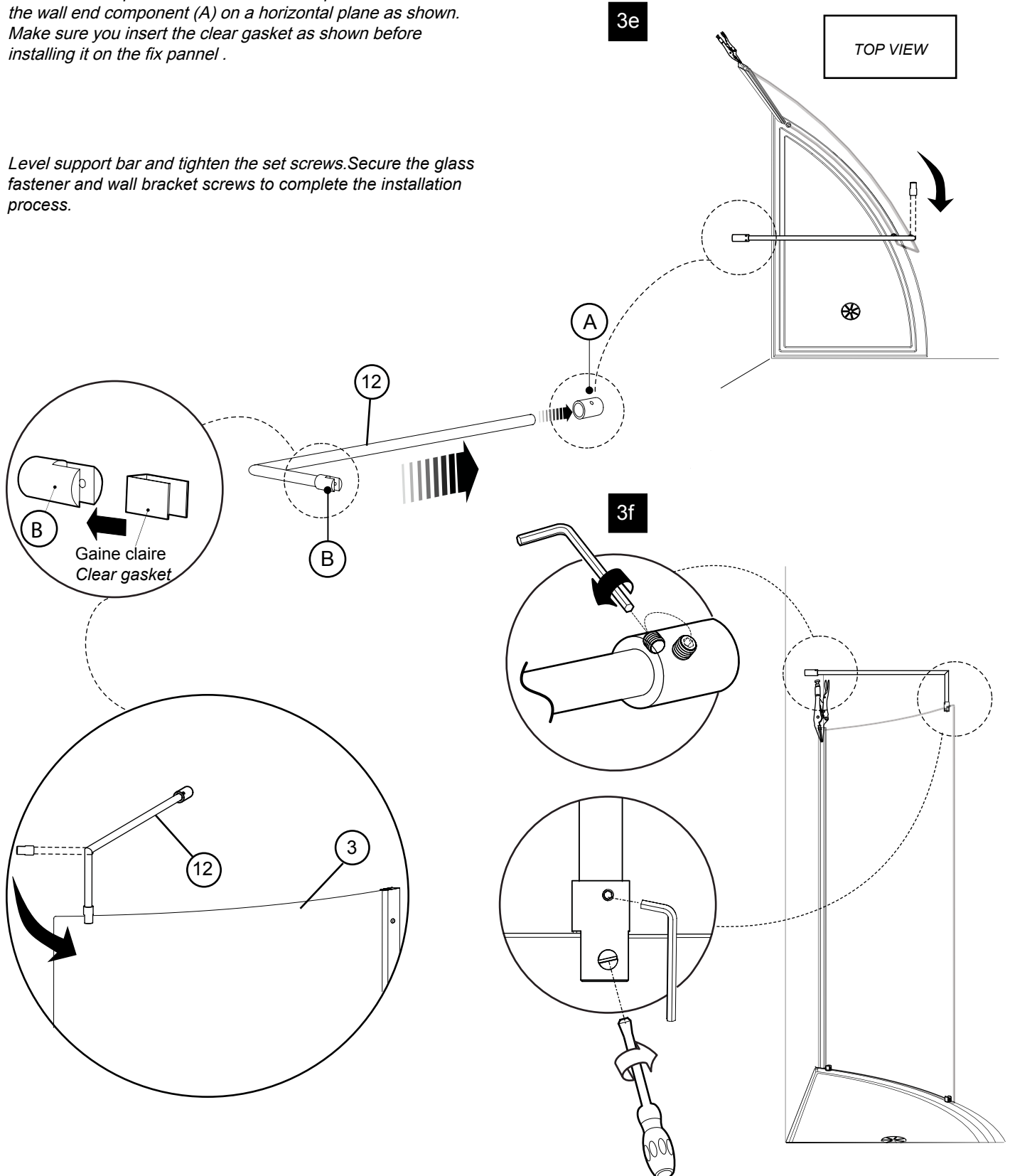

4 INSERT THE MAGNETIC GASKET (FIX PANEL)

4a Use a mallet to install the magnetic gasket on the fix panel. Make sure it touches the base.

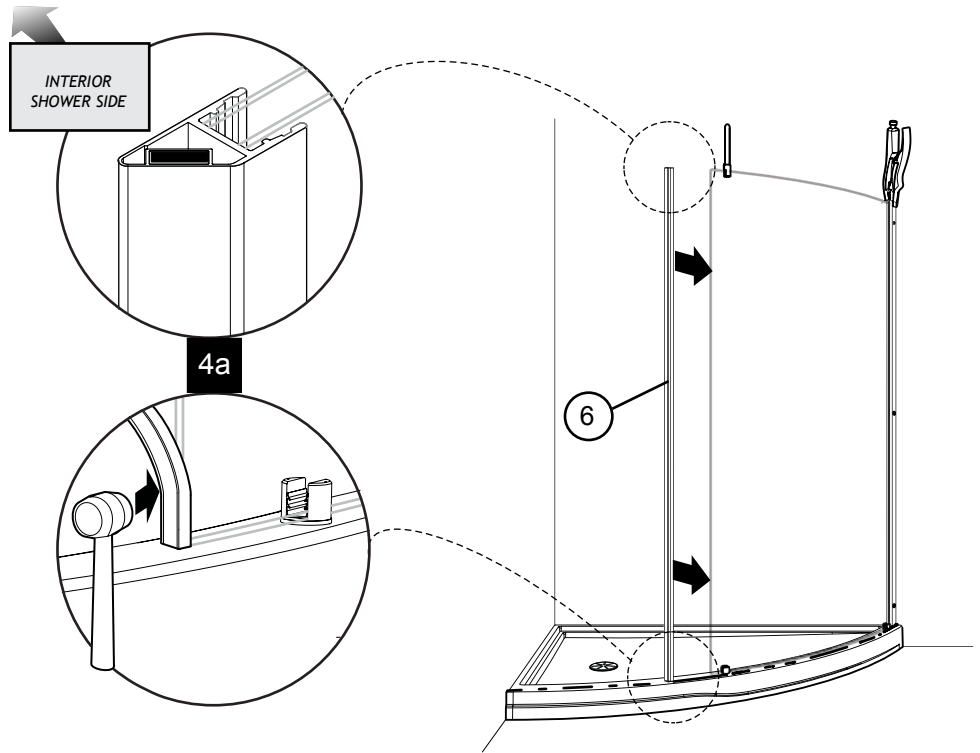

5 DOOR INSTALLATION

5a Fasten the hinges to the door as illustrated. Use the provided hex. Key.

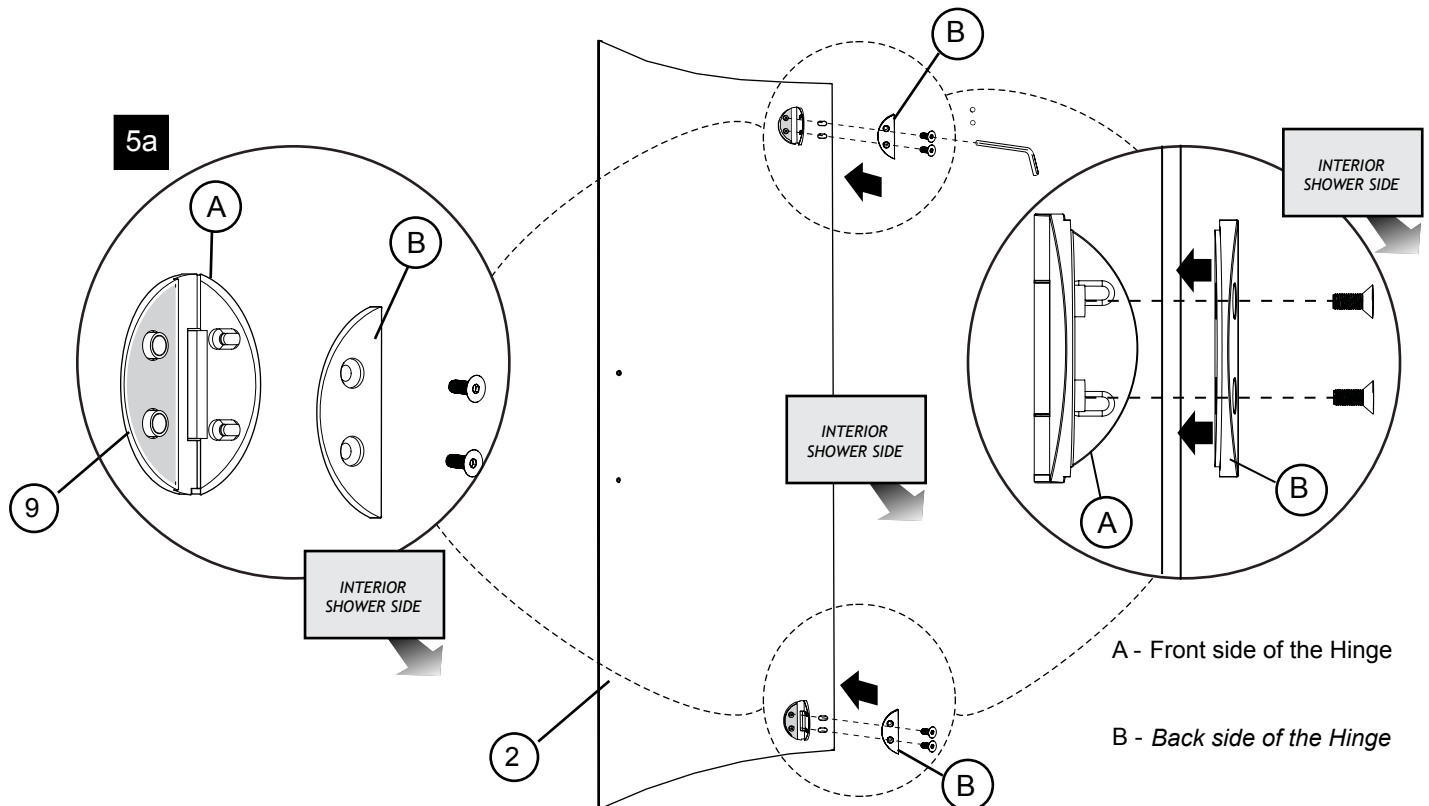

5 DOOR INSTALLATION (CONTINUED)

5b Use a mallet to install the magnetic gasket on the door as illustrated.

5c Use the two wood blocks that are supplied to place the door on the center of the base threshold.

5d Adjust the glass panels. Adjust the hinges positions in reference to the door panel to ensure contact between backplate gasket and the wall. The magnetic gaskets must be aligned and in contact.

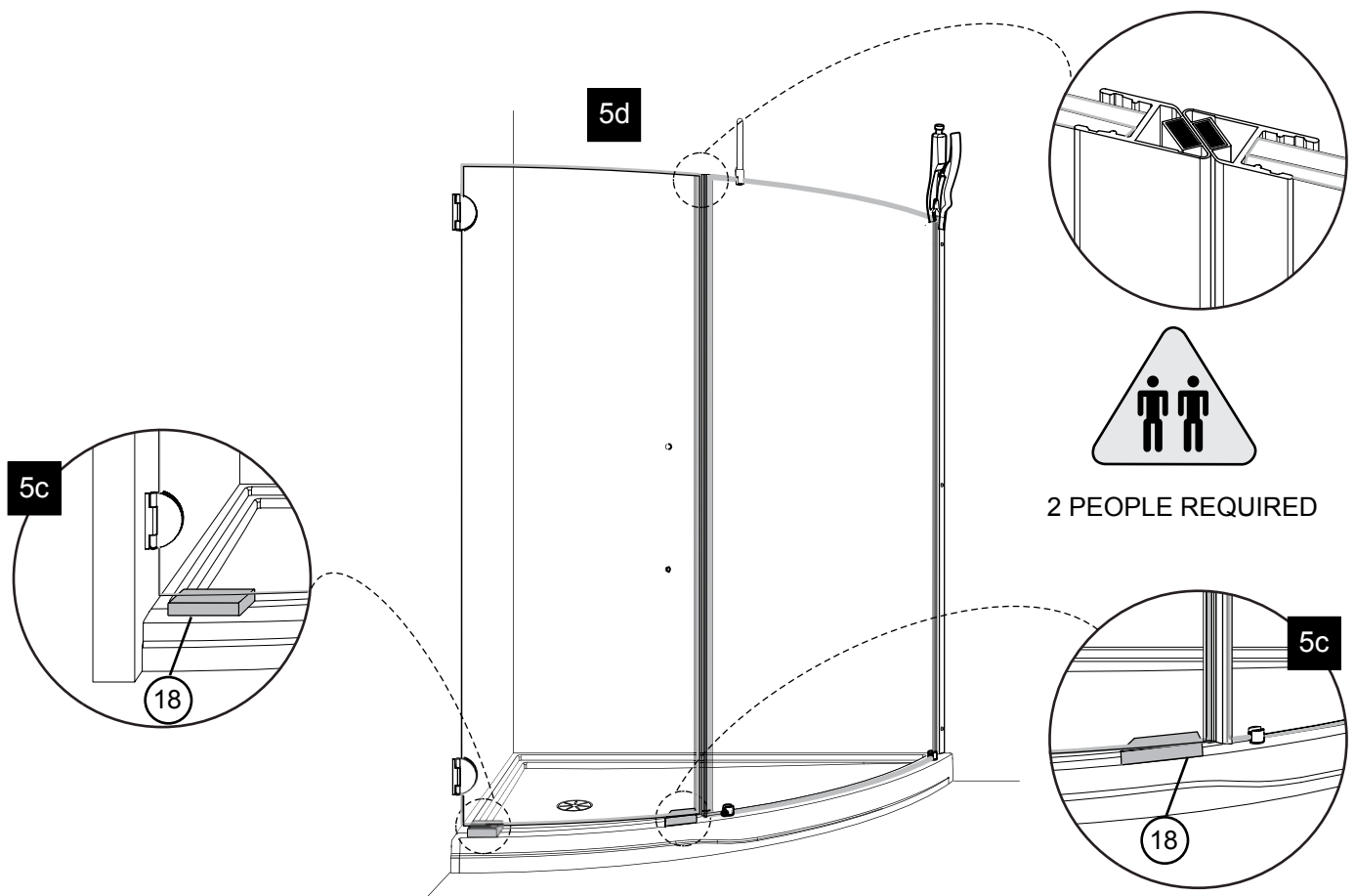
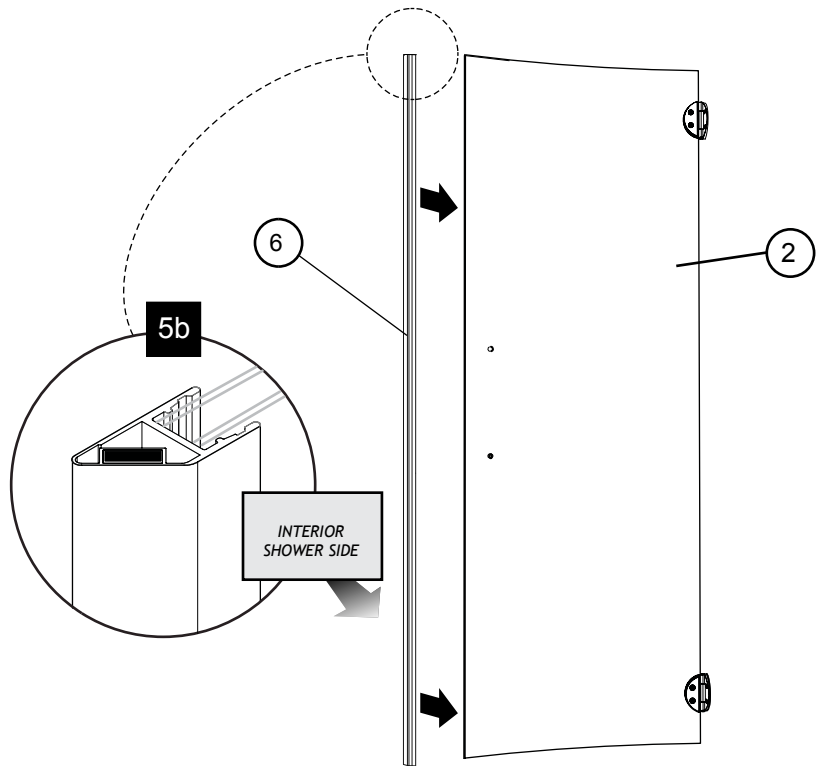

5 DOOR INSTALLATION (CONTINUED)

5e Mark the hinges and drilling locations on the wall

5f Remove the door temporarily and drill holes in each location .

5g Insert one drop of silicone in each hole before inserting the wall plug (x4) .

5h Remove the hinges
Take apart the hinge's front part (A) with the provided hex Key.
Place the hinge's front part (A) on the wall using the marked lines and screw it in place using the screws supplied.

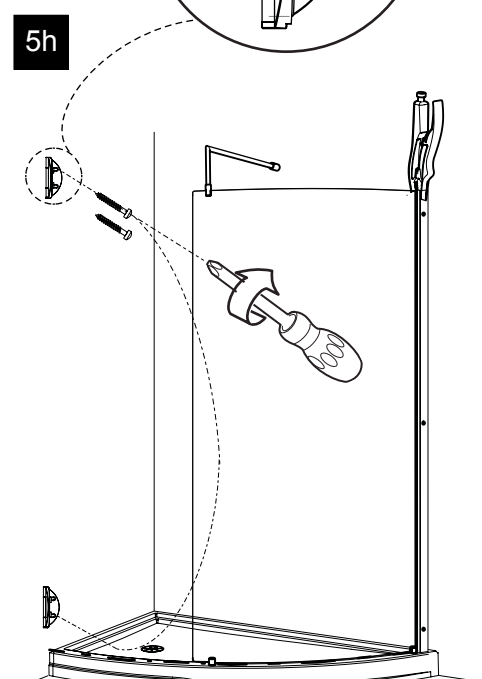
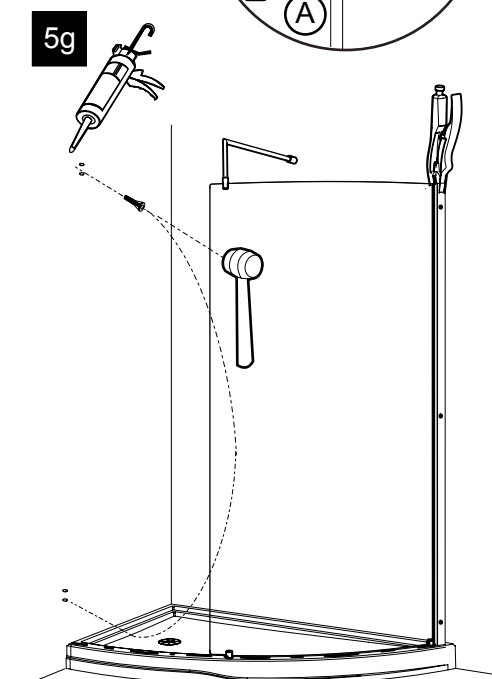
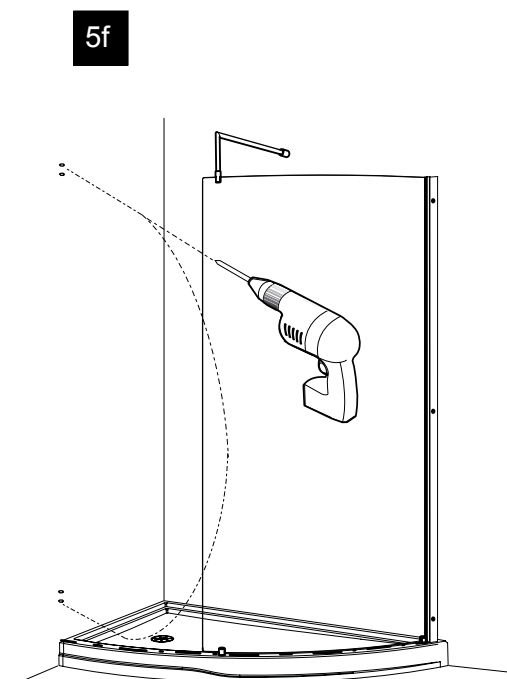
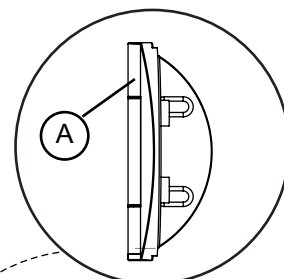
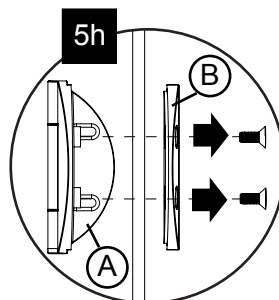
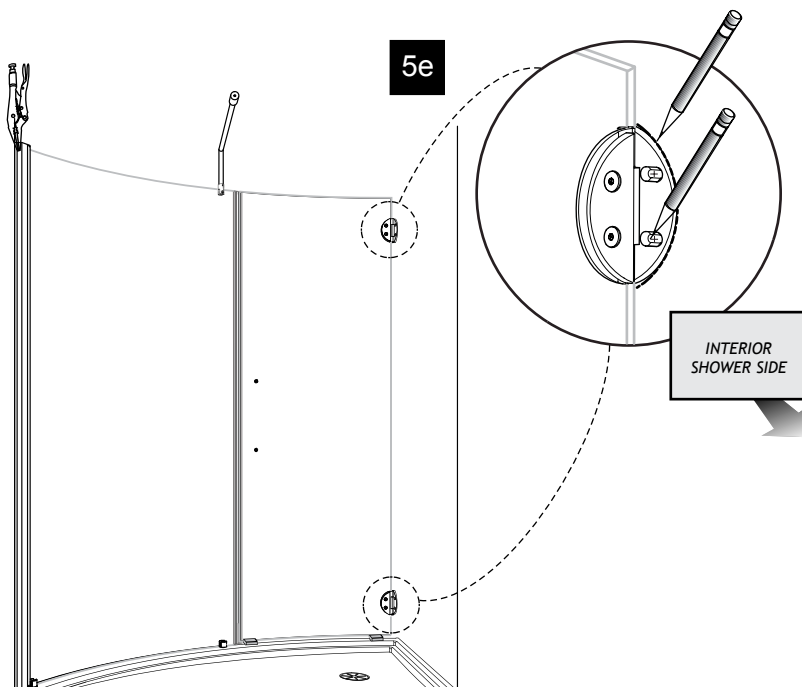

5 DOOR INSTALLATION (CONTINUED)

- 5j *Reposition the door .
Place on the door the hinge's back side (B) and screw it in place using the screws supplied.*

5j

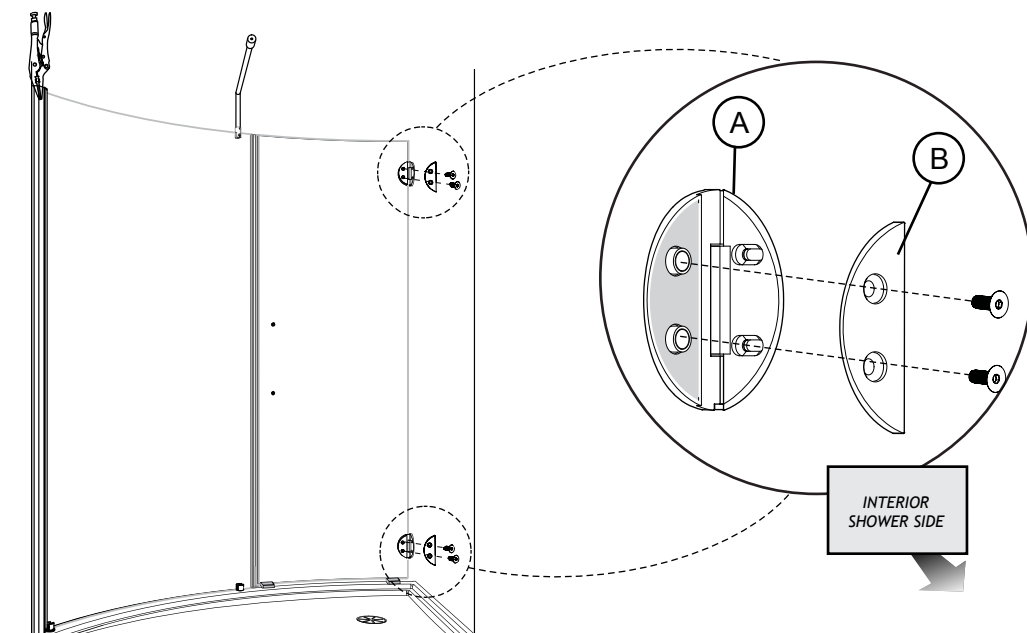

- 5k *Secure the fix panel with the screws 3/8" (x3) ensuring that the magnetic gaskets are still in contact .*

- 5l *Remove the wood blocks.*

5k

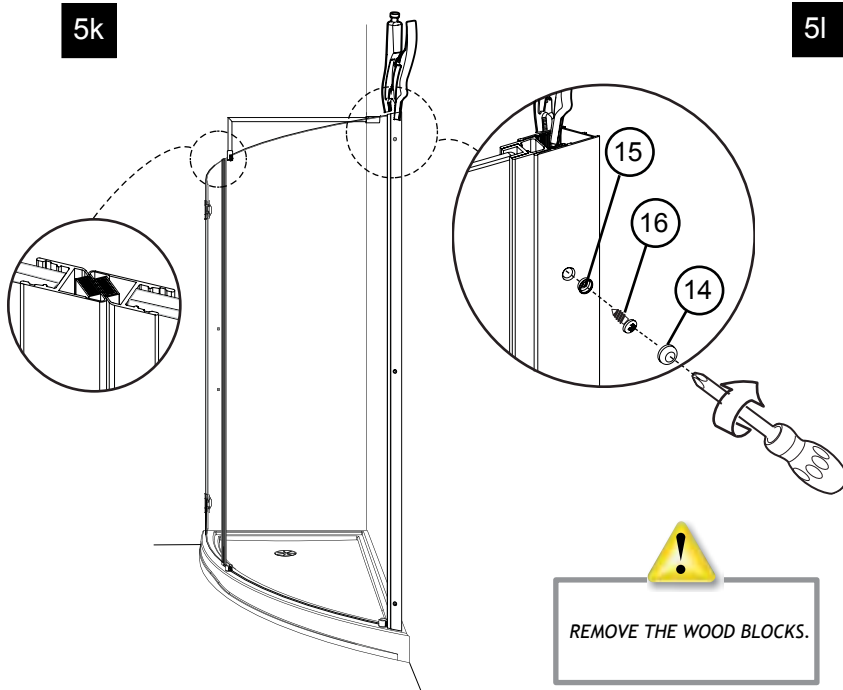

5l

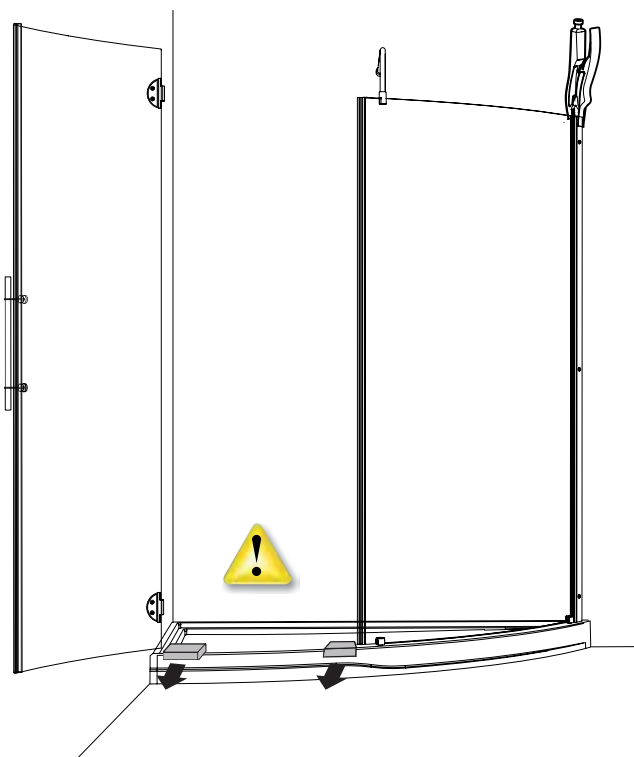

6 ACCESSORIES INSTALLATION

6a The gasket must be installed inside the shower.

6b Insert the bottom gasket as illustrated.



SWIPE THE EDGE OF THE DOOR PANEL CLEAN TO ENSURE THAT THE ADHESIVE GASKET ADHERES TO THE PANEL.

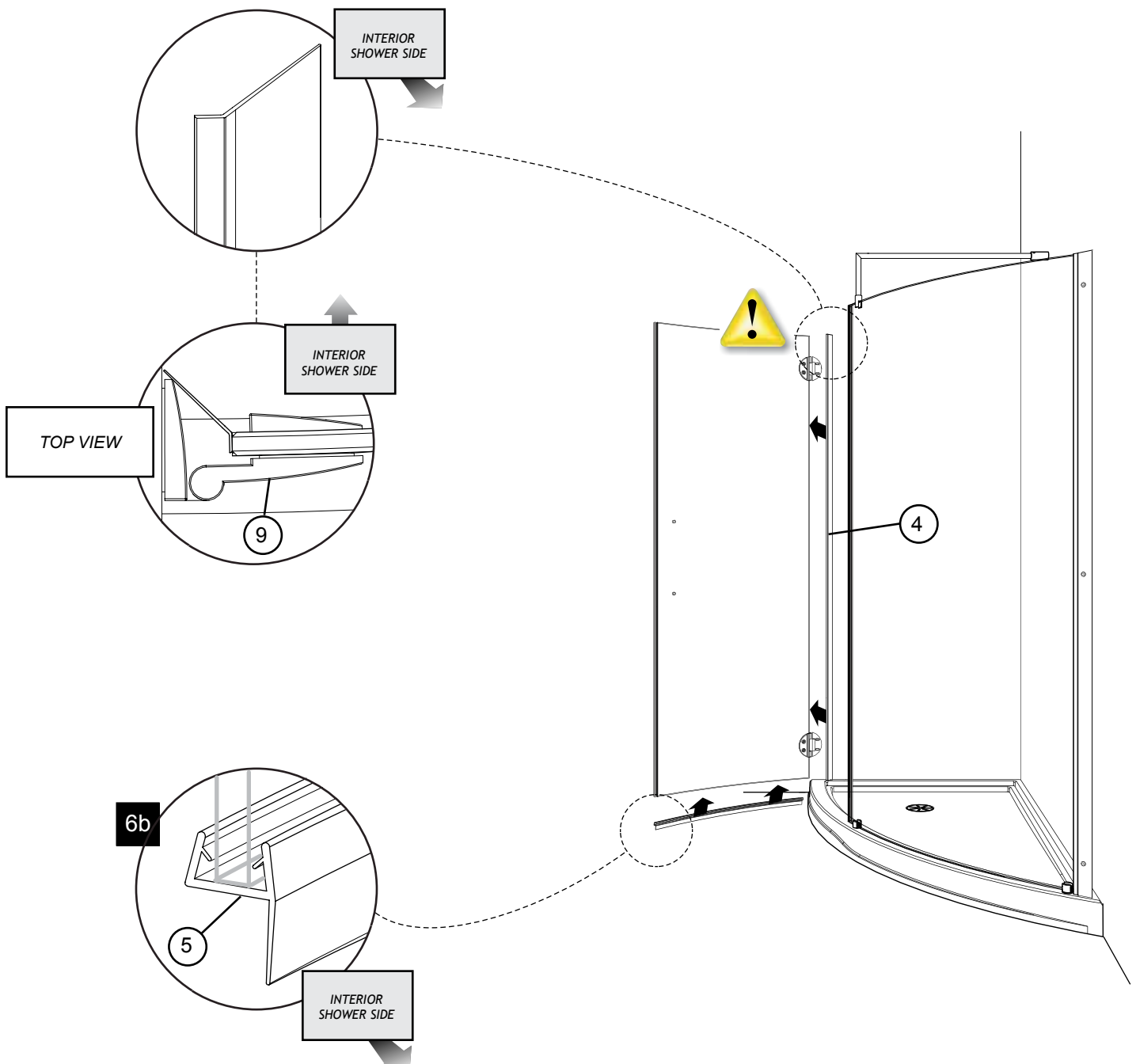

6 ACCESSORIES INSTALLATION (CONTINUED)

6c. Trace the location of the door on the base (when closed).

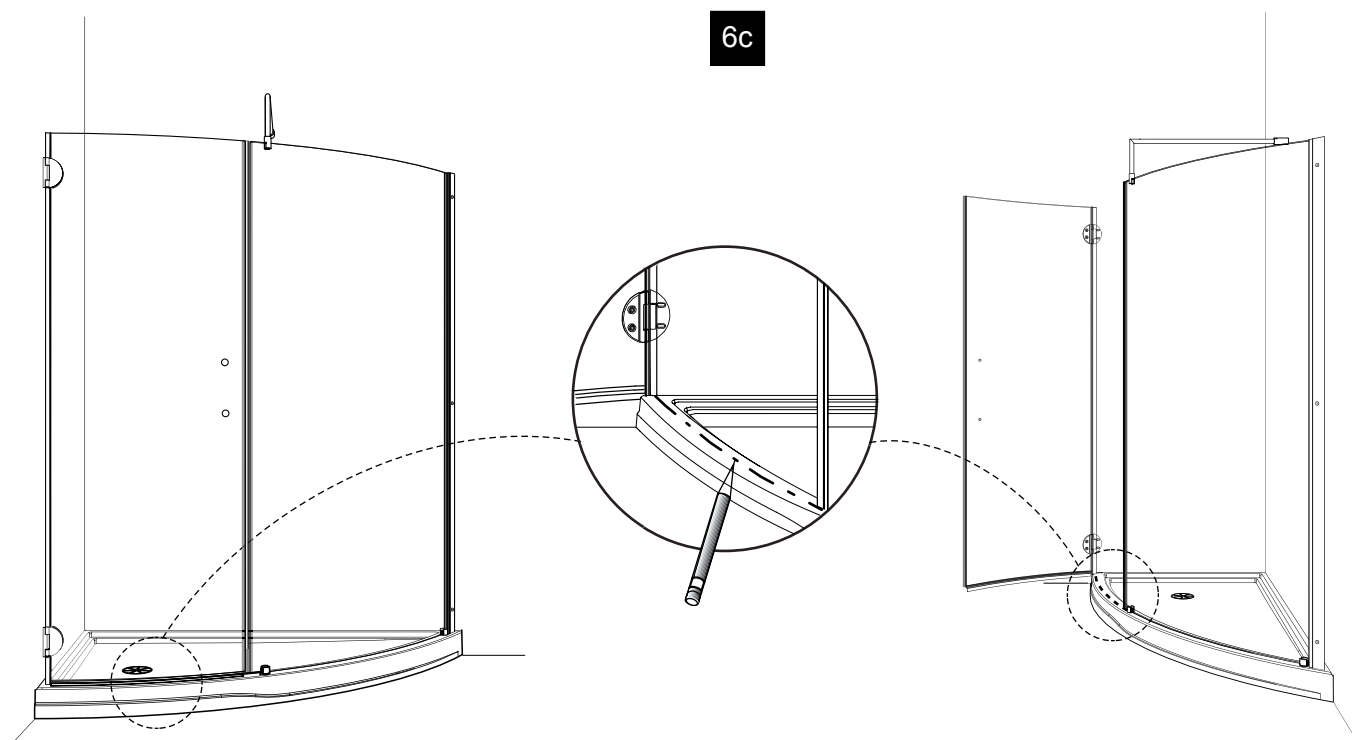

6d. To have a correct fit place the threshold against the wall and the glass support before adding the silicone.

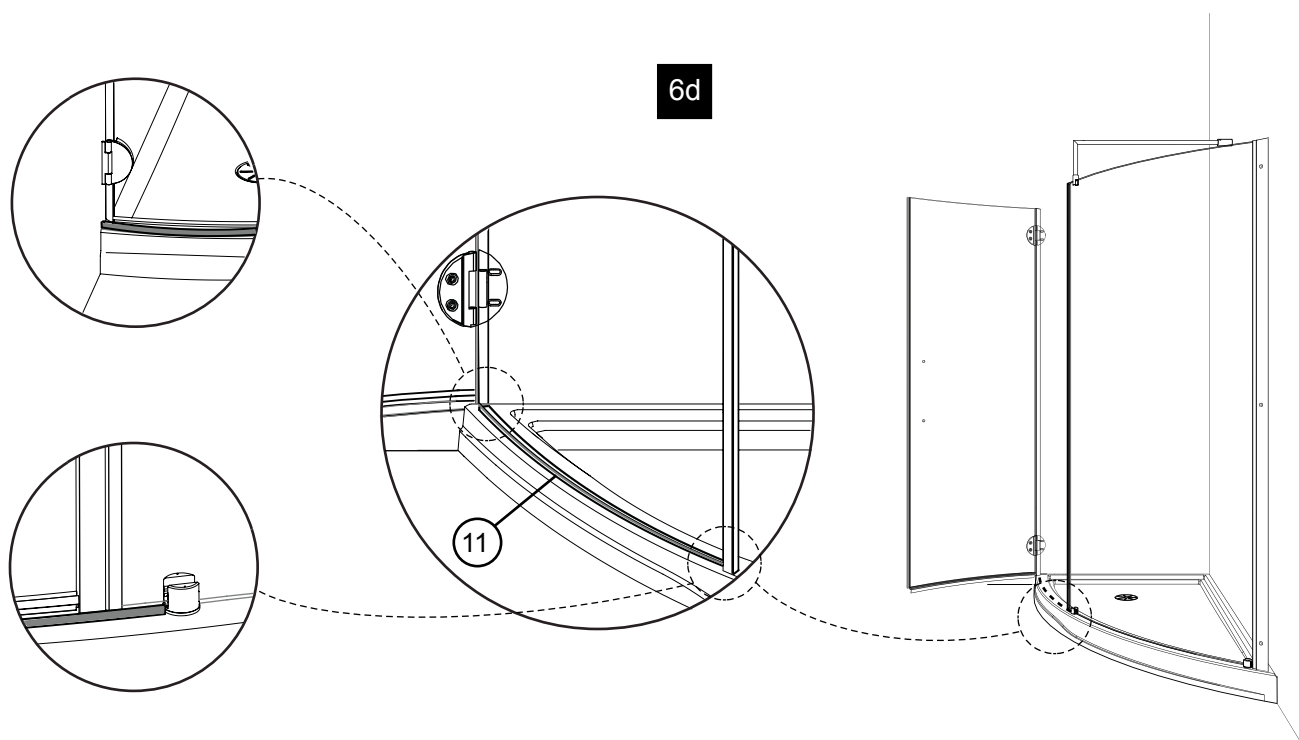

6 ACCESSORIES INSTALLATION (CONTINUED)

6e Apply a bead of silicone to the underside of the threshold before replacing it on the base.

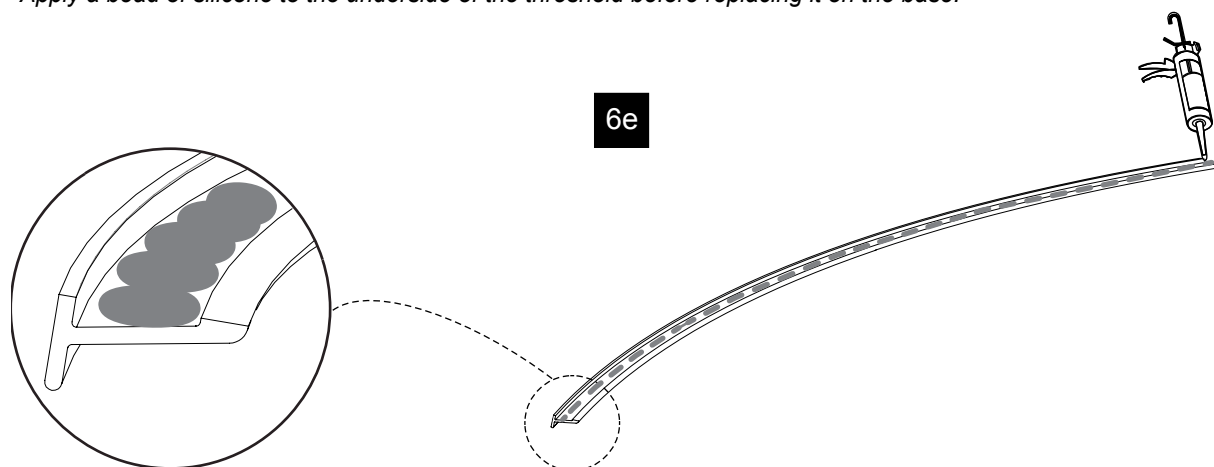

7 HANDLE INSTALLATION

7a See sheet for installation, install the handle as shown.

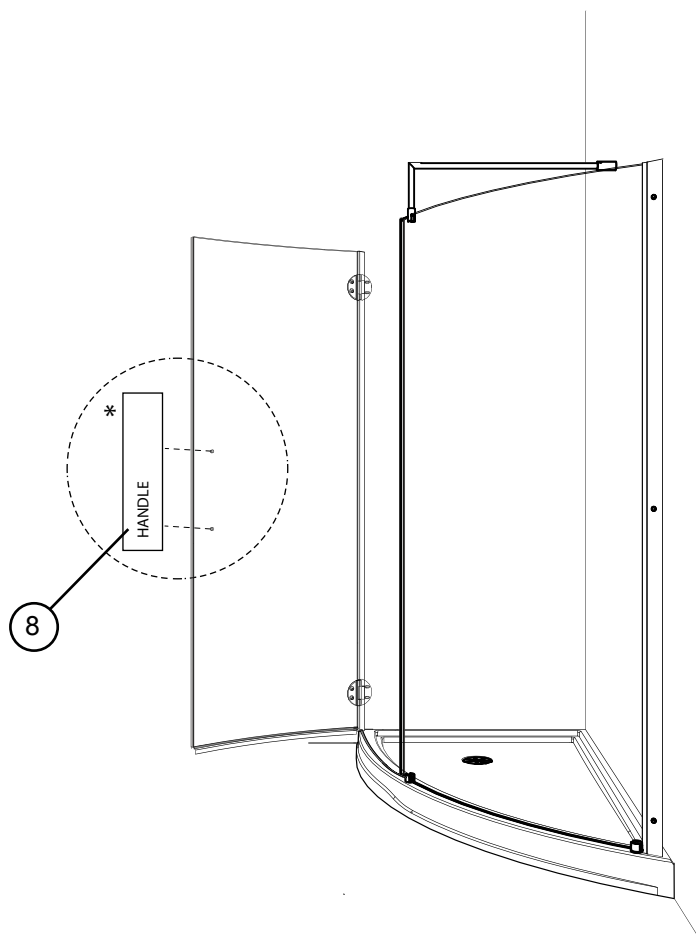

8 SEALING

8a Silicone the outside of the shower unit between the wall and the wall jamb (Fig.1), below the fix panel (Fig.2) and on the exterior side of the aluminum threshold (Fig.3).

8b Wait 24 hours before using the shower to allow the silicon to dry.

