

P-DR1W-72
OWNER'S MANUAL



SHOWER ENCLOSURES



2 PEOPLE REQUIRED



**IT IS MANDATORY TO HAVE A WALL STUD ON EACH SIDE OF THE
SHOWER UNIT TO SECURELY FASTEN THE RAIL TO THE WALLS.**

P002

TABLE OF CONTENTS

PARTS LISTING	3
GLASS PANEL DIMENSIONS	4
PROVIDED HARDWARE	4
REQUIRED TOOLS AND MATERIALS	4
GASKET INSTALLATION.....	5
RUNNING RAIL	6
GLASS HOLDERS	7
BOTTOM GLASS CLIPS.....	7
FIXED PANEL PLACEMENT	8
FIXED PANEL PLACEMENT (CONTINUED)	9
THRESHOLD	9
WALL BRACKETS	10
SMALL FIXED PANEL INSTALLATION.....	11
DOOR PANEL	12
DOOR (CONTINUED).....	13
STRAIGHT HANDLE	13
DOOR SIDE GASKET	14
STOPPERS.....	15
SILICONE.....	15

GENERAL INSTRUCTIONS

- Read this manual carefully and completely before proceeding.
- Product specifications are subject to change without notice. Use the installation instructions supplied with the product.

● SAFETY

- *It is recommended that you wear safety glasses at all times during the installation.*
- *At all times, 2 people are required for this installation.*

● WATERPROOFING

- *No sealant is required inside the shower.*
- *All models are equipped with transparent sealing gaskets.*
- *For models with wall jambs, if your shower door is to be installed over ceramic tiles, the tiles should lay completely under the wall jambs.*

● MAINTENANCE

- *Never use scouring powder pads or sharp instruments on metal pieces or glass panels.*
- *An occasional wiping down with a mild soap diluted in water is all that is needed to keep the panels and aluminum parts looking new.*
- *We recommend wiping the glass panels with a squeegee after each use.*

1 PARTS LISTING

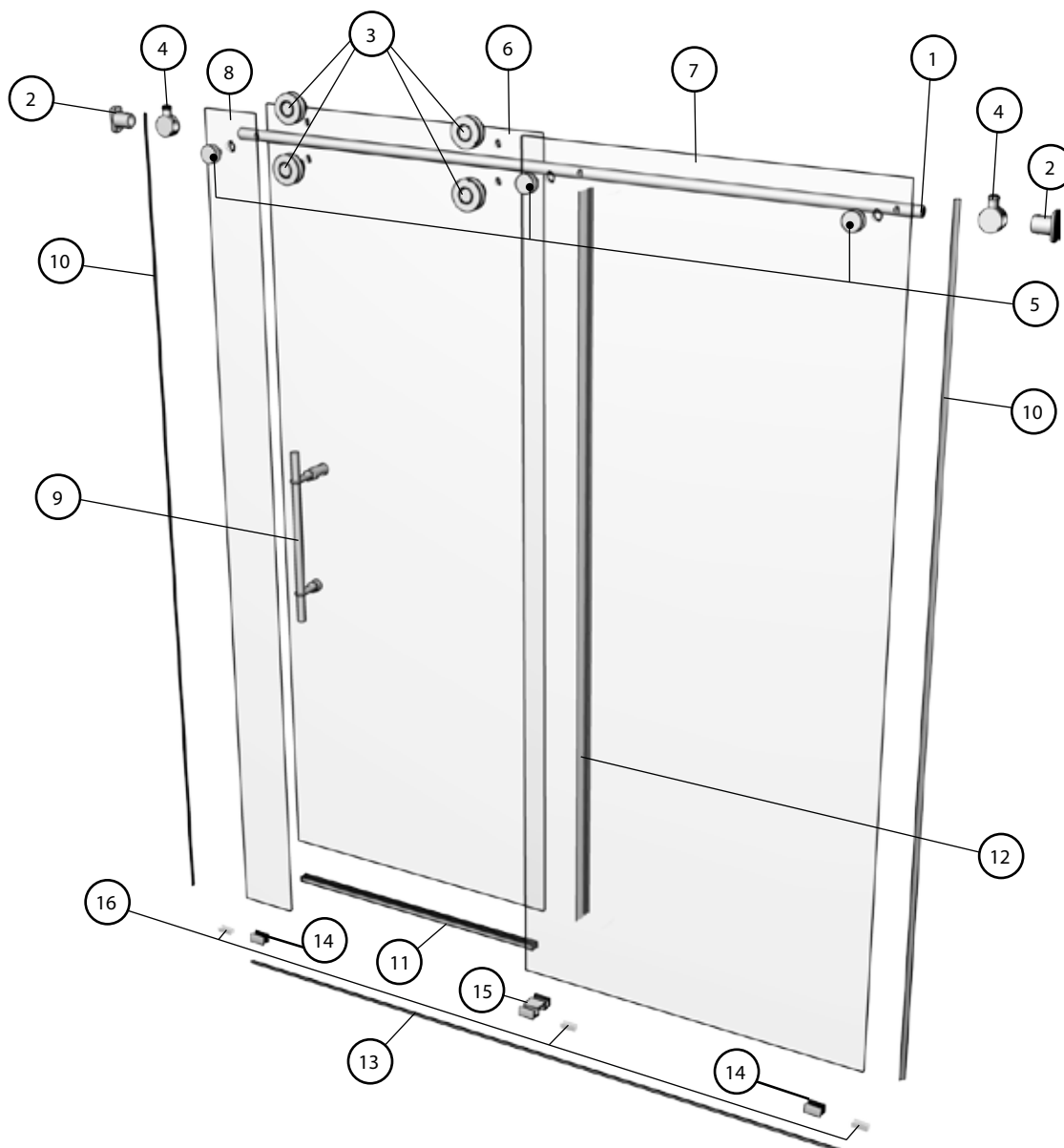

ITEM	PARTS	QTY
1	Running rail	1
2	Wall bracket for running rail	2
3	Set of double rollers	4
4	Door stopper	2
5	Glass holder for fixed panel	3
6	Door panel	1
7	Wide Fixed panel	1
8	Narrow Fixed panel	1
9	Straight handle	1
10	Fixed panel gasket	1
11	Door bottom gasket	1
12	Door side gasket	2
13	Threshold=(finished wall opening)	1
14	Glass Clip for bottom of fixed panel	3
15	Bottom center guide	1
16	Gasket (Glass Clip + Bottom Guide)	3

HARDWARE

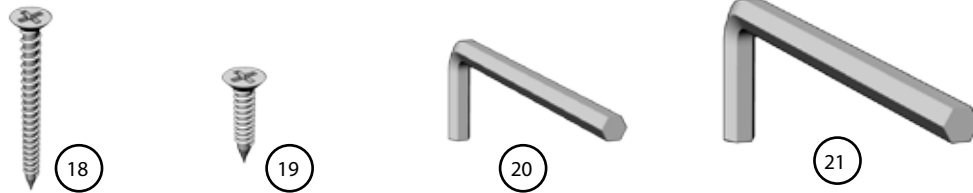

ITEM	HARDWARE	QTY
18	#12-3 SELF-THREADING SCREW	4
19	#6-1 SELF-THREADING SCREW	2
20	HEX KEY 3mm	1
21	HEX KEY 6mm (7/32")	1

TOOLS

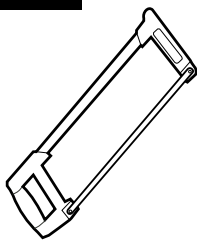

HACKSAW



SCREWDRIVERS

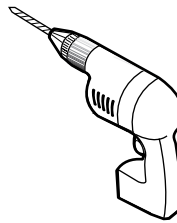

DRILL

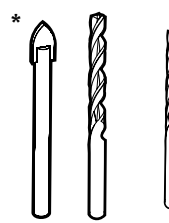

1/4" & 1/8" DRILL BITS

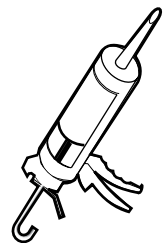

SILICONE

If the shower panels are to be assembled on ceramic tiles, use a 1/4" drill bit for ceramic tiles.

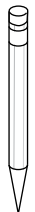

PENCIL

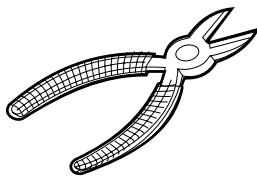

CUTTING PLIER

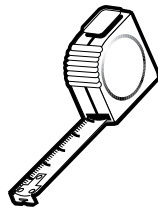

TAPE MEASURE

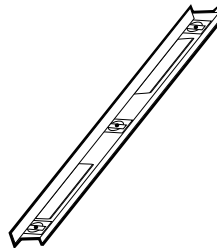

LEVEL

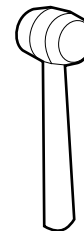

MALLET



BLOCK

1 GASKET INSTALLATION

1A

Using the cardboard packaging box as platform, install bottom door gasket (11) onto door panel (6) using a block and a mallet. Notice the gasket orientation.

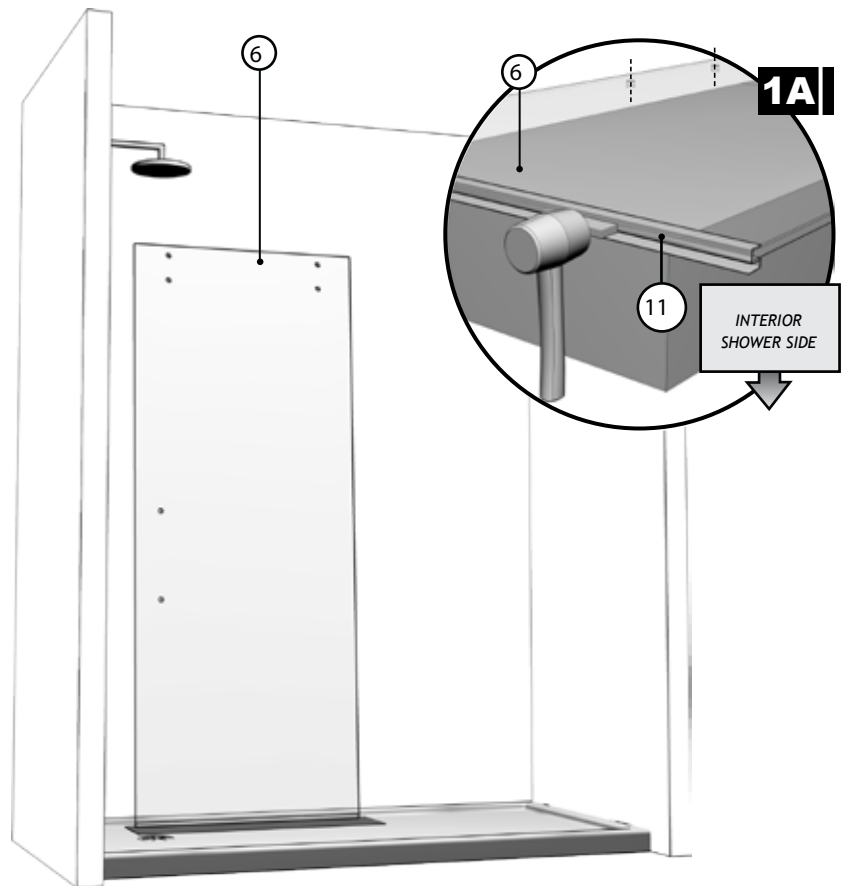

1B

Place door panel (6) inside tub to simplify following installation procedures. Ensure placing the panel onto a cushioned surface, such as a towel or cardboard, to prevent damage either to the panel or the tub.

1C

Thoroughly clean either edges of the fixed panels (7) (8). Apply gaskets (10) on these edge of the fixed panels, as illustrated.

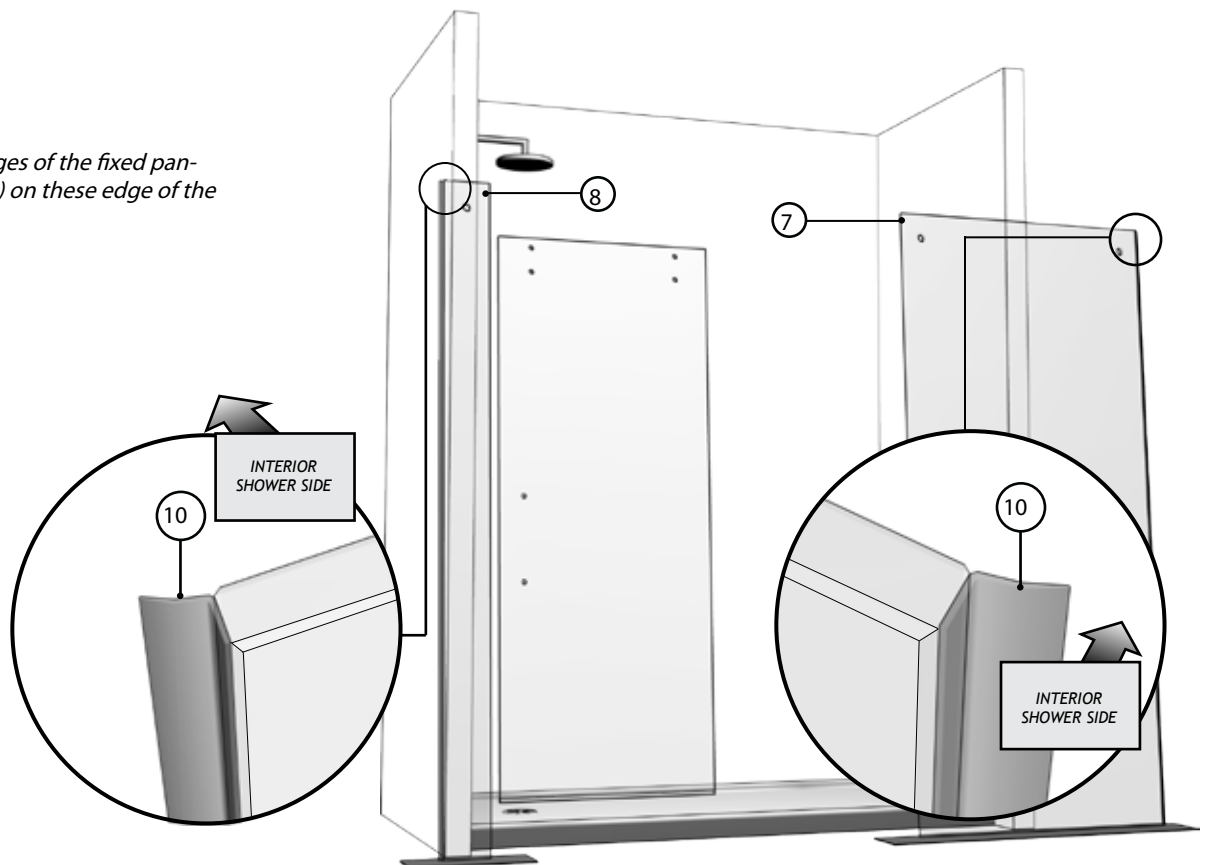

2 RUNNING RAIL

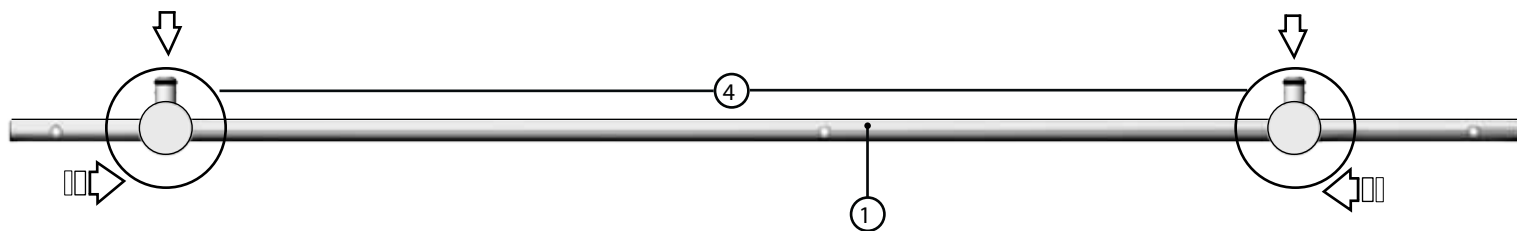

2A

Position the stoppers (4) on the running rail (1) as illustrated. Secure them temporarily in place.

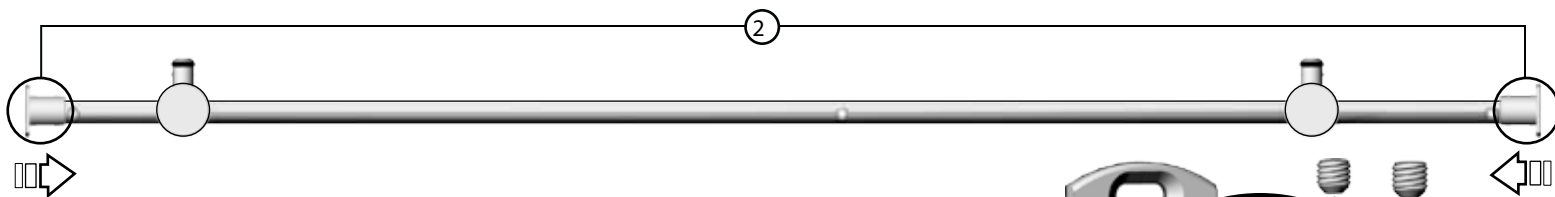
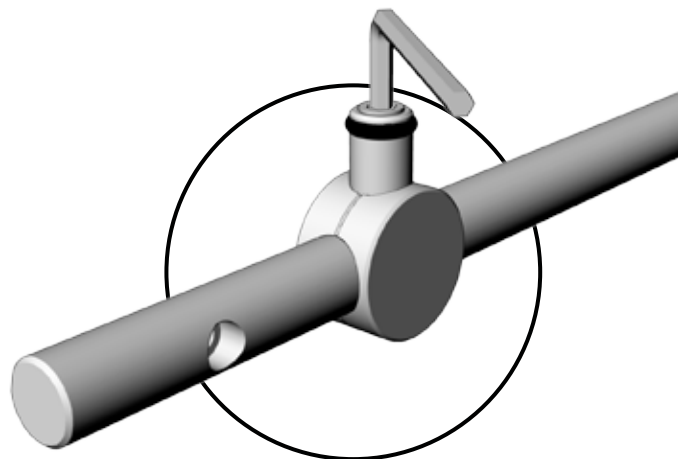

2B

Position the wall brackets (2) on the running rail (1) as illustrated. Secure them temporarily in place.

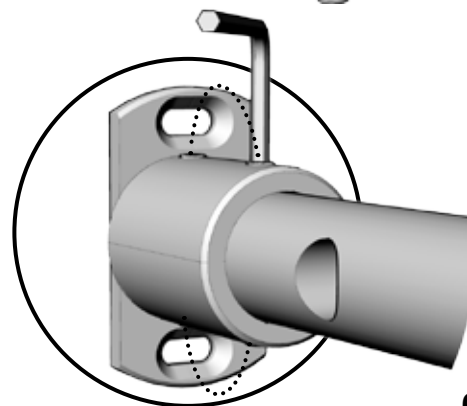
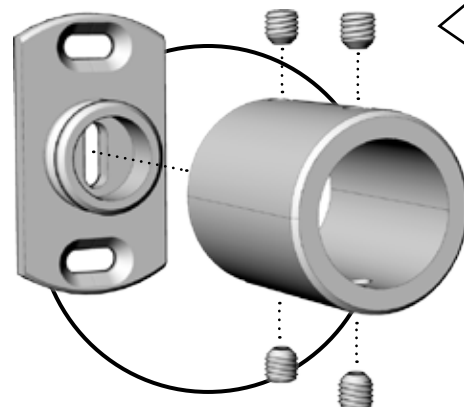

3 GLASS HOLDERS

Fasten the running rail (1) to the wide fixed panel (7) with the glass holders (4). Secure them temporarily in place.

Ensure that the running rail (1) is at the highest possible position in reference to the holes of the fixed large panel (7).

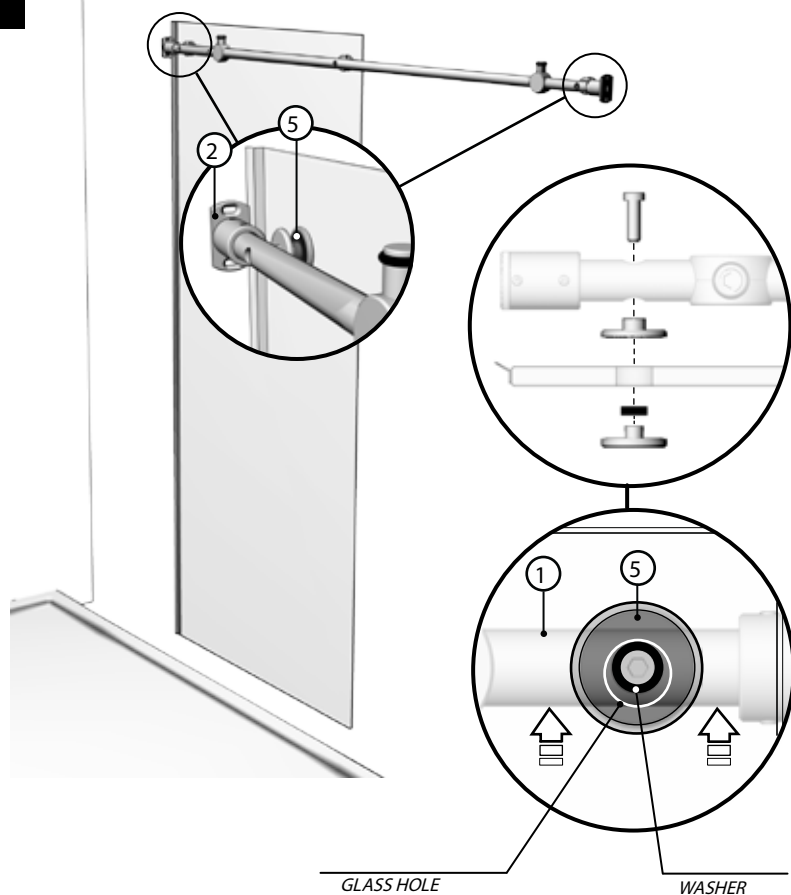

4 BOTTOM GLASS CLIPS

Insert gaskets (16) in the glass clip (14) and bottom center guide (15).

Position the glass clip (14) and bottom center guide (15) on the wide fixed panel (7) as illustrated.

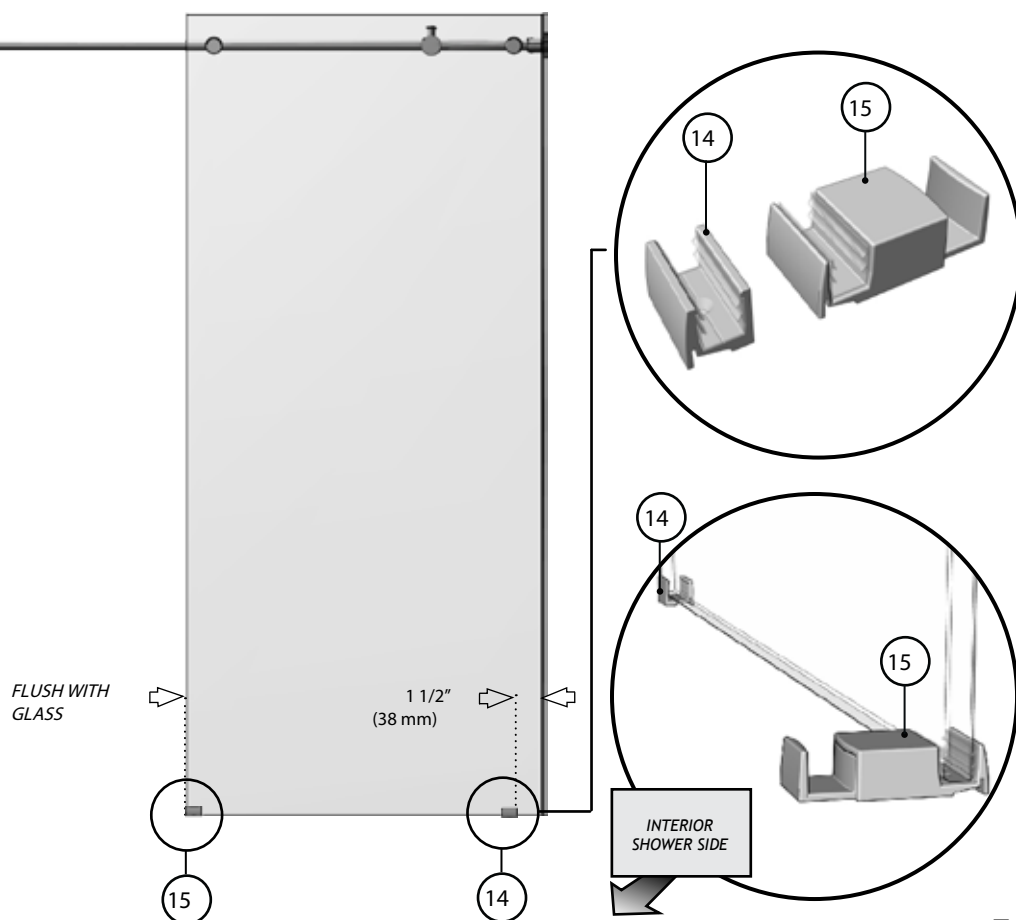

5 FIXED PANEL PLACEMENT

5A

Position the fixed panel assembly (7) on threshold of base (B) as shown. Adjust the wall brackets so as to ensure that they are pressed up against the walls. Distances A and B must however stay the same, as shown below.

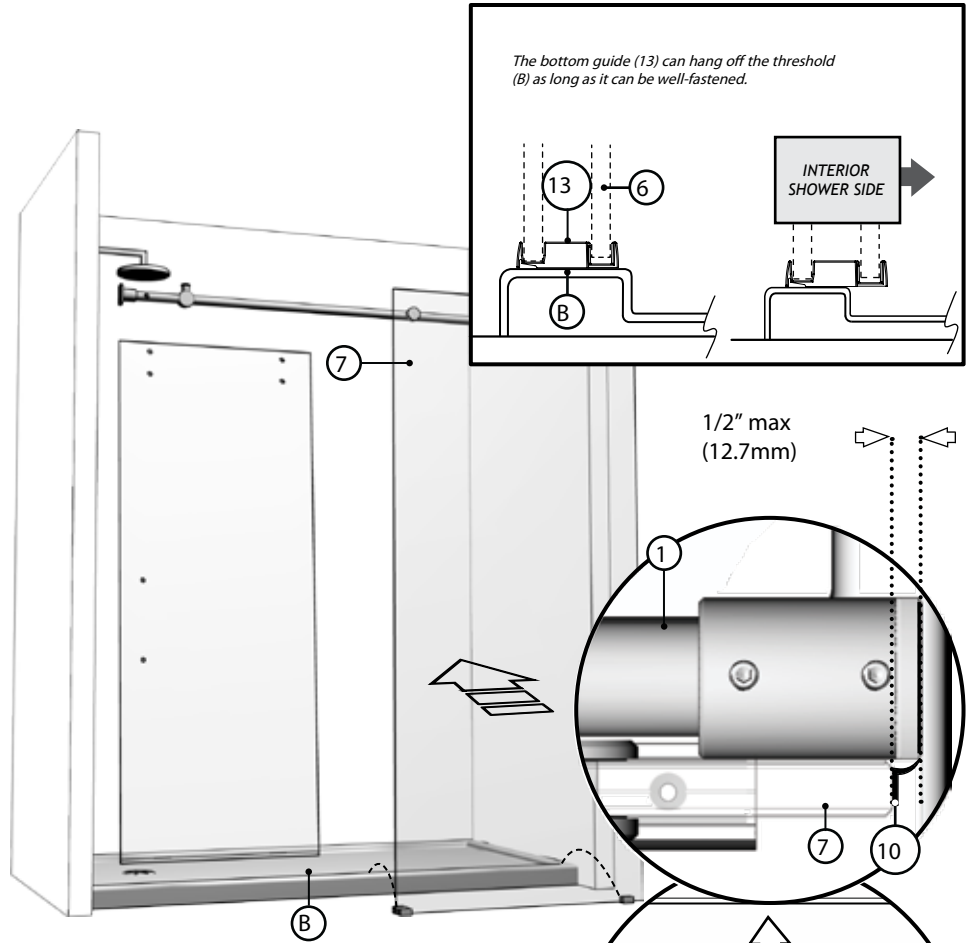
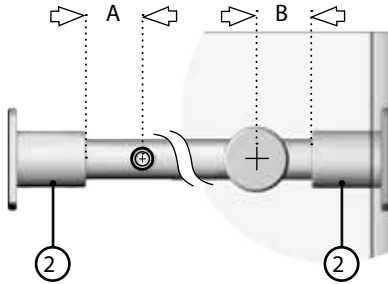

5B

Ensure that the gasket (10) collapses against the wall properly.

Ensure that the running rail (1) is level and that the wide fixed panel (7) is square. If a horizontal correction is required, adjust and level the glass fasteners (5).

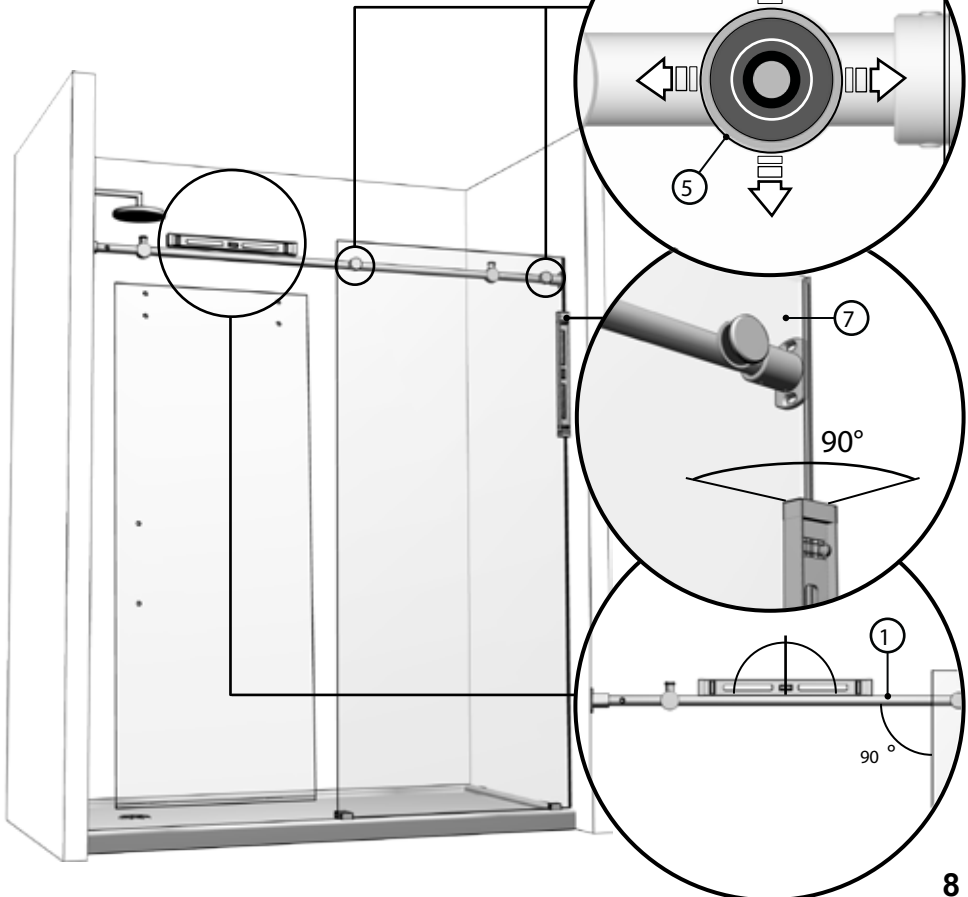

5C

Mark the screw locations for the wall brackets (2) on the walls on both sides of shower as well as the placement the glass clip (14) and bottom center guide (15).

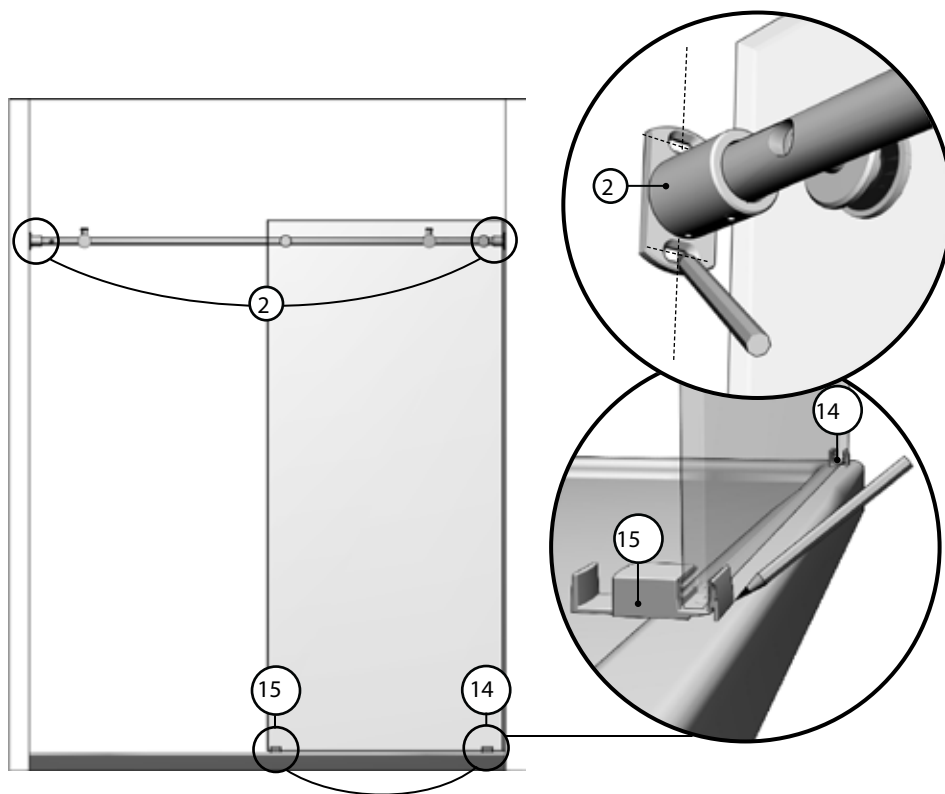

6 SEUIL DE RÉTENTION

6A

Remove the wide fixed panel assembly (7) so as to allow placement of the threshold (13) onto the base. Ensure that a bead of silicone (S) is applied to the underside of the threshold before installing.

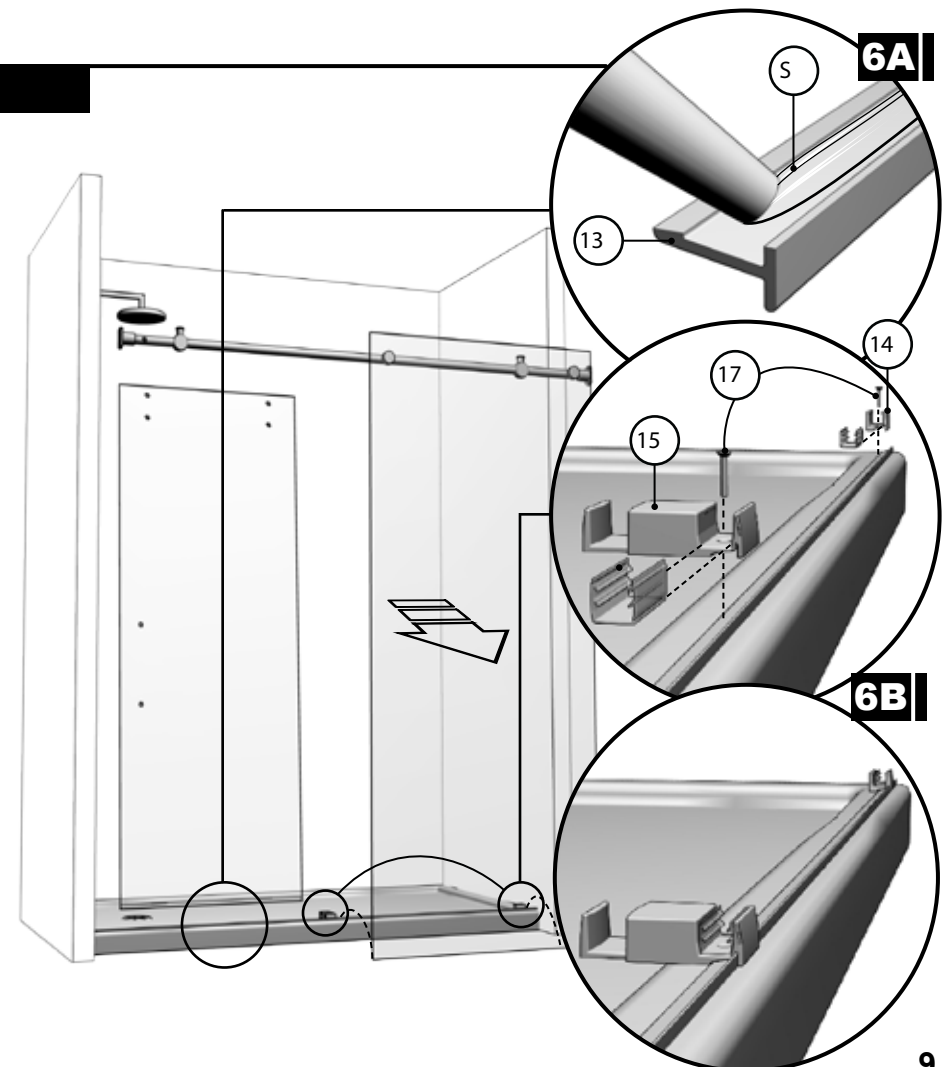

6B

Secure glass clip (14) and bottom center guide (15) with self drilling screws (17) and insert gaskets (16).

7 WALL BRACKETS

7A

Remove running rail (1) from wall brackets (2).
Drill holes in walls with a drill bit, intended for ceramic tiles, through to the wall stud.

Fasten the wall brackets (2) with #12-3 (17).

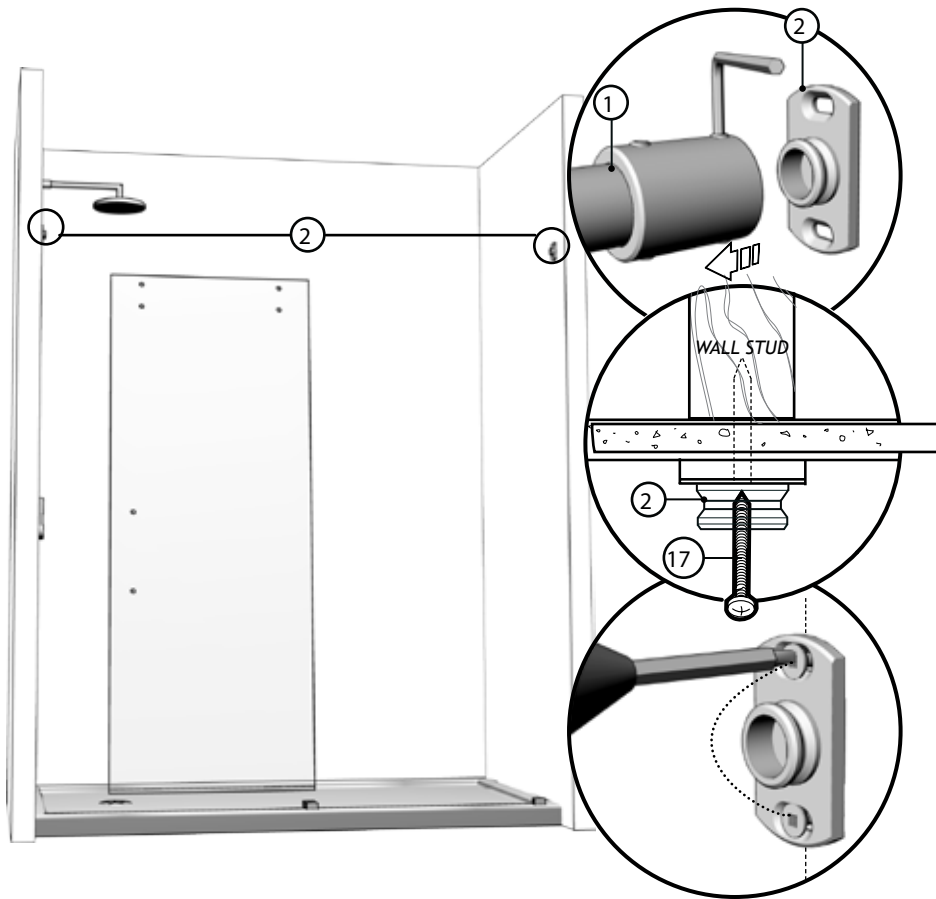

7B

Insert large fixed panel (7) back, ensuring that it's placed in the glass clip (14) and bottom center guide (15).

Slide expander (E) over wall bracket (2) and fasten set screws

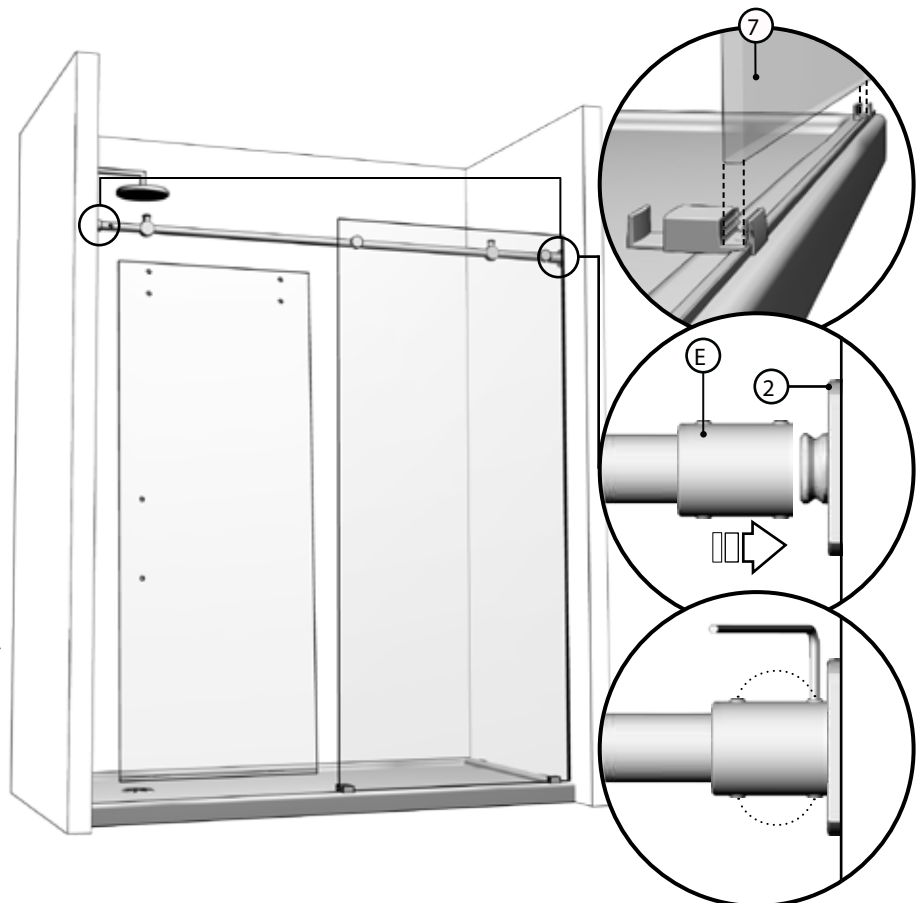

8 SMALL FIXED PANEL INSTALLATION

8A

Insert the bottom bottom glass clip (14) over the threshold (13), ensuring that the prescribed distance from the wall is respected. Screw down and insert the gasket (16).

8B

Place small fixed panel (8) within bottom glass clip (14).

8C

Fasten the small fixed panel (8) to the running rail (1) by means of the glass holders (5). Align the small fixed panel with the wall so as to ensure that the gasket (10) collapses against the wall.

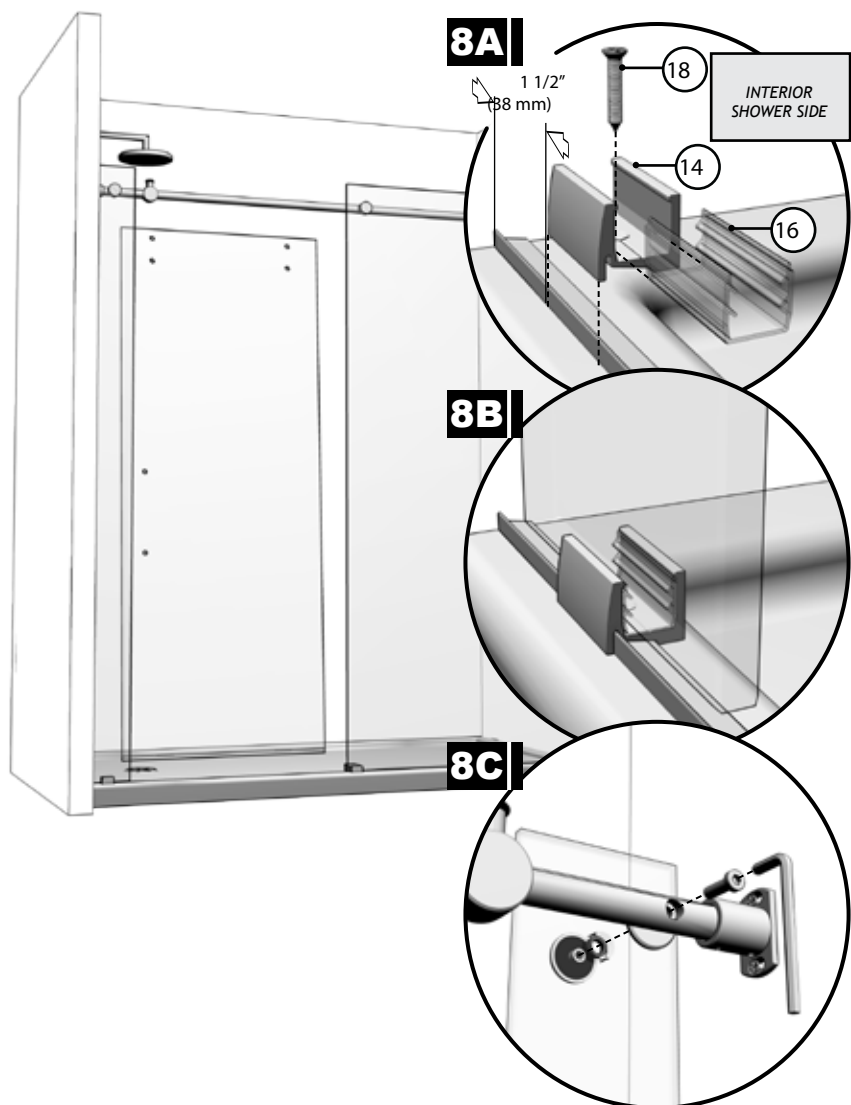

9 DOOR PANEL

9A

Assemble the 2 top rollers (3) to the door panel (6) as illustrated.

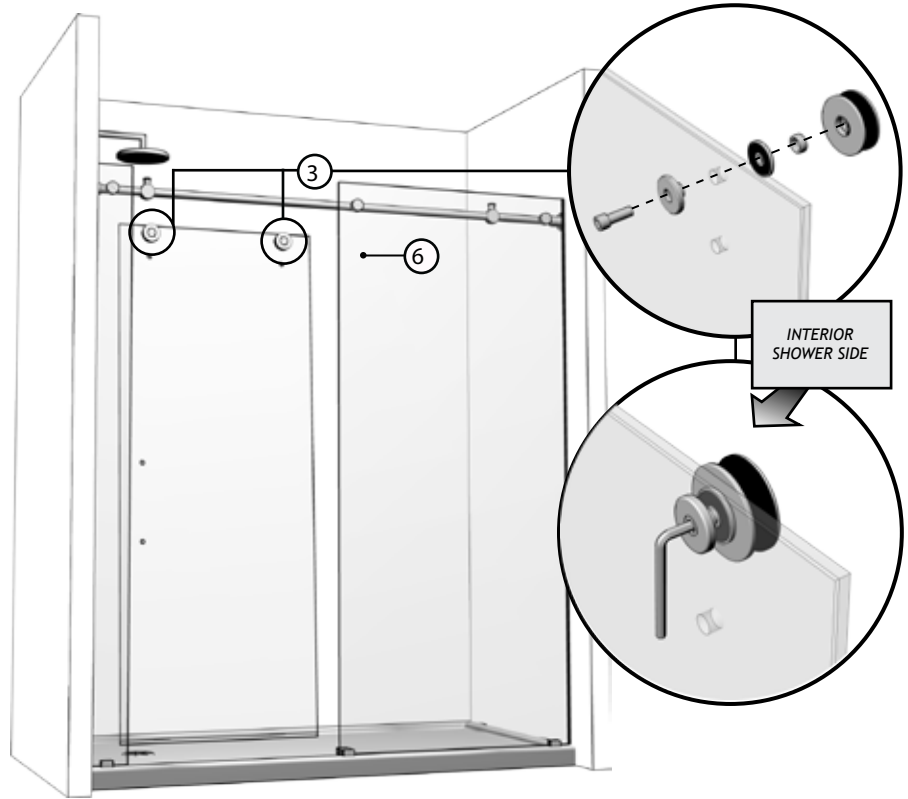

9B

Install sliding door (6) ensuring that rollers (3) are positioned over the running rail (1).

Ensure that sliding door (6) is placed within the bottom center guide (15).

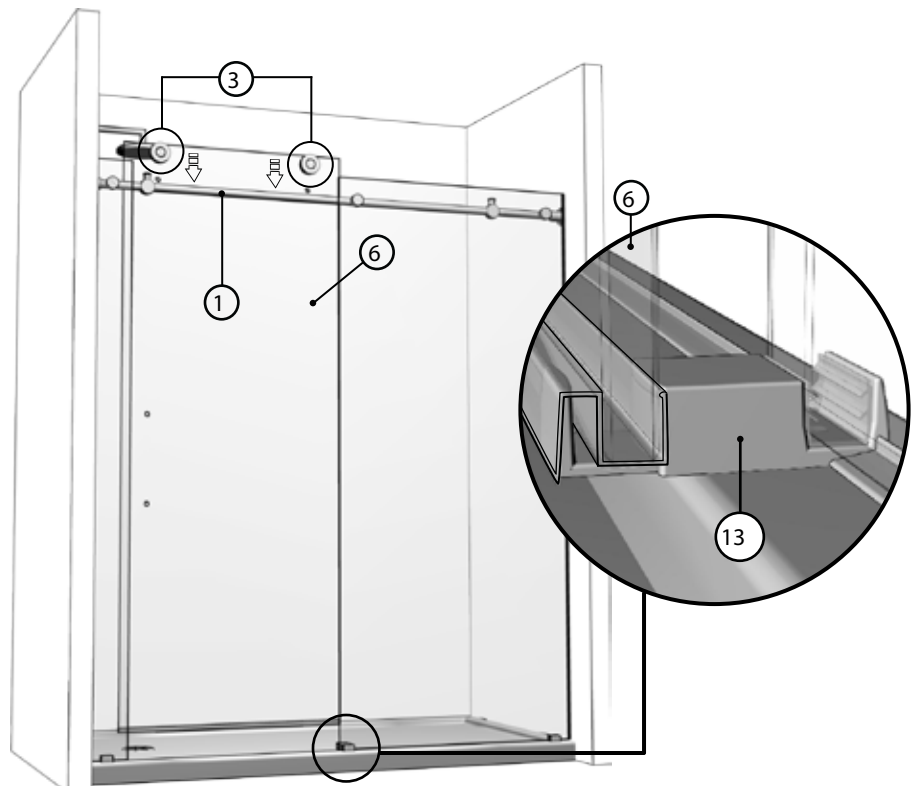

9C

Install bottom rollers, making sure that they are tangent to the running rail (1).

Through the use of the nonconcentric washers, adjust rollers so that the sliding door panel is parallel to the running rail.

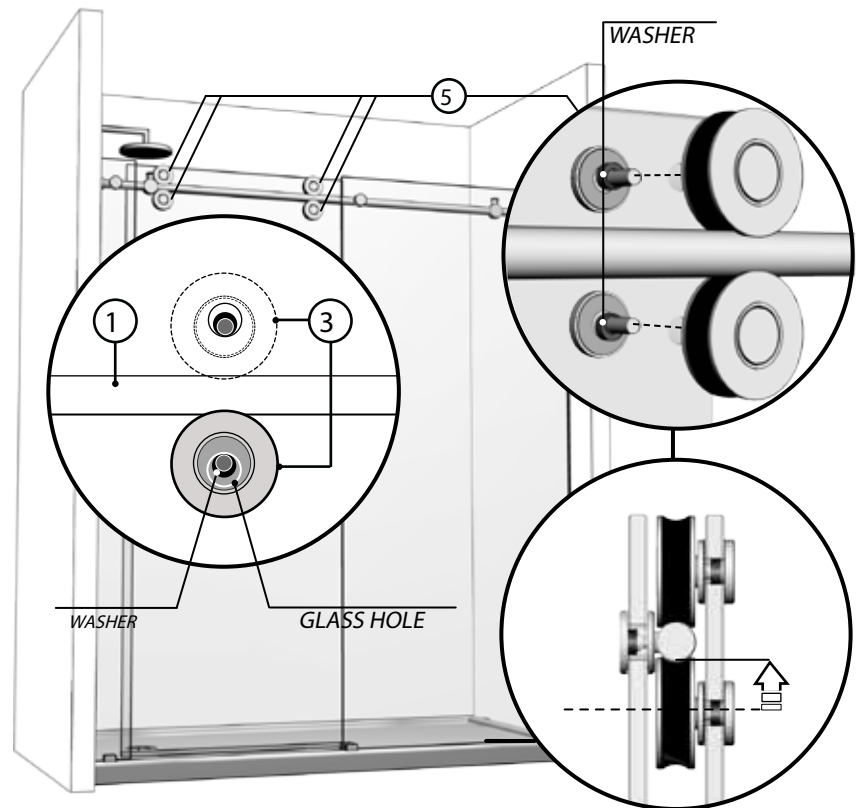
**10** STRAIGHT HANDLE

Install straight handle (9) onto sliding door (6). Ensure that clear washers on either side of glass are installed.

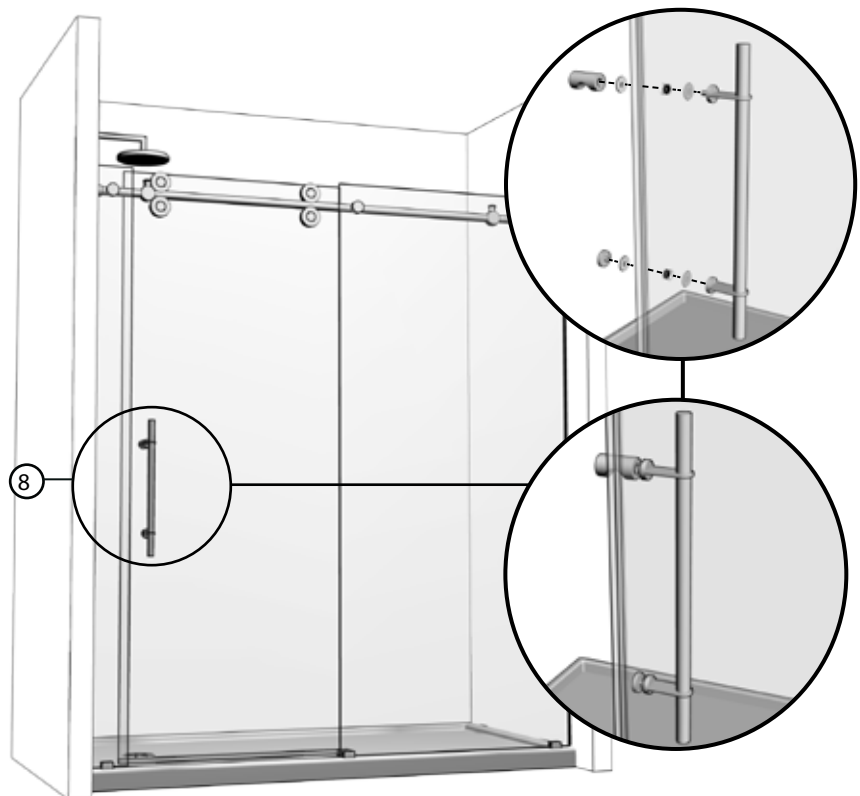

11

Install door side gasket (12) onto sliding door panel (6).

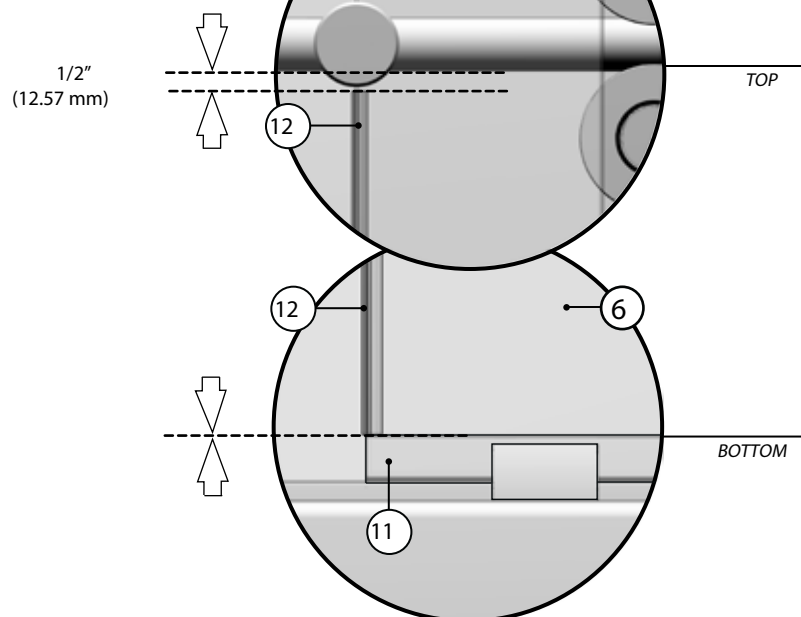

12 STOPPERS

Adjust the position of the stoppers (4) so as to ensure a maximum opening and closing range.

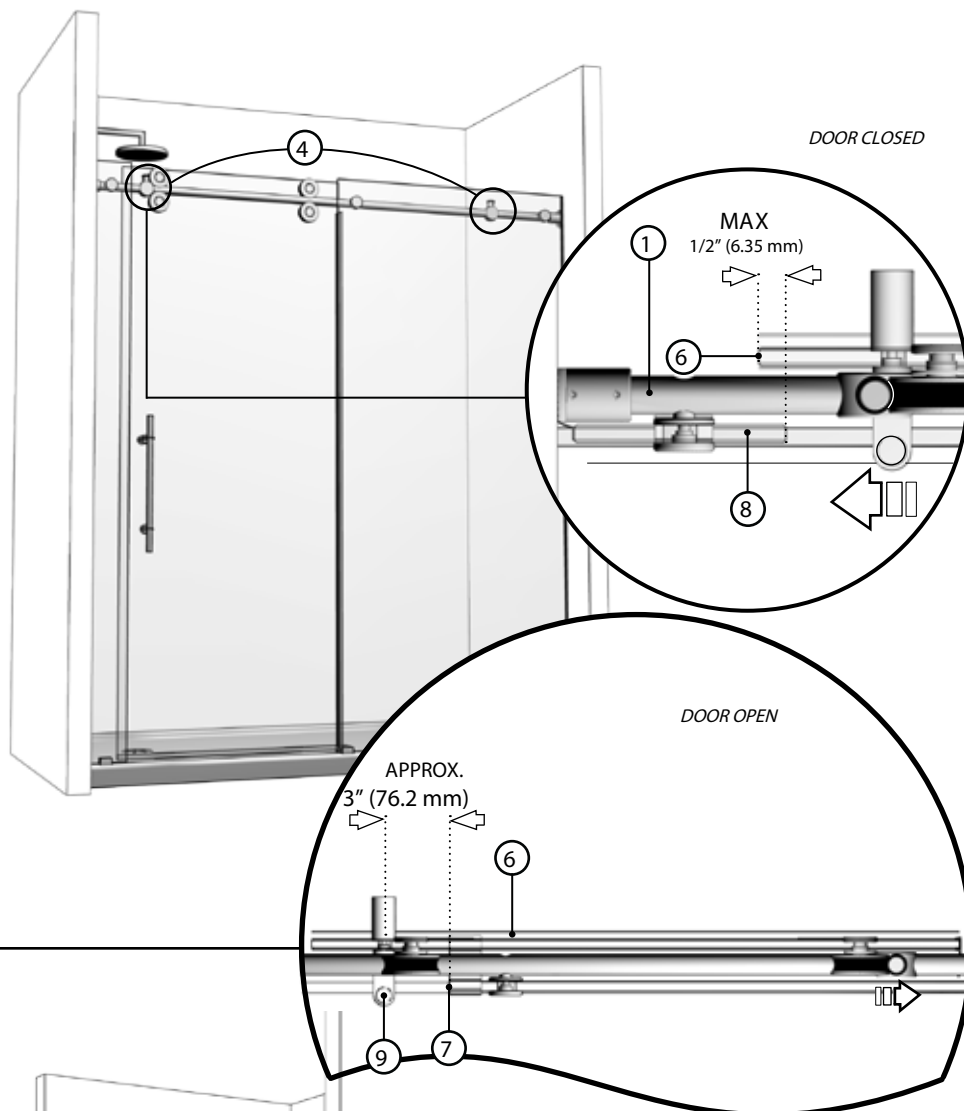

13 SILICONE

Apply silicone between the bottom of the fixed panel and the threshold of the base. Silicone application along the length of the threshold is also suggested. In both cases, it is done from the outside of the shower area.

