

Tel: 800-643-1514

www.alumaxshowerdoor.com

391CVM SERIES STIKSTALL™ SHOWER ENCLOSURE



!WARNINGS!

Contact your dealer for all warranty repair(s). This includes loose screws, broken parts, missing parts, glass replacement or any other product concern. Additionally, if the door does not open or close properly, contact your dealer to inspect the door and to make adjustments if required. Do NOT try to make any repairs or adjustments to the unit.

INSTALLATION WARNINGS

- a) Alumax Bath Enclosures by Hydro are intended to be installed by an experienced installer. If you need assistance with locating an experienced installer, contact us at 1.800.643.1514 or go to our website www.alumaxshowerdoor.com to access our "dealer locator". If a dealer is not listed in your area, call or send us an e-mail and we will find one for you.
- b) The enclosure must be properly installed per our published installation instructions. If NOT, the unit will not operate as designed which will cause hardware failure, glass breakage, leaking, other unidentified issues, and may cause nullification of warranty.
- c) Unpack your unit carefully and inspect for freight damage. Lay out and identify all parts using the instruction sheets as a reference. Before discarding the carton, check for small hardware bags that tend to fall into the bottom of the box. If any parts are damaged or missing, refer to the descriptions noted in the instructions when contacting your dealer for replacements.
- d) Before beginning installation, check the tub rim for level and both walls for plumb. If either is off more than 1/4" to 3/8", you should use a tapered filler which can be used to level the tub track or plumb the wall jambs.
- e) Wear safety glasses when drilling or cutting to avoid injury to the eyes.
- f) When drilling holes in ceramic tile or marble, use a center punch and hammer to carefully break the surface glaze so the drill can start without skidding. A skidding drill can cause damage to the surface and can be dangerous (risk of personal injury).
- g) Use caution and proper technique whenever using tools to avoid damage to property and/or personal injury.

GENERAL USAGE AND HANDLING WARNINGS

- a) Shower doors are not leak-proof. They are designed to direct water to the interior of the tub or shower under normal conditions. Excessive water pressure or directing the shower head directly at the door can result in leaks.
- b) Do not hang on towel bars or handles or use them to support your weight getting in and out of the bathtub or shower. Towel bars and handles are not intended to be used as grab bars for assistance getting in and out of the shower or bathtub. They are not intended to support a person's weight and could break.
- c) Do not use excessive force when opening and closing the enclosure. Excessive force can lead to glass breakage or other damage to the enclosure. Make sure wall jamb bumpers are securely fastened in place per the installation instructions.

GLASS USAGE AND HANDLING WARNINGS

- a) **TEMPERED GLASS CANNOT BE CUT.** Attempting to cut tempered glass will result in the glass breaking or shattering.
- b) **USE CAUTION WHEN HANDLING GLASS PANELS.** Safety tempered glass is very resistant to breakage, but it can still break if unequal pressure is placed on it during installation (or if cutting of the glass is attempted). In addition, the sharp corners of the panels can damage tile and floor coverings or cause injury.
- c) **PROTECT THE EDGES OF THE GLASS.** Never let the edge of the glass come in direct contact with concrete, tile, marble or other hard surfaces that may nick, or damage the glass edge in any way as this damage may cause a delayed blow. Always check the edge of the glass for nicks, slivers, rough areas, or clam shelling. Do not install the glass if these conditions are present.
- d) Alumax Bath Enclosures by Hydro is not liable for glass breakage of any kind.

CARE AND CLEANING WARNINGS

- a) The simplest and preferred method of cleaning your unit is by washing it with clean water and drying with a soft cloth.
- b) If soil is still present after drying, a non-abrasive cleanser with a pH of seven to eight may be used. Comet Bathroom Cleaner® has been tested and is recommended by the Bath Enclosure Manufacturers Association (BEMA).
- c) Contact your dealer for more information about glass coatings that will help keep the glass clean.
- d) **DO NOT USE SCOURING PADS, SHARP INSTRUMENTS, BLEACH OR ACID-BASED CLEANSERS TO CLEAN THE UNIT AS THEY MAY DAMAGE THE UNIT.**

LIMITED WARRANTY

- a) Alumax Bath Enclosures by Hydro provides a **LIMITED WARRANTY** on material and workmanship only. Primary glass and component suppliers must be included in all warranty claims.
- b) Alumax Bath Enclosures by Hydro is not responsible for glass breakage.
- c) Products must be handled, installed and maintained per our published Warning and Installation instructions or the warranty may be nullified.
- d) The Limited Warranty applies to the original owner only, and is not transferable.
- e) Please visit our website www.alumaxshowerdoor.com or call us at 1.800.643.1514 to get copies of our published warranty, installation and warranty policies.

391CVM STIKSTALL PARTS LIST

- A. 1 Curb (with weep slots)
- B. 2 Wall Jamb
- C. 6 Plastic Wall Anchors
- D. 6 #8 x 1 1/2 Truss Head Screws
- E. 2 Plastic Setting Blocks
- F. 1 Fixed Glass Panel
- G. 1 Header
- H. 7 #8 x 1/4 Truss Head Screws
- I. 1 Handle w/o Set Screws
- J. 2 Plastic Bushings
- K. 4 Metal Washers
- L. 4 Plastic Washers
- M. 2 Cone Head Screws
- N. 1 Handle with Set Screws
- P. 2 Fillers
- Q. 2 Magnetic Strike Vinyl
- R. 1 Hinge Jamb
- S. 1 Door Panel Assembly
- T. 2 Vertical Glazing Vinyl (V-219)
- U. 4 Horizontal Glazing Vinyl (V-220)
- V. 1 Drip Vinyl

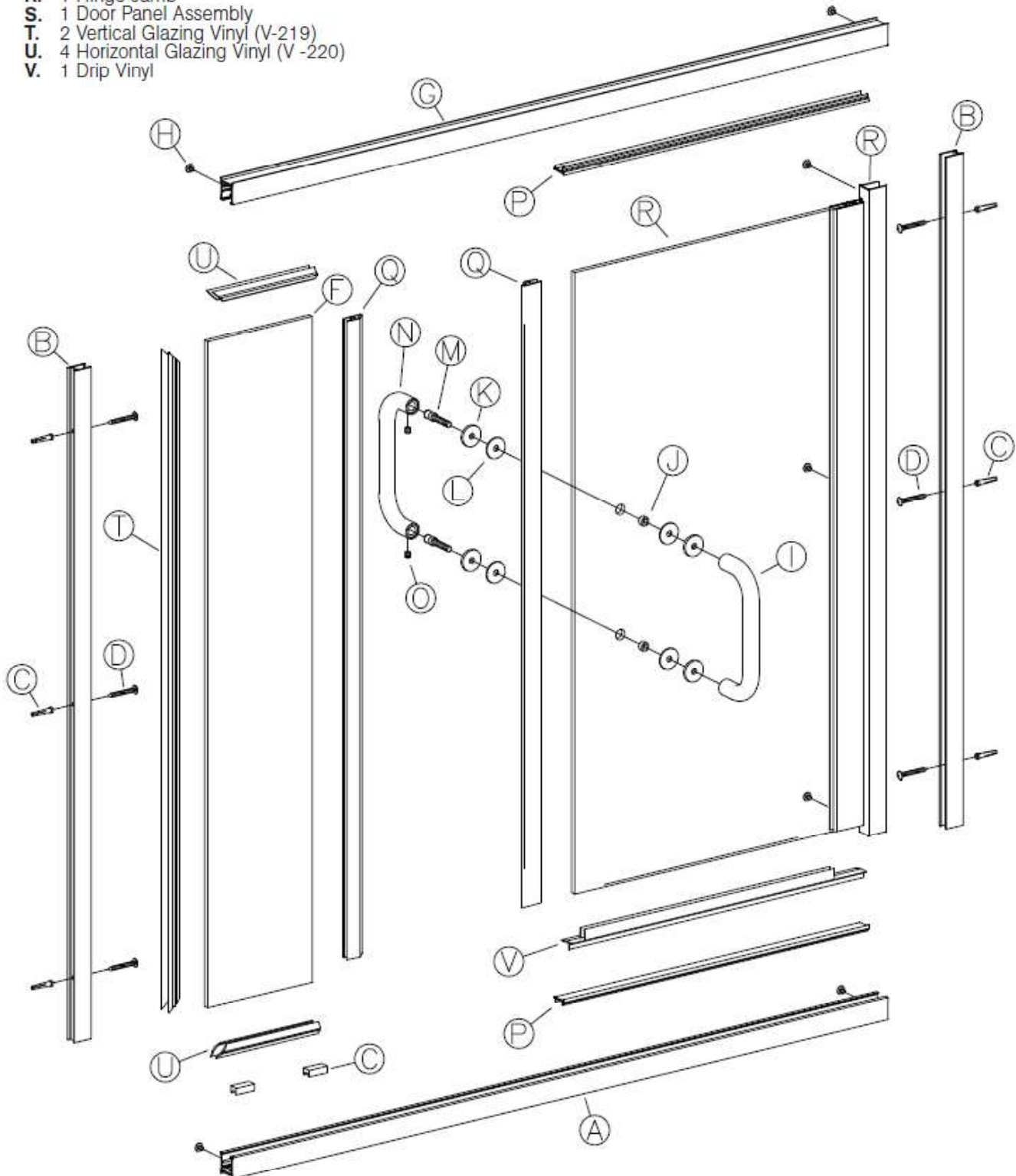

1

The ALUMAX 391CVM STIKSTALL Shower Enclosure is completely reversible and may be installed pivot-left or pivot-right. The door may pivot from the wall or from the center post. For maximum waterproofing, the pivot jamb should always be opposite the shower head. Using the illustration, determine the correct position for the door in your particular STIKSTALL installation. This instruction sheet depicts a pivot-right installation.

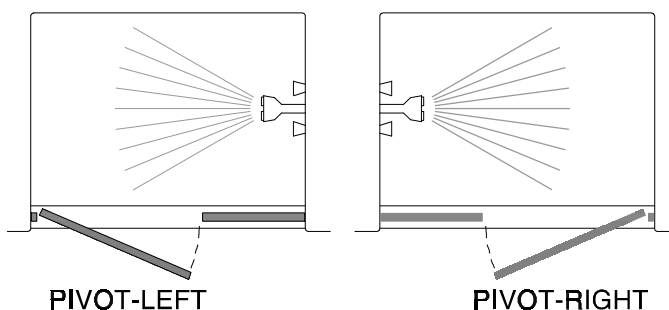

NOTE: Fixed glass panel size should be determined by formulas shown on ALUMAX detail sheets.

CAUTION: For safety reasons, the door panel must always open *outward*.

2

Measure the wall-to-wall opening at the shower sill and cut the curb [A] (with weep slots) to fit the full width of the opening. If necessary, use a file to round the lower corners of the curb to fit the shower sill properly.

Using a 3/16" drill bit, drill the interior face of the curb on both ends as shown.

Position the curb in the middle of the sill with the weep slots to the interior and mark its position with a pencil line along the interior and exterior base.

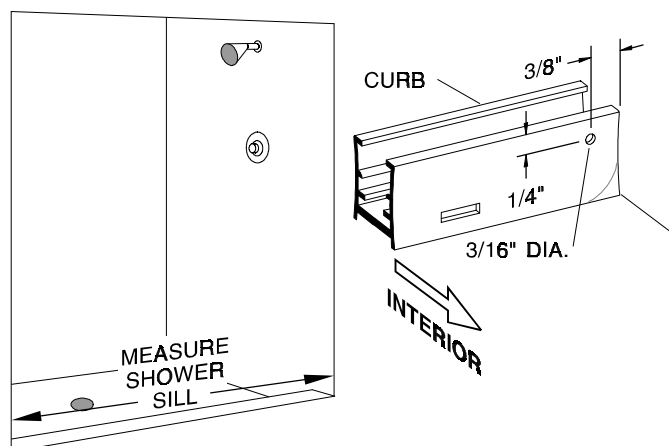

3

Place the two wall jambs [B] into the ends of the curb [A]. Masking tape may be used to hold the curb in place during this operation. Plumb the jambs and mark the hole locations on the wall. Remove all parts and drill the walls for mounting hardware.

For tile or marble walls, drill six 3/16" diameter holes and insert the plastic wall anchors [C]. Attachments to fiberglass or acrylic units can be made in two ways. If a reinforcement is built into the wall of unit, drill six 1/8" holes to install mounting screws directly into the reinforcement. If walls are not reinforced, drill six 3/16" holes and install plastic wall anchors or toggle bolts (toggle bolts not supplied by ALUMAX).

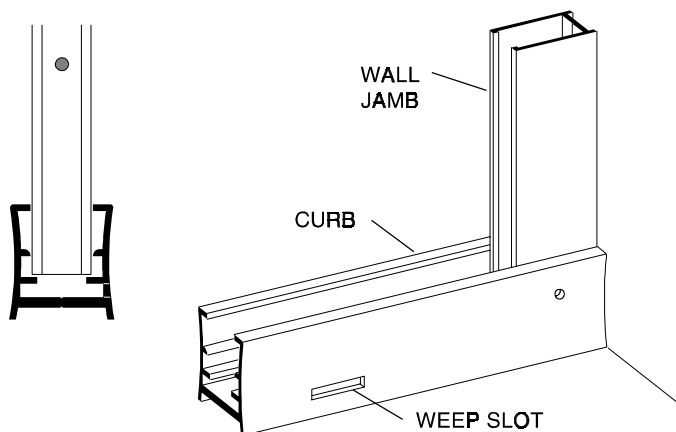

4

Wipe the shower walls and sill, the curb [A] and the wall jambs [B] with a clean, dry cloth to remove any dust or debris. Apply a 1/4" bead of caulk along the inside of both of the pencil lines marked in Step #2. Carefully replace the curb in the exact position marked. Caulk the inside of the curb ends where they meet the wall.

Replace both wall jambs and attach to the walls with six #8 x 1 1/2" truss head screws [D].

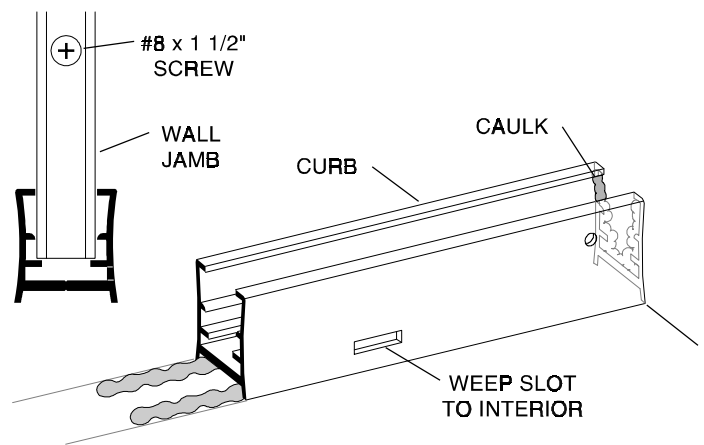

5

Place the setting blocks [E] in the curb [A] to support the fixed glass panel [F]. Position the blocks 3" from each corner of the glass panel. Remove any protective strips from the glass panel and set it into place on the setting blocks and approx. 1/2" into the wall jamb [B]. A strip of masking tape 1/2" from each vertical edge of the glass will aid alignment. The Inside of the Fixed Glass Panel [F] will need to be vertical. Galzing shims of varying sizes may be needed if the shower sill is not level. (Shims not supplied)

NOTE: Patterned, Deco or Etched glass should be installed with the smooth side of the glass to the inside of the shower.

NOTE: To facilitate out of plumb walls, the 1/2" glass bite may be varied from 1/4" to 3/4".

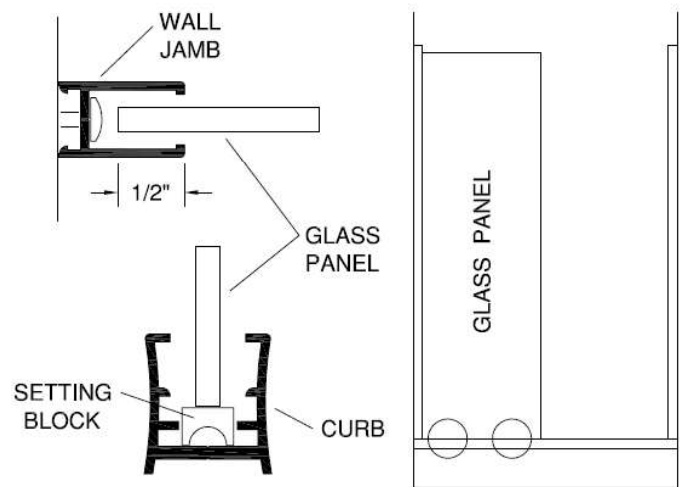

6

Measure the wall-to-wall opening at the top of the wall jambs [B] and cut the header [G] to fit the exact opening. Using a 3/16" drill bit, drill the interior face of the header on both ends as shown.

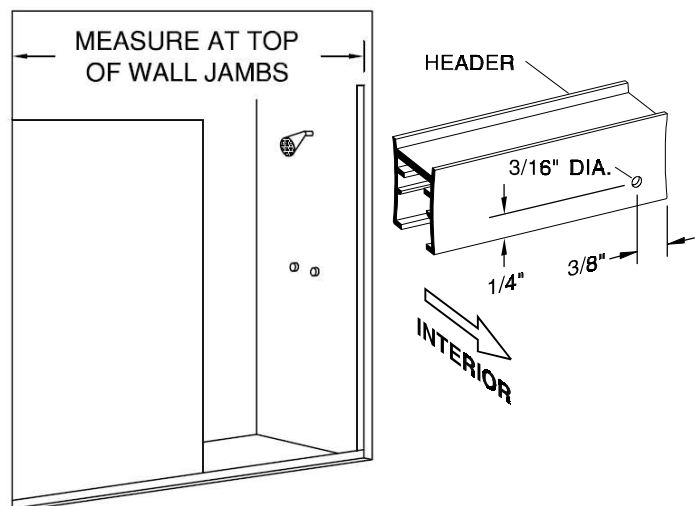

7

Press the header [G] over the wall jambs and fixed panel glass [F]. Using the holes in the ends of the curb and header as guides, drill four 1/8" holes into the wall jambs. Secure the curb and header to the wall jambs with four #8 x 1/4" truss head screws [H].

CAUTION: Slide glass away from the wall jamb before drilling to prevent damage or breakage.

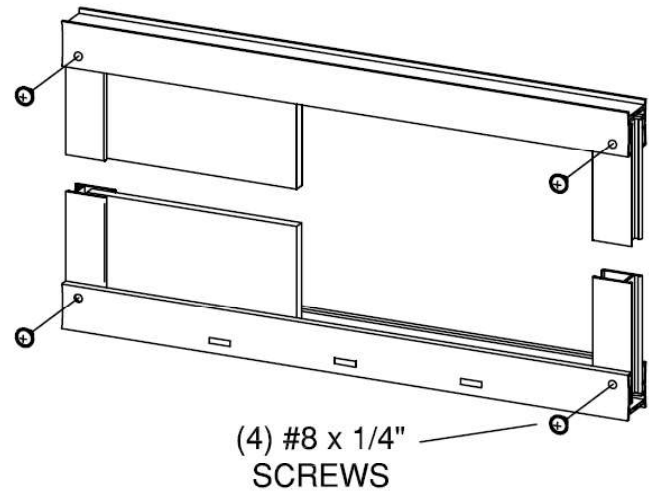

8

Locate the handle that has no set screws [I]. This is the exterior handle. Place a Plastic Bushing [J] into the top handle hole then place a Metal Washer [K] and a Plastic Washer [L] over the threads of a Cone Head Screw [M]. Insert them through the top hole and bushing. Place a plastic washer and a metal washer over the exposed thread. Loosely screw the Handle without the set screws onto the cone head screw. Repeat for the bottom hole. Tighten both cone head screws. Place the Handle with the set screws [N] over the exposed cone head screws and while holding the handle firmly against the metal washer, tighten the set screws [O].

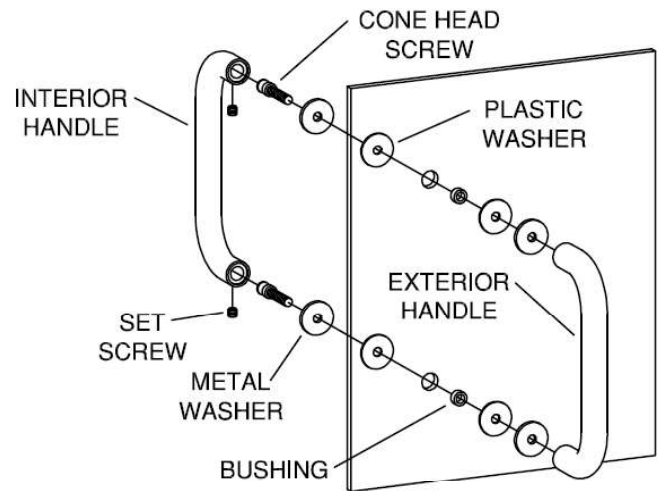

9

Press the Hinge Jamb [R] of the Door Panel Assembly [R] over the wall jamb. Make sure that the distance from the edge of the door glass to the edge of the fixed panel is 13/16". The fixed panel glass can be moved into and out of the wall jamb for adjustment (1/2" overlap at the wall jamb is optimal). The hinge jamb and wall jamb also have some overlap adjustment. Plumb the Hinge Jamb. From inside of the enclosure drill three 1/8" diameter holes through the hinge jamb and into the wall jamb. **CAUTION:** Do not drill through the front of the Jambs. Attach the Hinge Jamb/Door Panel Assembly to the wall Jamb using three #8 x 1/4" Truss Head Screws [H].

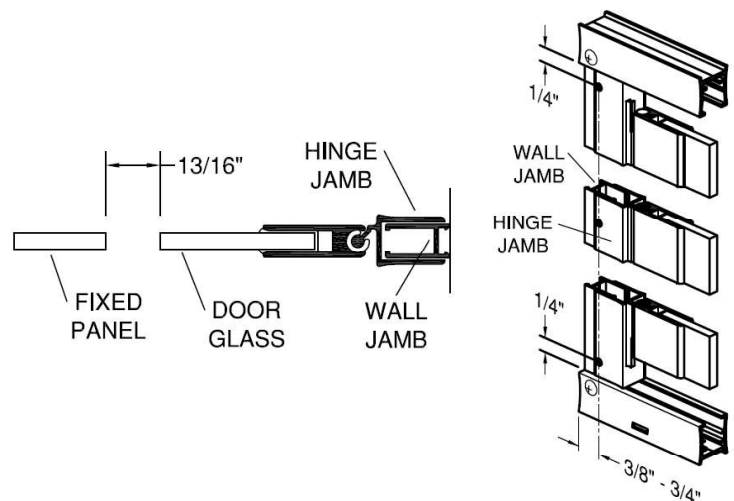

10

Snap the Fillers [P] into the Curb [A] and Header [G] between the hinge jamb and the edge of the fixed panel glass, with the raised lip to the exterior. Make sure that the fillers are touching the hinge jamb and the edge of the fixed panel glass.

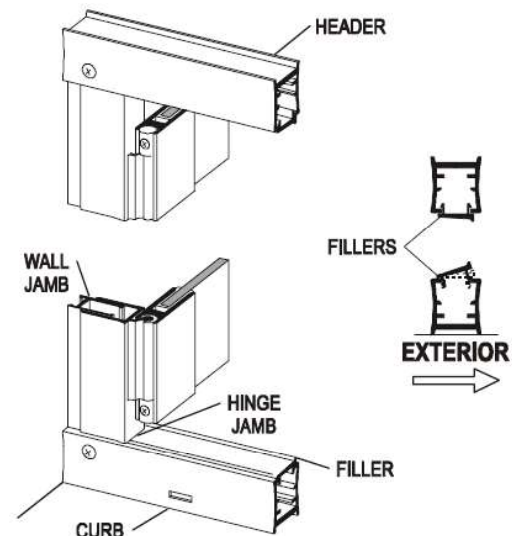

11

Cut the Magnetic Strike Vinyl [Q] for the fixed panel (unit height-2 5/16"). Attach it to the strike edge of the fixed panel glass, with the angled face to the exterior of the enclosure. Cut the Magnetic Strike Vinyl [Q] for the door (equal to the door glass height). Attach it to the strike edge of the door, with the angled face to the interior of the enclosure. Close the door and make sure the magnetic vinyl pieces catch.

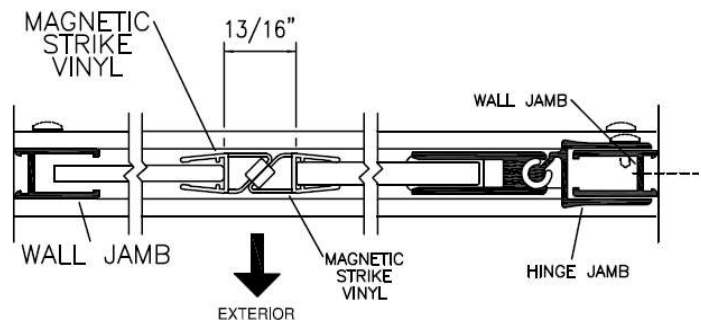



CAUTION: For safety reasons, door should only open to the exterior of the unit. Forcing the door to pass the strike vinyl, or into the shower, will damage the unit and cause failure.

12

Inspect the pieces of black glazing vinyl, and note the two different profiles. The smaller shape [T] is installed vertically and the larger shape [U] is installed horizontally. For structural strength and maximum water resistance, these vinyls are designed to fit tightly between the glass and framing. To speed installation, use glass cleaner for lubrication and a small block of wood to press the vinyl into place.

NOTE: These glazing vinyls have been pre-lubricated with a water-based silicone compound. Wash hands thoroughly after glazing and avoid contact with eyes or mouth.

FIXED GLASS PANEL	VERTICAL	HORIZONTAL
1/4" GLASS REQUIRES:	V-219 	V-220 

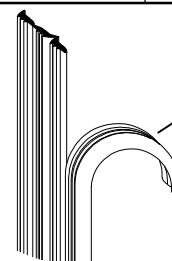

STANDARD SIZES SHIPPED WITH 4 PIECE VINYL (TEAR APART)

13

Cut four pieces of the Horizontal Glazing Vinyl [U] 1/2" longer than the exposed opening around the fixed panel glass and trim the ends at a 45 degree Angle. Cut four pieces of the horizontal vinyl 1" – 2" long and press into the header and curb at the middle of the glass, to hold it in place temporarily. Starting at both ends, press the exterior top horizontal vinyl into place, working from the outside towards the middle. Be careful not to stretch the vinyl. Install the other three in a similar fashion.

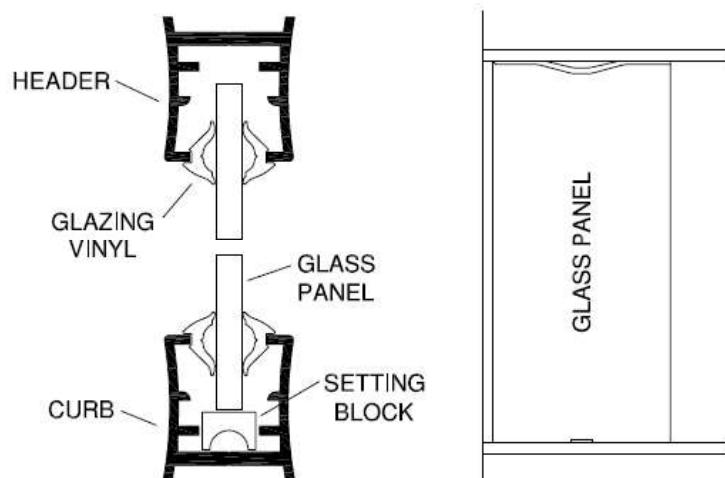

14

Cut 2 pieces of the Vertical Glazing Vinyl [T] 1" longer than the exposed opening around the fixed panel glass, and trim the ends at a 45 degree angle. Cut 2 pieces of the vertical vinyl 1" – 2" long and press into middle of the wall jamb to hold the glass temporarily. Starting at both ends, press the exterior vertical vinyl into place, working from the outside towards the middle. Be careful not to stretch the vinyl. Install the other three in a similar fashion.

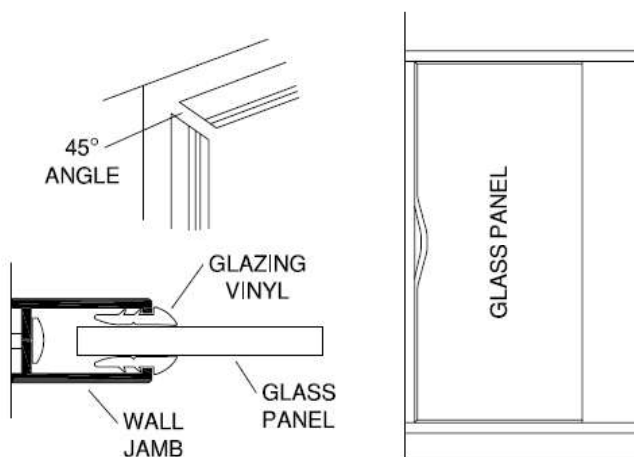

15

Determine the desired handing of the Door Drip Vinyl [V]. The deflector leg must go to the inside of the unit, and the pre-cut notch goes under the hinge rail, as shown. The strike side of the vinyl also needs to be notched, and cut to fill the gap below the Magnetic Strike Vinyl. Measure the gap between the glazing vinyl on the hinge rail and the edge of the magnetic strike vinyl and add 3/4" to that. Mark the vinyl and cut it, measuring from the vertical legs on the pre-notched end of the vinyl, as shown. Notch the strike end of the vinyl 3/4", removing only the vertical legs. Snip off the corner of the deflector leg on the strike end, at a 45 degree angle and about 1/4" deep. Press the Drip Vinyl onto the bottom of the door glass, making sure that the drip leg is to the interior of the shower.

NOTE: Some additional trimming might be necessary, depending on conditions.

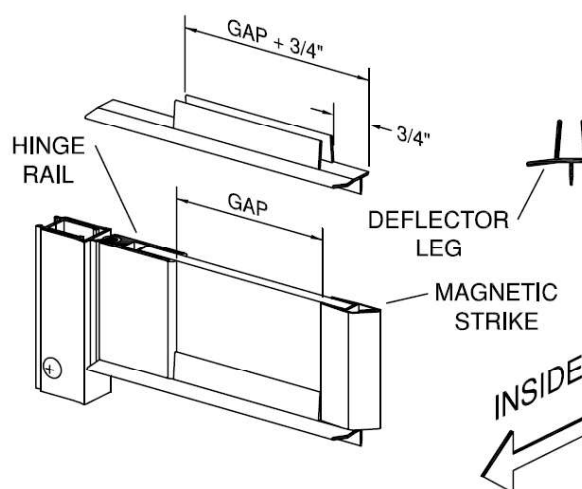

Clean all debris from the interior and exterior of the frame and carefully caulk the interior jamb-to-wall and curb-to base joints. For appearance you may wish to caulk the exterior joints as well. We recommend that you wait twenty-four hours before the first shower to allow the caulking to fully cure.

