

| DATE | S.M. | REVISION | BY |
|------|------|----------|----|
| | | | |
| | | | |
| | | | |
| | | | |
| | | | |

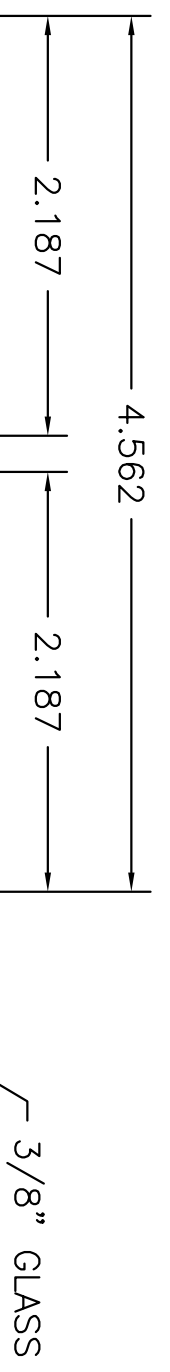
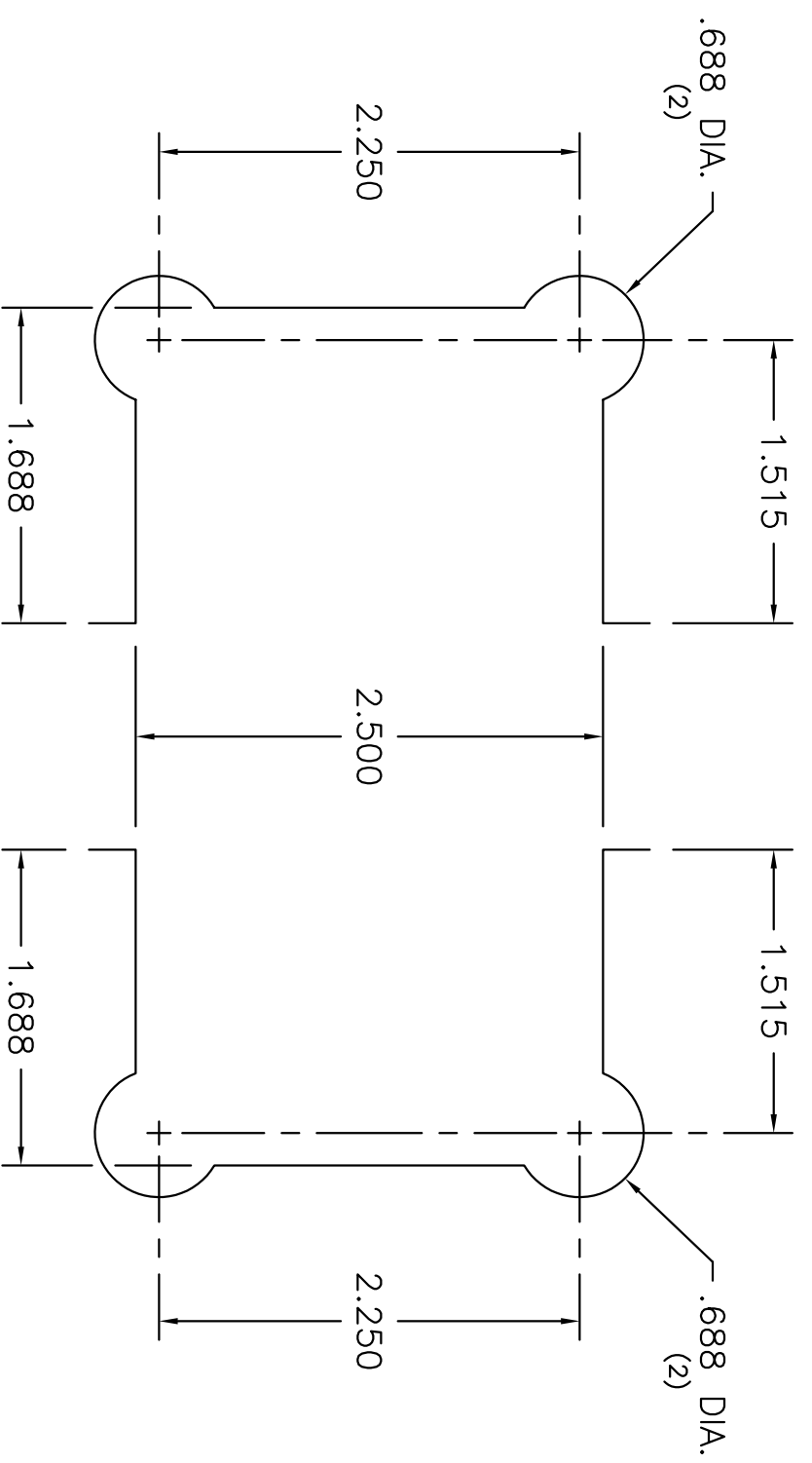
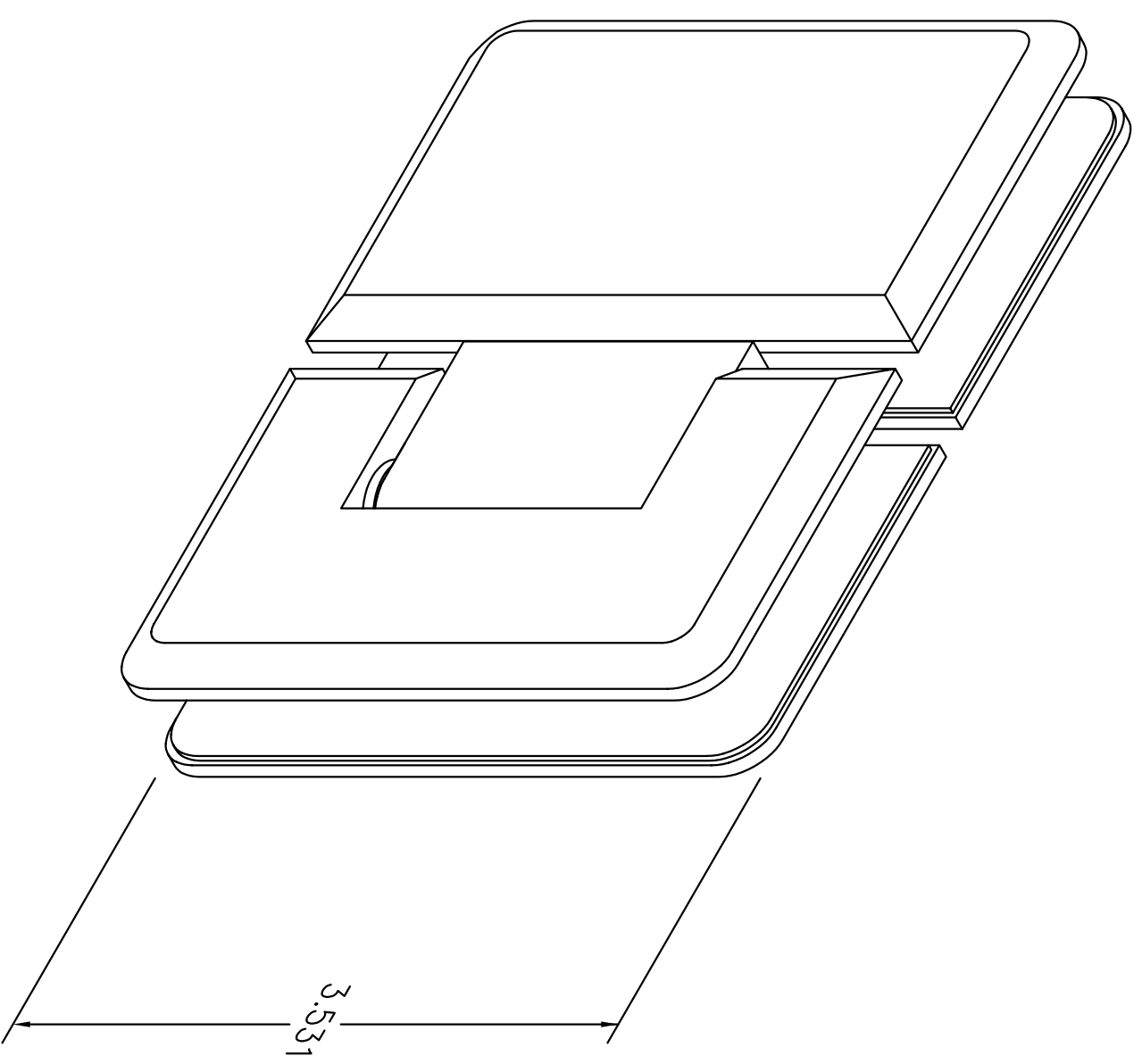

TOP VIEW OF HINGE AND GLASS
FULL SIZE

GLASS NOTCH
FULL SIZE

| | |
|-----------|----------------|
| G03710240 | Polish Chrome |
| G03710101 | Satin Chrome |
| G03710464 | Polish Brass |
| G03710185 | Satin Brass |
| G03710657 | Polish Nickel |
| G03710694 | Brush Nickel |
| G03711531 | White |
| G03711843 | Oil Rub Bronze |

T885A EPH-XXX-04801

ALCOA

Extruded Construction Products

Magnolia Operations

1617 N. WASHINGTON, MAGNOLIA, ARK.
71754-0040 870-234-4260

| | | | |
|-----------|-----------------------------|----------|------------|
| PART NAME | HINGE - GLASS TO GLASS 180° | PART NO. | G03710240 |
| MATERIAL | BRASS | COLOR | VARIABLES |
| DRN. BY | DS | SCALE | FULL & NTS |
| DATE | 12-15-98 | DIE NO. | |