

180° POLYCARBONATE STRIKE

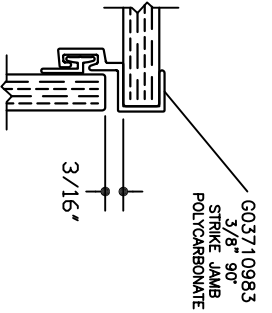

90° POLYCARBONATE STRIKE

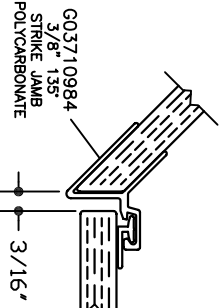

135° POLYCARBONATE STRIKE

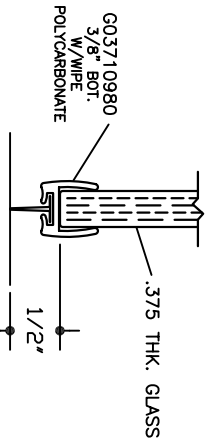

POLYCARBONATE  
@ BOTTOM OF DOOR

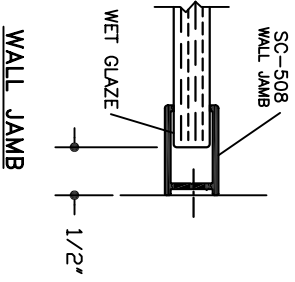

WALL JAMB

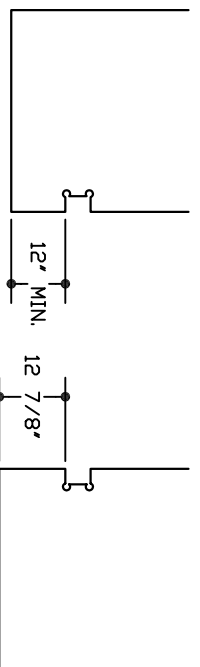

GLASS DOOR

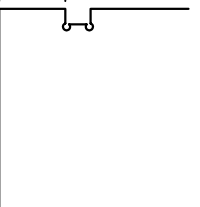

GLASS PANEL

When running channel under the door also, the panel hinge notch is 7/8" farther from the edge of the glass than on the door.

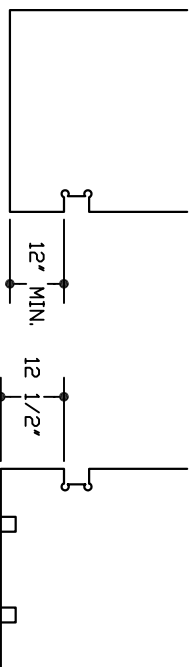

GLASS DOOR

GLASS PANEL

When installing panel with clips, panel hinge is 1/2" farther from the edge of the glass than on the door.

1/2 SIZE DETAIL

NOTE: Glazing material for all KD units and Glazed units must conform to Ansi Z97.1 and CPSC Standard 16 CFC 1201 Category I and II.

XHGOPTIONS.DWG  
DATE: 11-13-06

**SERIES**  
**DESIGNLINE**  
**HEAVY GLASS**  
**OPTIONS**



**ALUMAX**  
**BATH ENCLOSURES**

a product of ALCOA  
PO Box 40 - Magnolia, AR 71754-0040 - (870) 234-4260  
www.alumaxbath.com