

8" TUBULAR SINGLE
MOUNT HANDLE

- G03710242 Polish Chrome
- G03710103 Satin Chrome
- G03710466 Polish Brass
- G03710187 Satin Brass
- G03710659 Polish Nickel
- G03710696 Brush Nickel
- G03711533 White
- G03711845 Oil Rub Bronze

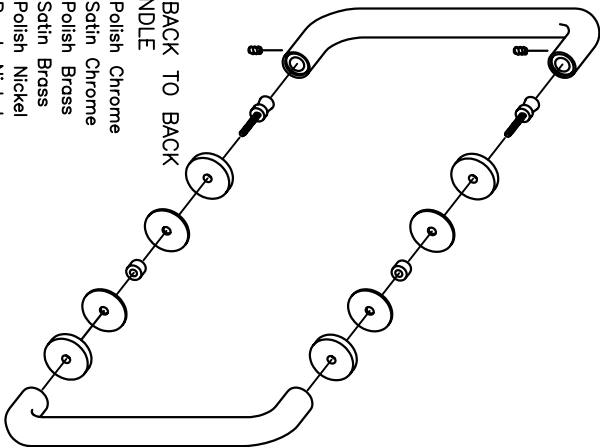

8" TUBULAR BACK TO BACK
HANDLE

- G03710243 Polish Chrome
- G03710104 Satin Chrome
- G03710467 Polish Brass
- G03710188 Satin Brass
- G03710660 Polish Nickel
- G03710697 Brush Nickel
- G03711534 White
- G03711846 Oil Rub Bronze

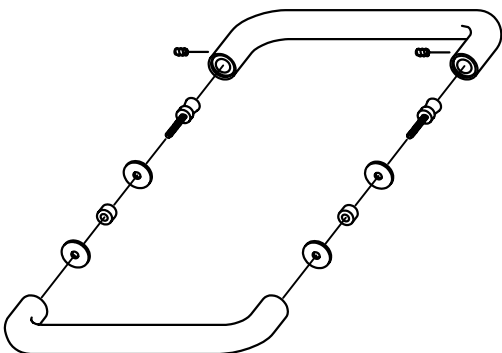

6" TUBULAR BACK TO BACK
HANDLE

- G03710261 Polish Chrome
- G03710118 Satin Chrome
- G03710485 Polish Brass
- G03710200 Satin Brass
- G03710672 Polish Nickel
- G03710711 Brush Nickel
- G03711552 White
- G03711859 Oil Rub Bronze

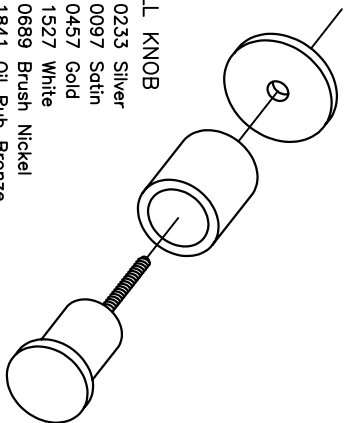

PULL KNOB

- G03710233 Silver
- G03710097 Satin
- G03710457 Gold
- G03711527 White
- G03710689 Brush Nickel
- G03711841 Oil Rub Bronze

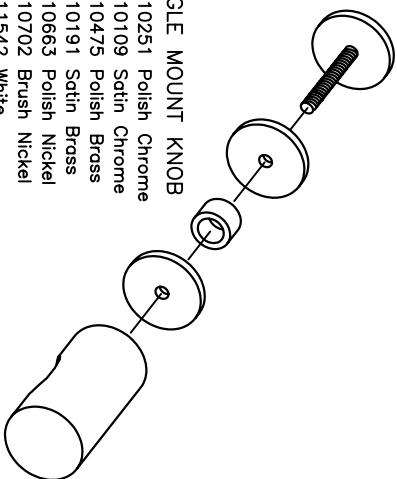

SINGLE MOUNT KNOB

- G03710251 Polish Chrome
- G03710109 Satin Chrome
- G03710475 Polish Brass
- G03710191 Satin Brass
- G03710663 Polish Nickel
- G03710702 Brush Nickel
- G03711542 White
- G03711850 Oil Rub Bronze

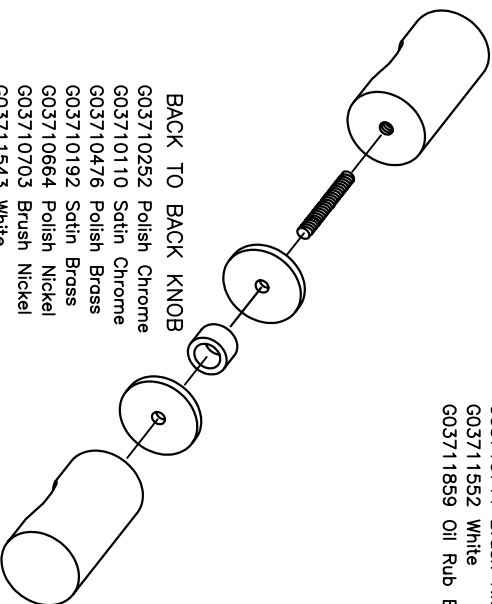

BACK TO BACK KNOB

- G03710252 Polish Chrome
- G03710110 Satin Chrome
- G03710476 Polish Brass
- G03710192 Satin Brass
- G03710664 Polish Nickel
- G03710703 Brush Nickel
- G03711543 White
- G03711851 Oil Rub Bronze

1/2 SIZE DETAIL

SERIES

**DESIGNLINE
HANDLE AND
KNOB**

NOTE: Glazing material for all KD units and Glazed units must conform to Ansi Z97.1 and CPSC Standard 16 CFC 1201 Category I and II.

XHGTUBU-HANDLE.DWG
DATE: 11-7-06



BATH ENCLOSURES

a product of ALCOA

PO Box 40 - Magnolia, AR 71754-0040 - (870) 234-4260
www.alumaxbath.com