

TECHNICAL SPECIFICATIONS – STIKSTALL

391 - Door/Panel

StikStall Unit - 3/16" Glass



SC-505 Header Standard

Options

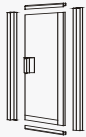

390C
Standard
Door

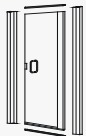

390CV
Standard
Door

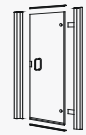

390D
Standard
Door



SC-923
Light Euro
Header

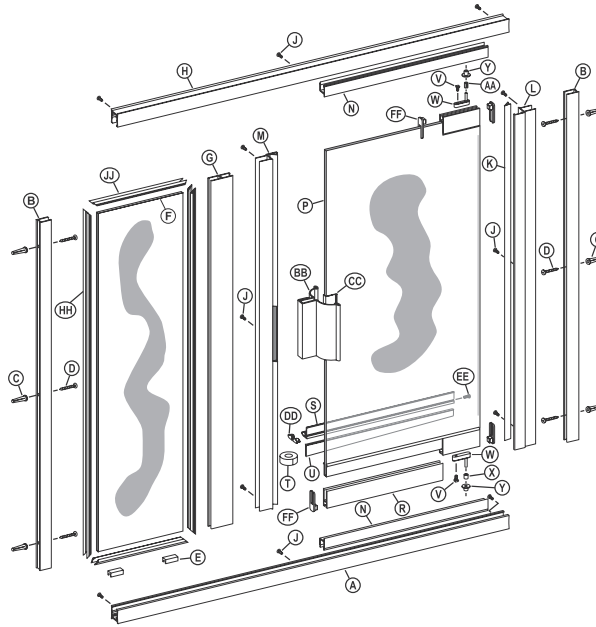

- A. 1 SC-505A Curb (with weep slots)
- B. 2 SC-508 Wall Jamb
- C. 6 Plastic Wall Anchors
- D. 6 #8 x 1 1/2 Truss Head Screws
- E. 2 Plastic Setting Blocks
- F. 1 Fixed Glass Panel
- G. 1 SC-511 180° Post
- H. 1 SC-505 Header
- J. 12 #8 x 1/4 Truss Head Screws
- K. 1 Clear Vinyl Pivot Jamb Seal
- L. 1 SC-552 Pivot Jamb
- M. 1 SC-552 Strike Jamb Assy (Magnetic)
- N. 2 SC-507 Snap-in Fillers
- P. 1 Glazed Door Panel
- R. 1 Bottom Rail
- S. 1 SC-589 Drip Rail
- T. 1 Roll of Double Stick Tape
- U. 1 Tapered Drip Vinyl
- V. 2 #10 x 7/16 Set Screws
- W. 2 Pivot Block
- X. 1 Nylon Spacer
- Y. 2 Nylon Pivot Bushings
- AA. 1 Security Washer
- BB. 1 Door Handle Assembly
- CC. 1 Door Handle Vinyl (4")
- DD. 2 Drip Plug
- EE. 1 #6 x 3/8 Truss Head Screw
- FF. 4 Rail End Caps
- HH. 4 Pcs. Vert. Glazing Vinyl (72)
- JJ. 4 Pcs. Horiz. Glazing Vinyl (72)

Glass Size

Door opening width as determined

390 - Door glass height = Unit ht. - 5

Door glass width = Door Opening - 3/8

390C - Door glass height = Unit ht. - 3 5/8

Door glass width = Door Opening - 1 3/16

390CV - Door glass height = Unit ht. - 3 1/8

Door glass width = Door Opening - 1 3/16

390D - Door glass height = Unit ht. - 3 1/8

Door glass width = Door Opening - 1/2

Panel glass width = Unit width - door opening width - 2 3/4

Panel glass ht. = Unit ht. - 1

Standard Door Openings

390 - 24 3/4" and 28 3/4" at 68 1/2" Unit Height
24 3/4" and 30 3/4" at 72" Unit Height
24 3/8" and 28 3/8" at 76" Unit Height

390C - 25" and 30" at 68 1/2" Unit Height
25" and 30" at 72" Unit Height
25" and 30" at 76" Unit Height

390CV - 25 3/16" and 29 3/16" at 68 1/2" Unit Height
25 3/16" and 29 3/16" at 72" Unit Height
29 3/16" at 76" Unit Height

Calculations

Maximum allowable width of unit = 72

Maximum allowable height of unit = 84

Adjustment for Wall Conditions

+ 3/8", - 0" on Door Panel

± 1/4" on Fixed Panel