

# TECHNICAL SPECIFICATIONS – STIKSTALL

## 394 - Neo-Angle Panel/Door/Panel StikStall Unit - 3/16" Glass

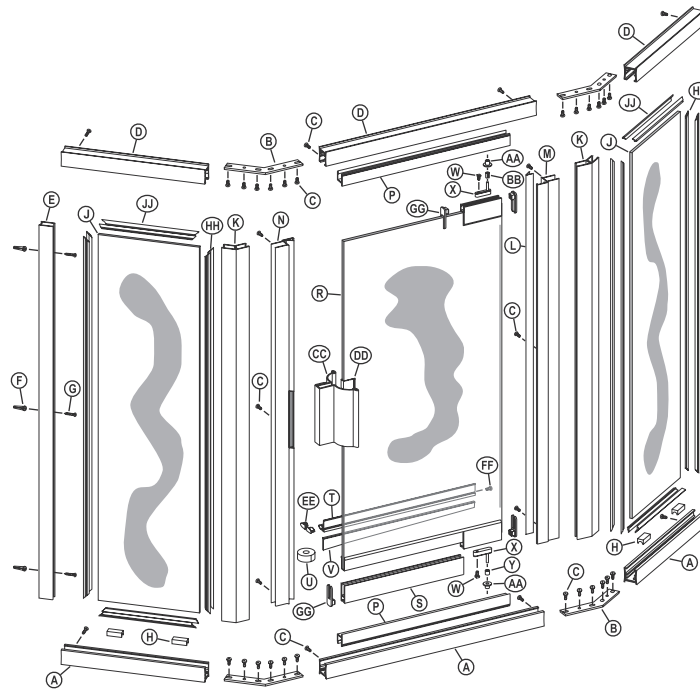

SC-505 Header Standard



- A.** 3 SC-505A Curb Sections (with weep slots)
- B.** 4 135° Anchor Plates
- C.** 44 #8 x 1/4 Truss Head Screws
- D.** 3 SC-505 Header Sections
- E.** 2 SC-508 Wall Jamb
- F.** 6 Plastic Wall Anchors
- G.** 6 #8 x 1 1/2 Truss Head Screws
- H.** 4 Plastic Setting Blocks
- J.** 2 Fixed Glass Panels
- K.** 2 SC-512 135° Posts
- L.** 1 Clear Vinyl Jamb Seal
- M.** 1 SC-552 Pivot Jamb
- N.** 1 SC-552 Strike Jamb Assy (Magnetic)
- P.** 2 SC-507 Snap-in Fillers
- R.** 1 Glazed Door Panel
- S.** 1 Bottom Rail
- U.** 1 SC-589 Drip Rail
- V.** 1 Roll Double Stick Tape
- W.** 1 Tapered Drip Vinyl
- X.** 2 #10 x 7/16 Set Screws
- Y.** 2 Pivot Blocks
- T.** 1 Nylon Spacer
- AA.** 2 Nylon Pivot Bushings
- BB.** 1 Security Washer
- CC.** 1 Door Handle Assy
- DD.** 1 Door Handle Vinyl (4)
- EE.** 1 Drip Plug
- FF.** 1 #6 x 3/8 Truss Head Screws
- GG.** 4 Rail End Caps
- HH.** 8 Pcs. Vert. Glazing Vinyl (72)
- JJ.** 8 Pcs. Horiz. Glazing Vinyl (72)

### Glass Size

Door opening width as determined

- 390 - Door glass height = Unit ht. - 5  
Door glass width = Door Opening - 3/8
- 390C - Door glass height = Unit ht. - 3 5/8  
Door glass width = Door Opening - 1 3/16
- 390CV - Door glass height = Unit ht. - 3 1/8  
Door glass width = Door Opening - 1 3/16
- 390D - Door glass height = Unit ht. - 3 1/8  
Door glass width = Door Opening - 1/2

Panel glass width = Centerline dim. - 13/16  
Panel glass ht. = Unit ht. - 1

### Standard Door Openings

- 390 - 24 3/4" and 28 3/4" at 68 1/2" Unit Height  
24 3/4" and 30 3/4" at 72" Unit Height  
24 3/8" and 28 3/8" at 76" Unit Height
- 390C - 25" and 30" at 68 1/2" Unit Height  
25" and 30" at 72" Unit Height  
25" and 30" at 76" Unit Height
- 390CV - 25 3/16" and 29 3/16" at 68 1/2" Unit Height  
25 3/16" and 29 3/16" at 72" Unit Height  
29 3/16" at 76" Unit Height

### Calculations

Maximum allowable width of unit = 36 x 36 x 36  
Maximum allowable height of unit = 84

### Adjustment for Wall Conditions

± 1/4" on Fixed Panels