

TECHNICAL SPECIFICATIONS – STIKSTALL

792 - Door with Return Panel

StikStall Unit - 5/32" Glass



SC-505 Header Standard

Options

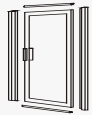

790C
Standard
Door



SC-923
Light Euro
Header

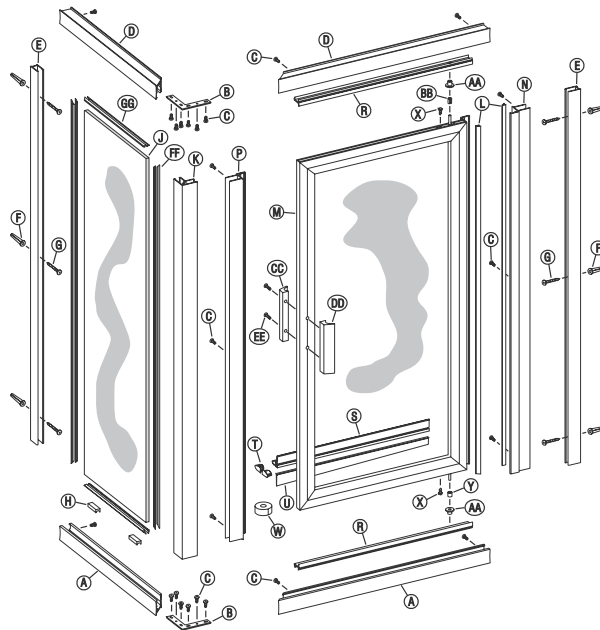

- A.** 2 SC-505A Curb Sections (with weep slots)
- B.** 2 90° Anchor Plates
- C.** 24 #8 x 1/4 Truss Head Screws
- D.** 2 SC-505 Header Sections
- E.** 2 SC-508 Wall Jamb
- F.** 6 Plastic Wall Anchors
- G.** 6 #8 x 1 1/2 Truss Head Screws
- H.** 2 Plastic Setting Blocks
- J.** 1 Fixed Glass Panel
- K.** 1 SC-513 90° Post
- L.** 2 Clear Vinyl Jamb Seals
- M.** 1 Glazed Door Panel
- N.** 1 SC-552 Pivot Jamb
- P.** 1 SC-552 Strike Jamb (Magnetic)
- R.** 2 SC-506 Snap-in Fillers
- S.** 1 SC-589 Drip Rail
- T.** 2 Drip Plugs
- U.** 1 Tapered Drip Vinyl
- W.** 1 Roll Double Stick Tape
- X.** 2 #10 x 7/16 Sq. Head Set Screws
- Y.** 1 Nylon Spacer
- AA.** 2 Nylon Pivot Bushings
- BB.** 1 Security Washer
- CC.** 1 Interior Door Handle
- DD.** 1 Exterior Door Handle
- EE.** 2 #6 x 1 1/4 Round Head Screws
- FF.** 4 Pcs Vert. Glazing Vinyl (72)
- GG.** 4 Pcs Horiz. Glazing Vinyl (48)

Glass Size

Door opening width as determined

790 - Door glass height = Unit ht. - 5
Door glass width = Door Opening - 2 1/4

790C - Door glass height = Unit ht. - 5
Door glass width = Door Opening - 2 3/16

Panel glass width = Centerline dim. - 7/8

Panel glass ht. = Unit ht. - 1

Standard Door Openings

790 - 24 5/8" and 29 5/8" at 68 1/2" Unit Height
24 5/8" and 29 5/8" at 72" Unit Height
24 5/8" and 29 5/8" at 76" Unit Height

790C - 24 9/16" and 29 9/16" at 68 1/2" Unit Height
24 9/16" and 29 9/16" at 72" Unit Height
24 9/16" and 29 9/16" at 76" Unit Height

Calculations

Maximum allowable width of unit = 38 x 38
Maximum allowable height of unit = 84

Adjustment for Wall Conditions

+ 3/8", - 0" on Door Panel
± 1/4" on Return Panel