

**K-HSZ - Hapa**

**INSTRUCTION MANUAL**

**ALUMAX**  
*Kula Collection*

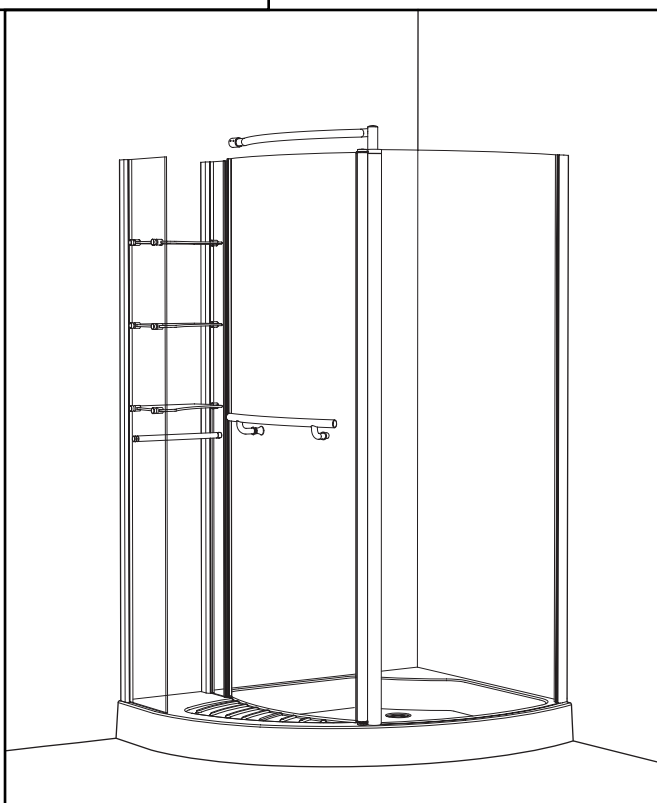
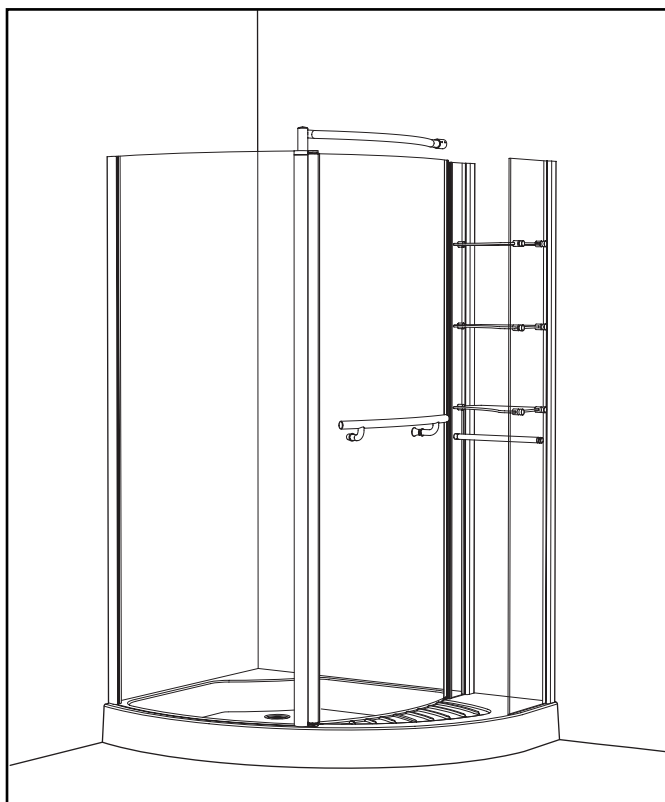

07.10

KH001

- Model Number: K-HSZ

*Please keep this manual and product code number for future reference  
and to order replacement parts if necessary.*

## ● Table of Contents

MODEL NUMBER.....	2
GENERAL INSTRUCTIONS .....	3
INSTALLATION OVER CERAMIC TILES.....	3
NOTICE.....	3
CARE FOR YOUR FRAMELESS SHOWER DOOR .....	3
CHOICE OF INSTALLATION .....	4
PARTS LISTING.....	5
PROVIDED HARDWARE.....	6
TOOLS AND MATERIALS REQUIRED .....	7
INSTALL THE WALL JAMBS.....	8
MOUNT THE WALL JAMBS (CONTINUED). ....	9
PANEL INSTALLATION. ....	10
MOUNT THE DOOR.....	11
GASKET INSTALLATION.....	12
INSTALL THE SUPPORT BAR. ....	13
FASTEN UNIT.....	14
INSTALL THE SHELFs. ....	15
SILICON SEALING.....	16

## ● General Instructions

- Read this manual carefully and completely before proceeding.
- It is recommended that you wear safety glasses at all times during the installation.

## ● Installation over Ceramic Tiles

- Silicone should be used to seal the gap where the ~~ceramic~~ meet the fixed panel.
- If your shower door is to be installed over ceramic tiles, the tiles should lay completely under the wall jamb.

## ● Notice

- Caulking: no sealant is required inside the shower.
- All models are equipped with transparent sealing gaskets.

## ● Care for your Frameless Shower Door

- Never use scouring powder pads or sharp instruments on metal pieces or glass panels.  
An occasional wiping down with a mild soap diluted in water is all that is needed to keep the panels and aluminum parts looking new.
- We recommend wiping the glass panels with a squeegee after each use.

Product specifications are subject to change  
without notice.

## CHOICE OF INSTALLATION

1. Choice your door opening: left (1A) or right (1B)

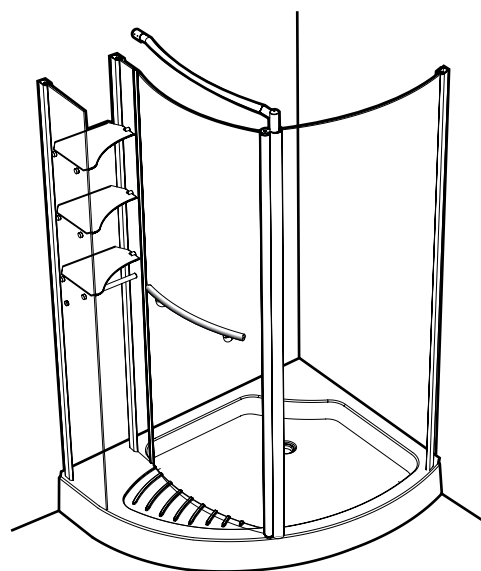
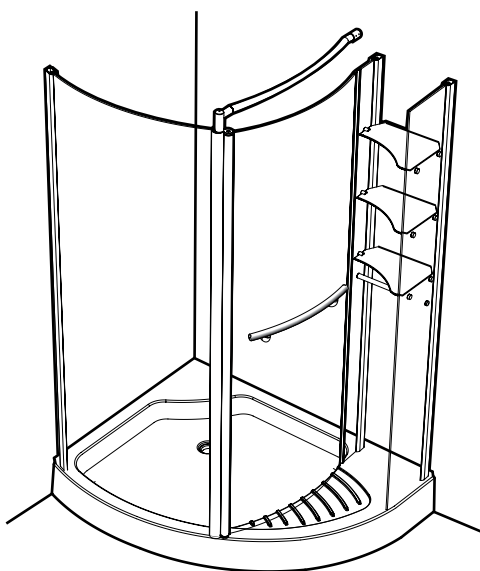
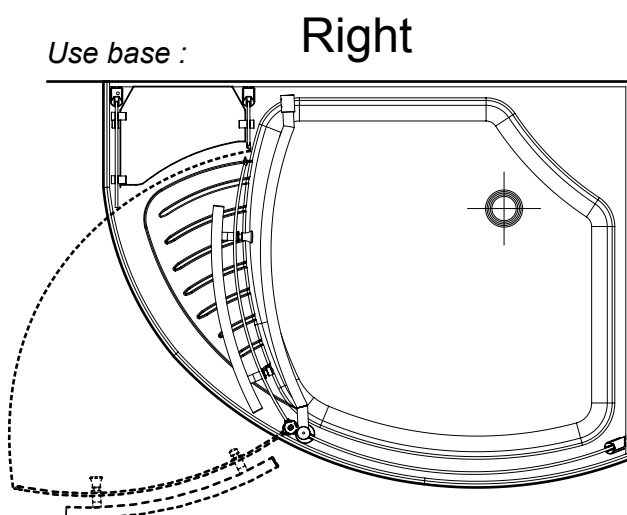
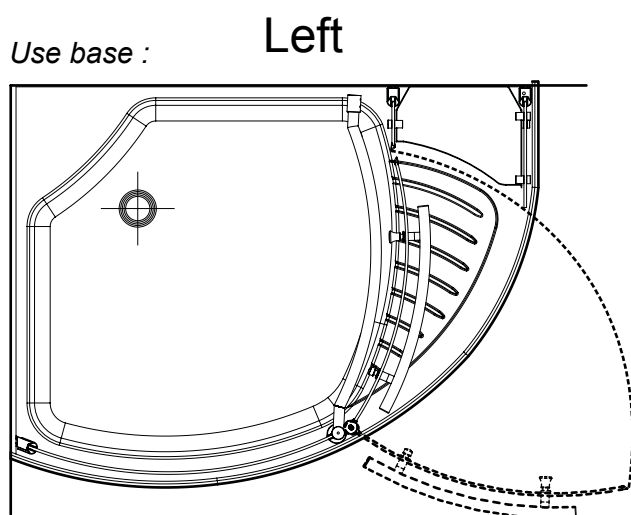

## PARTS LISTING

### NOTE

XX REFERS TO THE MATERIAL FINISH

11- Chrome

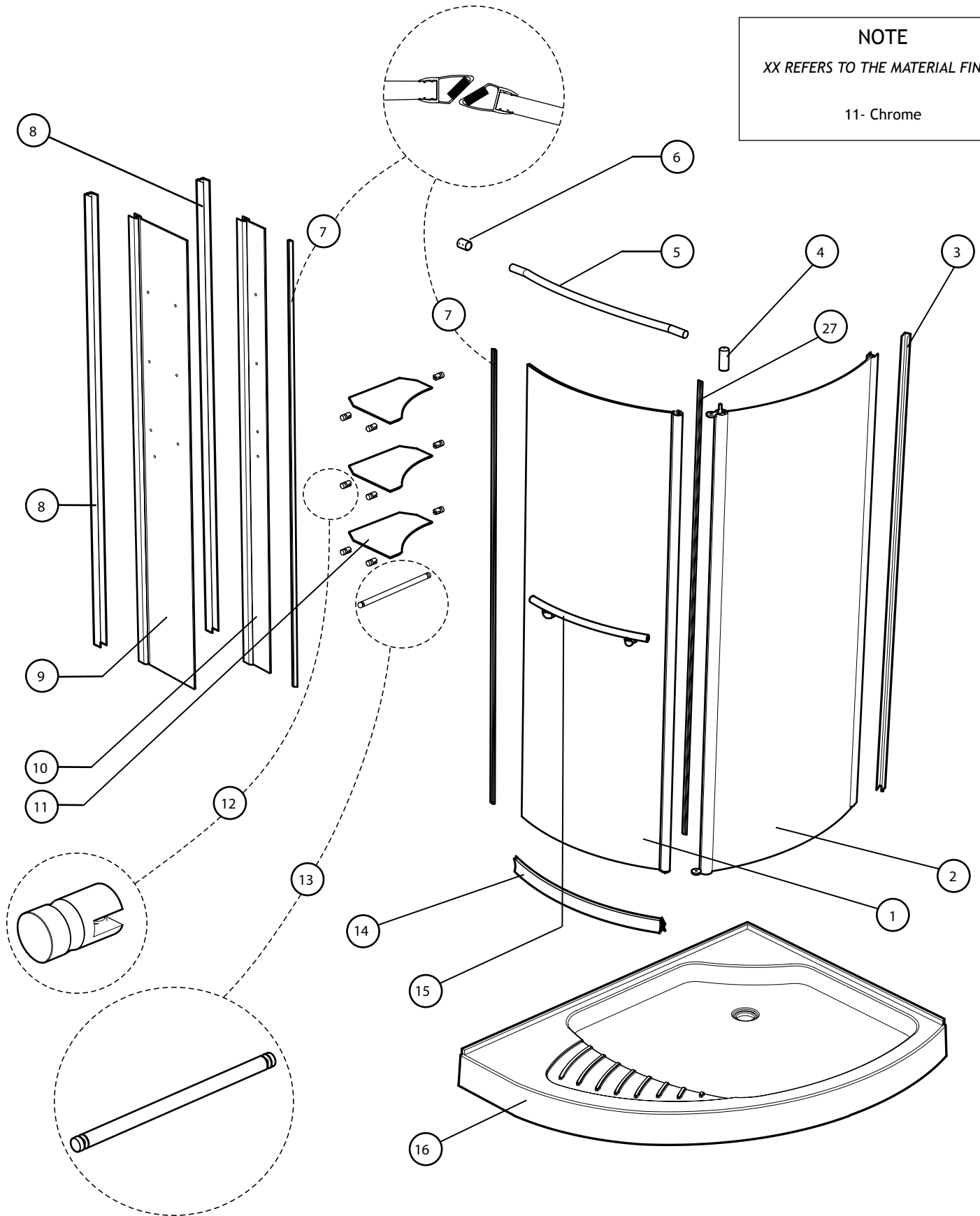

## PROVIDED HARDWARE

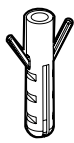

17

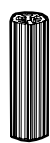

18



19



20

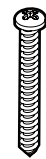

21



22



23

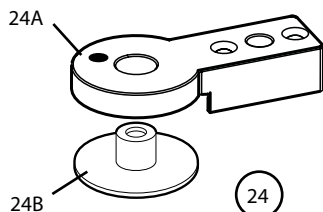

24



25



26



28

	PARTS	QTY
1	DOOR PANEL	1
2	CURVED FIXED PANEL	1
3	WALL JAMB "A"	1
4	CONNECTOR	1
5	SUPPORT BAR	1
6	WALL BRACKET	1
7	MAGNET GASKET	2
8	WALL JAMB "B"	2
9	BIG FIXED PANEL	1
10	SMALL FIXED PANEL	1
11	SHELF	3
12	SHELF HOLDERS	9
13	TOWEL BAR	1
14	BOTTOM DOOR GASKET	1
15	SET OF HANDLE BAR	1
16	BASE	1
17	WALL PLUG	1
18	WALL PLUG	12
19	SCREW	12
20	SCREW	4
21	SCREW	12
22	SCREW CAP	12
23	ROD	1
24	PIVOT SUPPORT	2
25	SCREW	1
26	KEY	2
27	SIDE GASKET	1
28	SCREW	1

## TOOLS AND MATERIALS REQUIRED



SCREWDRIVERS

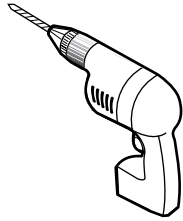

DRILL

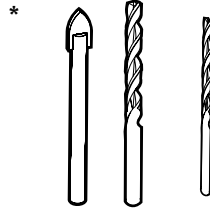

1/4" & 1/8" DRILL BITS

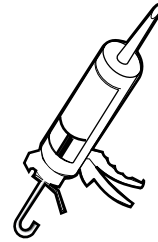

SILICONE

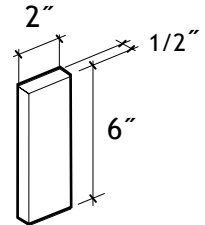

WOODEN BLOCK

*\* If the shower panels are to be assembled on ceramic tiles, use a 1/4" drill bit for ceramic tiles.*



PENCIL

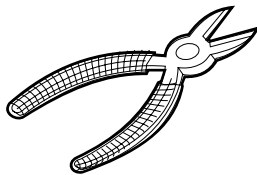

CUTTING PLIER

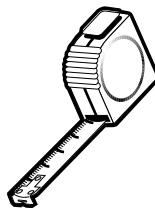

TAPE MEASURE

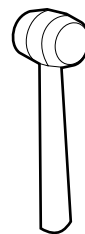

MALLET

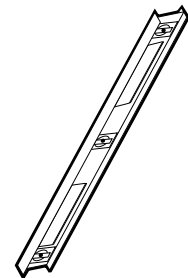

LEVEL

# 1

## INSTALL THE WALL JAMBS

1A. Refer to the provided figure, position and center the wall jambs (#3 & #8) on the shower threshold.

1B. Verify wall jambs verticality using a level.

1C. Trace outer edge of wall jambs.

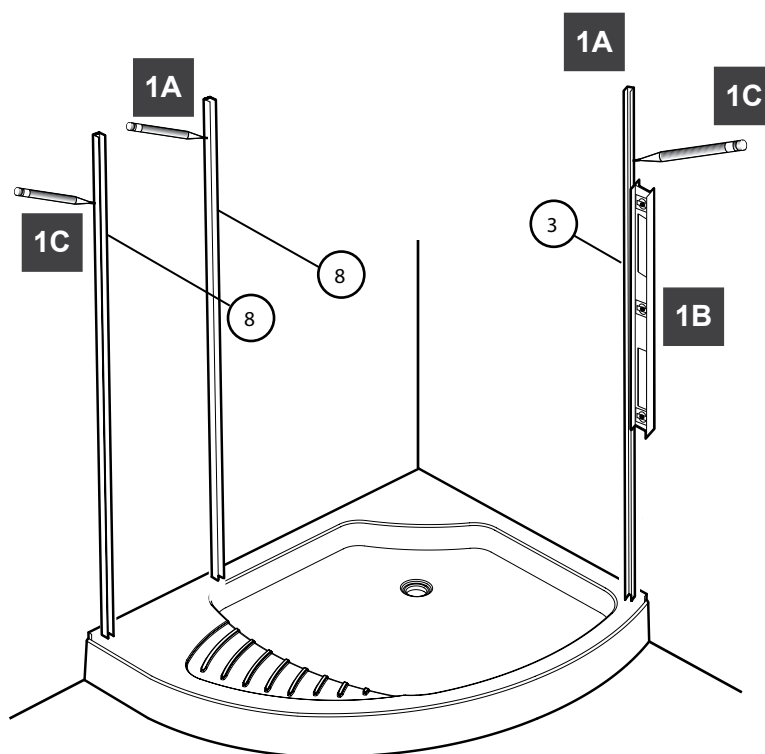
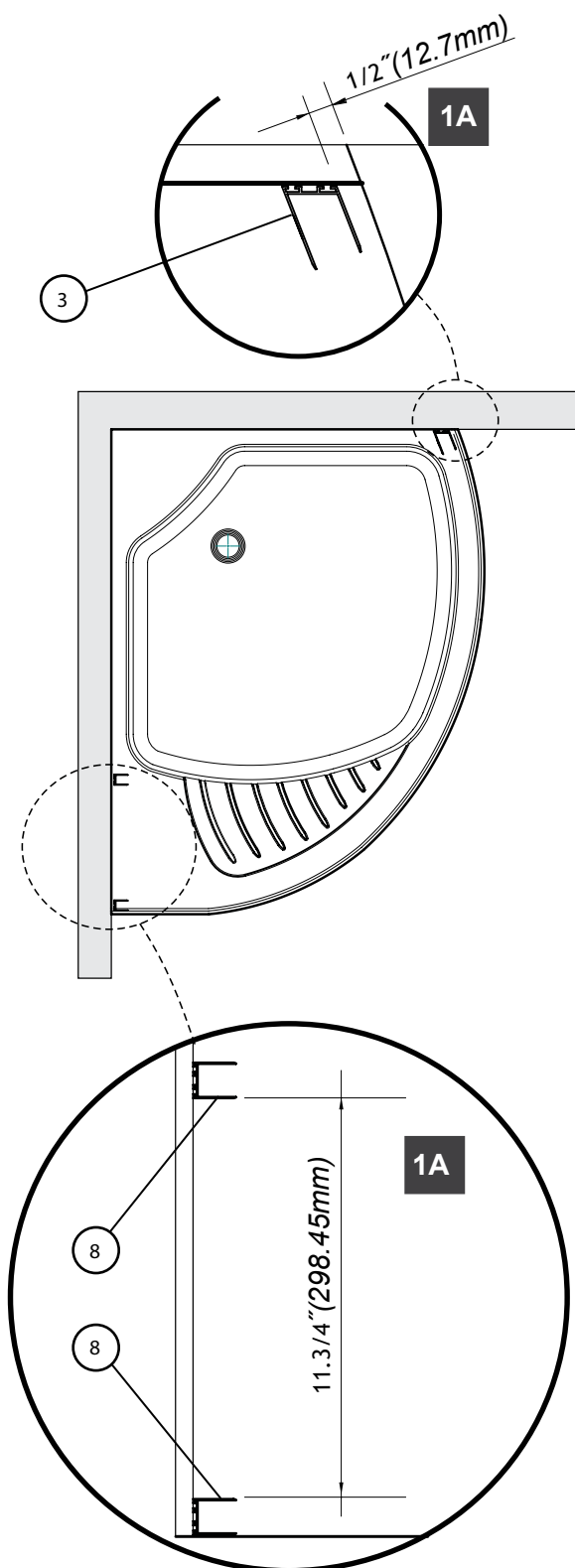



## 2 MOUNT THE WALL JAMBS (CONTINUED).

2A. Reposition the wall jambs "A" (#3) on the shower threshold.

2B. Mark drilling location.

2C. With a 1/4" drill bit, drill 4 holes into the wall using the marks as a guide

2D. Insert 4 wall plugs (#18) and put in each a drop of silicone.

2E. Secure the wall jamb "A" (#3) using the 1 3/8" screws (#21).

2F. Repeat step 2 for the wall jamb "B" (#8).

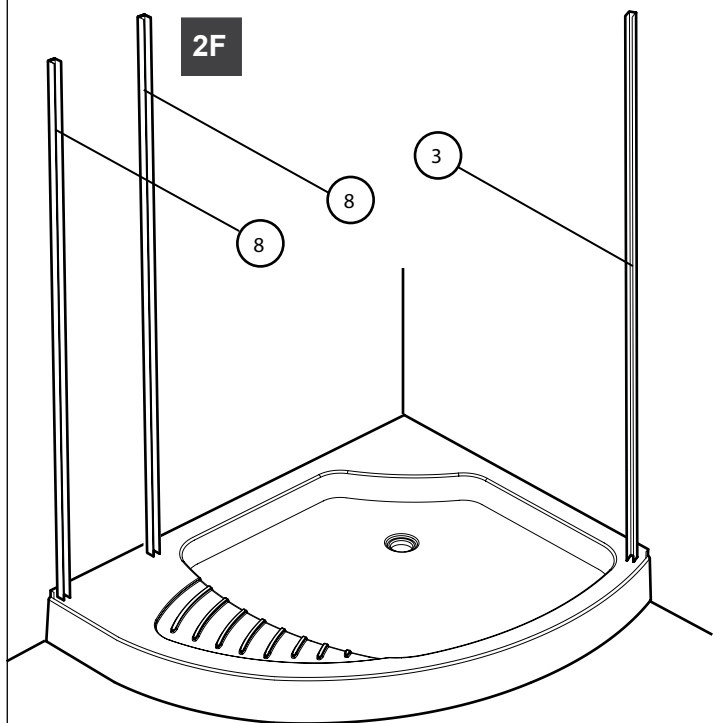
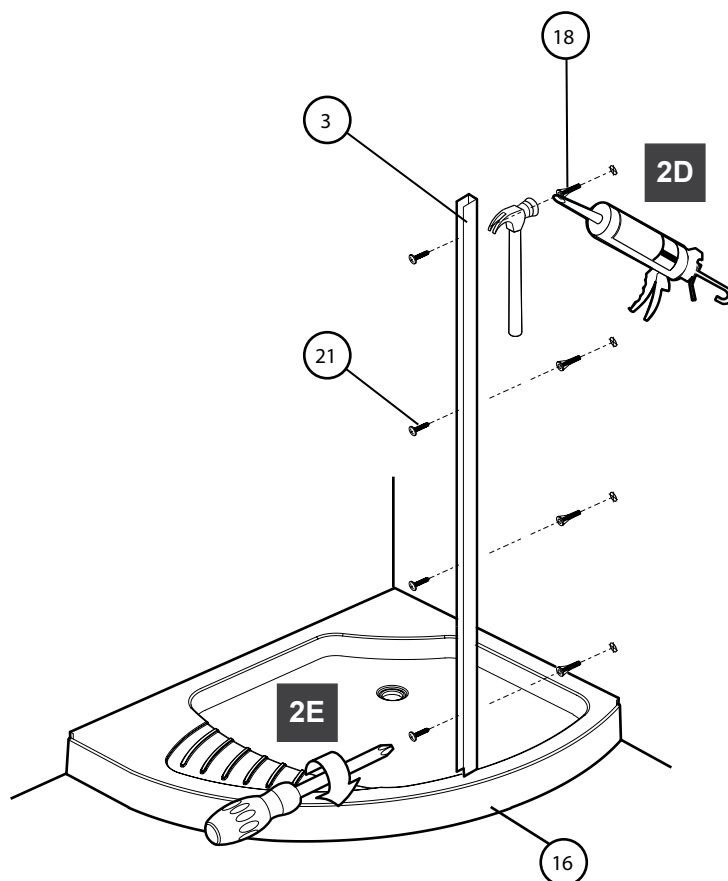
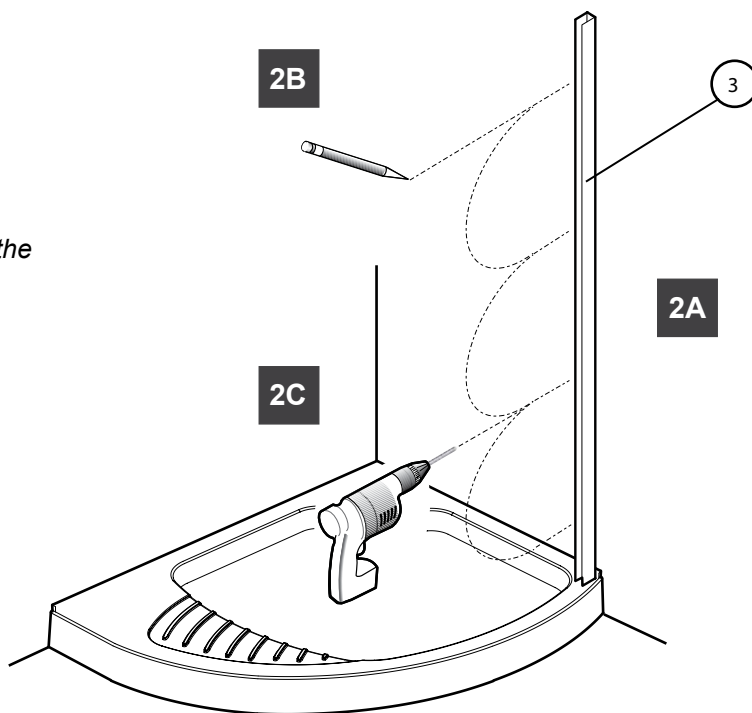

3A. Insert the pivot support(#24)door into fixed panel, (top and bottom of the panel). Tighten screw (#20) lightly permit door panel assembly. (only on the top panel).

3B. Insert fixed panels(#2, #9, #10)into wall jambs(#3, #8x2).

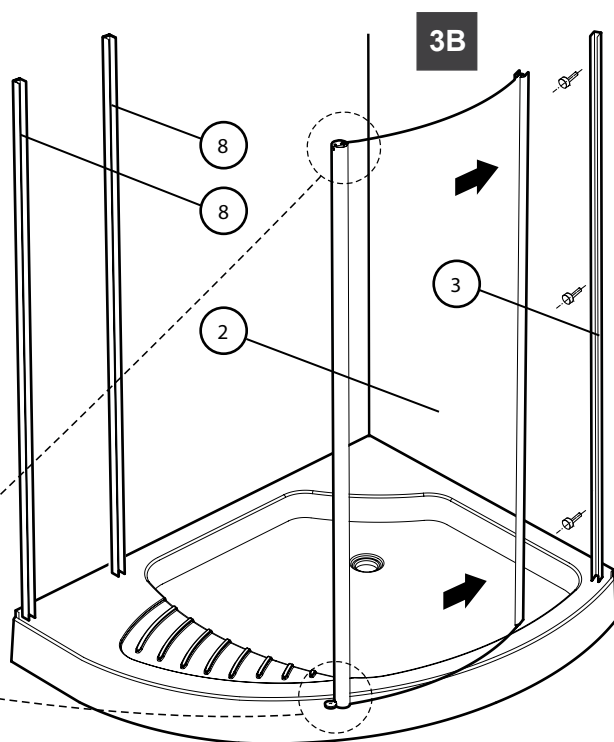
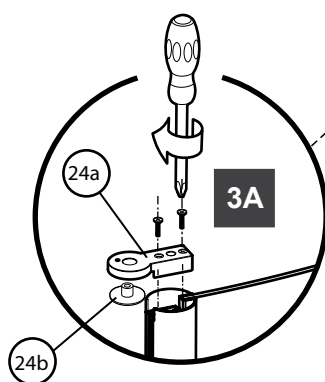

**NOTICE:** Position the drain detail of the pivot support (#24) facing the inside of the shower unit.



drain

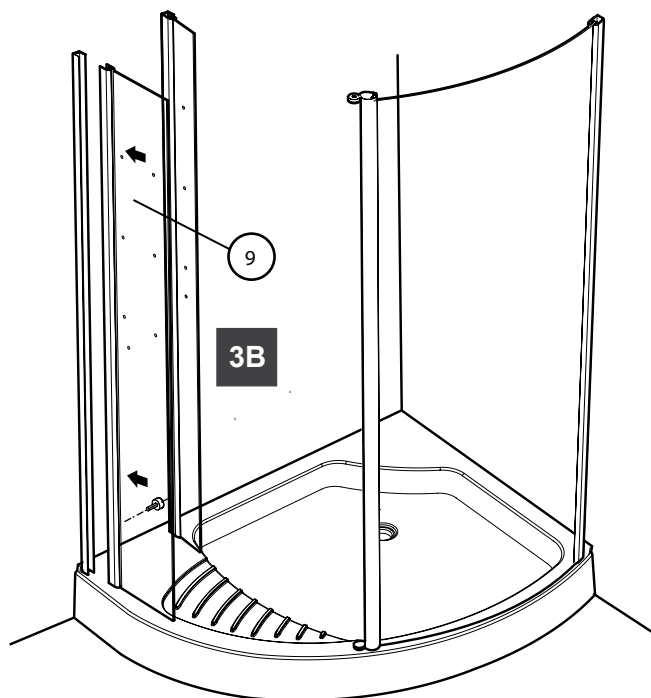
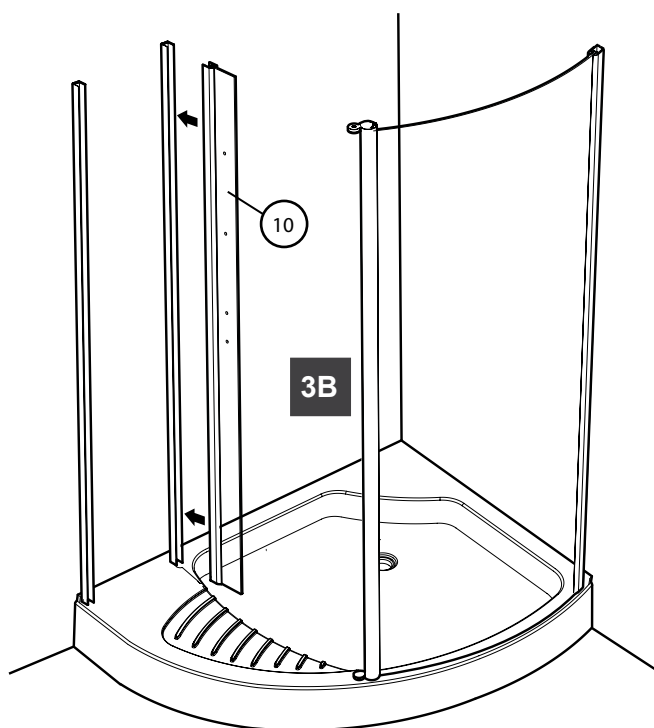
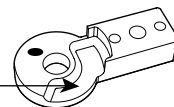

4A. Insert the side gasket (#27) into existing profil of the fixed panel.

4B. Insert the door (#1) into existing pivot support.

4C. Insert the support pivot (#24) door into fixed panel, to fixe the door (#1) in position.

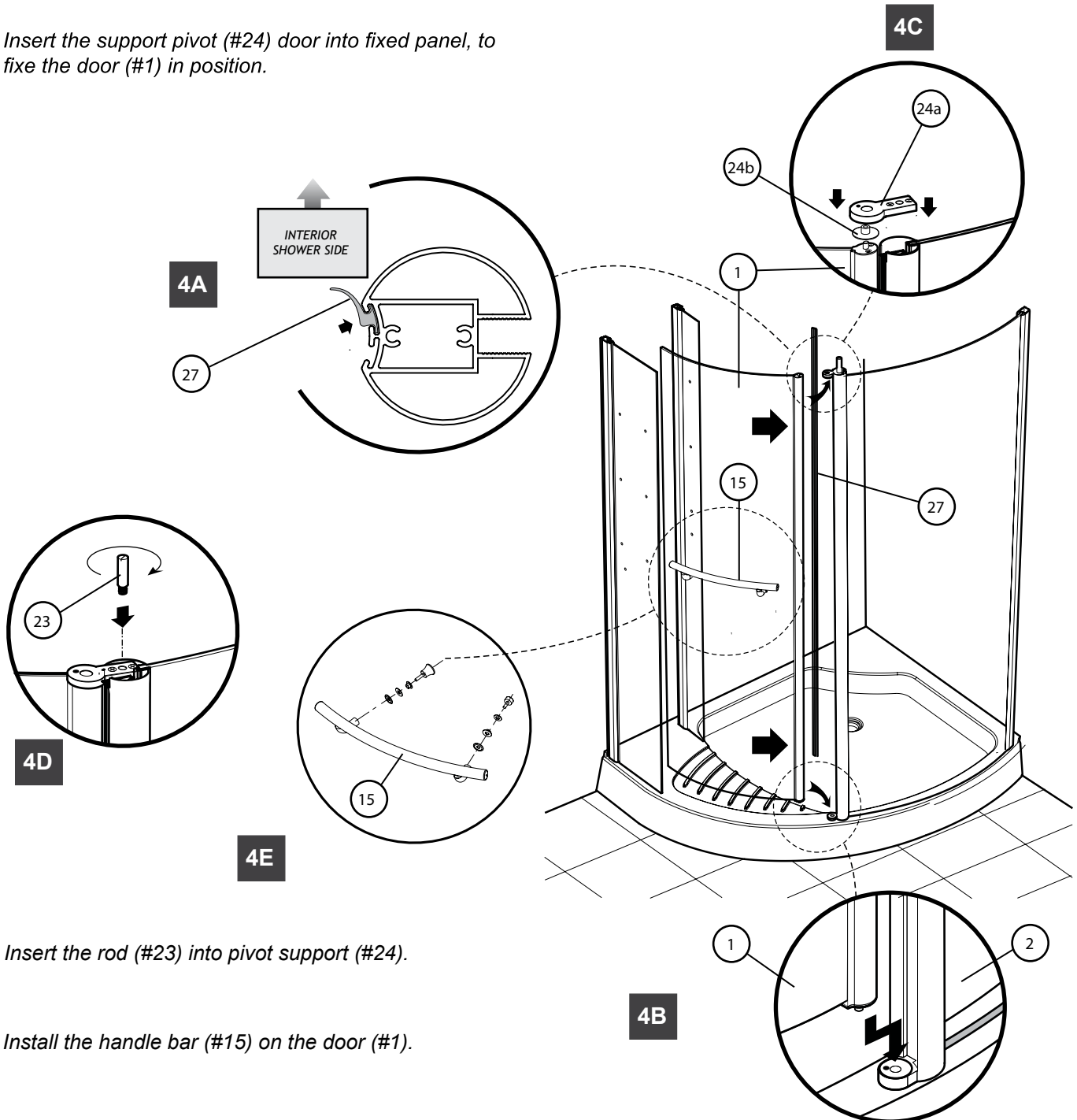

4D. Insert the rod (#23) into pivot support (#24).

4E. Install the handle bar (#15) on the door (#1).

## 5 GASKET INSTALLATION

5A. Insert magnetic gasket (#7) into fixed panels (#10) and door (#1).

5B. Verify swivelling of door.

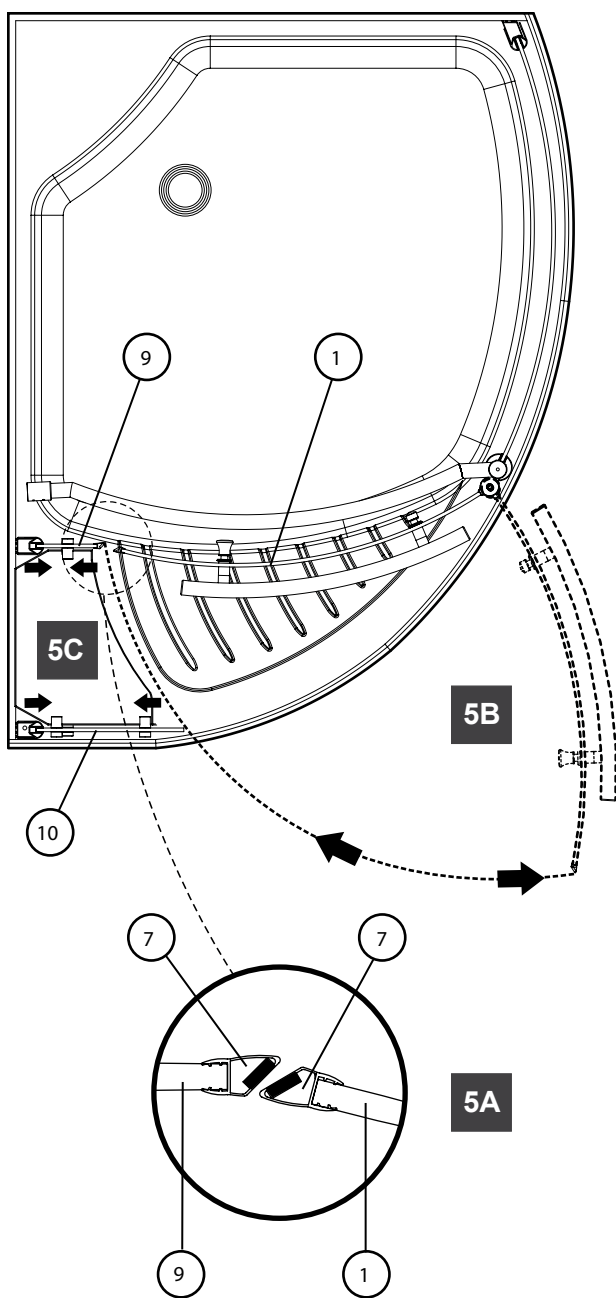

5C. Adjust in consequence the fixed panels (#9, #10).

5D. Insert bottom gasket (#14) into the door (#1).

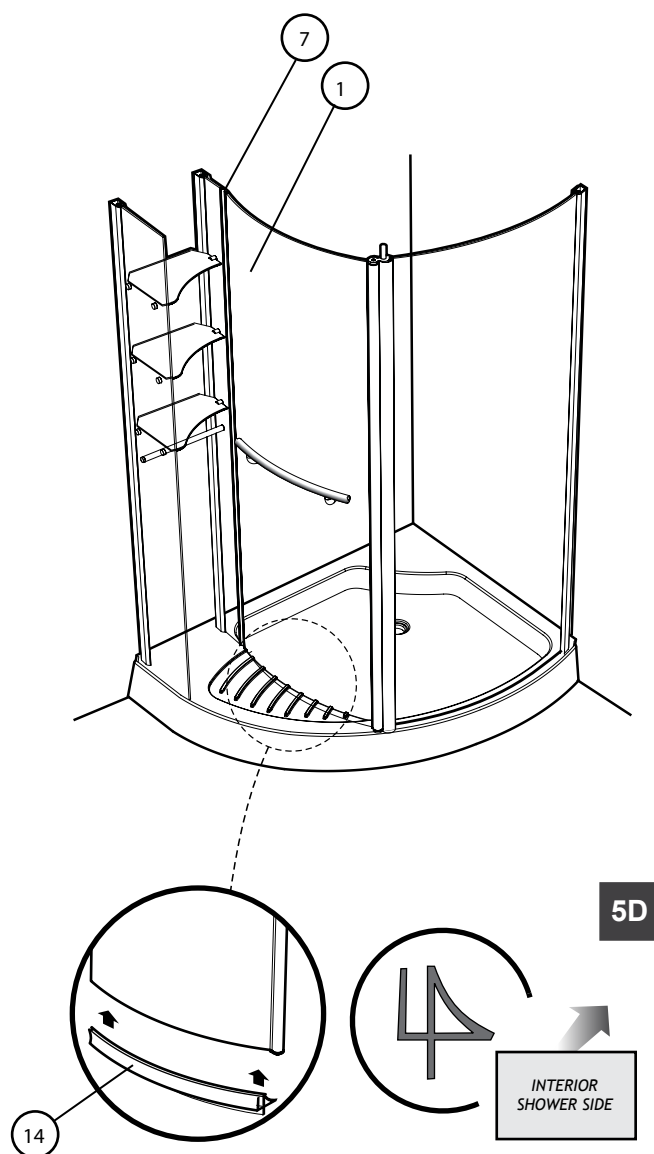

## 6 INSTALL THE SUPPORT BAR.

6A. Insert connector (#4) into the rod (#23).

6B. Insert temporarily the adjustment bar (#5) into connector (#4)

6C. Insert temporarily the wall bracket (#6) into adjusting bar (#5).

6D. Mark drilling location.

6E. Secure the connector (#4).

6F. Secure the wall bracket (#6).

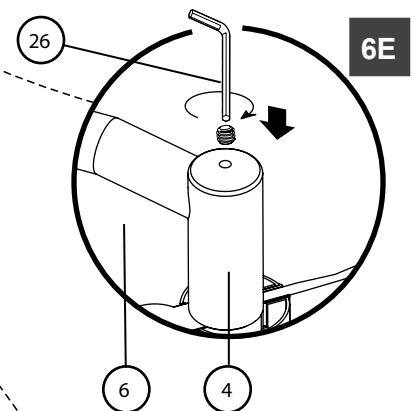
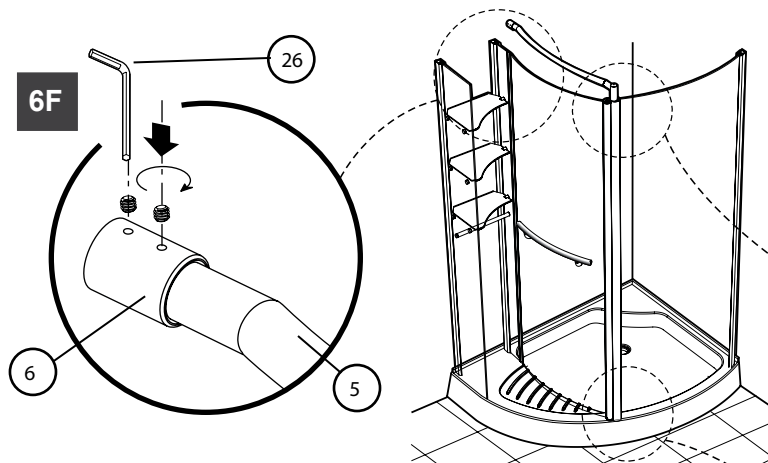
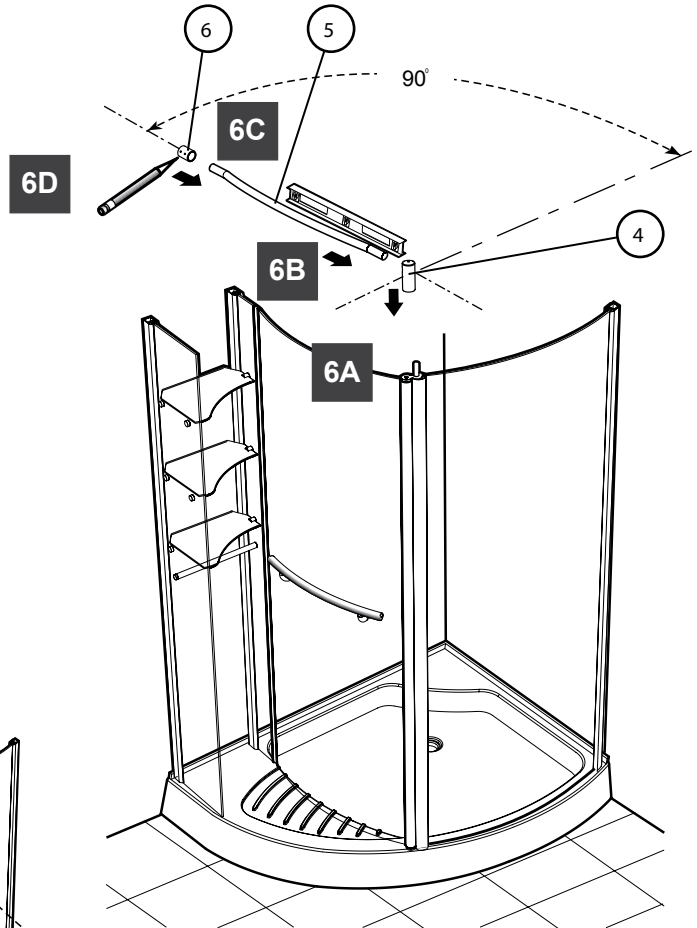

6G. Remove door panel.

Using a drill bit Ø1/16" into the base through the pivot support. Put a bead of silicon inside the hole.

Screw in the provided retainer piece.

Put back door panel.

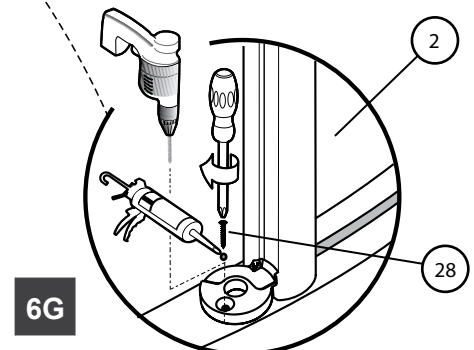

7A. Assure good relation between two magnetic gaskets (#7), adjusting (if necessary) the support bar (#5). gaskets (#7).

7B. Screw fixed panel (#2,#9 & #10).

7C. Secure the connector (#4).

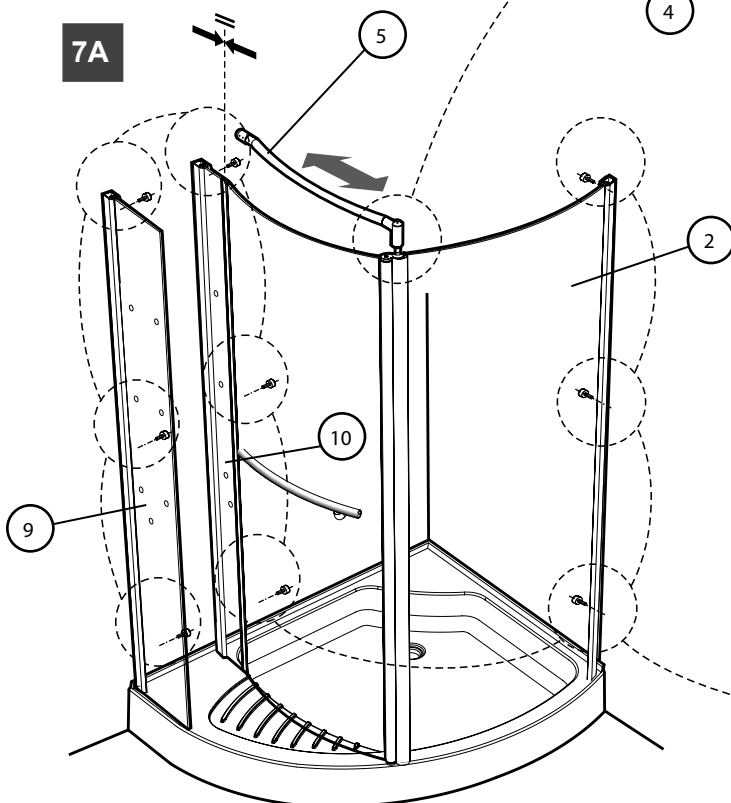
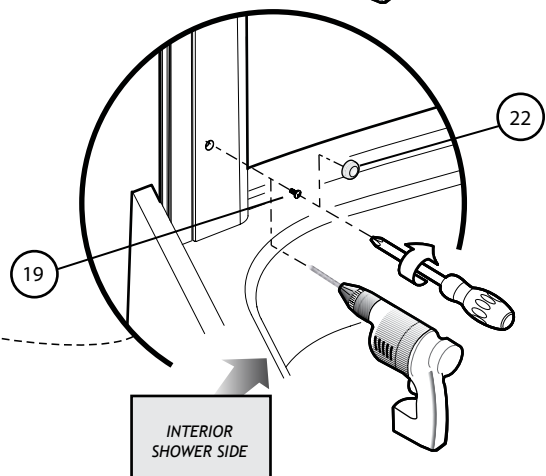
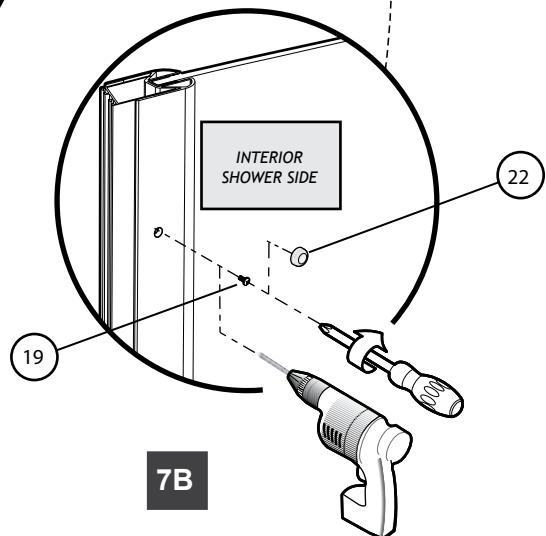
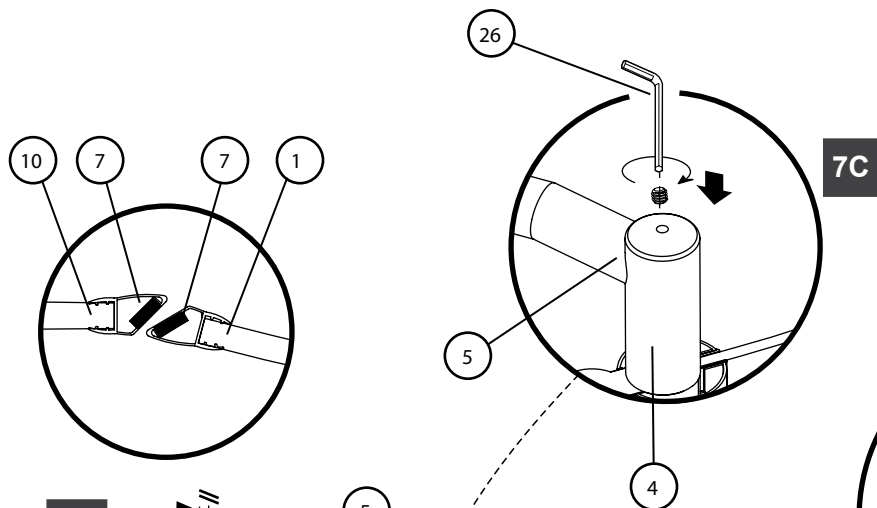
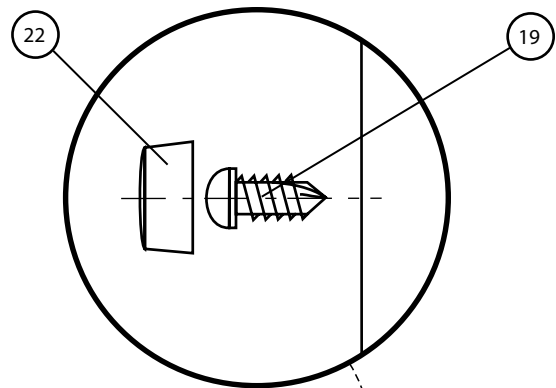

8A. Insert shelf holders (#12) between the fixed panels.(#9,#10).

8B. Insert shelf (#11) between two fixed panel.

8C. Tighten the shelf holders.

8D. Install towel bar (#13).

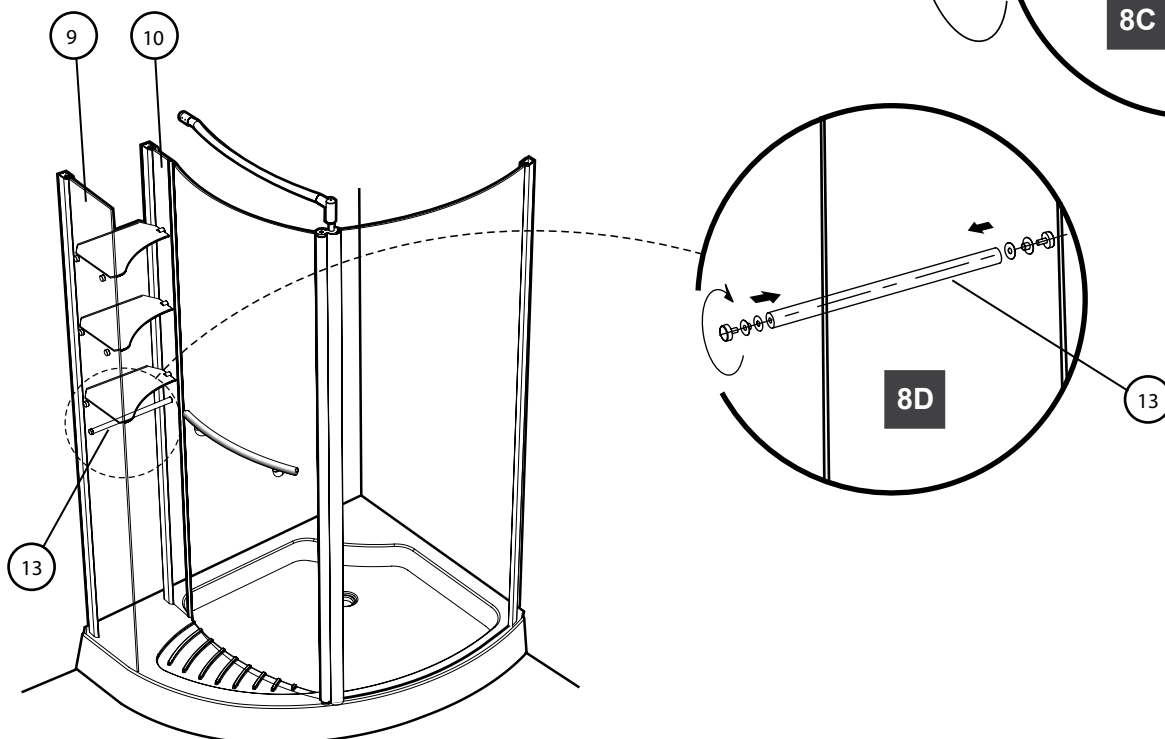
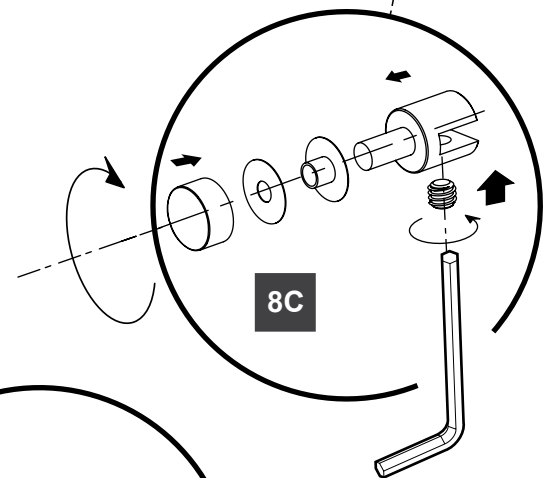
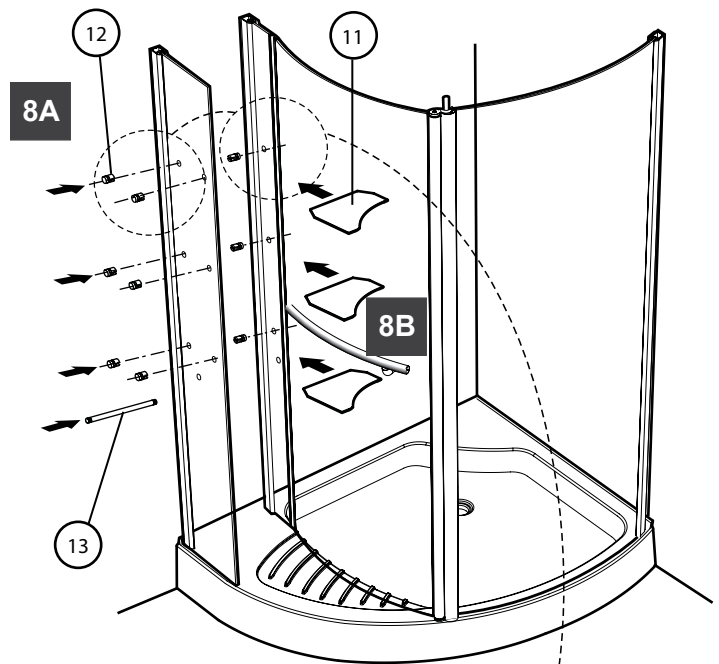

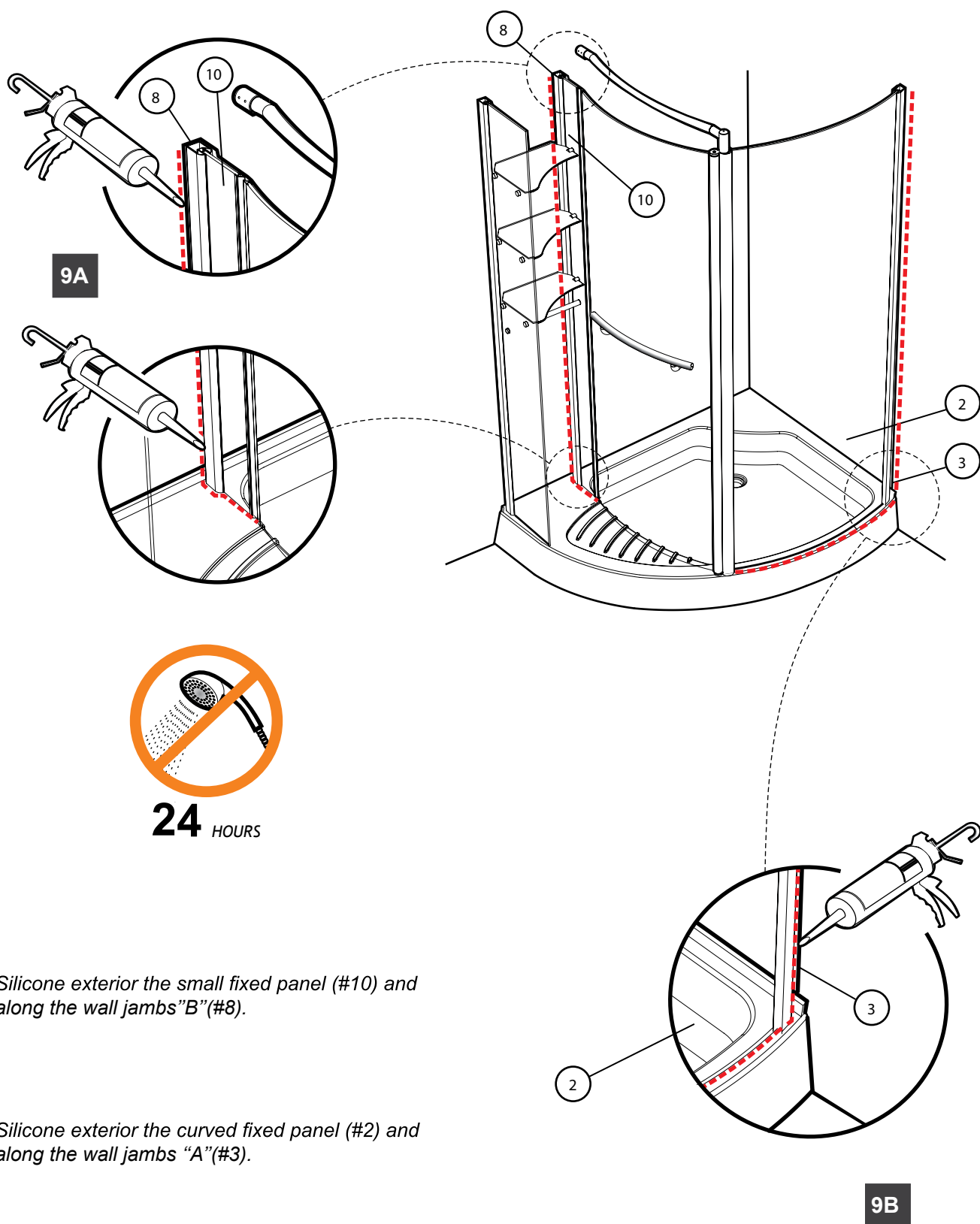

9A. Silicone exterior the small fixed panel (#10) and along the wall jambs "B" (#8).

9B. Silicone exterior the curved fixed panel (#2) and along the wall jambs "A" (#3).