

SC-881
15131
640 Header
2-1/16" x 2-1/8"



V-243
Anti-Jump
Header Insert



V-52
Glazing Vinyl
for 5/32" glass



V-53
Glazing Vinyl
for 3/16" glass

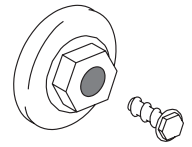

#4082
Roller Bearing
w/Screw



SC-882
60631
Top Rail
1/2" x 2-3/8"



SC-884
14750
640 Side Rail
1-1/4" x 1/2"

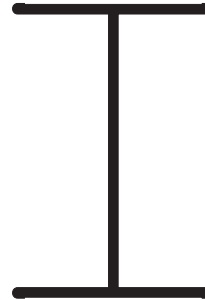

SC-896
12684
340/640 Wall Jamb
1" x 1-1/2"



SC-545
64234
Inline Panel Rail

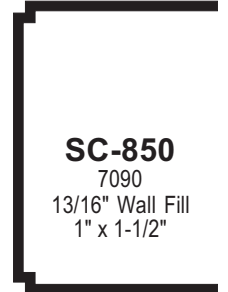

SC-850
7090
13/16" Wall Fill
1" x 1-1/2"

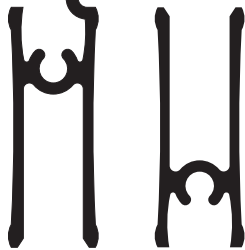

SC-883
14751
Bottom Rail
1/2" x 1-1/4"



#5095
Acorn Nut

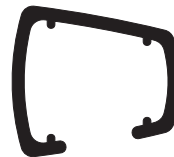

SC-805
63135
Towel Bar

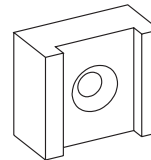

#4112
Finger Pull
with Decal

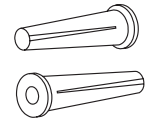

#4106
Plastic Wall Anchors

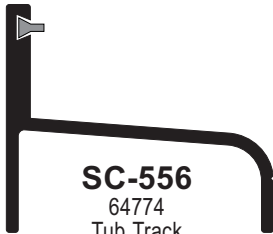

SC-556
64774
Tub Track
with V-190
Vinyl
1-3/8" x 1-3/16"

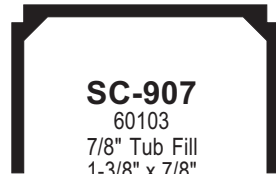

SC-907
60103
7/8" Tub Fill
1-3/8" x 7/8"

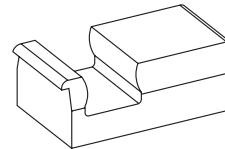

#8273
640 Jamb Bumper

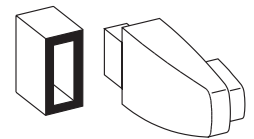

#4125
T-Bar Brkt & Sleeve

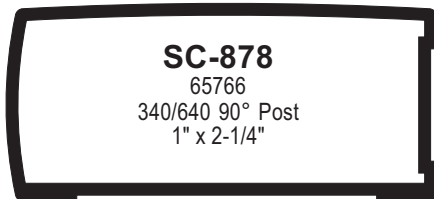

SC-878
65766
340/640 90° Post
1" x 2-1/4"

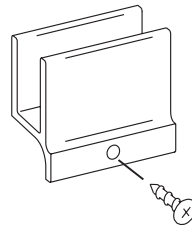

#4048
Bottom Guide with
Screw

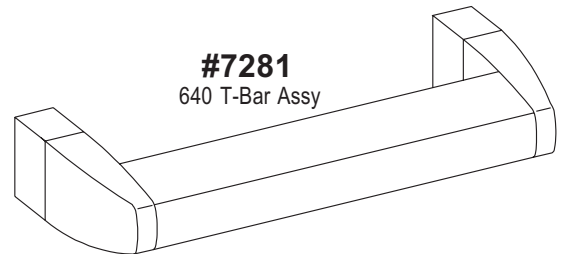

#7281
640 T-Bar Assy

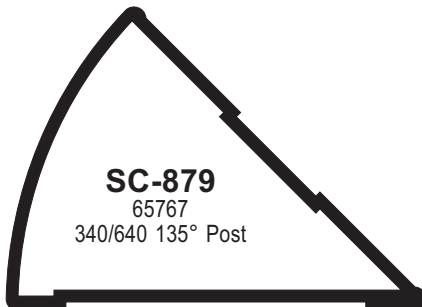

SC-879
65767
340/640 135° Post

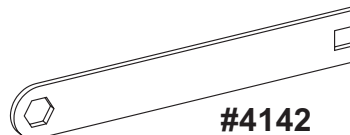

#4142
Adjustment Wrench